

CORPORATE BOUNDARIES

as of
December 1, 1970

State of Wisconsin)
Department of State) ss.

Received and filed this Thirty-first

day of December A.D. 1970

Robert Zimmerman
.....
Secretary of State

**VILLAGE OF ELEVA
TREMPEALEAU COUNTY, WISCONSIN
LEGAL DESCRIPTION**

Commencing at the Southwest corner of Section 10, Township 24 North, Range 9 West; thence East 189.75 feet; thence North 2,640 feet to a point 189.75 feet East of the West Quarter stake of Section 10; thence East 816.75 feet on the East and West Quarter line; thence North 2,640 feet to the South line of Section 3; thence East on said line 1,105.5 feet; thence North 627 feet in the Southwest Quarter of Section 3; thence West 2,772 feet to a point in Section 4; thence South 627 feet to the south line of Section 4; thence West 96 rods; thence South 80 rods to the forty line; thence West 676.50 feet; thence South 1,237.5 feet to the right-of-way of the Chicago and North Western Railway Company; thence Southeasterly on the right-of-way line of the above named railroad to a point 709.5 feet South of the Southwest corner of the Southeast Quarter of the Northeast Quarter of Section 9; thence South 1,930.5 feet to the South line of Section 9; thence East on said Section line 1,320 feet to the place of beginning.

STATE OF WISCONSIN

VILLAGE OF ELEVA

TREMPEALEAU COUNTY

I, John Bjorklund, Village Clerk in and for, the Village of Eleva, Trempealeau County, Wisconsin, do hereby certify that the attached map and the above description is a true and correct description of the corporate boundaries of the Village of Eleva as of December 1, 1970.

VILLAGE SEAL

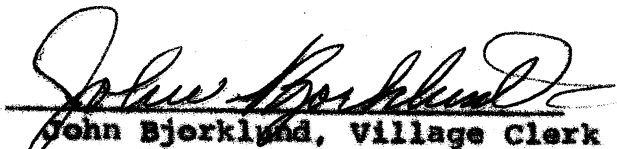
John Bjorklund, Village Clerk

STATE OF WISCONSIN
DEPARTMENT OF STATE
RECEIVED AND FILED



DEC 31 1970

ROBERT C. ZIMMERMAN
SECRETARY OF STATE

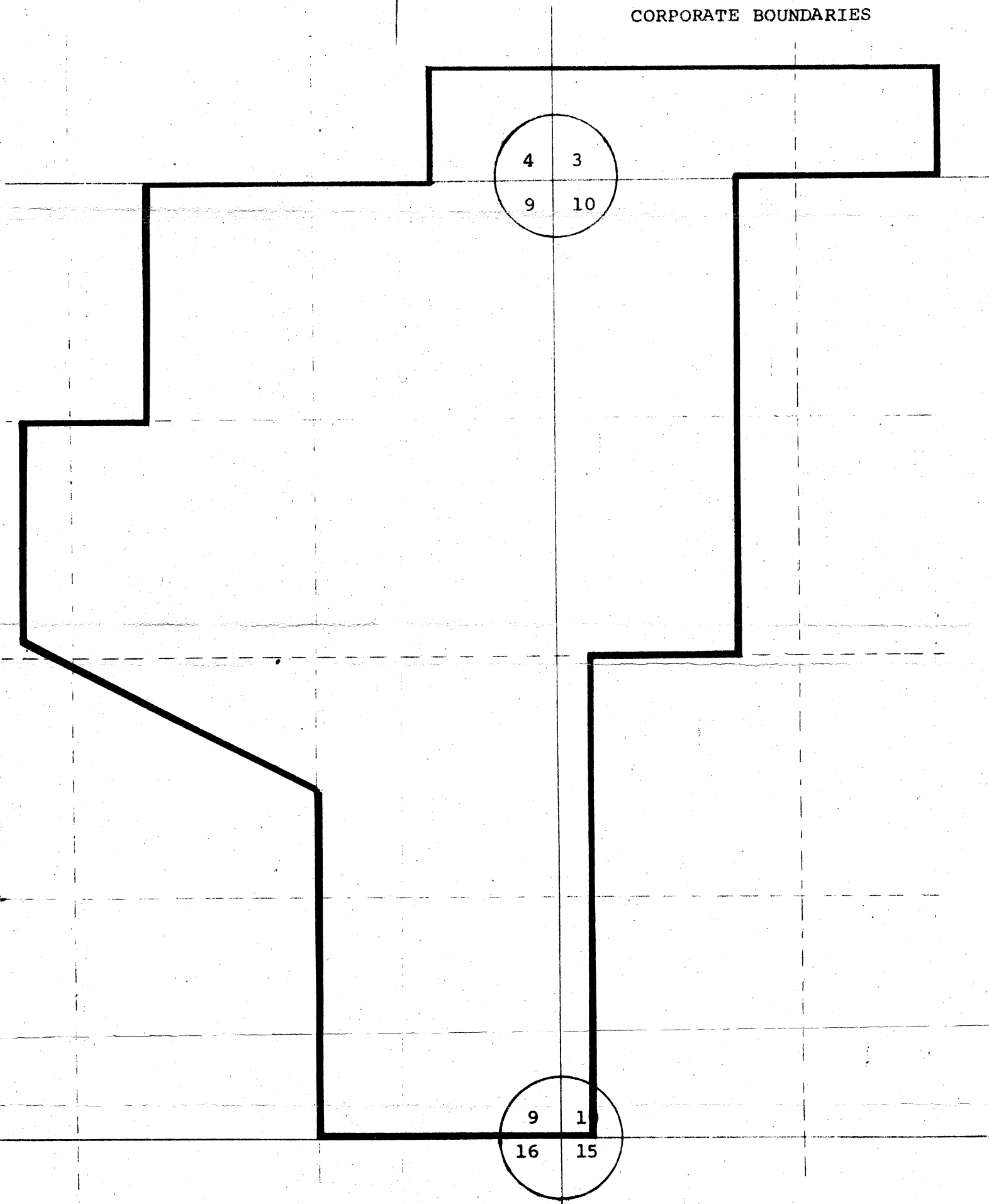

VILLAGE OF ELEVA
TREMPEALEAU COUNTY

CORPORATE BOUNDARIES



0' 500' 1000'
Scale

Township 24 North, Range 9 West

STATE OF WISCONSIN
DEPARTMENT OF STATE
RECEIVED AND FILED

DEC 31 1970
ROBERT C. ZIMMERMAN
SECRETARY OF STATE