

Black Creek

Corporate Boundaries

State of Wisconsin)
Department of State) ss.

Received and filed this 25th

day of Apr. A.D. 1973

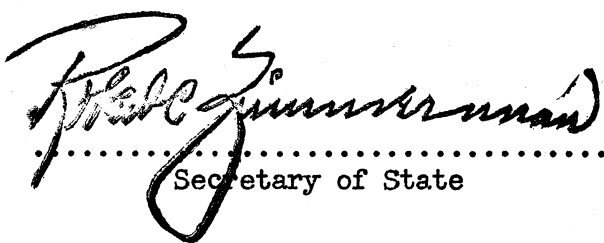
.....
Secretary of State

CERTIFICATE FOR REPORTING CORPORATE LIMITS
OF VILLAGE AFTER ALTERATION

(Pursuant to Section 66.021(8) Wisconsin Statutes)

I, RICHARD BAUMAN, Village Clerk of the Village of Black Creek, County of Outagamie, State of Wisconsin, DO HEREBY CERTIFY that the corporate boundaries of the said Village have been altered within the previous twelve month period ending December 1, 1972, and that the following description is the present corporate limits of the said Village as of December 1, 1972:

All of the SE 1/4, Section 8, the SW 1/4, Section 9, the NW 1/4, Section 16, and the NE 1/4, Section 17, all in T23N, R17E;

Also, the west 200 feet of Government Lot 2, Section 9, T23N, R17E;

Also, a parcel of land in Government Lot 8, Section 8, T23N, R17E, described as follows:

Commencing at the east 1/4 corner of said Section 8; Thence west along the 1/4 line, 106.8 feet to the west line of new S.T.H. 47 as the point of beginning; Thence southerly along the west line of said S.T.H. 47, 221 feet to the north line of property owned by Outagamie County for road purposes; Thence westerly along said north line 82.5 feet to the northeasterly line of old S.T.H. 47; Thence northwesterly along the said northeasterly line 241.7 feet to an angle point; Thence continuing northerly along the easterly line of old S.T.H. 47, 305 feet to the center of Black Creek; Thence easterly along the centerline of Black Creek as it existed prior to the channel change made when the new S.T.H. 47 was built in 1950, 257 feet more or less to the west line of new S.T.H. 47; Thence southerly along the said west line, 485 feet to the point of beginning, excepting therefrom that part in the southeast 1/4 of said Section 8 that already lies in the Village of Black Creek.

Dated: 4-24-73

Richard D Bauman
Village Clerk

STATE OF WISCONSIN
DEPARTMENT OF STATE
RECEIVED AND FILED

APR 25 1973

ROBERT C. ZIMMERMAN
SECRETARY OF STATE

DATE OF LAST COR.	STATE TRUNKS	CONN. STREETS	COUNTY TRUNKS	LOCAL STREETS
1-1-73	2.04		0.25	4.41
1-1-68	2.04		0.25	4.07
1-1-69	2.04		0.25	4.41
1-1-70	2.04		0.25	4.41
1-1-71	2.04		0.25	4.41
1-1-72	2.04		0.25	4.41

CERTIFIED AS CORRECT:

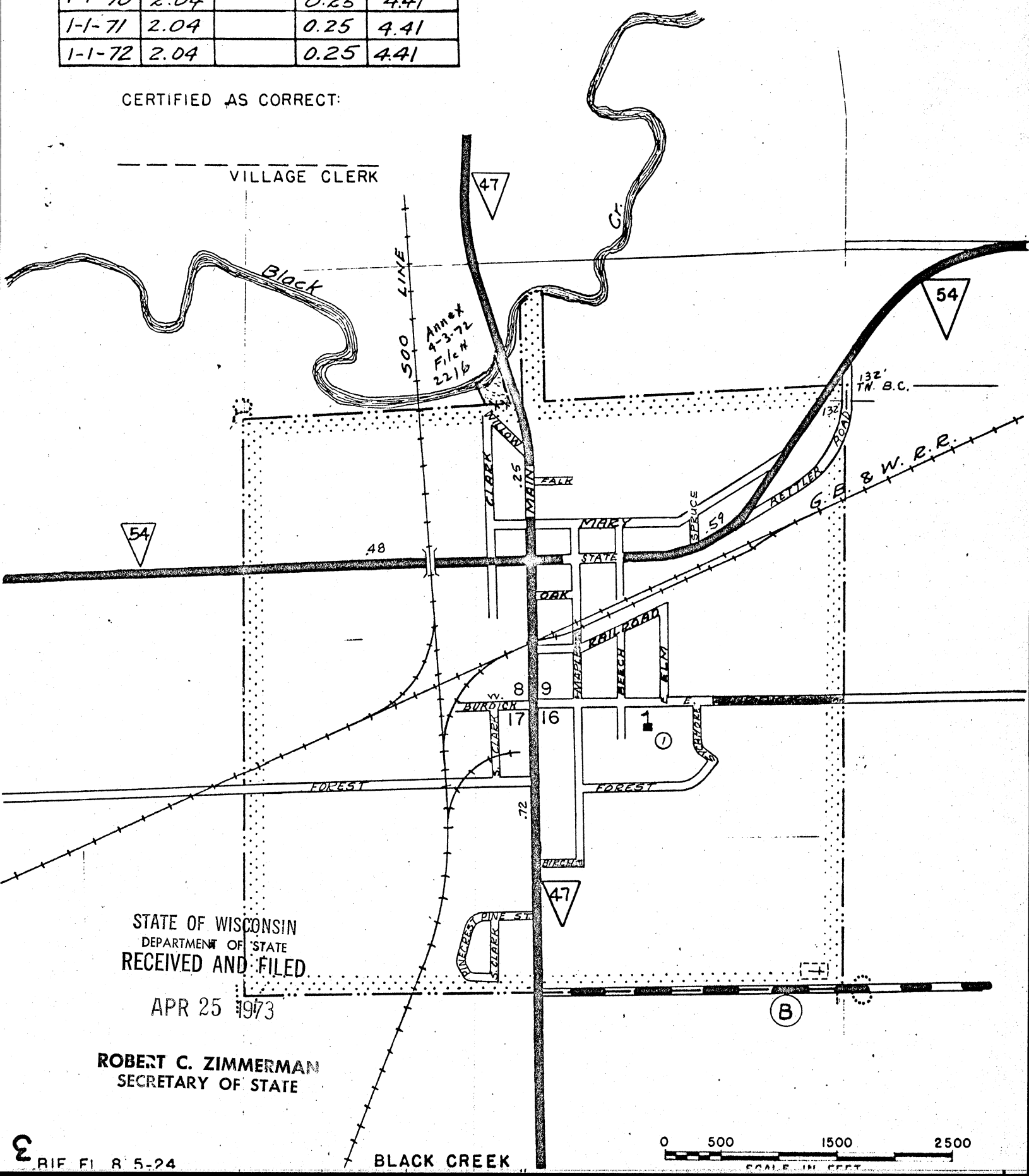

STATE OF WISCONSIN
DEPARTMENT OF STATE
RECEIVED AND FILED

APR 25 1973

ROBERT C. ZIMMERMAN
SECRETARY OF STATE

BLACK CREEK

REF FI 8 5-24

0 500 1500 2500

SCALE IN FEET