

VILLAGE OF OREGON

COUNTY OF DANE

Annexation and Plat Map

OFFICE OF THE SECRETARY OF STATE
State of Wisconsin

Filed: March 20, 1989

DOUGLAS LA FOLLETTE



SECRETARY OF STATE
WISCONSIN

Department of Transportation
Room 951
Hill Farm State Office Building
Madison WI

Attn: John Pamperin

Dear Sir:

Pursuant to Wis. Stats. 66.021/66.025, we are pleased to enclose, in duplicate, certificate and plat relating to annexation of territory adopted by the Village Board of The Village of Oregon, County of Dane, on January 16, 1989.

Sincerely,

A handwritten signature in cursive script that reads "Douglas La Follette".

DOUGLAS LA FOLLETTE
Secretary of State

cc: Depts. of:

Administration
Development
Public Instruction
Revenue

Clerk
File

Village of Oregon

OFFICE OF CLERK

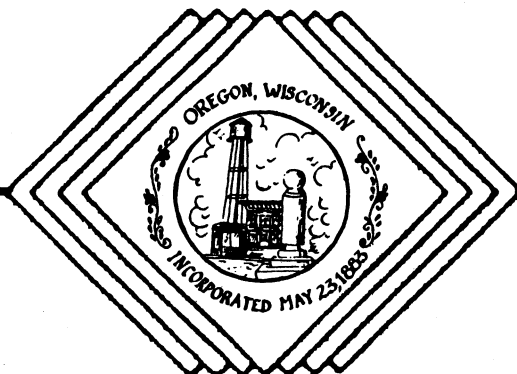

VILLAGE HALL, 117 SPRING STREET
OREGON, WISCONSIN 53575
TELEPHONE: (608) 835-3118
JEANETTE FORMAN
VILLAGE CLERK-TREASURER

I, Jeanette H. Forman, Village Clerk for the Village of Oregon do hereby certify that Ordinance 89-2 annexing certain lands from the Town of Oregon to the Village of Oregon was adopted by the Village Board of the Village of Oregon on January 16, 1989, and further certify that there was zero population within the area annexed.

Dated this 16th day of March, 1989.

Jeanette H. Forman, Village Clerk

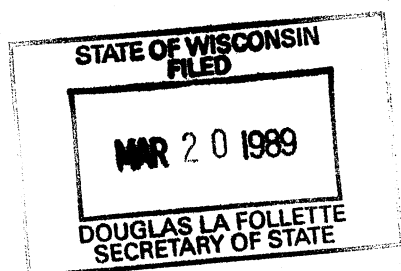

VILLAGE OF OREGON
ORDINANCE NO. 89-2

AN ORDINANCE ANNEXING TERRITORY TO THE VILLAGE
OF OREGON, DANE COUNTY, WISCONSIN

By request of Lythjohan and Weber Realty, Inc

WHEREAS, on December 6, 1988 a petition was filed with the Village Clerk of the Village of Oregon and the Town Clerk of the Town of Oregon signed by Robert C. and Bruce L. Lythjohan, owners of all of the lands included in said petition, seeking to annex certain lands hereafter described to the Village of Oregon; and

WHEREAS, there are no electors residing in the territory proposed to be annexed; and

WHEREAS, a copy of the petition has been filed with the Wisconsin Department of Development and the Clerk of the Town of Oregon; and

WHEREAS, the Department of Development has not notified the Village within twenty (20) days after receipt of a copy of the petition that the annexation is against the public interest.

NOW, THEREFORE, the Village Board of the Village of Oregon ordains as follows:

Section 1. Territory annexed. In accordance with Wis. Stat. §66.021 and the petition for direct annexation filed with the Village Clerk on the 6th day of December, 1988, signed by all of the owners of land in area and in assessed value in the territory proposed to be annexed, there being no electors residing therein, the following described territory in the Town of Oregon, Dane County, Wisconsin is hereby annexed to the Village of Oregon, Wisconsin:

Tax Parcel Numbers 21-11-190 and 21-12-196 of the Town of Oregon, described as, Part of the NW¼, SW¼, Section 12; and part of the NE¼, SE¼, Section 11; all in T5N, R9E, Town of Oregon, Dane County, Wisconsin, more fully described as follows:

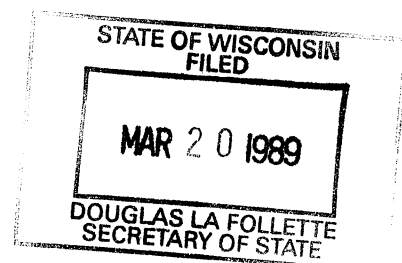

Beginning at the West one quarter corner of the said Section 12, thence N89°59'38" West along the section line, 930.33 feet; thence S0°10'12" West along a line which is 384 feet easterly of the westerly line of the said NE¼, SE¼ of said Section 11, 1134.375 feet (prev. rec. as 68-3/4 rods); thence S89°59'38" East, 930.02 feet; thence S0°11'09" West along the section line, 36.00 feet; thence S88°58'34" East, 526.23 feet; thence N5°00'40" East along the westerly right-of-way of Union Road, 67.62 feet; thence N88°58'34" West along the southerly line of C.S.M. 2234, 309.42 feet; thence N0°33'24" East along the westerly line of the said C.S.M., 1102.83 feet; thence N88°58'34" West along the northerly line of the said NW¼, SW¼ of Section 12, 229.64 feet to the point of beginning. Contains 30.765 Acres.

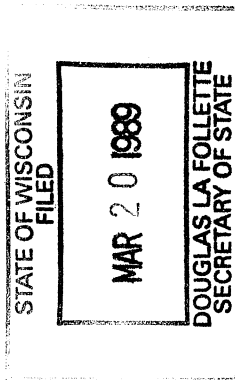

Section 2. Scale map. There is attached hereto, as Exhibit A, a scale map of the property proposed to be annexed showing its relationship to the boundaries of the Village of Oregon and the Town of Oregon.

Section 3. Effect of annexation. From and after the date of publication of this ordinance, the territory described in Section 1, shall be a part of the Village of Oregon for any and all purposes provided by law and all persons coming or residing within said such territory shall be subject to all ordinances, rules and regulations governing the Village of Oregon.

Section 4. Temporary zoning classification.

(a) Upon recommendation of the Village plan commission, the territory annexed to the Village of Oregon by this ordinance is temporarily designated to be part of the AG-1 district of the Village for zoning purposes and subject to all provisions of Chapter 17, "Zoning", of the Municipal Code of the Village of Oregon, Wisconsin, relating to such districts.

(b) The boundaries of the designated zoning district hereby established are shown on the map filed in the office of the Village clerk entitled "Interim District Map, Oregon, Wisconsin."

(c) The plan commission is directed to prepare an amendment to the Village Zoning Code setting forth permanent classifications for the zoning of the annexed area and submit its recommendations to the Village Board within a reasonable time after adoption of this ordinance.

Section 5. Ward designation. The territory described in Section 1 of this ordinance is hereby made a part of the ward of the Village of Oregon, subject to the ordinances, rules and regulations of the Village governing wards.

Section 6. Filing of ordinance. Immediately upon passage and publication of this ordinance, the Village clerk/treasurer shall file with the Wisconsin secretary of state, Division of annexations and railroads, 201 East Washington Avenue, Room 271, Madison, Wisconsin 53703; with each company providing utility service in the annexed area; with the Dane County register of deeds office and with the Oregon school district clerk, certified copies of this ordinance, a certificate of annexation and a copy of the plat of the territory hereby annexed to the Village of Oregon.

Section 7. Annual certification of boundaries. Pursuant to the requirements of Wis. Stat. §66.021(8)(b), no later than February 28, 1989, the Village clerk/treasurer shall certify to the Wisconsin secretary of state and the Dane County register of deeds a legal description of the total boundaries of the Village as they exist on December 1, 1988.

Section 8. Severability. If any provision in this ordinance is invalid or unconstitutional or if the application of this ordinance to any person or circumstance is invalid or unconstitutional, such invalidity or unconstitutionality shall not effect the other provisions or applications of this ordinance which can be given effect without the invalid or unconstitutional provision or application.

Section 9. Effective Date. This ordinance shall take effect upon passage and publication as provided by law.

BY ORDER OF THE VILLAGE BOARD OF THE
VILLAGE OF OREGON THIS 16th DAY OF
January, 1989.

William E. Kortte
William E. Kortte, Village President

Attest:

Jeanette H. Forman
Jeanette H. Forman, Village Clerk/Treasurer

Date Enacted: January 16, 1989
Requires 2/3 Vote

Date Published: January 26, 1989

Effective Date: January 26, 1989

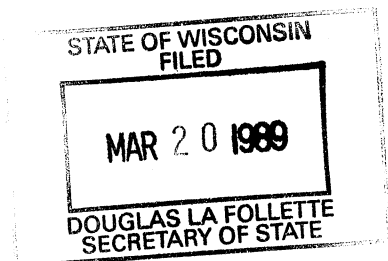

SEE PAGE 19

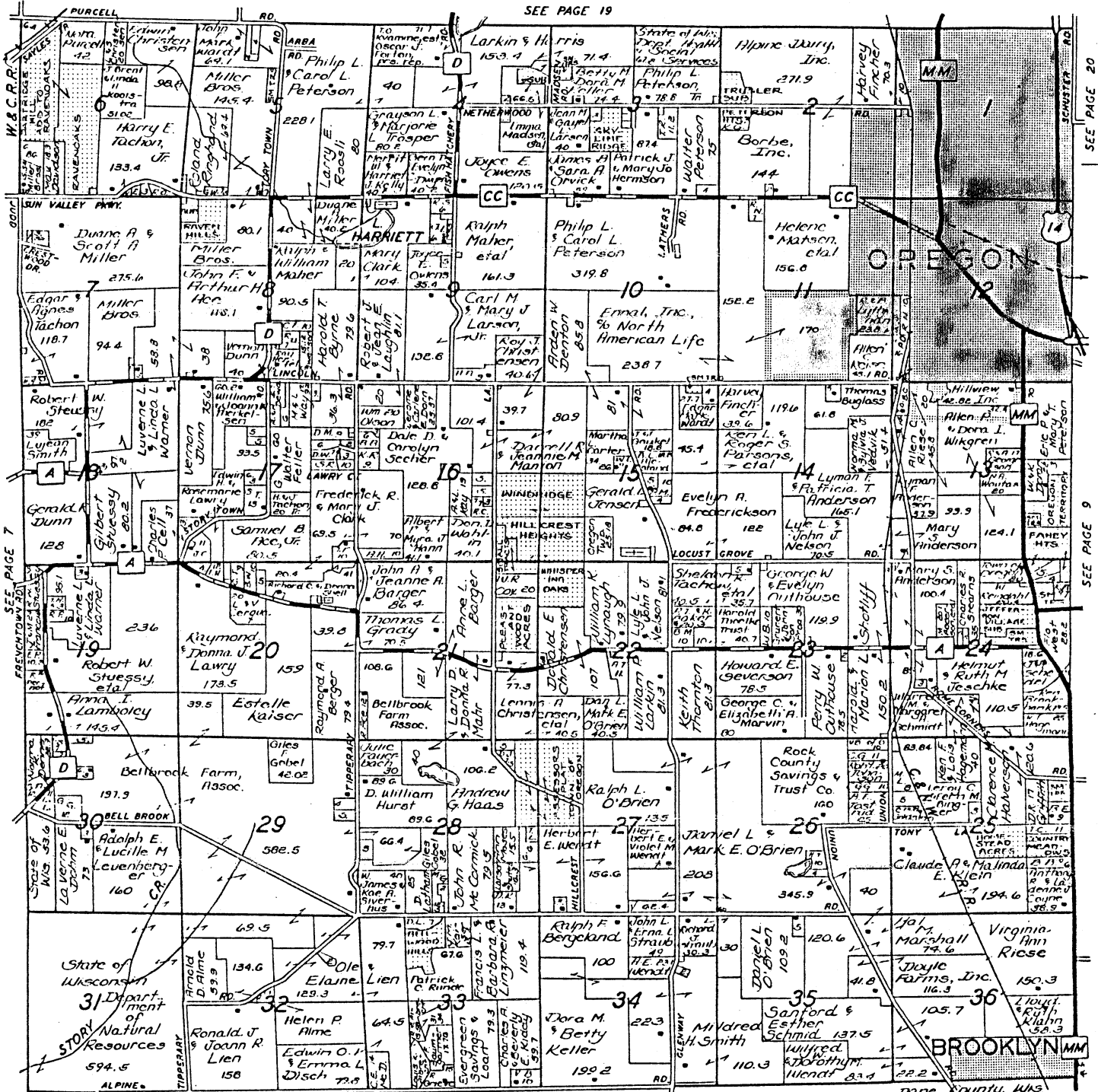

©1986 Rockford Map Works, Inc.

GREEN COUNTY

DANE COUNTY, WIS.

STATE OF WISCONSIN
FILED

MAR 20 1989

DOUGLAS LA FOLLETTE
SECRETARY OF STATE

subject property

Village of Oregon