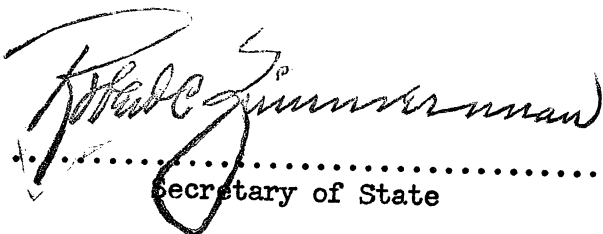

KEWASKUM  
Washington County

CORPORATE BOUNDARIES  
as of  
December 1, 1965

State of Wisconsin )  
Department of State ) ss.

Received and filed this .....23rd.....  
day of .....Dec..... A.D. 19.65..

  
.....  
Secretary of State

CERTIFICATE for REPORTING CORPORATE LIMITS  
Village of Kewaskum, Washington County, Wisconsin

S.

I, William/Martin, Village Commissioner of the Village of Kewaskum, County of Washington, State of Wisconsin, DO HEREBY CERTIFY that the corporate boundaries of the said Village have been altered within the previous 12-month period ending December 1, 1965, and that the following description is the present corporate limits of the said Village as of December 1, 1965:

Beginning at the Northwest corner of Section 9, Township 12 North, Range 19 East in the Town of Kewaskum, Washington County, Wisconsin; thence South  $0^{\circ}02'$  East 2,655 ft. along the West line of Section 9 to the Southwest corner of the Northwest  $1/4$  of said Section 9; thence South  $88^{\circ}59'$  East 1,333.3 ft. along the South line of the Northwest  $1/4$  of Section 9; thence South  $0^{\circ}25'$  East 1,337.2 ft. along the West line of the Northeast  $1/4$  of the Southwest  $1/4$  of Section 9; thence South  $88^{\circ}46'$  East 1,326.6 ft. along the South line of the Northeast  $1/4$  of the Southwest  $1/4$  of Section 9, to the North and South  $1/4$  line of said Section 9; thence South  $0^{\circ}16'$  East along the North and South  $1/4$  line of said Section 9, 1,168.03 ft.; thence South  $88^{\circ}55'$  East 505 ft.; thence South  $0^{\circ}16'$  East 156.75 ft. to the South line of said Section 9; thence South  $88^{\circ}55'$  East along the South line of said Section 9, 1,498 ft. more or less to the reference line of U.S.H. #45; thence North  $30^{\circ}05'$  West 53.4 ft.; thence North  $28^{\circ}01'$  West 1,001.1 ft.; thence North  $28^{\circ}52'$  West to a point which is 296 ft. South  $28^{\circ}52'$  East of the North line of the South  $1/2$  of the Southeast  $1/4$  of said Section 9; thence North  $85^{\circ}08'$  East 278 ft.; thence North  $73^{\circ}59'$  East 273.4 ft. to the Westerly right-of-way line of the Chicago & Northwestern Railway; thence Northwesterly along the said railway right-of-way line 174.03 ft. to the North line of the Southeast  $1/4$  of the Southeast  $1/4$  of said Section 9; thence South  $89^{\circ}09'$  East 797.6 ft. to the Southeast corner of the Northeast  $1/4$  of the Southeast  $1/4$  of Section 9; thence North  $88^{\circ}27'$  East 1,324.5 ft. along the South line of the Northwest  $1/4$  of the Southwest  $1/4$  of Section 10; Township 12 North, Range 19 East; thence North  $1^{\circ}20'$  East 1,324.4 ft. along the East line of the Northwest  $1/4$  of the Southwest  $1/4$  of Section 10; thence North  $0^{\circ}18'$  West 1,337.4 ft. along the East line of the Southwest  $1/4$  of the Northwest  $1/4$  of Section 10; thence due North 1,320.5 ft. to the Northeast corner of the Northwest  $1/4$  of the Northwest  $1/4$  of Section 10; thence South  $87^{\circ}47'$  West 1,320.7 ft. to the Northwest corner of said Section 10; thence North  $88^{\circ}42'$  West 2,696.5 ft. along the North line of Section 9; thence North  $88^{\circ}35'$  West 2,677 ft. to the point of beginning.

Dated, December 21, , 196 5

William S. Martin  
Wm. S. Martin, Village Commissioner

STATE OF WISCONSIN SS  
DEPARTMENT OF STATE  
RECEIVED AND FILED

DEC 23 1965

ROBERT C. ZIMMERMAN  
SECRETARY OF STATE

CERTIFIED AS CORRECT:

*William S. Martin*  
VILLAGE CLERK

VILLAGE OF  
**KEWASKUM**

TOWN: KEWASKUM & AUBURN  
COUNTY: WASHINGTON & FOND DU LAC

228

**KEEP THIS PLAT  
FOR YOUR FILE**

DATE OF LAST COR.	STATE TRUNKS	CONN. STREETS	COUNTY TRUNKS	LOCAL STREETS
1-1-61	1.70		0.52	4.33
1-1-62	1.70		0.52	4.57
1-1-63	1.70		0.52	4.57
1-1-64	1.70		0.52	4.55
1-1-65	1.70		0.52	4.83
1-1-6				

S.O.S. 6-1-59

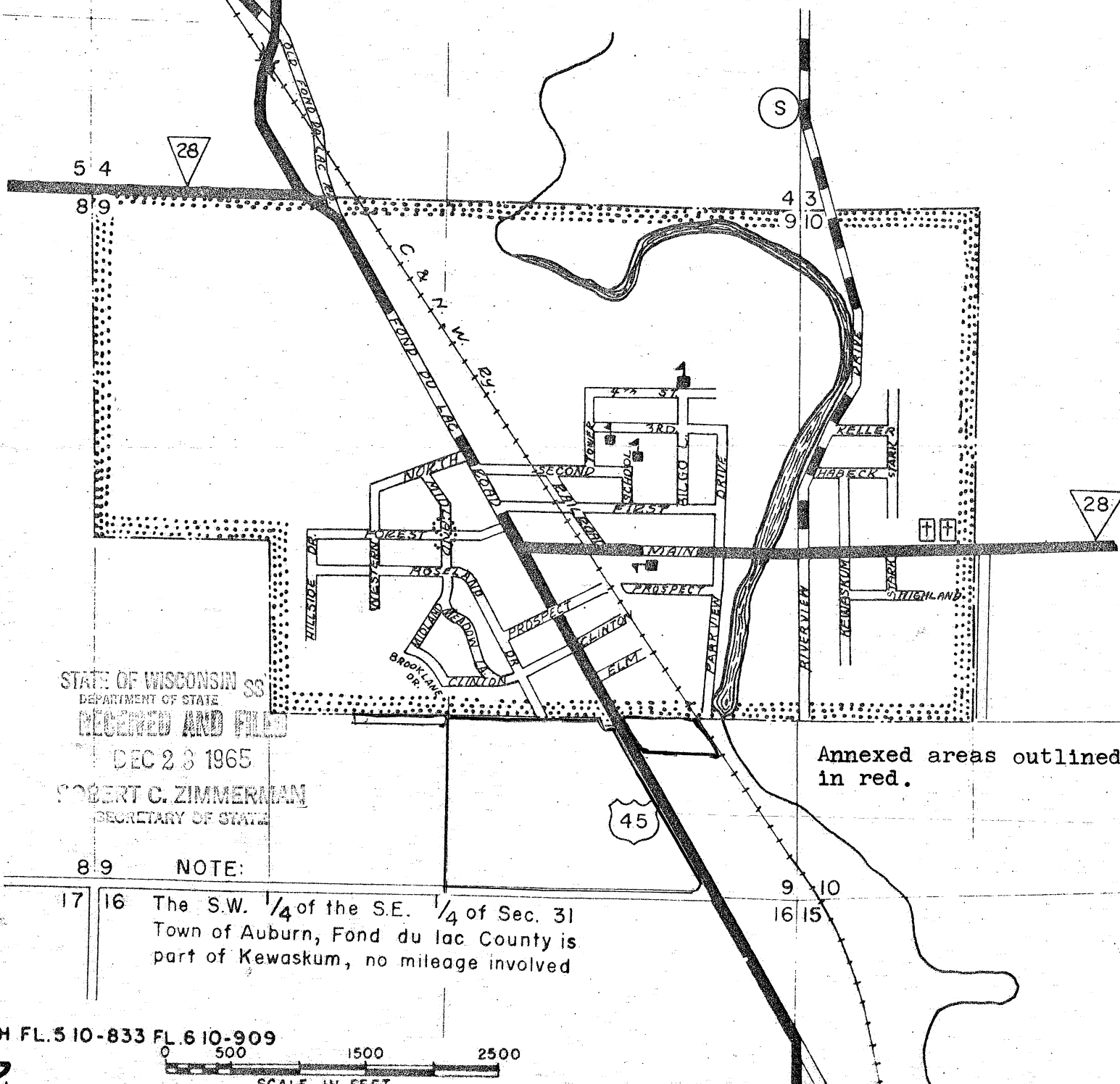

Annexed areas outlined  
in red.

NOTE:

The S.W.  $\frac{1}{4}$  of the S.E.  $\frac{1}{4}$  of Sec. 31  
Town of Auburn, Fond du lac County is  
part of Kewaskum, no mileage involved

XH FL 5 10-833 FL 6 10-909

0 500 1500 2500  
SCALE IN FEET