

VILLAGE OF CLINTON

COUNTY OF ROCK

ANNEXATION & PLAT

OFFICE OF THE SECRETARY OF STATE
State of Wisconsin

FILED JULY 7, 1997

MEMORANDUM

OFFICE OF THE SECRETARY OF STATE STATE OF WISCONSIN

Date:

7-10-97

From: Government Records Division

Contact Person: Billie/Linda

30 West Mifflin St., 10th Floor

P.O. Box 7848

Madison, WI 53707-7848

Billie

To:

Emily Jorenby

Department of Transportation

Room 951, Hill Farm State Office Bldg.

Re:

Municipal Filing Distribution

Attached please find a municipal filing submitted to the Office of the Secretary of State pursuant to Chapter 66, Wis. Stats.

Cc:

Eugene Miller, DOR/Bureau of Equalization

George Hall, DOA/Energy & Intergovernmental Relations

Bob Naylor, Dept. of Administration

Keith Foye, DATCP

Scott Hausmann, Dept. of Natural Resources

Clerk (2)

V- 246

VILLAGE OF CLINTON

301 Cross ST. P.O. Box 129
Clinton, Wisconsin 53525

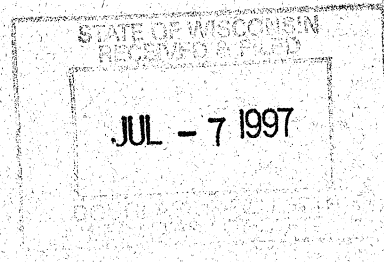

July 3, 1997

State of Wisconsin
Secretary of Business Organizations
PO Box 7848
Madison, Wisconsin 53707

Enclosed please find six certified originals entitled Certifications of Annexation Ordinance and Population, six copies of the plat map and ordinance passed by the Village Board and published.

I am requesting the Office of Business Organizations forward five of the copies to the various agencies according to your normal practice. Please certify the sixth copy as to the date it was received by your office and return it in the enclosed envelope.

Sincerely,

A handwritten signature in cursive script that reads "Lucy Dack".

Lucy Dack, Clerk/Treasurer
Village of Clinton

Lucy Dack
Clerk/Treasurer
608-676-5304
Fax 608-676-5483

James R. Korth
Chief of Police
608-676-5140

Roger W. Johnson
Director of Public Works/
Building Inspector
608-676-5231

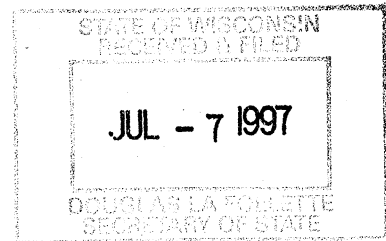

VILLAGE OF CLINTON

ORDINANCE # _____

AN ORDINANCE TO ANNEX TO THE VILLAGE OF CLINTON TERRITORY
IN SECTION 17, T. 1 N., R. 14 E., TOWN OF CLINTON, ROCK COUNTY, WISCONSIN.

WHEREAS, the territory described below is owned by the Village of Clinton, having been purchased by the Village of Clinton by warranty deed on June 30, 1995; and

WHEREAS, such territory is contiguous to the Village of Clinton; and

WHEREAS, no electors reside in such territory; and

WHEREAS, the Department of Commerce has not found the proposed annexation to be against the public interest; and

WHEREAS, the Village of Clinton consists of one consolidated ward and the territory to be annexed shall be included in such ward; and

WHEREAS, the Village Board has determined that the annexation is in the public interest in that the Village of Clinton requires additional land suitable for business, commercial, and residential development, and annexation of the territory will enable the Village to regulate and control development in the territory; and

WHEREAS, the Plan Commission of the Village of Clinton has recommended to the Village Board that the territory be annexed and that it be assigned the temporary zoning classification of A Agricultural District;

THE VILLAGE BOARD OF THE VILLAGE OF CLINTON, ROCK COUNTY, WISCONSIN, DO ORDAIN AS FOLLOWS:

SECTION I. The territory described as follows is hereby annexed to the Village of Clinton, Rock County, Wisconsin:

Part of the N.W. $\frac{1}{4}$ of Section 17, T. 1 N., R. 14 E. of the 4th P.M., Clinton Township, Rock County, Wisconsin, described as follows:

Beginning at the West $\frac{1}{4}$ corner of Section 17, aforesaid; thence North $0^{\circ} 47' 47''$ West along the West line of the N.W. $\frac{1}{4}$, a distance of 1208.78 feet to the South right-of-way line of the Chicago and Northwestern Railroad; thence North $63^{\circ} 09' 32''$ East along said right-of-way line, 1822.35 feet; thence South $88^{\circ} 52' 36''$ East, 1003.19 feet to the North-South centerline of Section 17, said line also being the centerline of S.T.H. 140; thence South $0^{\circ} 56' 21''$ East along said line, 400.26 feet; thence North $88^{\circ} 52' 36''$ West, 1321.20 feet to the East line of the West $\frac{1}{2}$ of the N.W. $\frac{1}{4}$;

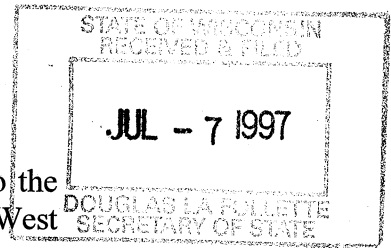

thence South 0° 52' 04" East along said line, 1663.65 feet to the East-west centerline of Section 17; thence North 88° 52' 36" West along said line, 1323.27 feet to the point of beginning.

SECTION II. Subsequent to the effective date of this ordinance, the above-described territory shall be exempt from further taxation and assessments by the Town of Clinton and henceforth shall be subject to taxation and assessments as a part of the Village of Clinton, Rock County, Wisconsin, for any and all purposes provided by law.

SECTION III. Subsequent to the effective date of this ordinance, and until a permanent zoning classification shall be assigned to the annexed territory by amendment of the Village of Clinton Zoning Ordinance, said territory shall be assigned the zoning classification of A Agricultural District.

SECTION IV. This ordinance shall take effect and be in full force from and after its passage and publication as provided by law.

IN WITNESS WHEREOF, we have hereunto set our hands and seals this 9th day of June, 1997.

Wm. Rueten
Village President

Lucy Dack
Village Clerk-Treasurer

I hereby certify that the above ordinance was adopted by the Village Board of the Village of Clinton on the 9th day of June, 1997, and that on the 3 day of July, 1997, it was published as a Class I notice, pursuant to Chapter 985, Wisconsin Statutes.

Lucy Dack
Clerk-Treasurer, Village of Clinton
Rock County, Wisconsin

Subscribed and sworn to before me
this 3rd day of July, 1997.

Leah E. Cross
Notary Public, Rock County, WI
My commission expires 5-20-01
EFFECTIVE DATE July 3, 1997

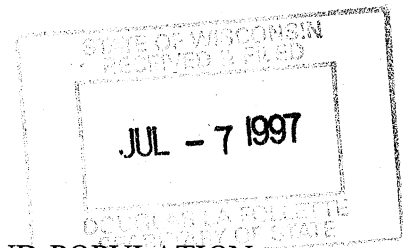

CERTIFICATION OF ANNEXATION ORDINANCE AND POPULATION

I, LUCY DACK, CLERK TREASURER FOR THE VILLAGE OF CLINTON, ROCK COUNTY, WISCONSIN, DO HEREBY CERTIFY THAT THE ATTACHED COPY IS A TRUE AND CORRECT COPY OF THE CORRESPONDING ORIGINAL ANNEXATION ORDINANCE AS THE SAME APPEARS FROM THE RECORDS AND FILES IN MY OFFICE. I FURTHER CERTIFY THAT THE POPULATION ASSOCIATED WITH THE TERRITORY ANNEXED IS ZERO AND THAT THERE ARE NO PERSONS CURRENTLY RESIDING THEREIN.

IN WITNESS WHEREOF, I HAVE HEREUNTO SET MY HAND AND CAUSED TO BE AFFIXED THE SEAL OF THE VILLAGE OF CLINTON, ROCK COUNTY, WISCONSIN.

Dated this 7th day of June, 1997.

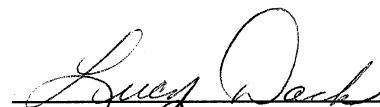

Lucy Dack, Clerk/Treasurer
Village of Clinton

FOUND BROKEN POLY-ALUMINUM
MONUMENT AT THE S. 1/4
CORNER OF SECTION 17-1-14

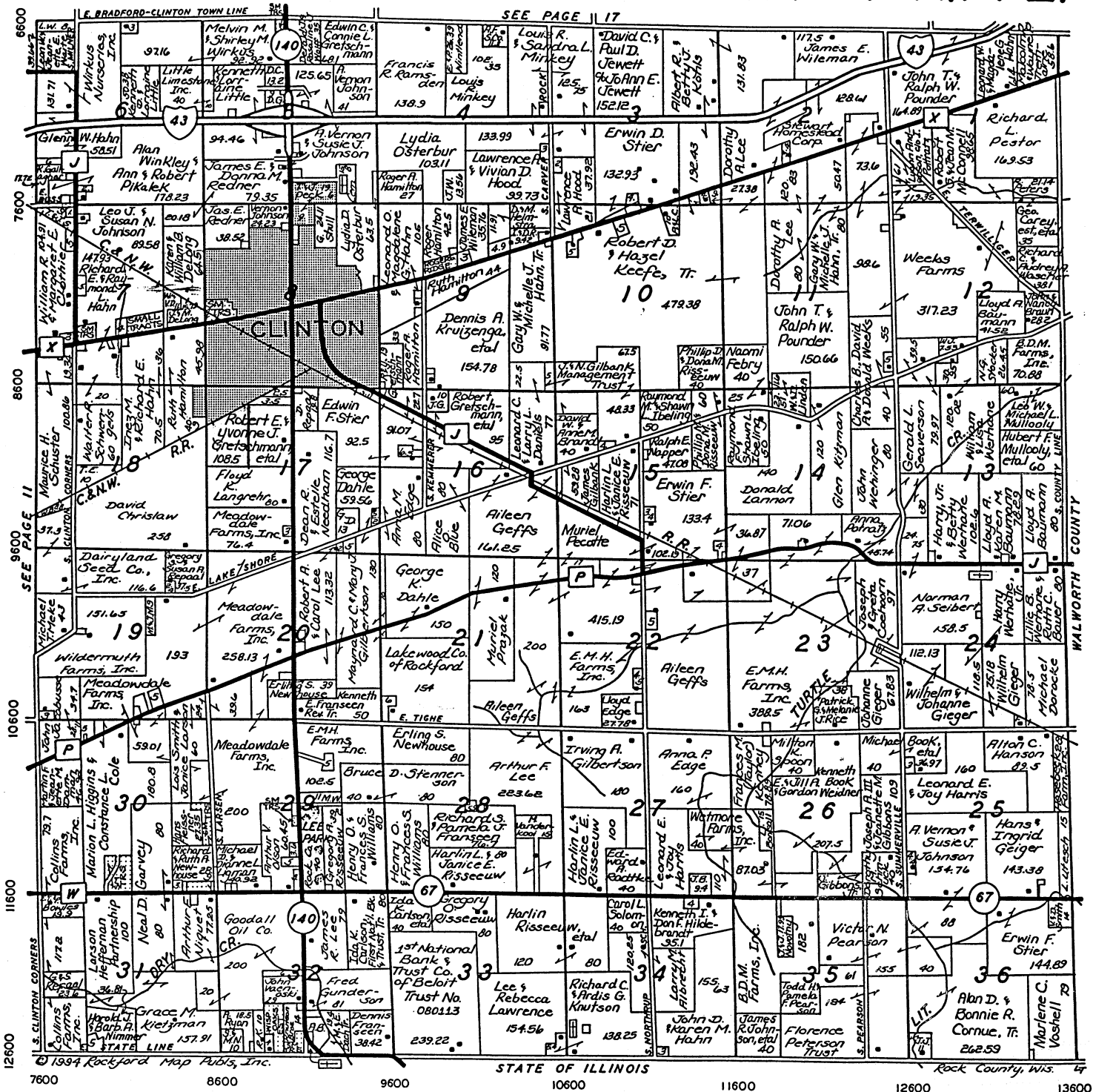

ART NIQUET REALTY

Office: (608) 756-1733 □ Home: (608) 676-4207

LARRY NIQUET

Real Estate Broker - Salesman

Specializing in Farms - Commercial Property

Real Estate of All Kinds

11025 East Townline Road
Clinton, Wisconsin 53525

1705 Highway 14 West
Janesville, Wisconsin 53545