

VILLAGE OF SHARON

COUNTY OF WALWORTH

ANNEXATION & PLAT

ORDINANCE # 3-21-94-93-20

OFFICE OF THE SECRETARY OF STATE
State of Wisconsin

FILED MAY 26, 1995

MEMORANDUM

OFFICE OF THE SECRETARY OF STATE

STATE OF WISCONSIN

Date: 5-26-95

**From: Government Records Division
Ginny Bormann, Records Specialist
30 West Mifflin Street, 10th Floor
P. O. Box 7848
Madison, WI 53707-7848**

**To: Emily Jorenby
Department of Transportation
Room 951, Hill Farm State Office Bldg.**

RE: Municipal filing distribution

Attached please find a municipal filing submitted to the Office of the Secretary of State pursuant to Chapter 66, Wis. Stats.

**cc: Frank Humphrey, Dept of Revenue
Patricia Sweet, Dept of Public Instruction
George Hall, DOA/Energy & Intergovernmental Relations
Bob Naylor, Dept of Administration
Kate Lawton, DATCP
Scott Hausmann, Dept of Natural Resources
Clerk
File**

Village of Sharon

125 Plain Street • P.O. Box 378
Sharon, Wisconsin 53585

Jimmy Quick

— (414) 736-4888 —
Fax (414) 736-4618

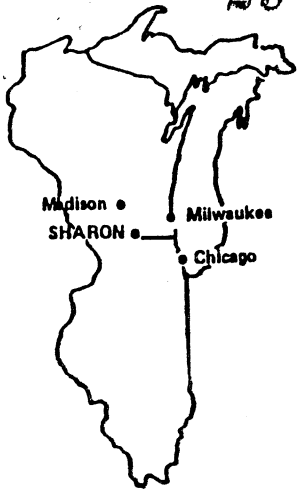

December 2, 1994

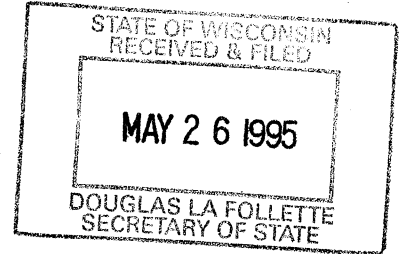

C E R T I F I C A T I O N

This is to certify this a true and exact copy of Ordinance 3-21-94-93-20 of the Village of Sharon.

Dawn E. Redenius

Dawn E. Redenius
Village Clerk-Treasurer

Subscribed and sworn to before me this 2nd day of December, 1994.

Christine M. Romenesko

Christine M. Romenesko
Notary Public
County of Walworth
State of Wisconsin

3 CS-35
RECORDED IN VOL. 633
PAGE 116

'94 DEC 5 AM 10 28

LOIS M. KETTERHAGEN
REGISTER OF DEEDS
WALWORTH COUNTY, WI

V. of Sharon
18-00

(ASSOCIATED POPULATION: 4)

CERTIFI
der

Instrument drafted by: Dawn E. Redenius

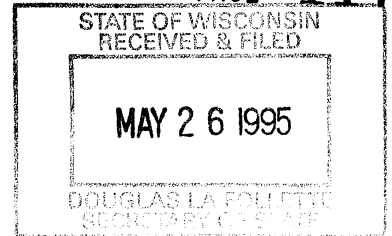

ORDINANCE NO. 3-21-94-93-20

AN ORDINANCE PROVIDING FOR DIRECT ANNEXATION OF A PORTION
OF THE TOWN OF SHARON, WALWORTH COUNTY, WISCONSIN, TO THE
VILLAGE OF SHARON, WALWORTH COUNTY, WISCONSIN

WHEREAS, on the 10th day of September, 1993, a Petition for Direct annexation of the following described territory was filed in the office of the Village Clerk of the Village of Sharon:

Lot 1 of Certified Survey Map No. 581, recorded in the office of the Register of Deeds for Walworth County, Wisconsin, on June 22, 1976 in Vol.3 of the Certified Surveys on page 35 as Document No. 04527. Said land being located in the SE $\frac{1}{4}$ of the SE $\frac{1}{4}$ of Section 28, T1N, R15E, Town of Sharon, Walworth County, Wisconsin. Tax Key No. AA 581 00001.

WHEREAS, it appears by the affidavit on file herein that the petitioner has filed a duplicate original of said Petition For Direct Annexation with the Town Clerk of the Town of Sharon, Walworth County, Wisconsin, and

WHEREAS, it further appears that the certificate of population filed by the Village Clerk indicates that there are persons residing in the territory proposed to be annexed and that all of the owners of the real property within such territory have signed said petition, and

WHEREAS, it further appears that all of the requirements of sections 66.021 (4) and (12) of the Wisconsin Statutes have been fully complied with, and

WHEREAS, it appears in the best interests of the Village of Sharon, that the aforescribed territory situated in the Town of Sharon be and the same is hereby annexed and attached to the Village of Sharon, Walworth County, Wisconsin;

THAT the said annexed territory be and the same is hereby temporarily designated as a Residential District for zoning purposes as recommended by the Village Planning Commission;

THAT the Village Clerk is hereby directed, pursuant to the provision of section 66.021 (8) (a) Wisconsin Statutes, to file immediately with the Secretary of State a certified copy of this ordinance, a certificate of population and a plat, to file one copy with each company that provides any utility service in the area annexed, to file one copy with the Register of Deeds, and to file one copy with the clerk of any affected school district. Within 30 days from the date hereof, and pursuant to section

COPY

66.03 Wisconsin Statutes, the Village Clerk is further directed to certify to the Town Clerk of the Town of Sharon a metes and bounds description of the territory herein annexed.

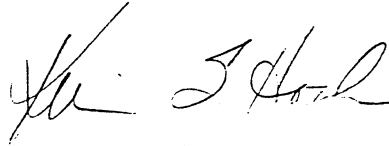

Kevin S. Hoak, Village President

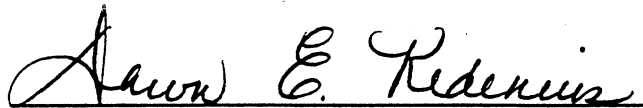

Dawn E. Redenius, Village Clerk

Adopted: 3/28/94

Published: 3/29/94

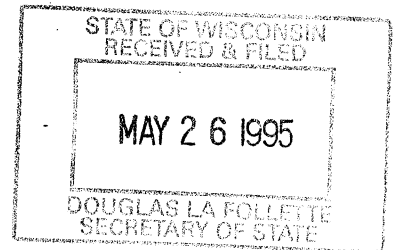

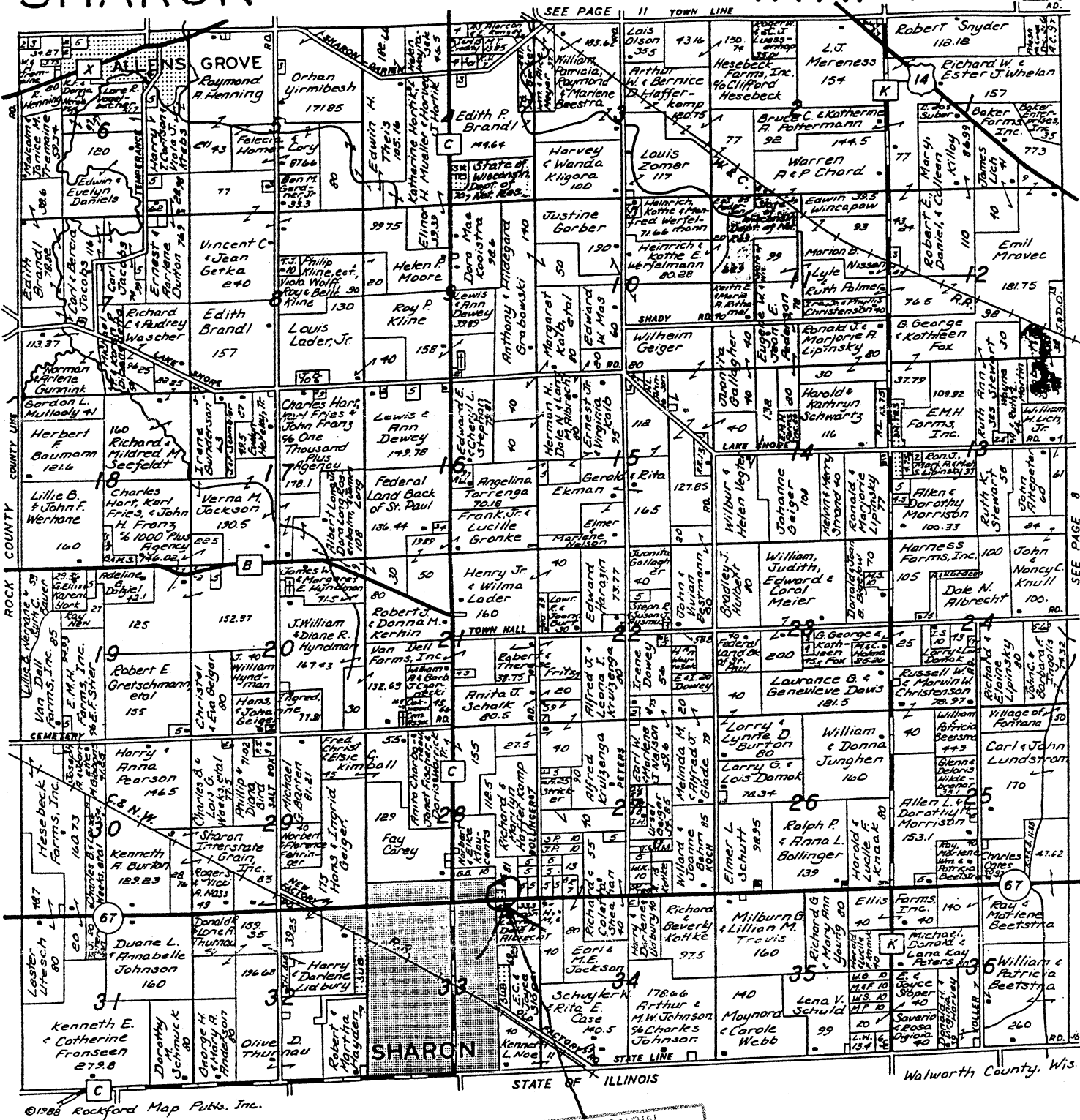

**PLEASE PATRONIZE
THE ADVERTISERS**

THEY WILL WELCOME
THE OPPORTUNITY TO SERVE YOU

BADGERLAND FARM CENTER

P.O. BOX 50, CLINTON, WISCONSIN 53525

PALMYRA CLINTON MILTON WHITEWATER
(414) 495-2187 (608) 676-4650 Mtl. (608) 868-2372 (414) 473-2410

MAY 26 1995



YOUR FULL SERVICE
FERTILIZER DEALER

- Fluid Fertilizers
- Dry Fertilizers
- Fluid High-Cal Lime
- Ag-Chemicals
- Custom Application

(800) 362-2522
ARENA, WISCONSIN

In the Matter of the Direct
Annexation of Land to the
Village of Sharon, Walworth
County, Wisconsin

PETITION FOR DIRECT
ANNEXATION

STATE OF WISCONSIN
RECEIVED & FILED

MAY 26 1995

DOUGLAS LA FOLLETTE
SECRETARY OF STATE

To: Village of Sharon
Walworth County, Wisconsin

Jimmy L. Quick and Lillian Quick hereby petition the Village of Sharon and represent as follows:

1. That petitioners Jimmy L. Quick and Lillian Quick are the owners of the following described real estate located in the Town of Sharon, Walworth County, Wisconsin.

Lot 1 of Certified Survey Map No. 581, recorded in the office of the Register of Deeds for Walworth County, Wisconsin on June 22, 1976 in Vol. 3 of Certified Surveys on page 35 as Document No. 04527. Said land being located in the SE 1/4 of the SE 1/4 of Section 28, T1N, R15E, Town of Sharon, Walworth County, Wisconsin. Tax Key No. AA 581 00001

2. That Jimmy L. Quick and Lillian Quick are the only electors residing in the territory comprised of the above described real estate;

3. That petitioners are desirous of having said real estate detached from the Town of Sharon and annexed to the Village of Sharon and the purpose of this petition is for direct annexation of the territory comprised solely of said real estate to said Village of Sharon;

4. That a scale map showing the boundaries of the above described real estate, being the territory to be annexed, and showing the relation to the municipalities involved is attached hereto and made a part hereof.

5. That the territory, comprised solely of the above described real estate, is contiguous to the Village of Sharon.

6. That the current population of the territory, comprised solely of said described land, is four, the same consisting of petitioners Jimmy L. Quick and Lillian Quick and their two children.

7. That petitioners are informed and believe that the territory comprised of said described real estate, meets all requirements for direct annexation under 66.021(2)(a)1., Wisconsin Statutes.

