

Iola

ANNEXATION & PLAT MAP

State of Wisconsin)
Department of State) ss.

Received and filed this 18th
day of ... September..... A.D. 19.75..

Douglas H. Follert
.....
Secretary of State

DE LYLE O. OMHOLT
445-3107
JAMES E. WISE, JR.
445-3508

P. O. BOX 335
IOLA, WISCONSIN 54945
TELEPHONE: AREA CODE 715
OFFICE 445-2513

September 17, 1975

Secretary of State
State Capitol
Madison, Wisconsin 53702

In re: Village of Iola annexation

Dear Sir:

Pursuant to instructions from your office I enclose herewith a certificate from the Clerk of the Town of Iola as to the population in the area to be annexed. I trust this completes the file.

Very truly yours,

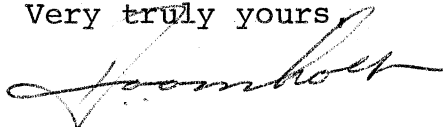

Omholz & Wise

DOO:ab

Enclosure

STATE OF WISCONSIN
DEPARTMENT OF STATE
RECEIVED AND FILED

SEP 18 1975

DOUGLAS LAFOLLETTE
SECRETARY OF STATE

DE LYLE O. OMHOLT
445-3107
JAMES E. WISE, JR.
445-3508

P. O. BOX 335
IOLA, WISCONSIN 54945
TELEPHONE: AREA CODE 715
OFFICE 445-2513

August 26, 1975

Secretary of State
State Capitol
Madison, Wisconsin 53702

Dear Sir:

Pursuant to action of the Village Board of the Village of Iola I enclose herewith one certified copy of an annexation ordinance under the direct annexation section of a parcel of land contiguous to the Village.

Very truly yours,

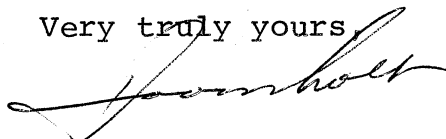

Omholt & Wise

DOO:ab

Enclosure

STATE OF WISCONSIN
DEPARTMENT OF STATE
RECEIVED AND FILED

SEP 18 1975

DOUGLAS LAFOLLETTE
SECRETARY OF STATE

An Ordinance to Annex Certain Lands
To The Village of Iola

Whereas, a petition under the provisions of S. 66.021 (12) Wisconsin Statutes, 1973 as amended, having been filed with the Village Clerk by the owners of all of the real property in assessed value within such territory, for direct annexation to the Village of certain lands therein described, and

Whereas, the Village Clerk, upon report of the Village Attorney, having certified that all requirements of the Wisconsin Statutes have been complied with, and all proper and necessary papers in connection therewith have been filed with the Village Clerk, including notices and maps to the Clerk of all municipalities affected by the proposed annexation, and the head of the planning function in the department of local affairs and development, and the Clerk of the Village of Iola having received the advice of the said head of the planning function in the department of local affairs and development and the Village Board having reviewed the same, and having found nothing adverse to said proposed annexation in said advice, and having received no petition adverse to such annexation either from the public or the municipalities affected thereby,

Now, Therefore, The Village Board for the Village of Iola do ordain as follows:

I

That the following described lands, presently in the Town of Iola, Waupaca County, Wisconsin and contiguous to the Village of Iola, and described as follows:

All that part of the Southeast 1/4 of the Southwest 1/4 of Section 36, Township 24 North, Range 11 East, lying South of State Highway 161,

be, and the same is hereby annexed to the Corporate limits of the Village of Iola.

II

That this ordinance does not affect the school district of the territory annexed.

I III

That a certified copy of this Ordinance, Certificate and scale map of the territory affected be filed with the Secretary of State of Wisconsin with the Wisconsin Power and Light Company, The

An Ordinance to Annex Certain Lands
To The Village of Iola

(Continued)

Central Wisconsin Electric Cooperative, and the Scandinavia Telephone Company, utilities serving the territory annexed, with the Register of Deeds of Waupaca County, Wisconsin, and with the Clerk of the Iola-Scandinavia Public Schools, as required by S.66.021 (8), Wisconsin Statutes, 1973, as amended.

Dated August 5, 1975.

/s/ Don Hafferman
Don Hafferman, President

PASSED:

PRESENT:

Voting for:

Voting Against:

Attest:

Ben Krause
/s/ Ben Krause
Ben Krause, Clerk

I certify that the above is a true copy of the Ordinance 5-75, to annex certain lands to the Village of Iola, and of the whole thereof adopted by the Village Board at its regular meeting on August 5, 1975.

Ben Krause
/s/ Ben Krause
Ben Krause
Village Clerk

STATE OF WISCONSIN
DEPARTMENT OF STATE
RECEIVED AND FILED

SEP 18 1975

DOUGLAS LAFOLLETTE
SECRETARY OF STATE

SEE PAGE 34

STATE OF WISCONSIN
DEPARTMENT OF STATE
RECEIVED AND FILED

SEP 18 1975

DOUGLAS LAFOLLETTE
SECRETARY OF STATE

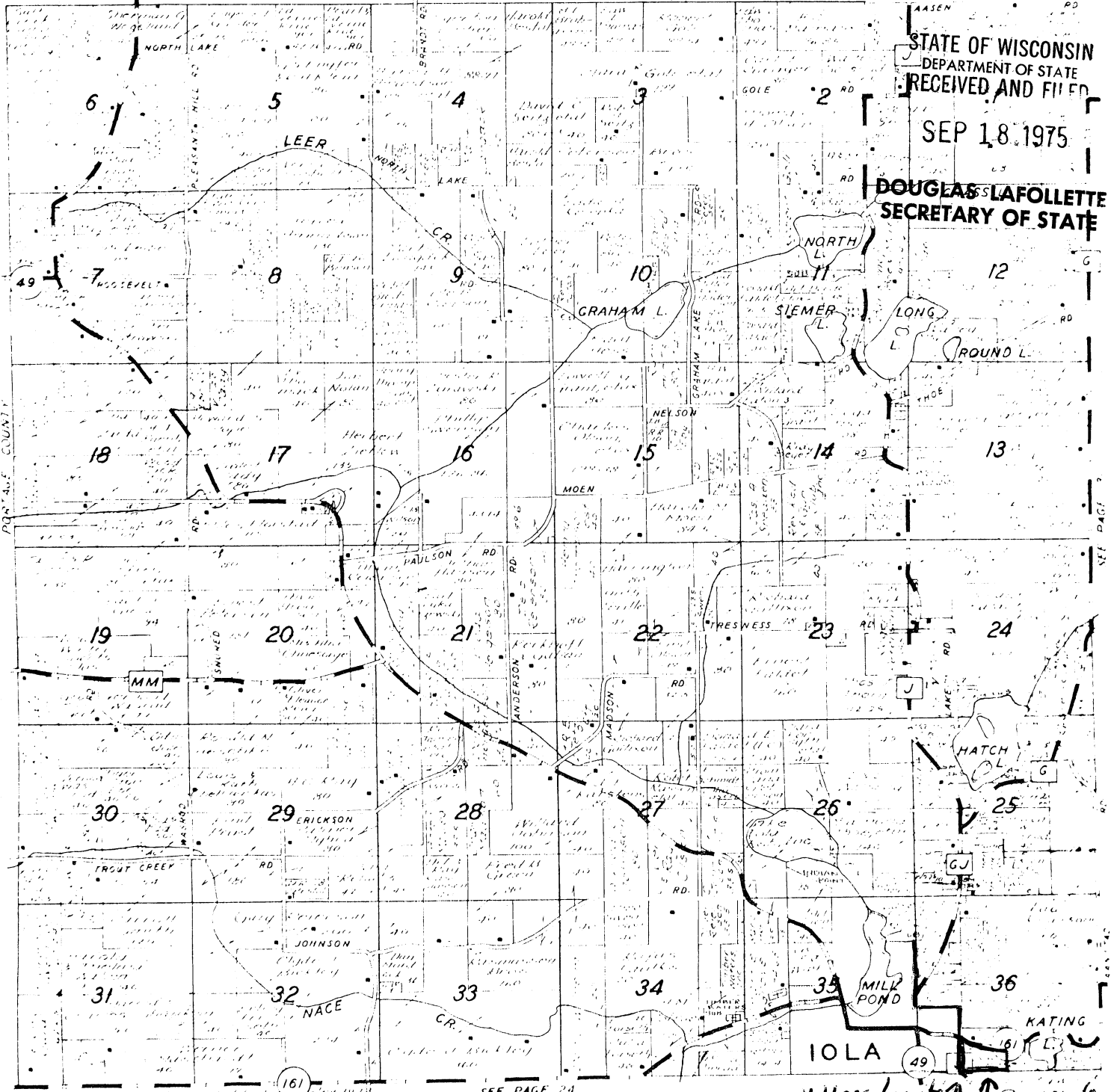

DOUGLAS COUNTY

SEE PAGE 3

SEE PAGE 24

Village Limits ↑ ↑ Parcel to BE annexed

161

49