

Bonduel

CORPORATE BOUNDARIES

State of Wisconsin)
Department of State) ss.

Received and filed this 10 th

day of January A.D. 19⁷⁷.....

Douglas McFollette
.....
Secretary of State

VILLAGE OF BONDUÉL

Shawano County

BONDUEL, WISCONSIN 54107

January 6, 1977

Mr. Doug LaFollette
Secretary of State
Room 112, West, Capitol
Madison, Wis. 53702

Dear Mr. LaFollette:

Enclosed are four copies of a map showing the corporate boundaries of the Village of Bonduel as requested in your recent letter.

The maps are current to December 1, 1976.

Sincerely yours,

Wilma D. Zernicke

Wilma D. Zernicke
Clerk

End-4

STATE OF WISCONSIN
DEPARTMENT OF STATE
RECEIVED AND FILED

JAN 10 1977

DOUGLAS LAFOLLETTE
SECRETARY OF STATE

MAP OF VILLAGE OF BONDUÉL

SHAWANO CO., WIS.

MAP PREPARED FOR VILLAGE OF BONDUÉL
BY R. W. PEDERSEN, P. E. & L. S.,
114 Circle Drive, Shawano, Wis.



SCALE 1" = 500'
0 500 1000

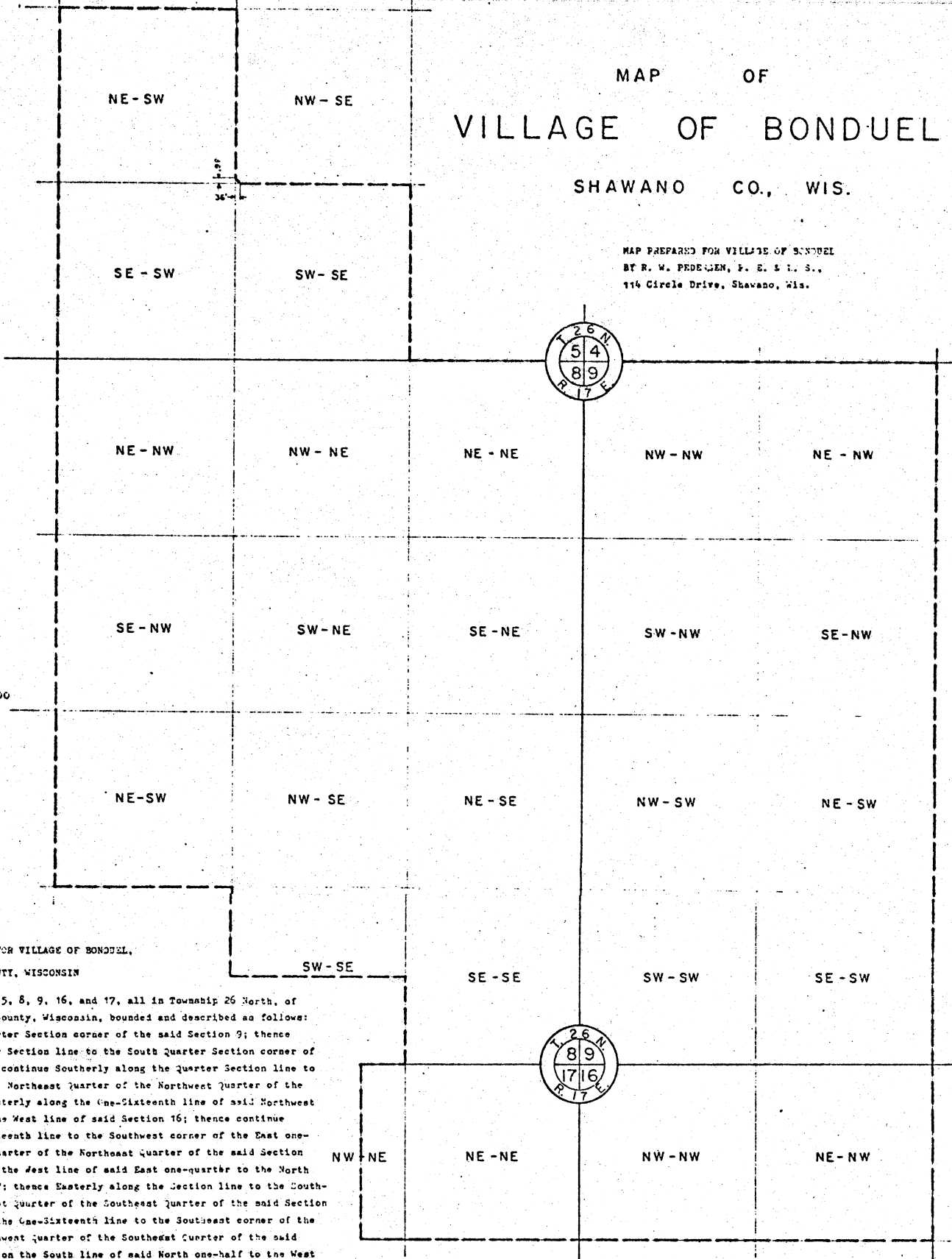

**DESCRIPTION OF BOUNDARIES FOR VILLAGE OF BONDUÉL,
SHAWANO COUNTY, WISCONSIN**

That part of Sections 5, 8, 9, 16, and 17, all in Township 26 North, of Range 17 East, in Shawano County, Wisconsin, bounded and described as follows: Beginning at the North Quarter Section corner of the said Section 9; thence Southerly along the Quarter Section line to the South Quarter Section corner of the said Section 9; thence continue Southerly along the Quarter Section line to the Southeast corner of the Northeast Quarter of the Northwest Quarter of the said Section 16; thence Westerly along the One-Sixteenth line of said Northwest quarter of Section 16 to the West line of said Section 16; thence continue Westerly along the One-Sixteenth line to the Southwest corner of the East one-quarter of the Northwest Quarter of the Northeast Quarter of the said Section 17; thence Northerly along the West line of said East one-quarter to the North line of the said Section 17; thence Easterly along the Section line to the Southwest corner of the Southeast Quarter of the Southeast Quarter of the said Section 8; thence Northerly along the One-Sixteenth line to the Southeast corner of the North one-half of the Southwest Quarter of the Southeast Quarter of the said Section 8; thence westerly on the South line of said North one-half to the West line of the Southwest Quarter of the Southeast Quarter of the said Section 8; thence Northerly on the One-Sixteenth line to the Northwest corner of the Southwest quarter of the Southeast Quarter of the said Section 8; thence Westerly on the One-Sixteenth line to the Southwest corner of the Northeast Quarter of the Southwest Quarter of the said Section 8; thence Northerly along the One-Sixteenth line to the North line of the said Section 8; thence continue Northerly along the One-Sixteenth line to the Northwest corner of the Northeast Quarter of the Southwest Quarter of the said Section 5; thence Easterly along the One-Sixteenth line to the Northeast corner of the Northeast Quarter of the Southwest Quarter of the said Section 5; thence Southerly along the One-Sixteenth line to a point 36 feet Northerly of the Southeast corner of the Northeast Quarter of the Southwest quarter of the said Section 5; thence Southeasterly to a point 36 feet Easterly of the Southwest corner of the Northwest Quarter of the Southeast Quarter of the said Section 5; thence Westerly along the One-Sixteenth line to the Northeast corner of the Southwest Quarter of the Southeast Quarter of the said Section 5; thence Southerly along the One-Sixteenth line to the South line of the said Section 5; thence Easterly along the North line of said Section 5 and 6 to the place of beginning.

STATE OF WISCONSIN
DEPARTMENT OF STATE
RECEIVED AND FILED

JAN 10 1977

DOUGLAS LAFOLLETTE
SECRETARY OF STATE

I, Wilma Zernicke, Village Clerk of the Village of Bonduel, Shawano County, State of Wisconsin, do hereby certify that the corporate boundaries of the said Village of Bonduel have been altered within the previous 12-month period ending December 1, 1976, and that the foregoing description is the present corporate limits of the said Village of Bonduel as of December 1, 1976.

Date: Jan 4, 1977

Wilma Zernicke
Wilma Zernicke, Village Clerk

MAP OF VILLAGE OF BONDUEL

SHAWANO CO., WIS.

MAP PREPARED FOR VILLAGE OF BONDUEL
BY R. W. PEDERSEN, P. E. & L. S.,
114 Circle Drive, Shawano, Wis.

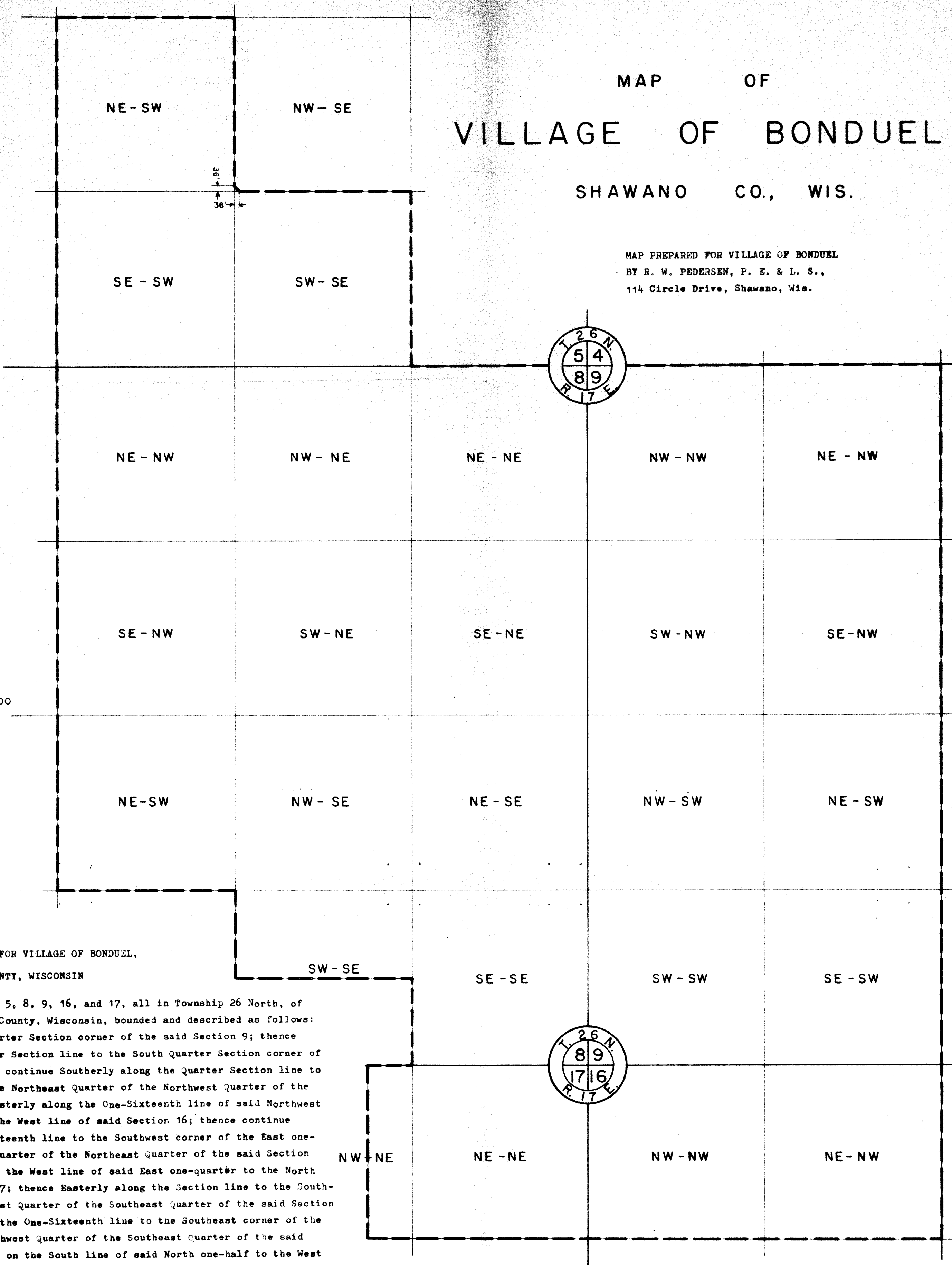
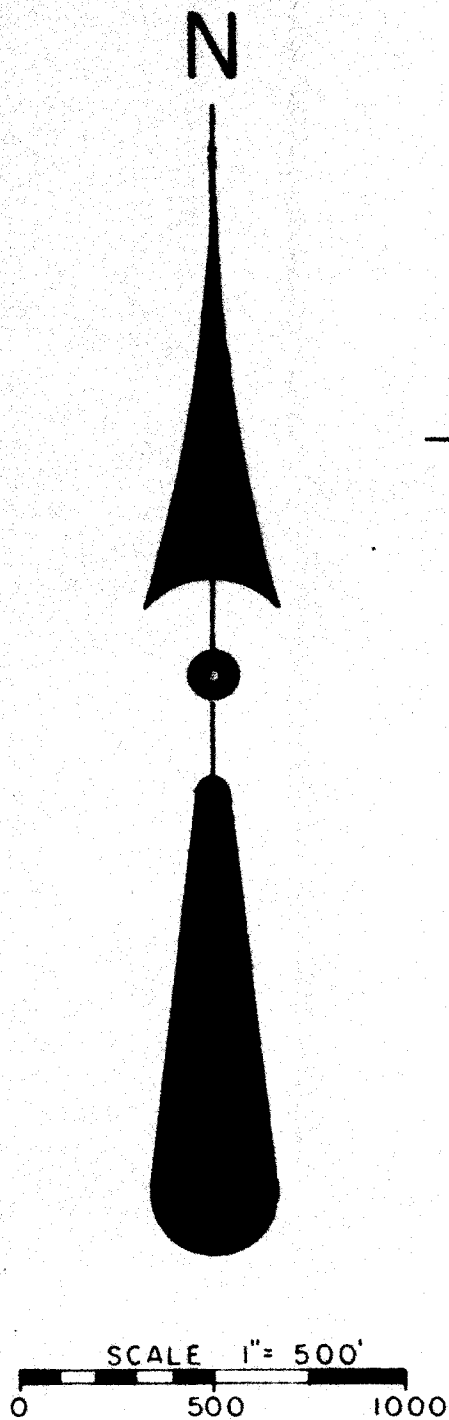

**DESCRIPTION OF BOUNDARIES FOR VILLAGE OF BONDUEL,
SHAWANO COUNTY, WISCONSIN**

That part of Sections 5, 8, 9, 16, and 17, all in Township 26 North, of Range 17 East, in Shawano County, Wisconsin, bounded and described as follows: Beginning at the North Quarter Section corner of the said Section 9; thence Southerly along the Quarter Section line to the South Quarter Section corner of the said Section 9; thence continue Southerly along the Quarter Section line to the Southeast corner of the Northeast Quarter of the said Section 16; thence Westerly along the One-Sixteenth line of said Northwest Quarter of Section 16 to the West line of said Section 16; thence continue Westerly along the One-Sixteenth line to the Southwest corner of the East one-quarter of the Northwest Quarter of the Northeast Quarter of the said Section 17; thence Northerly along the West line of said East one-quarter to the North line of the said Section 17; thence Easterly along the Section line to the Southwest corner of the Southeast Quarter of the Southeast Quarter of the said Section 8; thence Northerly along the One-Sixteenth line to the Southeast corner of the North one-half of the Southwest Quarter of the Southeast Quarter of the said Section 8; thence Westerly on the South line of said North one-half to the West line of the Southwest Quarter of the Southeast Quarter of the said Section 8; thence Northerly on the One-Sixteenth line to the Northwest corner of the Southwest Quarter of the Southeast Quarter of the said Section 8; thence Westerly on the One-Sixteenth line to the Southwest corner of the Northeast Quarter of the Southwest Quarter of the said Section 8; thence Northerly along the One-Sixteenth line to the North line of the said Section 8; thence continue Northerly along the One-Sixteenth line to the Northwest corner of the Northeast Quarter of the Southwest Quarter of the said Section 5; thence Easterly along the One-Sixteenth line to the Northeast corner of the Northeast Quarter of the Southwest Quarter of the said Section 5; thence Southerly along the One-Sixteenth line to a point 36 feet Northerly of the Southeast corner of the Northeast Quarter of the Southwest Quarter of the said Section 5; thence Southeasterly to a point 36 feet Easterly of the Southwest corner of the Northwest Quarter of the Southeast Quarter of the said Section 5; thence Easterly along the One-Sixteenth line to the Northeast corner of the Southwest Quarter of the Southeast Quarter of the said Section 5; thence Southerly along the One-Sixteenth line to the South line of the said Section 5; thence Easterly along the North line of said Sections 8 and 9 to the place of beginning.

I, Wilma Zernicke, Village Clerk of the Village of Bonduel, Shawano County, State of Wisconsin, do hereby certify that the corporate boundaries of the said Village of Bonduel have been altered within the previous 12-month period ending December 1, 1976, and that the foregoing description is the present corporate limits of the said Village of Bonduel as of December 1, 1976.

Date: Jan 6, 1977

Wilma Zernicke
Wilma Zernicke, Village Clerk

STATE OF WISCONSIN
DEPARTMENT OF STATE
RECEIVED AND FILED

JAN 10 1977

DOUGLAS LAFOLLETTE
SECRETARY OF STATE