

Mishicot

CORPORATE LIMITS

State of Wisconsin)
Department of State) ss.

Received and filed this 20th
day of December A.D. 19⁷².....

Paul Zimmerman
.....
Secretary of State

SPEED LETTER.

VILLAGE CLERK OFFICE

TO Robert C. Zimmerman
Secretary of State
State Capital
Madison, Wisconsin 53702

FROM _____

Village of Mishicot

Mishicot, Wis. 54228

SUBJECT Corporate boundaries

— NO. 9 & 10 FOLD

MESSAGE

DATE December 16 19 72

Enclosed, required four certified copies of corporate boundaries
 and plat maps of the Village of Mishicot.

Wm. A. Bergelin
 Mishicot Village Clerk

SIGNED _____

Wm A Bergelin

DATE _____ 19 _____

REPLY

*Received 4 certified copies
 of Corporate boundaries*

STATE OF WISCONSIN
 DEPARTMENT OF STATE
 RECEIVED AND FILED

DEC 20 1972

ROBERT C. ZIMMERMAN
 SECRETARY OF STATE

— NO. 9 FOLD

— NO. 10 FOLD

SIGNED _____

Village of Mishicot

Incorporated 1950

Manitowoc County

Mishicot, Wisconsin 54228

I, Wm. A. Bergelin, Village Clerk of the Village of Mishicot, County of Manitowoc, State of Wisconsin, DO HEREBY CERTIFY that the corporate boundaries of the said Village have been altered within the previous 12-month period ending December 1, 1971, and that the following description is the present corporate limits of the said Village as of December 1, 1972.

Dated: December 16 1972.



Wm. A. Bergelin
Mishicot Village Clerk

STATE OF WISCONSIN
DEPARTMENT OF STATE
RECEIVED AND FILED

DEC 20 1972

ROBERT C. ZIMMERMAN
SECRETARY OF STATE

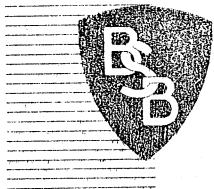

BREY, STUEWE & BRAUN, INC.

Consulting Engineers & Surveyors

MANITOWOC, WISCONSIN

December 8, 1972

STATE OF WISCONSIN
DEPARTMENT OF STATE
RECEIVED AND FILED

DEC 20 1972

429 NO. 9th STREET
MANITOWOC, WIS. 54220
Telephone 684-9046

Total Boundary Description
Village of Mishicot

ROBERT C. ZIMMERMAN
SECRETARY OF STATE

The boundaries of the Village of Mishicot which is located in Sections 4, 5 and 9 of T. 20 N., R. 24 E. and in Section 36, T. 21 N., R. 23 E., and in Section 31, T. 21 N., R. 24 E., Manitowoc County, Wisconsin are described as follows:

Commencing at the Northwest corner of said Section 9, thence West along the Section line a distance of 1324.7 feet more or less to the centerline of C.T.H. "B", the point of real beginning, thence S. $88^{\circ} 55' 30''$ W. along the south line of Section 5 a distance of 1311.85 feet to the $S\frac{1}{4}$ corner of Section 5; thence westerly along the south line of Section 5 a distance of 1311.5 feet to the west line of the $E\frac{1}{2}$ of the $SW\frac{1}{4}$ of said Section 5, thence northerly along said west line a distance of 2354.16 feet more or less, thence easterly and parallel with the centerline of County Trunk Highway "V" a distance of 600 feet, thence north and parallel with the west line of the $E\frac{1}{2}$ of the $SW\frac{1}{4}$ of Section 5 a distance of 330 feet more or less to the $\frac{1}{4}$ section line of Section 5; thence S. $89^{\circ} 50' E.$ along the $\frac{1}{4}$ section line a distance of 275 feet more or less to the west line of the east $1/3$ of the $SE\frac{1}{4}$ of the $NW\frac{1}{4}$ of Section 5; thence N. $0^{\circ} 5' 30'' E.$ along said west line a distance of 165.0 feet; thence S. $89^{\circ} 50' E.$ parallel with the $\frac{1}{4}$ section line a distance of 1757 feet



more or less to the centerline of County Trunk Highway "B"; thence N. $0^{\circ} 42' E.$ along said centerline a distance of 2471.5 feet to the north line of T. 20 N., thence N. $89^{\circ} 34' 15'' W.$ along said township line a distance of 636.6 feet to the high water mark of the Mishicot River, thence N. $29^{\circ} 26' 45'' W.$ along said high water line a distance of 315.2 feet, thence N. $66^{\circ} 32' 45'' W.$ along said high water line a distance of 536.4 feet, thence N. $1^{\circ} 21' 15'' E.$ a distance of 608.0 feet, thence N. $60^{\circ} 01' 15'' W.$ a distance of 176.0 feet, thence N. $36^{\circ} 12' 45'' E.$ a distance of 158.5 feet to the centerline of S.T.H. 147, thence S. $58^{\circ} 31' E.$ along said centerline a distance of 24.0 feet, thence N. $23^{\circ} 37' 45'' E.$ a distance of 229.3 feet, thence S. $56^{\circ} 08' 15'' E.$ a distance of 198.0 feet, thence S. $21^{\circ} 21' 45'' W.$ a distance of 71.0 feet to the north line of the $SE\frac{1}{4}$ of the $SE\frac{1}{4}$ of Section 36, thence N. $89^{\circ} 22' 45'' E.$ along said North line a distance of 1267.9 feet to the centerline of S.T.H. 163, thence N. $89^{\circ} 55' E.$ a distance of 708.55 feet, thence S. $0^{\circ} 55' 30'' E.$ a distance of 655.5 feet, thence N. $89^{\circ} 47' 30'' E.$ a distance of 704 feet to the East line of the $SW\frac{1}{4}$ of the $SW\frac{1}{4}$ of Section 31, thence N. $89^{\circ} 52' 30'' E.$ a distance of 1311.0 feet, thence S. $0^{\circ} 12' E.$ a distance of 320.0 feet, thence N. $89^{\circ} 37' E.$ a distance of 1318.4 feet, thence S. $0^{\circ} 05' 30'' E.$ a distance of 340.0 feet to the centerline of C.T.H. "V", thence N. $89^{\circ} 34' E.$ along said centerline of C.T.H. "V" a distance of 89.2 feet, thence S. $0^{\circ} 19' W.$ a distance of 208.7 feet, thence N. $89^{\circ} 34' E.$ a distance of 202.4 feet, thence S. $0^{\circ} 19' W.$ a distance of 1097.19 feet to the south line of the $NW\frac{1}{4}$ of the $NE\frac{1}{4}$ of Section 4, thence S. $89^{\circ} 51' W.$ along said South line a distance of 625 feet more or less to the centerline of the Mishicot River,

thence southeasterly and southerly along the centerline of said Mishicot River a distance of 8700 feet more or less to its intersection with the south line of the NE $\frac{1}{4}$ of Section 9, thence west along said south line of the NE $\frac{1}{4}$ a distance of 710 feet more or less to the northeast corner of the NW $\frac{1}{4}$ of the SE $\frac{1}{4}$ of said Section 9, thence S. 1° 23' 45" E. a distance of 461.96 feet, thence S. 39° 26' 45" E. a distance of 388.60 feet, thence S. 50° 33' 15" W. a distance of 183.0 feet to the centerline of S.T.H. 147, thence northwesterly along said centerline of S.T.H. 147 a distance of 817.07 feet, thence S. 56° 30' W. a distance of 176.95 feet, thence N. 34° 15' W. a distance of 155.0 feet, thence N. 56° 51' E. a distance of 197.0 feet to the centerline of S.T.H. 147, thence N. 24° 30' 15" W. along said centerline a distance of 82.0 feet to the north line of the SE $\frac{1}{4}$ of said Section 9, said point being 3435.5 feet N. 89° 28' E. of the west $\frac{1}{4}$ corner of said Section 9, thence S. 89° 28' W. a distance of 795 feet more or less to the center of said Section 9, thence north along the north-south $\frac{1}{4}$ section line a distance of 1320 feet more or less to the southeast corner of the NE $\frac{1}{4}$ of the NW $\frac{1}{4}$ of said Section 9, thence west along the south line of said NE $\frac{1}{4}$ of the NW $\frac{1}{4}$ a distance of 1320 feet more or less to the northeast corner of the SW $\frac{1}{4}$ of the NW $\frac{1}{4}$ of said Section 9, thence south along the east line of said SW $\frac{1}{4}$ of the NW $\frac{1}{4}$ a distance of 1320 feet more or less to the southeast corner of the SW $\frac{1}{4}$ of the NW $\frac{1}{4}$, thence west along the east-west $\frac{1}{4}$ section line a distance of 2640 feet more or less to the centerline of C.T.H. "B" thence N. 0° 05' W. along said centerline of C.T.H. "B" a distance of 2640 feet more or less to the point of real beginning.

Said tract contains 1228 acres of land more or less.

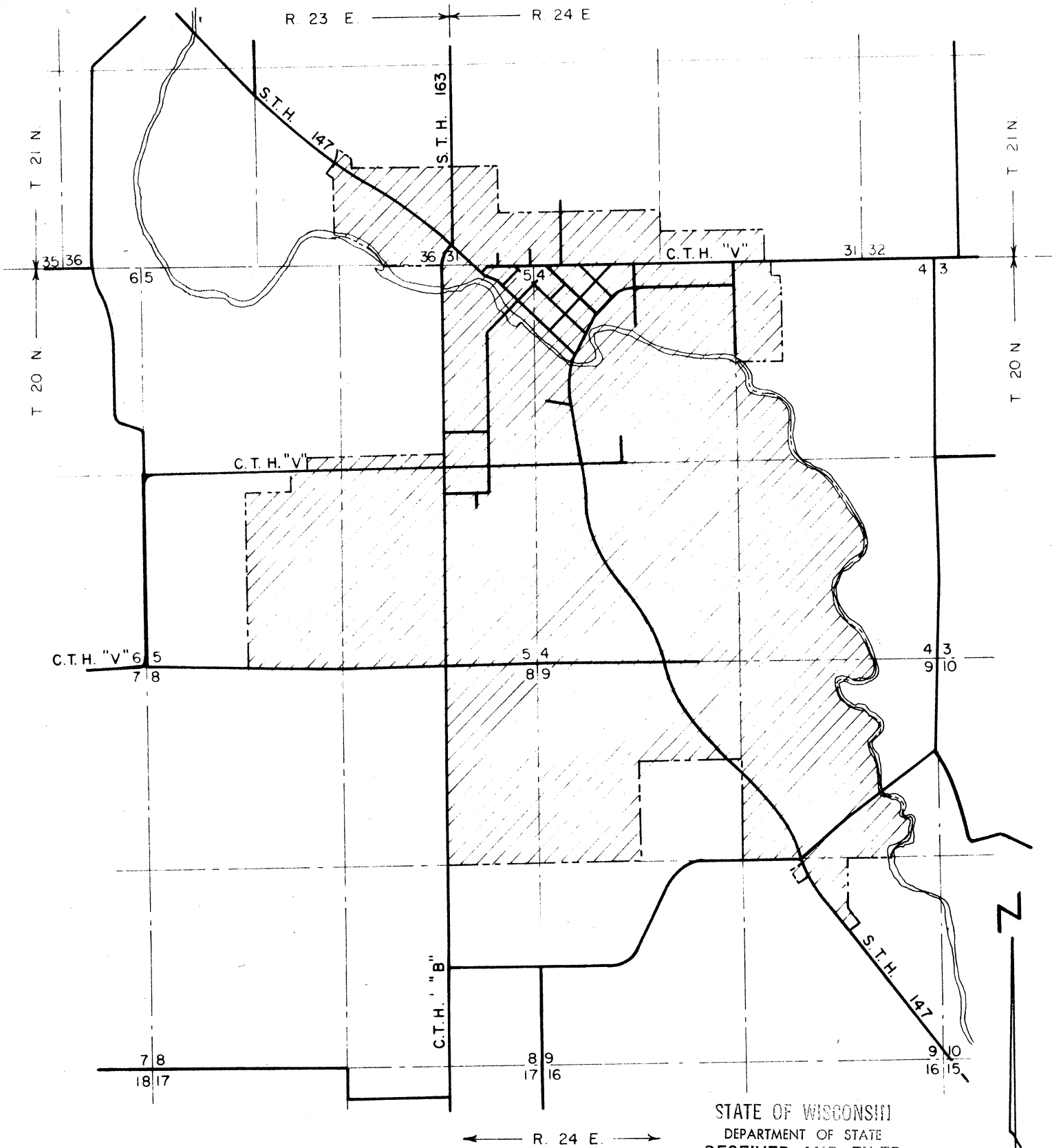

BREY, STUEWE & BRAUN INCORPORATED
CONSULTING ENGINEERS AND SURVEYORS
429 N. 9TH ST. MANITOWOC, WISCONSIN

STATE OF WISCONSIN
DEPARTMENT OF STATE
RECEIVED AND FILED

DEC 20 1972

NO SCALE

ROBERT C. ZIMMERMAN
SECRETARY OF STATE

CORPORATE LIMITS

VILLAGE OF MISHICOT

MANITOWOC COUNTY, WISCONSIN