

Kellnersville
Manitowoc County

ANNEXATION OF TERRITORY

State of Wisconsin)
Department of State) ss.

Received and filed this

day of August A.D. 19⁷⁶.....

Douglas H. Follette

.....
Secretary of State

To: Secretary of State

Re: Population of Annexed area

This memo is to certify that the population of the area annexed to the village is 0. No people resideing within its boundaries.

Thank you.

VILLAGE OF KELLNERSVILLE

Ronald B. Muench
By: Ronald B. Muench, Village Clerk

CERTIFICATE OF ANNEXATION

I, Ronald Muench, Village Clerk of the Village of Kellnersville, County of Manitowoc, State of Wisconsin, do hereby certify that the following described territory was detached from the Town of Kossuth, County of Manitowoc, and was annexed to the said Village of Kellnersville, pursuant to Section 66.021 of the Wisconsin Statutes, by an Ordinance adopted by the Village Board at a regular meeting held August 2, 1976:

The South Half of the Northeast Quarter of the Northwest Quarter (S $\frac{1}{2}$ NE $\frac{1}{4}$ NW $\frac{1}{4}$) of Section Seven (7), Township Twenty (20) North, Range Twenty-three (23) East.

Dated August 2, 1976.

Ronald B. Muench
Village Clerk

I, Ronald Muench, Village Clerk of the Village of Kellnersville, Manitowoc Co., WI hereby certify that the above Certificate of Annexation is a true and correct copy of the original on file in my office.

Ronald B. Muench
Village Clerk

(Seal)

ORDINANCE ANNEXING TERRITORY TO THE VILLAGE
OF KELLNERSVILLE, WISCONSIN.

The Village Board of the Village of Kellnersville, Wisconsin,
does ordain as follows:

SECTION 1. Territory Annexed. In accordance with Section 66.021 of the Wisconsin Statutes and the petition for direct annexation including the scale map and description of the territory proposed to be annexed filed with the Village Clerk on the 7th day of June, 1976, signed by all of the owners of the land in the area, said territory having no electors residing within its boundaries, the following described territory in the Town of Kossuth, Manitowoc County, Wisconsin, is annexed to the Village of Kellnersville, Wisconsin:

The South Half of the Northeast Quarter of the Northwest Quarter (S $\frac{1}{2}$ NE $\frac{1}{4}$ NW $\frac{1}{4}$) of Section Seven (7), Township Twenty (20) North, Range Twenty-three (23) East.

SECTION 2. Effect of Annexation. From and after the date of this ordinance the territory described in Section 1 shall be a part of the Village of Kellnersville for any and all purposes provided by law and all persons coming or residing within such territory shall be subject to all ordinances, rules and regulations governing the Village of Kellnersville.

SECTION 3. That more than twenty days have elapsed since service of notice on the Head of Planning Function, Department of Local Affairs and Development, and that no notice or reply has been received from said Department.

SECTION 4. Schools. That said territory is within the Reedsville School District (formerly Joint School District #1, Villages of Reedsville, Kellnersville, Towns of Cato, Cooperstown, Franklin, Kossuth, Maple Grove, Rockland, Manitowoc County; also Town of Morrison, Brown County).

SECTION 5. Severability. If any provision of this ordinance

is invalid or unconstitutional, or if the application of this ordinance to any person or circumstances is invalid or unconstitutional, such invalidity or unconstitutionality shall not affect the other provisions or applications of this ordinance which can be given effect without the invalid or unconstitutional provision or application.

Dated: August 2, 1976.

John E. Deets
Village President

Attest:

Ronald B. Muench
Village Clerk

I, Ronald Muench, Village Clerk of the Village of Kellnersville, Manitowoc Co., WI, hereby certify that the above Ordinance is a true and correct copy of the original on file in my office.

Ronald B. Muench
Village Clerk

(Seal)

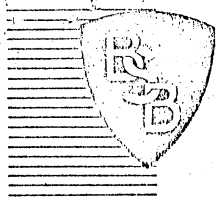

BREY, STUEWE & BRAUN, INC.

Consulting Engineers & Surveyors

MANITOWOC, WISCONSIN

January 8, 1976

429 NO. 9th STREET
MANITOWOC, WIS. 54220
Telephone 684-5583

Attorney Vic Miller
107 West Main St.
St. Nazianz, Wis.

Re: Kellnersville Annexation
Boundry Description

Dear Vic,

Enclosed is a boundry description of Kellnersville as requested 1/6/76. I wonder if the SE $\frac{1}{4}$ of the NW $\frac{1}{4}$ of the NW $\frac{1}{4}$ belonging to George Muench shouldn't be added to square things off more.

Very Truly Yours

Burlyn H. Stuewe

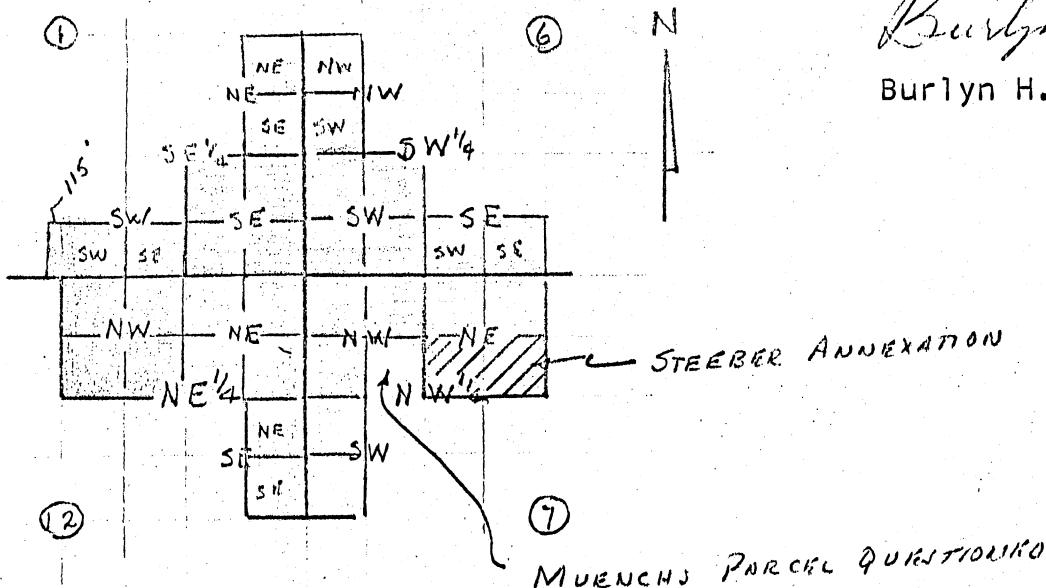

KELLNERSVILLE

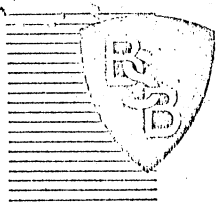

BREY, STUEWE & BRAUN, INC.

Consulting Engineers & Surveyors

MANITOWOC, WISCONSIN

January 8, 1976

429 NO. 9th STREET
MANITOWOC, WIS. 54220
Telephone 684-5583

Village of Kellnersville Description

The incorporated Village of Kellnersville is located in the Townships of Franklin and Kossuth, Manitowoc County, with the following described limits:

The NE $\frac{1}{4}$ of the NE $\frac{1}{4}$ of the SE $\frac{1}{4}$ - 10 acres
The SE $\frac{1}{4}$ of the NE $\frac{1}{4}$ of the SE $\frac{1}{4}$ - 10 acres
The SE $\frac{1}{4}$ of the SE $\frac{1}{4}$ - 40 acres
The SW $\frac{1}{4}$ of the SW $\frac{1}{4}$ of the SE $\frac{1}{4}$ - 10 acres
The SE $\frac{1}{4}$ of the SW $\frac{1}{4}$ of the SE $\frac{1}{4}$ - 10 acres
The East 115.5 feet of the SE $\frac{1}{4}$ of the SE $\frac{1}{4}$ of the SW $\frac{1}{4}$ - 1.75 acres
All in Section 1, T. 20 N., R. 22 E. (Town of Franklin)

The NE $\frac{1}{4}$ of the NE $\frac{1}{4}$ - 40 acres
The NW $\frac{1}{4}$ of the NE $\frac{1}{4}$ - 40 acres
The NE $\frac{1}{4}$ of the SE $\frac{1}{4}$ of the NE $\frac{1}{4}$ - 10 acres
The SE $\frac{1}{4}$ of the SE $\frac{1}{4}$ of the NE $\frac{1}{4}$ - 10 acres
All in Section 12, T. 20 N., R. 22 E. (Town of Franklin)

The NW $\frac{1}{4}$ of the NW $\frac{1}{4}$ of the SW $\frac{1}{4}$ - 10 acres
The SW $\frac{1}{4}$ of the NW $\frac{1}{4}$ of the SW $\frac{1}{4}$ - 10 acres
The SW $\frac{1}{4}$ of the SW $\frac{1}{4}$ - 40 acres
The SW $\frac{1}{4}$ of the SE $\frac{1}{4}$ of the SW $\frac{1}{4}$ - 10 acres
The SE $\frac{1}{4}$ of the SE $\frac{1}{4}$ of the SW $\frac{1}{4}$ - 10 acres
All in Section 6, T. 20 N., R. 23 E. (Town of Kossuth)

The NE $\frac{1}{4}$ of the NW $\frac{1}{4}$ - 40 acres
The NE $\frac{1}{4}$ of the NW $\frac{1}{4}$ of the NW $\frac{1}{4}$ - 10 acres
The NW $\frac{1}{4}$ of the NW $\frac{1}{4}$ of the NW $\frac{1}{4}$ - 10 acres
The SW $\frac{1}{4}$ of the NW $\frac{1}{4}$ of the NW $\frac{1}{4}$ - 10 acres
The NW $\frac{1}{4}$ of the SW $\frac{1}{4}$ of the NW $\frac{1}{4}$ - 10 acres
The SW $\frac{1}{4}$ of the SW $\frac{1}{4}$ of the NW $\frac{1}{4}$ - 10 acres
All in Section 7, T. 20 N., R. 23 E. (Town of Kossuth)

Said tract contains 351.75 acres more or less.