

CITY OF CHIPPEWA FALLS

COUNTY OF CHIPPEWA

Annexation and Plat Map

OFFICE OF THE SECRETARY OF STATE
State of Wisconsin

Filed: March 12, 1991

CORRESPONDENCE/MEMORANDUM

STATE OF WISCONSIN

Date: *March 12, 1991*File Ref: *42*

To: John Pamperin
Department of Transportation
Room 951, Hill Farm State Office Bldg.

From: Secretary of State's Office
Teresa J. Walker
Government Records Division

Subject: Municipal filings re: Chapter 66, Wis. Stats.

Enclosed please find the following:

- ☒ Annexation
☐ Detachment
☐ Notice of Litigation
☐ Other: _____

City/Village of: *Chippewa Falls*
County of: *Chippewa*
Land from Town/Village of: *Hallie*
Ordinance #: *91-6*
Adoption date: *March 5, 1991*
Population: *0*

If you have any questions, please contact our office.

cc: Depts. of: Administration
Development
Public Instruction
Revenue

Clerk
File



City of Chippewa Falls

30 WEST CENTRAL STREET, CHIPPEWA FALLS, WISCONSIN 54729

March 6, 1991

I, Lucyann LeCleir, Clerk of the City of Chippewa Falls, Chippewa County, Wisconsin, DO HEREBY CERTIFY that the following described territory was detached from the Town of Hallie, Chippewa County and was annexed to the City of Chippewa Falls - a parcel of land located in the Town of Hallie in the SE $\frac{1}{4}$ -NE $\frac{1}{4}$ -NE $\frac{1}{4}$ of Sec.18, T28N, R8W, Lots 1 and 2, Block 1, Loffler's Third Addn. to the Town of Hallie, Chippewa County, Wisconsin, pursuant to Sec.66.021 of the Wisconsin Statutes.

Ordinance 91-6 was adopted by a unanimous vote of the Common Council at a Regular Meeting held on March 5, 1991.

Said population of said territory is zero. The attached is a true and complete copy of said Ordinance as adopted.

Lucyann LeCleir
City Clerk
City of Chippewa Falls, Wi.

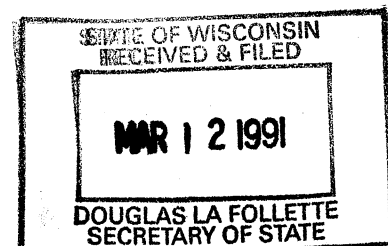

AN ORDINANCE ANNEXING TERRITORY TO THE CITY
OF CHIPPEWA FALLS, WISCONSIN

THE COMMON COUNCIL OF THE CITY OF CHIPPEWA FALLS, WISCONSIN, DO ORDAIN
AS FOLLOWS:

SECTION 1. Territory Annexed. In accordance with S. 66.021, Wisconsin Statutes, and the Petition for Direct Annexation filed with the City Clerk on the 9th day of January 1991, signed by the owners of all of the real property in the territory, the following described territory in the Town of Hallie, Chippewa County, Wisconsin, which is shown on the attached map, is annexed to the City of Chippewa Falls, Wisconsin:

A parcel of land presently located in the Town of Hallie, Chippewa County, Wisconsin, and located in the SE 1/4 of the NE 1/4 of the NE 1/4 of Section 18, Township 28 North, Range 8 West, and more particularly described as follows:

Lots 1 and 2 of Block 1, Loffler's Third Addition to the Town of Hallie, Chippewa County, Wisconsin.

SECTION 2. Effect of Annexation. From and after the date of this Ordinance the territory described in Section 1 shall be a part of the City of Chippewa Falls for any and all purposes provided by law and all persons coming or residing within such territory shall be subject to all Ordinances, rules and regulations governing the City of Chippewa Falls.

SECTION 3. Temporary Zoning Classification. Upon recommendation of the Plan Commission the territory annexed to the City of Chippewa Falls by this Ordinance is temporarily designated to be part of the following districts of the City for zoning purposes and subject to all provisions of Zoning Ordinances of the City of Chippewa Falls: C-2 General Commercial District.

SECTION 4. Ward Designation. The territory described in Section 1 of this Ordinance is hereby made a part of the 6th Ward of the City of Chippewa Falls, subject to the Ordinances, rules and regulations of the City governing Wards.

SECTION 5. Severability. If any provision of this Ordinance is invalid or unconstitutional, or if the application of this Ordinance to any person or circumstances is invalid or unconstitutional, such invalidity or unconstitutionality shall not affect the other provisions or applications of this Ordinance which can be given effect without the invalid or unconstitutional provision or application.

SECTION 6. Effective Date. This Ordinance shall take effect upon passage as provided by law.

Dated this 5th day of March, 1991.

FIRST READING: March 5, 1991

SECOND READING: March 5, 1991

ADOPTED: March 5, 1991

APPROVED: Bernard F. Ulli
Mayor

ATTEST: Lucyann L. Lohr
City Clerk

Arthur L. Mangler
Alderman

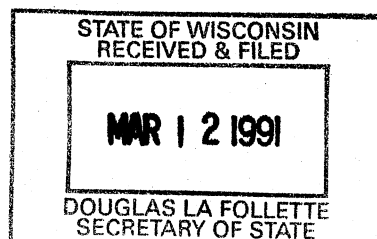

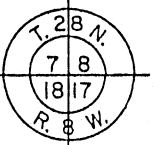

SOUTH AVE.

TOWN OF HALLIE

CITY LIMITS

STATE OF WISCONSIN
RECEIVED & FILED
MAR 12 1991
DOUGLAS LA FOLLETTE
SECRETARY OF STATE

U.S. HIGHWAY 124

PRAIRIE VIEW RD.

WOODWARD AVE.

CITY LIMITS

TOWN OF HALLIE

GERALD ST.

AVE.

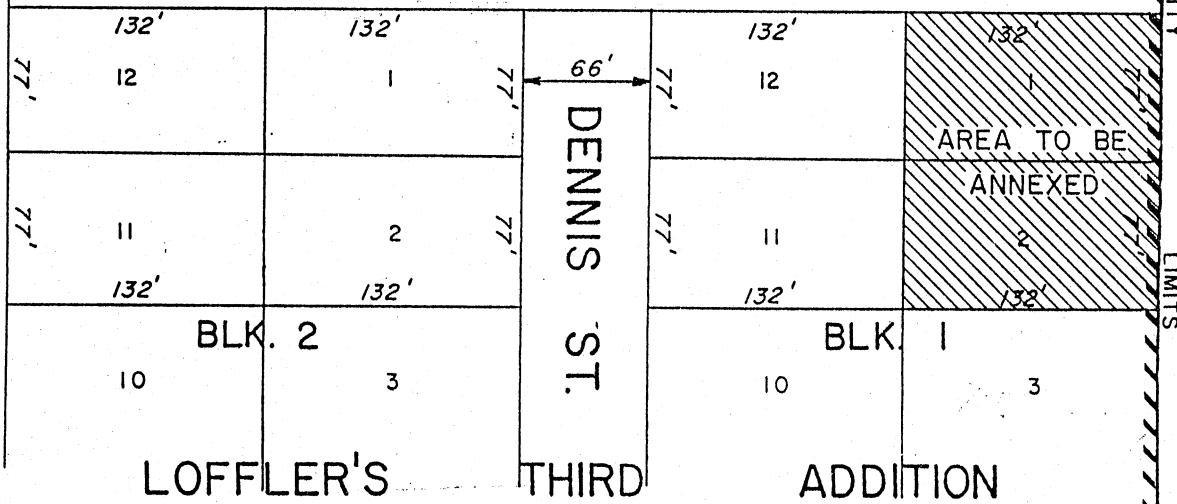

ANNEXATION MAP
PARCEL IN

SE 1/4 - NE 1/4 - NE 1/4, SEC. 18
T. 28 N. - R. 8 W.
TOWN OF HALLIE TO
CITY OF CHIPPEWA FALLS, WI



SCALE : 1" = 100'
DATE : 11/5/90
DRAWN BY : T.M.B.
APPR. *[Signature]*