

CUDAHY

Milwaukee County

ANNEXATION OF TERRITORY

Adopted Sept. 16, 1952

and

PLAT

Sec. 62.07 (3)

State of Wisconsin, }
Department of State. } ss.

Received and filed this 9th

day of January A. D. 1953

Fred R. Zimmerman
Secretary of State.

CERTIFICATE DESCRIBING TERRITORY
ATTACHED BY THE CITY OF CUDAHY,
MILWAUKEE COUNTY, WISCONSIN, FROM
THE TOWN OF LAKE AND DESCRIBING
THE BOUNDARIES OF THE CITY OF CUD-
AHY AFTER ANNEXATION PURSUANT TO
SECTION 62.07 (3) OF THE WISCONSIN
STATUTES

MILTON S. BEDUSEK
ATTORNEY-AT-LAW

STATE OF WISCONSIN SS
DEPARTMENT OF STATE
RECEIVED AND FILED

DEC 31 1952

FRED R. ZIMMERMAN
SECRETARY OF STATE

Corrected certificate

STATE OF WISCONSIN SS
DEPARTMENT OF STATE

RECEIVED AND FILED

JAN - 9 1953

FRED R. ZIMMERMAN
SECRETARY OF STATE

MILTON S. BEDUSEK
ATTORNEY-AT-LAW
4752 SOUTH PACKARD AVENUE
CUDAHY, WISCONSIN

CERTIFICATE DESCRIBING TERRITORY ATTACHED BY THE
CITY OF CUDAHY, MILWAUKEE COUNTY, WISCONSIN, FROM
THE TOWN OF LAKE AND DESCRIBING THE BOUNDARIES OF
THE CITY OF CUDAHY AFTER ANNEXATION PURSUANT TO
SECTION 62.07 (3) OF THE WISCONSIN STATUTES

I, the City Clerk of the City of Cudahy, Milwaukee County, Wisconsin, certify that the following is a description of the territory detached from the Town of Lake by Ordinance No. 386 passed by the Common Council of the City of Cudahy on September 16, 1952,

By Ordinance No. 386:

"All that part of the North East One-quarter (N.E. 1/4), North West One-quarter (N. W. 1/4), South West One-quarter (S.W. 1/4), and South East One-quarter (S. E. 1/4) of Section numbered Twenty-seven (27); the North West One-quarter (N. W. 1/4), South West One-quarter (S. W. 1/4), South East One-quarter (S. E. 1/4) and North East One-quarter (N. E. 1/4) of Section numbered Thirty-four (34); and the South West One-quarter (S. W. 1/4) and North West One-quarter (N. W. 1/4) of Section numbered Thirty-five (35), all in Township numbered Six (6) North, Range numbered Twenty-two (22) East, in the Town of Lake, County of Milwaukee, State of Wisconsin, bounded and described as follows; to-wit:

"Commencing at a point in the present limits line of the City of Cudahy, said point being One Hundred Eighty (180) feet South of the Northeast corner of the North East One-quarter (N. E. 1/4) of Section numbered Twenty-seven (27), Township numbered Six (6) North, Range numbered Twenty-two (22) East; running thence West on a line One Hundred Eighty (180) feet South of and parallel to the North line of the North East One-quarter (N. E. 1/4) and the North West One-quarter (N. W. 1/4) of Section numbered Twenty-seven (27), Township numbered Six (6) North, Range numbered Twenty-two (22) East, to a point in the Westerly Right-of-Way line of the Chicago and Northwestern Railroad; thence Southerly and following along the Westerly Right-of-Way line of said Railroad to a point in the South line of the South West One-quarter (S. W. 1/4) of Section numbered Thirty-four (34), Township numbered Six (6) North, Range numbered Twenty-two (22) East, said point being in the center line of E. College Avenue; thence East along the South line of the South West One-quarter (S. W. 1/4) and South East One-quarter (S. E. 1/4) of Section numbered Thirty-four (34) and the South line of the South West One-quarter (S. W. 1/4) of Section numbered Thirty-five (35), all in Township numbered Six (6) North, Range numbered Twenty-two (22) East, to a point in the present limits line of the City of Cudahy; thence Northerly and following along the present limits line of the City of Cudahy to the point of commencement."

And that the following is a description of the boundary of the City of Cudahy, after alteration by said Annexation:

"Commencing at the Northwest corner of the Southwest One-quarter (SW 1/4) of Section numbered Twenty-three (23), Township numbered Six (6) North, Range numbered Twenty-two (22) East; thence Easterly on and along the North lines of these following one-quarter sections: The Southwest One-quarter (SW 1/4) of

Section numbered Twenty-three (23), Township numbered Six (6) North, Range numbered Twenty-two (22) East; the Southeast One-quarter (SE 1/4) of Section numbered Twenty-three (23), Township numbered Six (6) North, Range numbered Twenty-two (22) East, and the Southwest fractional One-quarter (SW fractional 1/4) of Section numbered Twenty-four (24), Township numbered Six (6) North, Range numbered Twenty-two (22) East, to the waters edge of Lake Michigan thence Southerly on and along the shore of said Lake Michigan, approximately two and one-half (2 1/2) miles to the intersection of the South line of the Southwest fractional One-quarter (SW fractional 1/4) of section numbered Thirty-six (36), Township numbered Six (6) North, Range numbered Twenty-two (22) East, thence Westerly on and along the South lines of these following One-quarter Sections: The Southwest fractional One-quarter (SW fractional 1/4) of Section numbered Thirty-six (36) Township numbered Six (6) North, Range numbered Twenty-two (22) East; the Southeast One-quarter (SE 1/4) of Section numbered Thirty-five (35), Township numbered Six (6) North, Range numbered Twenty-two (22) East; the Southwest One-quarter (SW 1/4) of Section numbered Thirty-five (35), Township numbered Six (6) North, Range numbered Twenty-two (22) East; the Southeast One-quarter (SE 1/4) of Section numbered Thirty-four (34), Township numbered Six (6) North, Range numbered Twenty-two (22) East; and that part of the Southwest One-quarter (SW 1/4) of Section numbered Thirty-four (34), Township numbered Six (6) North, Range numbered Twenty-two (22) East, to a point in the Westerly right-of-way line of the Chicago and Northwestern Railroad; thence Northerly on and along the Westerly right-of-way line of said Railroad approximately two (2) miles to a point, said point being One hundred eighty (180) feet South of the North line of the Northwest One-quarter (NW 1/4) of Section numbered Twenty-seven (27), Township numbered Six (6) North, Range numbered Twenty-two (22) East, thence East on a line One Hundred Eighty (180) feet South of and parallel to the North line of the Northwest One-quarter (NE 1/4) and the Northeast One-quarter (NE 1/4) of Section numbered Twenty-seven (27) and the Township numbered Six (6) North Range numbered Twenty-two (22) East, to the intersection of the West line of the Northwest One-quarter (NW 1/4) of Section numbered Twenty-six (26), Township numbered Six (6) North, Range numbered Twenty-two (22) East; thence Northerly on and along the West line of these following One-quarter Sections: the Northwest One-quarter (NW 1/4) of Section numbered Twenty-six (26), Township numbered Six (6) North, Range numbered Twenty-two (22) East, and the Southwest One-quarter (SW 1/4) of Section numbered Twenty-three (23), Township numbered Six (6) North, Range numbered Twenty-two (22) East, to the point of beginning of this description; said land being in the County of Milwaukee, State of Wisconsin."

Dated at Cudahy, Wisconsin, this 8th day of January, 1953.

CITY OF CUDAHY

Witnesses:

William S. Beaudin

James E. Miller
City Clerk

Florence Pelosi

STATE OF WISCONSIN SS
DEPARTMENT OF STATE

RECEIVED AND FILED

JAN - 9 1953

FRED R. ZIMMERMAN
SECRETARY OF STATE

TOWN
of
LAKE

BILLY MITCHELL FIELD

180'

WEST LINE OF R.R. R.O.W.
C.M.V. R.R.

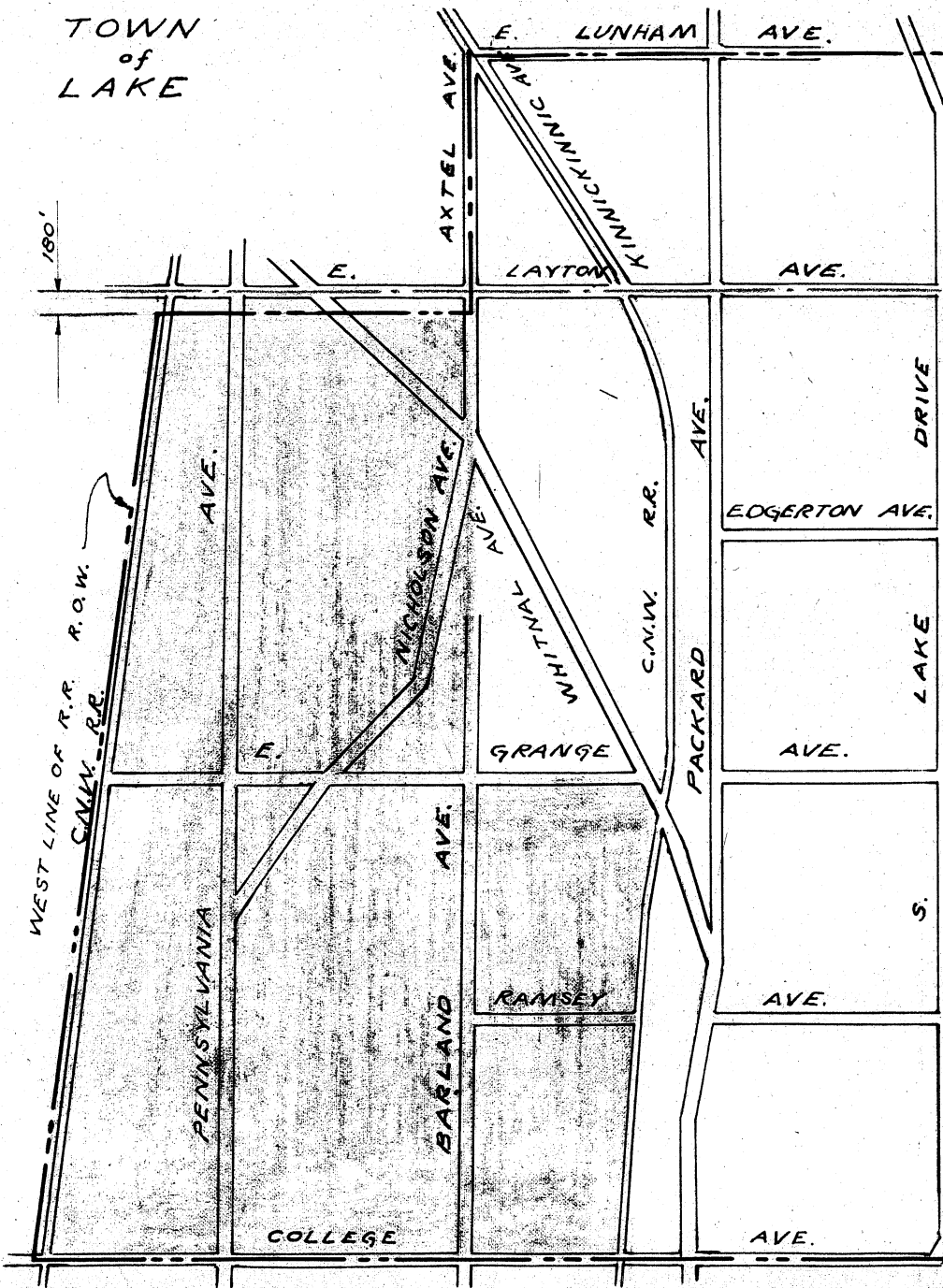

N

MICHIGAN

LAKE

SHADED PORTION
SHOWS AREA ANNEXED
DEC. 16, 1952
CITY LIMITS - - - -

ORIGINAL AREA	1231.80 AC.
SILVERDALE AREA	582.40 AC.
WEST AREA	1216.48 AC.
TOTAL AREA	3030.7 AC.
	= 4.73 SQ. MI.

CITY of CUDAHY ENGINEERING DEPT.	
MAP OF CITY OF CUDAHY	
DRAWN BY K.L.H.	1" = 2000'
APPROVED BY <i>Edwin J. Duszynski</i>	CITY ENGR.
DATE 12-22-52	