

CLINTONVILLE

WAUPACA COUNTY

OFFICE OF THE SECRETARY OF STATE
State of Wisconsin

STATE OF WISCONSIN
FILED

JUN 1 1983

DOUGLAS LA FOLLETTE
SECRETARY OF STATE



The State of Wisconsin

OFFICE OF THE
SECRETARY OF STATE

MADISON 53702

Department of Transportation
Room 901
Hill Farm State Office Building

Attn. Mr. John Pamperin

Dear Sir:

Pursuant to s. 66.021 / 66.025, we are pleased to enclose,
in duplicate, certificate and plat relating to annexation of territory
adopted by the Common Council of the City of CLINTONVILLE
County of WAUPACA on JUNE 1, 1983.

Yours very truly,

A handwritten signature in cursive script that reads 'Douglas La Follette'.

DOUGLAS LA FOLLETTE
Secretary of State

LHM:ld

Enclosures:

cc: Department of Public Instruction
Department of Administration
Department of Revenue
Department of Local Affairs and Development
Clerk
File

CITY OF CLINTONVILLE



50 10th Street

Clintonville, Wisconsin 54929

Phone: 715-823-6584

May 27, 1983

Mr. Douglas LaFollette,
Secretary of State
Room 13 West, State Capitol
Madison, Wi. 53702

Dear Mr. LaFollette:

Pursuant to Section 66.021(8) enclosed herewith is a certified copy of an annexation ordinance adopted on May 19, 1983 along with a scaled map.

Should you have any questions regarding this annexation, please feel free to contact this office.

Sincerely,

CITY OF CLINTONVILLE

Nancy Harris
Clerk-Treasurer

NH:sj
Encls.

cc: Urban Telephone Corporation
Clintonville Utilities
Wisconsin Gas Company
Waupaca County Register of Deeds
Betty Schroeder, Clerk, Clintonville School District #1
Margaret Schwenke, Clerk, Town of Larrabee

STATE OF WISCONSIN
FILED

JUN 1 1983

DOUGLAS LA FOLLETTE
SECRETARY OF STATE

CITY OF CLINTONVILLE

A black and white illustration of a long, low building with a flat roof. The building features five large, dark, arched openings along its side. To the left of these arches is a smaller section with a tiled roof and a small arched entrance. To the right of the arches is another section with a flat roof and a small rectangular entrance. The building is surrounded by some landscaping, including trees and bushes.

Clintonville, Wisconsin 54929

Phone: 715-823-6584

CERTIFICATE

STATE OF WISCONSIN)
) ss.
COUNTY OF WAUPACA)

I, NANCY HARRIS, do hereby certify as follows:

1. I am the City Clerk-Treasurer of the City of Clintonville, Wisconsin, and was such at all times mentioned in this Certificate.

2. I am the legal custodian of the papers and records of the City of Clintonville.

3. That the Common Council of the City of Clintonville is composed of ten (10) members.

4. That at a special meeting of said Council held in open session at the City Hall, Clintonville, Wisconsin, on the 19th day of May, 1983, at which 9 of the members of said Council were present in person, the attached Ordinance was duly adopted by the affirmative vote of 8 of the members of said Council and that same has not been rescinded or amended in any way.

5. That notice to the public and to the official city newspaper and to those news media which have filed a written request for such notice, of the time, place and subject matter of the Common Council meeting described above was given pursuant to Subchapter IV of Chapter 19, Wisconsin Statutes, not less than 24 hours prior to the commencement of said meeting, by posting a written notice thereof at a public bulletin board in the City Hall and by such other means as was reasonably likely to apprise the members of the public and the news media of the subject matter of said meeting.

WITNESS my official signature and the corporate seal of the
City of Clintonville this 27th day of May, 1983.

Nancy Harris
Nancy Harris, Clerk-Treasurer
City of Clintonville

JUN 1 1983

DOUGLAS LA FOLLETTE
SECRETARY OF STATE

CITY OF CLINTONVILLE

URBAN TELEPHONE

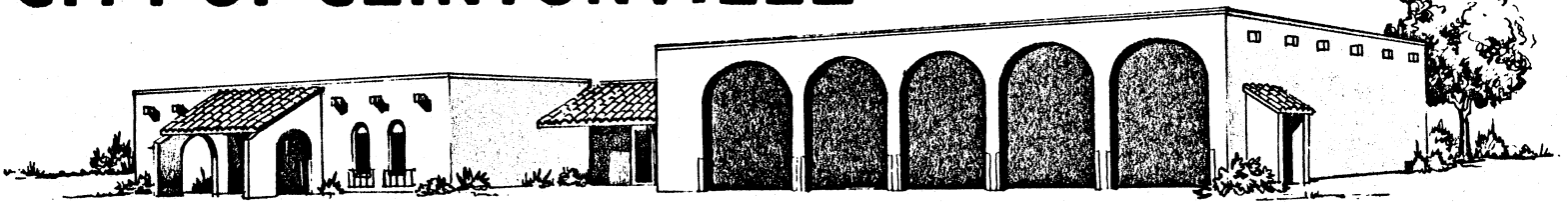

GERALD L. KOENIG
City Attorney

OFFICE OF THE CITY ATTORNEY
208 W. Green Bay Street
P.O. Box 59
Shawano, Wisconsin 54166

TELEPHONE
(715) 526-3191

May 17, 1983

STATE OF WISCONSIN
FILED

JUN 1 1983

ORDINANCE NO. 534

DOUGLAS LA FOLLETTE
SECRETARY OF STATE

AN ORDINANCE ANNEXING TERRITORY TO THE CITY OF CLINTONVILLE FROM THE TOWN OF LARRABEE, WAUPACA COUNTY, WISCONSIN

Section One: Territory Annexed. Pursuant to the authority granted by Section 66.021(12), Wis. Stats., and the Petition for Direct Annexation filed with the City Clerk-Treasurer on the 5th day of May, 1983, signed by the owner of all of the real property in the territory proposed for annexation, there being no electors residing therein, the following described territory in the Town of Larrabee, Waupaca County, Wisconsin, is hereby annexed to the City of Clintonville:

Part of the NW 1/4 NE 1/4 of Section 35-25-14, bounded and described as follows, to-wit: Commencing at the intersection of the center line of the New London-Shawano Road (now known as Highway 22 and 45) with the North line of said Section 35, running thence South 10 degrees 29 minutes West along the center of the highway 209.14 feet, thence South 89 degrees 54 minutes East 226.46 feet, thence North 7 minutes East 209.73 feet to the North line of the aforesaid Section 35, thence West on the Section line 195 feet to the place of beginning.

Section Two: Effect of Annexation. From and after the date of this ordinance, the territory described in Section One shall be a part of the City of Clintonville for any and all purposes provided by law and all persons coming or residing within said territory shall be subject to all ordinances, rules and regulations governing the City of Clintonville.

Section Three: Temporary Zoning Classification.

(a) Upon recommendation of the Plan Commission, the territory annexed to the City of Clintonville by this ordinance is temporarily designated to be part of the following district of the City for zoning purposes and subject to all provisions of the

Clintonville Municipal Code relating to such district classification and to zoning:

Class B-1, General Commercial District.

(b) The Plan Commission is directed to prepare an amendment to the applicable portion of the Clintonville Zoning Ordinance setting forth a permanent classification and regulations for the zoning of the annexed area and to submit its recommendations to the Common Council not later than May 1, 1984.

Section Four: Ward Designation. The territory described in Section One of this ordinance is hereby made a part of the Fourth Ward, Third Aldermanic District of the City of Clintonville, subject to the ordinances, rules and regulations of the City of Clintonville governing wards and districts.

Section Five: Severability. If any provision of this ordinance is invalid or unconstitutional, or if the application of this ordinance to any person or circumstance is invalid or unconstitutional, such invalidity or unconstitutionality shall not affect the other provisions or applications of this ordinance which can be effected without the invalid or unconstitutional provision or application.

Section Six: Effective Date. This ordinance shall take effect upon passage and publication.

CITY OF CLINTONVILLE

By Karen Siewert
Karen Siewert, Mayor

Attest Nancy Harris
Nancy Harris, Clerk-Treasurer

Adopted: 5/19-83
Published: 5/26-83

STATE OF WISCONSIN
FILED

JUN 1 1983

DOUGLAS LA FOLLETTE
SECRETARY OF STATE

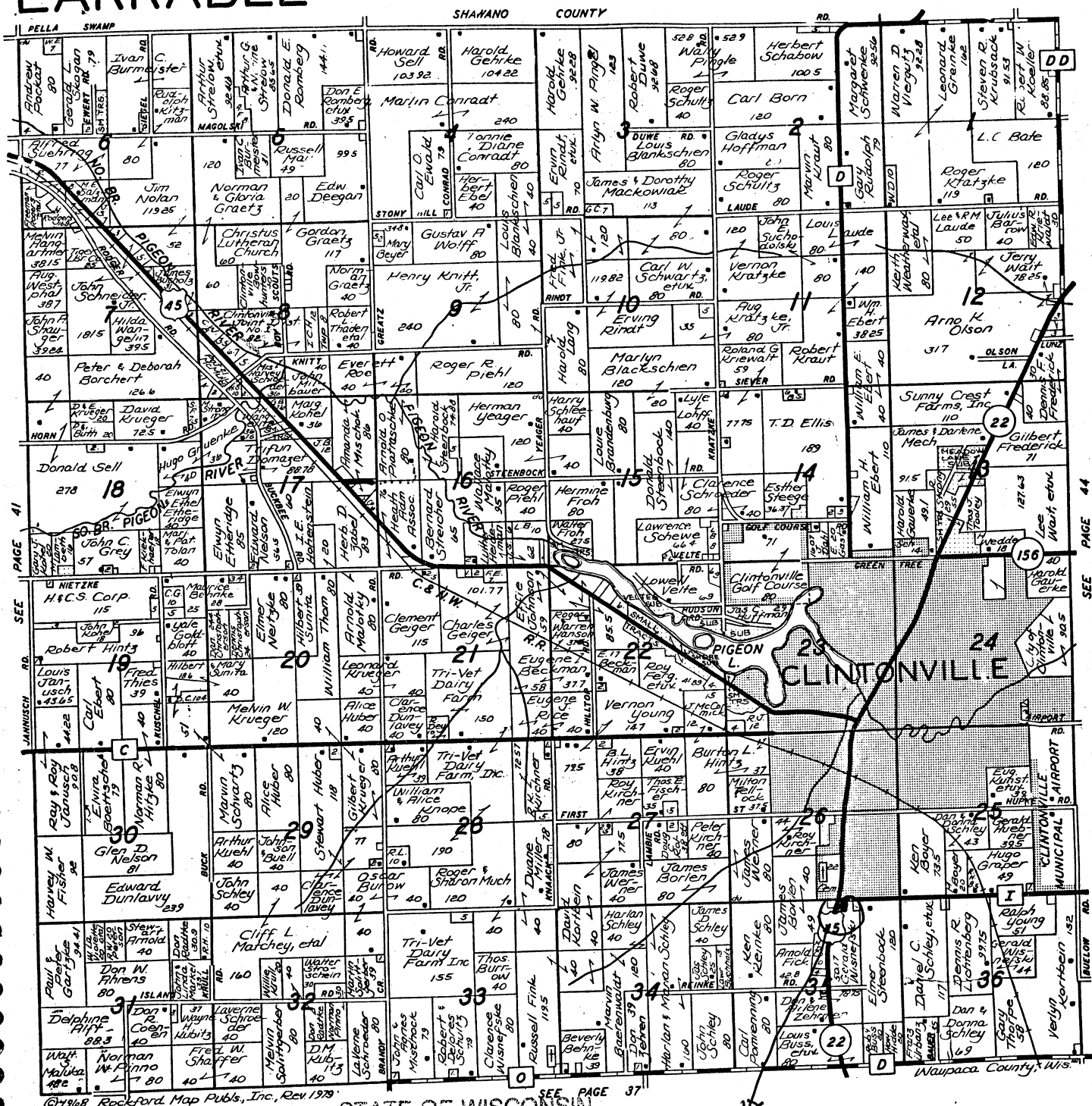

STATE OF WISCONSIN
FILED

PROPOSED AREA TO BE ANNEXED

KELLER'S APPLIANCE SHOP



WASHERS AND DRYERS
SALES & SERVICES

PHONE: 823-3660

143 South Main Street - Clintonville, Wisconsin 54929

CLINTONVILLE FLOUR AND FEED CO.

Phone: 823-3817 - Clintonville, Wisconsin 54929

CUSTOM GRINDING AND MIXING
SEED TREATING AND CLEANING

Feed, Seed, Fertilizer, Salt
Molasses Blending, Hay Grinding

LA VIOLETTE'S CHECK-R-MIX
Mash - Dairy - Hog Feed





SCALE 1"=30'

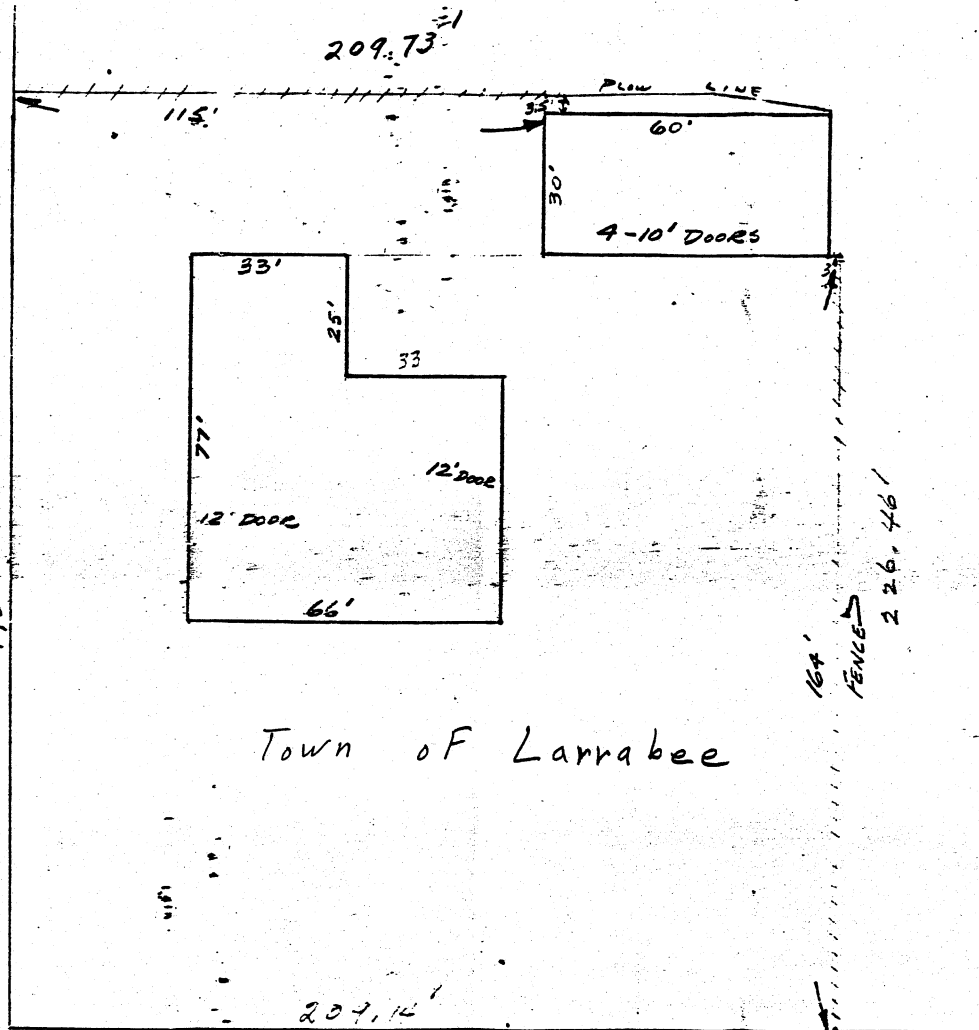

Town of Larrabee

U.S.H. 45

City of

Clintonville

DOUGLAS LA FOLLETTE
SECRETARY OF STATE

JUN 1 1983

STATE OF WISCONSIN
FILED

County Register

1983