

## ANNEXATION OF

## TERRITORY

State of Wisconsin )  
Department of State ) ss.

Received and filed this .....17th

day of .....February..... A.D. 19.76

*Douglas H. Felt*

.....  
Secretary of State

N  O R D I N A N C E  

## AN ORDINANCE ANNEXING TERRITORY TO THE CITY OF EAU CLAIRE

THE CITY COUNCIL OF THE CITY OF EAU CLAIRE DO ORDAIN AS FOLLOWS:

SECTION 1.     Territory Annexed.   In accordance with Section 66.021 of the

Wisconsin Statutes the following described territory in the Town of Seymour,  
Eau Claire County, Wisconsin, is annexed to the City of Eau Claire, Wisconsin:

That part of the SW $\frac{1}{4}$  of the SW $\frac{1}{4}$ , Section 10 T 27 N, R 9 W, Town of  
Seymour, Eau Claire County, Wisconsin described as follows:

Commencing at the Southwest corner of Section 10; thence East along  
the South line Section 10, 826.98 feet to the East R/W line Brookline  
Avenue as platted in Seymour Park Addition; thence North along the  
East R/W line Brookline Avenue 1312.33 feet to the North line of the  
SW $\frac{1}{4}$  SW $\frac{1}{4}$  Section 10; thence West 818.06 feet along said North line of  
→ the SW $\frac{1}{4}$  SW $\frac{1}{4}$  to the NW corner thereof; thence South along the West  
line said SW $\frac{1}{4}$  SW $\frac{1}{4}$  1313.40 feet to the point of beginning.

SECTION 2.     Effect of Annexation.   From and after the date of this ordinance the  
territory described in Section 1 shall be part of the City of Eau Claire for  
any and all purposes provided by law and all persons coming or residing within  
such territory shall be subject to all ordinances, rules and regulations  
governing the City of Eau Claire.

SECTION 3.     Temporary Zoning Classification.   The territory annexed to the City of  
Eau Claire by this ordinance is temporarily designated to be part of an R-1A  
(One Family Dwellings-Large Lots) District for zoning purposes and subject to  
all provisions of the Zoning Ordinance of the City of Eau Claire relating to  
such district classification and to zoning in the city.

SECTION 4.     School Purposes.   The annexed territory is also annexed for school  
purposes and is thereby made a part of the city school district and subject  
to all of the laws governing the same.

SECTION 5.     Ward Designation.   The territory described in Section 1 of this ordi-  
nance is hereby made a part of the 11th Ward of the City of Eau Claire,  
subject to all ordinances, rules and regulations of the City governing wards.

SECTION 6.     Severability.   If any provision of this ordinance is invalid or uncon-  
stitutional, or if the application of this ordinance to any person or  
circumstances is invalid or unconstitutional, such invalidity or unconsti-  
tutionality shall not affect the other provisions or application of this  
ordinance which can be given effect without the invalid or unconstitutional  
provisions or applications.

SECTION 7.     This ordinance shall take effect upon passage and publication as  
provided by law.

(SEAL)     H. D. Crinion  
                    President

Passed, February 11, 1976  
Approved, February 12, 1976

(ATTESTED)     D. M. Johnson  
                    City Clerk

C E R T I F I C A T E    O F    A N N E X A T I O N

STATE OF WISCONSIN    )

COUNTY OF EAU CLAIRE SS

COUNTY OF CHIPPEWA    )

CITY OF EAU CLAIRE    )

I, Donald M. Johnson, City Clerk of the City of Eau Claire, County of Chippewa and the County of Eau Claire, DO HEREBY CERTIFY, That the following described territory was detached from the Town of Seymour, County of Eau Claire and was annexed to the said City of Eau Claire, pursuant to Section 66.021 of the Wisconsin Statutes, by an Ordinance adopted by the Common Council of the City of Eau Claire at a Regular Meeting held February 11, 1976.

That part of the SW $\frac{1}{4}$  of the SW $\frac{1}{4}$ , Section 10 T 27 N, R 9 W, Town of Seymour, Eau Claire County, Wisconsin, described as follows:

Commencing at the Southwest corner of Section 10: thence East along the South line Section 10, 826.98 feet to the East R/W line Brookline Avenue as platted in Seymour Park Addition; thence North along the East R/W line Brookline Avenue 1312.33 feet to the North line of the SW $\frac{1}{4}$  SW $\frac{1}{4}$  Section 10; thence West 818.06 feet along said North line of the SE $\frac{1}{4}$  SW $\frac{1}{4}$  to the NW corner thereof; thence South along the West line said SW $\frac{1}{4}$  SW $\frac{1}{4}$  1313.40 feet to the point of beginning.

Dated this 13th day of February, 1976.

No. of residents 3

STATE OF WISCONSIN  
DEPARTMENT OF STATE  
RECEIVED AND FILED

FEB 17 1976

DOUGLAS LAFOLLETTE  
SECRETARY OF STATE

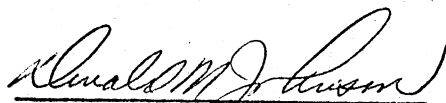
  
Donald M. Johnson,  
City Clerk

A N O R D I N A N C E

AN ORDINANCE ANNEXING TERRITORY TO THE CITY OF EAU CLAIRE

THE CITY COUNCIL OF THE CITY OF EAU CLAIRE DO ORDAIN AS FOLLOWS:

SECTION 1. Territory Annexed. In accordance with Section 66.021 of the Wisconsin Statutes the following described territory in the Town of Seymour, Eau Claire County, Wisconsin, is annexed to the City of Eau Claire, Wisconsin:

That part of the SW $\frac{1}{4}$  of the SW $\frac{1}{4}$ , Section 10 T 27 N, R 9 W, Town of Seymour, Eau Claire County, Wisconsin described as follows:

Commencing at the Southwest corner of Section 10; thence East along the South line Section 10, 826.98 feet to the East R/W line Brookline Avenue as platted in Seymour Park Addition; thence North along the East R/W line Brookline Avenue 1312.33 feet to the North line of the SW $\frac{1}{4}$  SW $\frac{1}{4}$  Section 10; thence West 818.06 feet along said North line of the SE $\frac{1}{4}$  SW $\frac{1}{4}$  to the NW corner thereof; thence South along the West line said SW $\frac{1}{4}$  SW $\frac{1}{4}$  1313.40 feet to the point of beginning.

SECTION 2. Effect of Annexation. From and after the date of this ordinance the territory described in Section 1 shall be part of the City of Eau Claire for any and all purposes provided by law and all persons coming or residing within such territory shall be subject to all ordinances, rules and regulations governing the City of Eau Claire.

SECTION 3. Temporary Zoning Classification. The territory annexed to the City of Eau Claire by this ordinance is temporarily designated to be part of an R-1A (One Family Dwellings-Large Lots) District for zoning purposes and subject to all provisions of the Zoning Ordinance of the City of Eau Claire relating to such district classification and to zoning in the city.

SECTION 4. School Purposes. The annexed territory is also annexed for school purposes and is thereby made a part of the city school district and subject to all of the laws governing the same.

SECTION 5. Ward Designation. The territory described in Section 1 of this ordinance is hereby made a part of the 11th Ward of the City of Eau Claire, subject to all ordinances, rules and regulations of the City governing wards.

SECTION 6. Severability. If any provision of this ordinance is invalid or unconstitutional, or if the application of this ordinance to any person or circumstances is invalid or unconstitutional, such invalidity or unconstitutionality shall not affect the other provisions or application of this ordinance which can be given effect without the invalid or unconstitutional provisions or applications.

SECTION 7. This ordinance shall take effect upon passage and publication as provided by law.

FEB 17 1976

DOUGLAS LAFOLLETTE  
SECRETARY OF STATE

(SEAL)

*[Signature]*  
President

(ATTESTED)

*[Signature]*  
City Clerk

Passed, February 11, 1976  
Approved, February 12, 1976

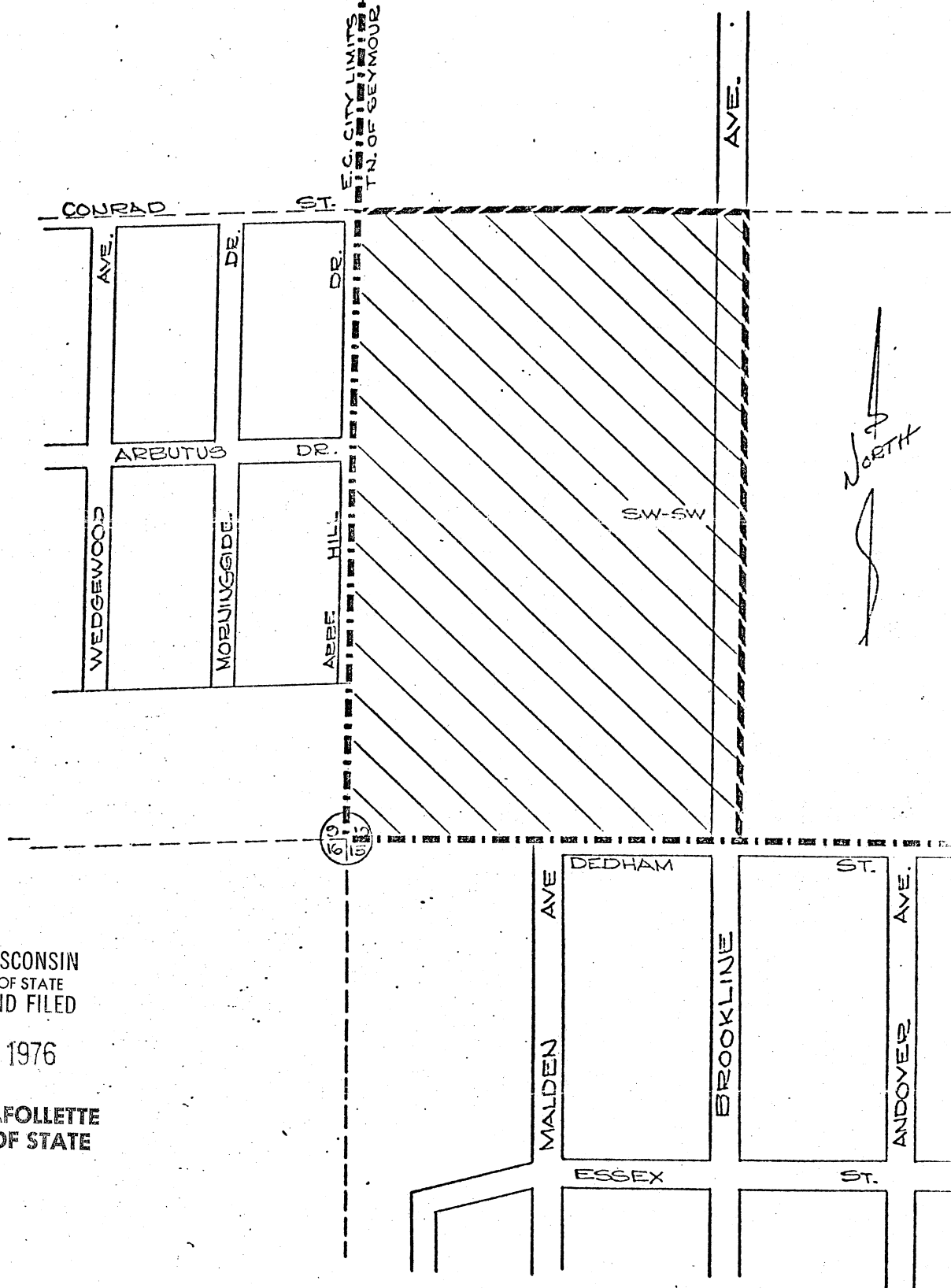

STATE OF WISCONSIN  
DEPARTMENT OF STATE  
RECEIVED AND FILED

FEB 17 1976

DOUGLAS LAFOLLETTE  
SECRETARY OF STATE

INDICATES PRESENT  
EAU CLAIRE CITY  
LIMITS LINE.

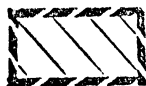

INDICATES LANDS PROP.  
TO BE ANNEXED TO THE  
CITY OF EAU CLAIRE.

### PROPOSED ANNEXATION

THESE LANDS BEING LOCATED  
IN THE SW-SW, SEC. 10-27-9,  
TOWN OF SEYMOUR, EAU CLAIRE  
COUNTY, WISCONSIN.

SCALE: 1"=250'

DEC. 1975

No. 75-5A