

CITY OF RICE LAKE
COUNTY OF BARRON

ANNEXATION & PLAT MAP
ORD. NO 848

OFFICE OF THE SECRETARY OF STATE
State of Wisconsin

FILED FEBRUARY 11, 1998

C71

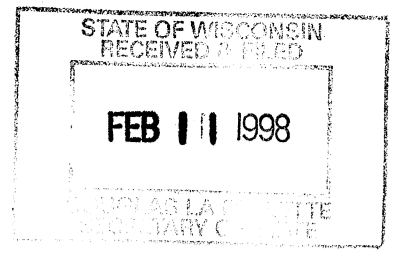

ORDINANCE NO. 848

**ORDINANCE ANNEXING TERRITORY TO THE
CITY OF RICE LAKE, WISCONSIN**

It is hereby ordained by the Common Council of the City of Rice Lake, Wisconsin, that the Code of Ordinances shall read as follows:

SECTION 1. Territory Annexed.

In accordance with Section 66.021, Wisconsin State Statutes, and the Petition for Direct Annexation filed with the City Clerk-Treasurer on the 4th day of August, 1997 signed by (a) property owner(s) of at least 50% of the real property of the total area to be annexed, the territories so described in the attached document to this ordinance that are located in the Town of Rice Lake, Barron County, Wisconsin, are hereby annexed to the City of Rice Lake, Barron County, Wisconsin (as more particularly described in the metes and bounds description which is attached hereto and incorporated by reference as if fully set out herein). The total population within the annexed territory is zero (0).

SECTION 2. Effect of Annexation.

- (a) From and after the date of this ordinance the territory described in Section 1 shall be a part of the City of Rice Lake for any and all purposes provided by law and all persons coming or residing within such territory shall be subject to all ordinances, rules and regulations governing the City of Rice Lake.

SECTION 3. Temporary Zoning Classification.

- (a) Upon recommendation of the Plan Commission, the territory annexed to the City of Rice Lake by this ordinance is temporarily designated to be part of the one of the following districts of the City for zoning purposes and subject to all provisions of the Code of Ordinances Section 13 of the City of Rice Lake, entitled "Land Use Regulations" relating to such district classifications and to zoning in the City:
 - (1) City of Rice Lake Code of Ordinances - Section 13-1-25 (Residential District "R1").
 - (2) City of Rice Lake Code of Ordinances - Section 13-1-35 (Commercial District "C").
- (b) The boundaries of the annexed properties for zoning purposes can be described upon a scale map filed in the office of the City Clerk-Treasurer and dated upon receipt on August 4, 1997.
- (c) The Plan Commission is directed to prepare in amendment to the zoning ordinance setting forth the permanent classifications and regulations for the zoning of the annexed area and to submit its recommendations to the Common Council not later than December 1, 1997.

SECTION 4. Ward Designation.

The territory described in Section 1 of this ordinance is hereby made a part of the 20th Ward of the City of Rice Lake, Wisconsin, subject to the ordinances, rules and regulations of the City of Rice Lake governing wards.

SECTION 5. Aldermanic District Designation.

The territory described in Section 1 of this ordinance is hereby made a part of the 8th Aldermanic District of the City of Rice Lake, Wisconsin, subject to the ordinances, rules and regulations of the City of Rice Lake governing Aldermanic Districts.

SECTION 6. School District Affiliation.

The territory described in Section 1 of this ordinance is annexed for school purposes and is hereby made part of the Rice Lake School District 4802 and subject to all laws governing the same.

SECTION 7. Severability.

If any provision of this ordinance is invalid or unconstitutional, or if the application of this ordinance to any person or circumstance is invalid or unconstitutional, such invalidity or unconstitutionality shall not affect the other provisions or applications of this ordinance which can be given effect without the invalid or unconstitutional provision or application.

SECTION 8. Effective Date.

This ordinance shall take effect immediately upon passage and publication as provided by law.

ADOPTED this 9th day of September, 1997.

CITY OF RICE LAKE

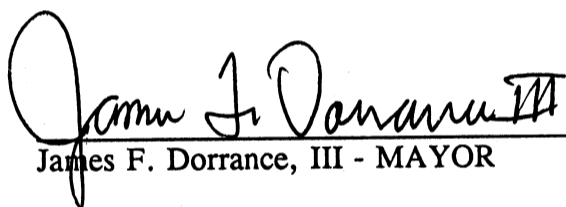

James F. Dorrance, III - MAYOR

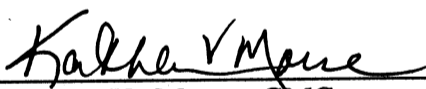
ATTEST:

Kathleen V. Morse, CMC
City Clerk-Treasurer

CERTIFICATION

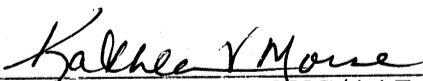
I, Kathleen V. Morse, City Clerk-Treasurer, hereby certifies that this Ordinance is a true and exact copy adopted by the Common Council on the 9th day of September, 1997 and taken from the official records of the City of Rice Lake, Wisconsin.

Kathleen V. Morse, CMC/AAE
City Clerk-Treasurer

Dated: 2-9-98

FEB 11 1998

DOUGLAS J. TOULLETTE
SECRETARY OF STATE**LEGAL DESCRIPTION**

A parcel of land located in the NE $\frac{1}{4}$ - SE $\frac{1}{4}$, NW $\frac{1}{4}$ - SE $\frac{1}{4}$, NE $\frac{1}{4}$ - SW $\frac{1}{4}$, SE $\frac{1}{4}$ - NW $\frac{1}{4}$, E $\frac{1}{2}$ - NE $\frac{1}{4}$ - NW $\frac{1}{4}$, NW $\frac{1}{4}$ - NE $\frac{1}{4}$, SW $\frac{1}{4}$ - NE $\frac{1}{4}$, NE $\frac{1}{4}$ - NE $\frac{1}{4}$ and the SE $\frac{1}{4}$ - NE $\frac{1}{4}$, Section 32, Township 35 North, Range 11 West, Township of Rice Lake, Barron County, Wisconsin, more particularly described as follows:

Beginning at the E $\frac{1}{4}$ corner of Section 32;

thence S 01°37'18" E, along the East line of the SE $\frac{1}{4}$ of said Section 32, 133.60 feet to the South right-of-way of C.T.H. "O", said point also being on a curve concave to the north having a radius of 11,609.16 feet and central angle of 00°25'39", and long chord bearing N 88°42'00" W, 86.63 feet;

thence Westerly, along said right-of-way and curve to the right, an arc distance of 86.63 feet;

thence N 88°27'38" W along said right-of-way, 280.45 feet;

thence N 88°29'43" W along said right-of-way, 296.72 feet;

thence N 88°27'12" W along said right-of-way, 207.69 feet;

thence N 88°32'38" W along said right-of-way, 269.19 feet;

thence N 89°08'37" W along said right-of-way, 7.65 feet;

thence N 88°27'10" W along said right-of-way, 56.85 to that right-of-way line described in Volume 385 Records, page 397;

thence S 01°17'48" E along said right-of-way, 28.06 feet;

thence S 01°23'52" E along said right-of-way, 96.64 feet;

thence S 16°42'46" W along said right-of-way, 90.97 feet, to the North line of that parcel described in Volume 307 Records, page 66;

thence N 88°50'58" W along said north line, 40.37 feet to the East right-of-way line of a town road;

thence S 01°28'49" E along said town road right-of-way, 897.59 feet to the South line of the NE $\frac{1}{4}$ - SE $\frac{1}{4}$;

thence N 88°55'42" W along said South line, 33.24 feet to the SE corner of the NW $\frac{1}{4}$ - SE $\frac{1}{4}$;

thence N 88°55'42" W along the South line of the NW $\frac{1}{4}$ - SE $\frac{1}{4}$, 1309.72 feet to the SW corner of the NW $\frac{1}{4}$ - SE $\frac{1}{4}$;

FEB 11 1998

thence N 01°18'49" W along the West line of the NW¼ - SE¼, 1127.31 feet to the South right-of-way line of C.T.H. "O";

thence N 88°30'00" W along said right-of-way line and Westerly extension thereof, 1310.02 feet to the West line of the NE¼ - SW¼;

thence N 01°08'06" W along said West line, 127.81 feet to the SW corner of the SE¼ - NW¼;

thence N 01°12'38" West along the West line of the SE¼ - NW¼, 1279.89 feet to the NW corner of the SE¼ - NW¼;

thence S 88°25'40" E along the North line of the SE¼ - NW¼, 653.30 feet to the SW corner of the
E½ - NE¼ - NW¼;

thence N 01°14'44" W along the West line of the E½ - NE¼ - NW¼, 1246.78 feet to the south right-of-way line of a town road;

thence S 88°17'28" E along said right-of-way line, 378.81 feet to the NW corner of Lot 2 of that Certified Survey Map recorded in Volume 16, page 103, Barron County Certified Survey Maps;

thence S 01°42'49" W along the West line of said Lot 2, 365.32 feet to the SW corner of said Lot 2;

thence S 88°17'29" E along the South line of said Lot 2, 740.55 feet to the SE corner of said Lot 2 said corner also being the SW corner of Lot 1 of that Certified Survey Map recorded in Volume 16, page 99 of Barron County Certified Survey Maps;

thence S 86°12'56" E along the South line of said Lot 1, 479.30 feet to the SE corner of said Lot 1, said corner also being on the West right-of-way line of River Road;

thence N 71°07'40" E across said right-of-way, 65.86 feet to the NW corner of Lot 5, Plat of Red Cedar Heights, said corner also being on the East right-of-way line of River Road;

thence S 17°27'40" E along the East right-of-way line of River Road; 856.46 feet to the beginning of a curve concave to the West, having a radius of 1730.93 feet. central angle of 06°44'53" and long chord bearing S 14°31'05" E, 203.74 feet;

thence Southerly along said right-of-way and curve to the right an arc distance of 203.86' to the SW corner of the Plat of Red Cedar Heights and South right-of-way line of a Public Access;

thence N 72°30'20" E along the south right-of-way line of said Public Access, 538.90 feet to a meander corner located S 72°30'20" W, 45 feet more or less from the West bank of the Red Cedar River;

thence S 17°51'04" E along a meander line, 423.48 feet to a meander corner;

thence S 05°40'49" E along a meander line, 351.36 feet to a meander corner;

thence S 25°54'21" E along a meander line, 291.07 feet to a meander corner;

thence S 36°54'28" E along a meander line, 185.05 feet to a meander corner;

thence S 09°05'45" E along a meander line, 61.00 feet to a meander corner;

thence S 07°30'30" E along a meander line, 117.85 feet to a meander corner located on the South line of the SE¼ - NE¼;

thence S 88°28'56" E along said South line, 424.79 feet to the point of beginning.

Said parcel includes all lands East of the meander line, South of the Easterly extension of the Southerly line of the Plat of Red Cedar Heights, North of the South line of the SE¼ - NE¼ and West of the West edge of the Red Cedar River and all of that part of the Red Cedar River lying South of the Easterly extension of the Southerly line of the Plat of Red Cedar Heights and North of the South line of the SE¼ - NE¼.

Said parcel contains 188.5 acres more or less.

Bearings for this description are reference to the Baron County Geodetic Grid.

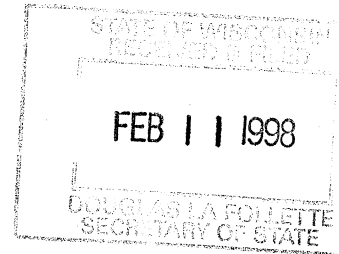

STATE OF WISCONSIN
RECEIVED & FILED
FEB 11 1998
JAMES LA FOLLE
SECRETARY OF STATE

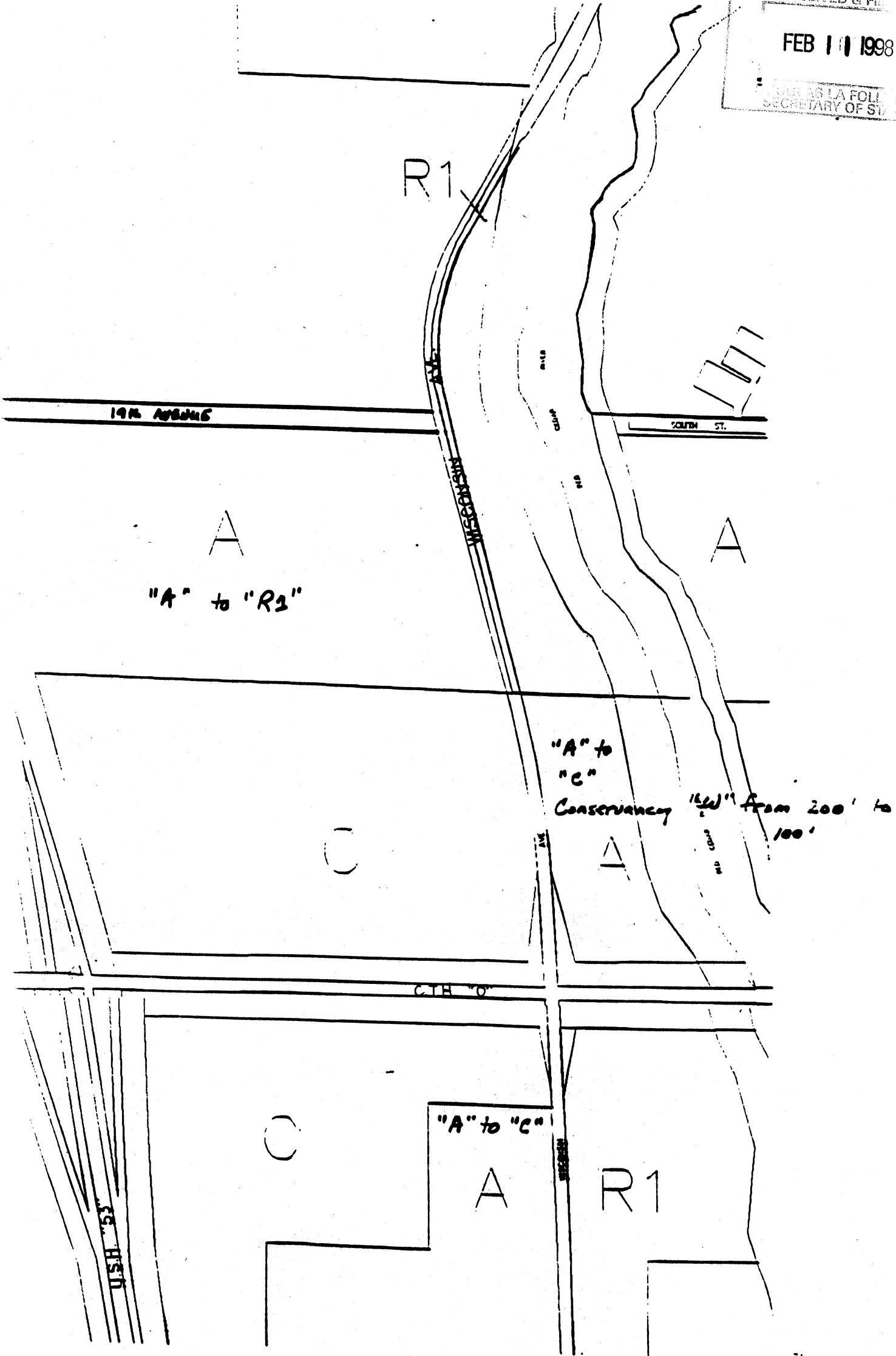

T.35N.-R.11W.

FEB 11 1998

RICE LAKE

47

SEE PAGE 41

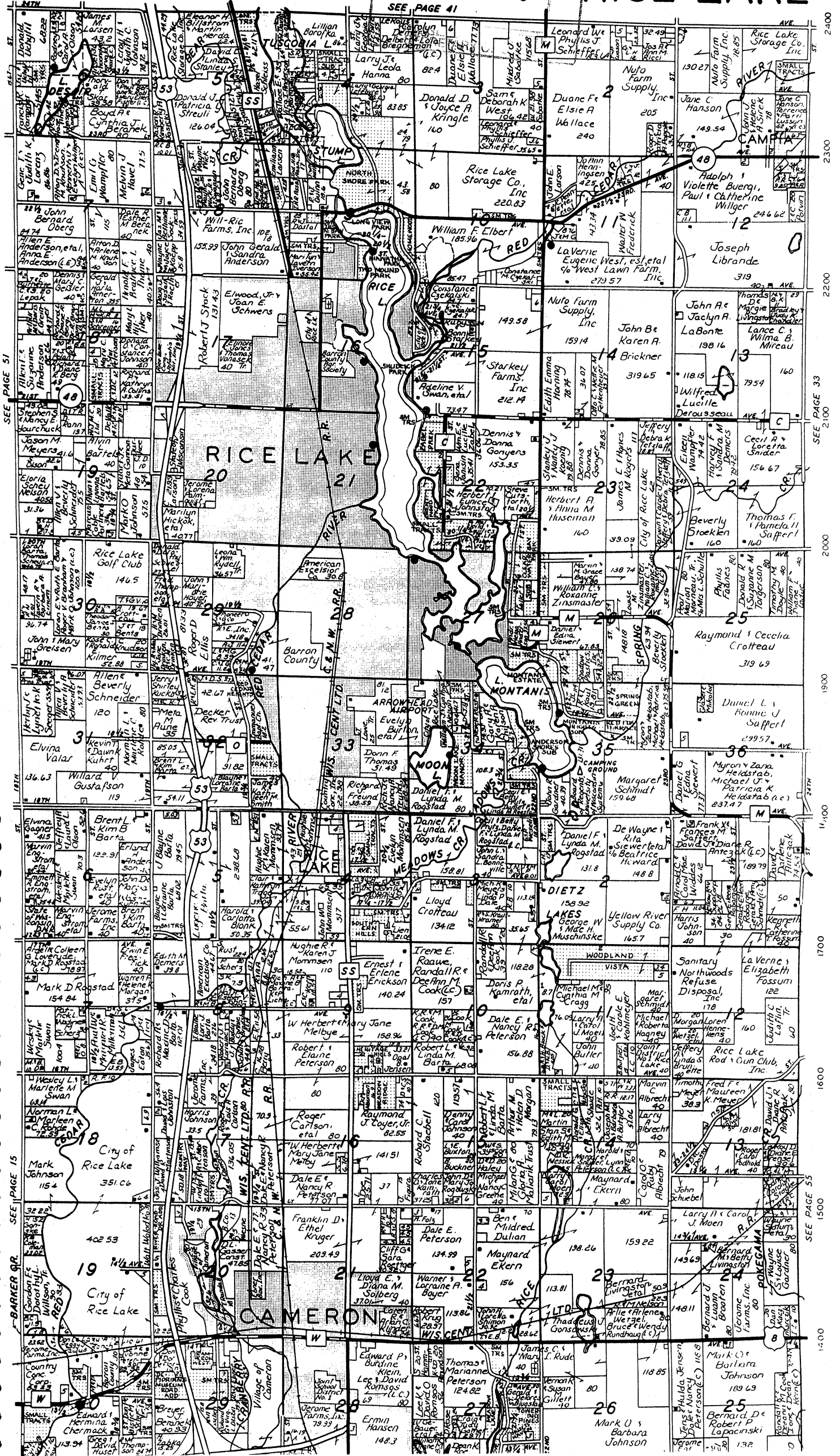

SEE PAGE 51

SEE PAGE 33

SEE PAGE 15

SEE PAGE 55