

CITY OF JANESVILLE

COUNTY OF ROCK

Annexation and Plat Map

OFFICE OF THE SECRETARY OF STATE  
*State of Wisconsin*

FILED April 12, 1988

DOUGLAS LA FOLLETTE  
SECRETARY OF STATE



STATE OF WISCONSIN  
OFFICE OF THE SECRETARY OF STATE  
201 EAST WASHINGTON AVENUE, ROOM 271  
MADISON 53702

CORPORATIONS  
DIVISION

P.O. BOX 7846  
MADISON, WI 53707

COOPERATIVE ASSOCIATIONS  
DOMESTIC AND FOREIGN  
CORPORATIONS AND  
LIMITED PARTNERSHIPS  
(608) 266-3590

UNIFORM COMMERCIAL  
CODE DIVISION

P.O. BOX 7847  
MADISON, WI 53707

GENERAL INFORMATION  
(608) 266-3087  
TELEPHONE SEARCH REQUESTS  
(608) 267-7167

GOVERNMENT RECORDS  
DIVISION

P.O. BOX 7848  
MADISON, WI 53707

LOBBY REGULATION  
MUNICIPAL/RAILROAD RECORDS  
PUBLICATION OF STATE LAWS  
(608) 266-5503  
NOTARIES PUBLIC  
APOSTILLES/AUTHENTICATIONS  
(608) 266-5594  
TRADE NAMES/TRADEMARKS  
(608) 266-5653

ADMINISTRATIVE  
SERVICES DIVISION

P.O. BOX 7848  
MADISON, WI 53707

GENERAL OPERATIONS  
(608) 266-1437

GENERAL OFFICE INFORMATION  
(608) 266-5801

LEGAL SERVICES  
SECTION

P.O. BOX 7848  
MADISON, WI 53707

GENERAL COUNSEL  
(608) 266-0182  
CORPORATIONS COUNSEL  
(608) 266-0181

Department of Transportation  
Room 951  
Hill Farm State Office Building  
Madison, WI

Attn: John Pamperin

Dear Sir:

Pursuant to Wis. Stats. 66.021/66.025, we are pleased to  
enclose in duplicate, certificate and plat relating to  
annexation of territory adopted by the Common Council of  
the City of JANESVILLE, County of ROCK  
on March 21, 1988.

Sincerely,

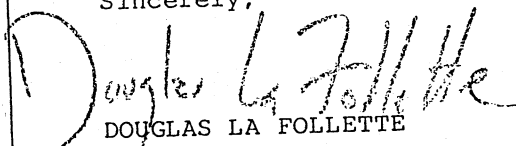
  
DOUGLAS LA FOLLETTE  
Secretary of State

cc: Depts. of:  
Administration  
Development  
Public Instruction  
Revenue

Clerk  
File

# CITY of JANESVILLE

*Department of City Clerk-Treasurer*

7 April 1988

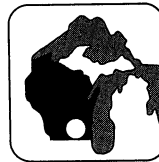

Municipal Building  
18 North Jackson Street  
Janesville, WI 53545

608-755-3000

The Honorable Douglas LaFollette  
Secretary of State  
State Capitol Building  
Madison, Wisconsin 53702

Greetings:

Pursuant to State Statute Section 66.021 (8), I am enclosing a copy of the following, pertaining to our recent annexation:

- Certificate of Annexation
- Certified copy of Ordinance No. 88-559
- Plat of Annexation

The ordinance was adopted by the Common Council of the City of Janesville at their regularly scheduled meeting held 21 March 1988.

I hereby certify that the total electors in this area is two, total population is 2.

Sincerely,

A handwritten signature in dark ink, appearing to read "Frank L. Spoden". The signature is fluid and cursive.

Frank L. Spoden  
City Clerk-Treasurer

hrp  
Enclosures

STATE OF WISCONSIN  
RECEIVED AND FILED

APR 12 1988

DOUGLAS LAFOLLETTE  
SECRETARY OF STATE

CERTIFICATE OF ANNEXATION

STATE OF WISCONSIN    )  
                              SS.  
COUNTY OF ROCK        )

I, Frank L. Spoden, City Clerk of the City of Janesville, Rock County, Wisconsin, do hereby certify that the following described territory was detached from the Town of Harmony, Rock County, Wisconsin, all pursuant to Wisconsin Statutes 66.02 (7)(a) by Ordinance No. 88-559 adopted by the Common Council of the City of Janesville on 21 March 1988.

Part of the SW 1/4 of Section 33, T.3N., R.13E., of the 4th PM., Harmony Township, Rock County, Wisconsin.

Commencing at the south 1/4 corner of said Section, thence N. 0° 07' 05"W. along the north-south centerline of said Section, 50.02 feet to the place of beginning for the land to be herein described; thence N. 88° 38' 30"W. along a line parallel to and 50 feet northerly of the south line of said SW 1/4, 2,288.59 feet to the east line of a certified survey map as recorded in Volume 11, Pages 31 and 32; thence N. 0° 04' 05"W. along said East line, 660.00 feet to the north line of said certified survey map; thence N. 88° 38' 30"W. along said north line 160.0 feet; thence N. 0° 04' 05"W. parallel with and 200 feet east of the west line of said SW 1/4, 1,920.07 feet to the east-west centerline of said Section; thence S. 88° 44' 50"E. along said east-west centerline 1,123.12 feet to the west line of the NE 1/4 of said SW 1/4; thence S. 0° 05' 35" E. along said West line 1,316.08 feet to the south line of the NE 1/4 of said SW 1/4; thence S. 88° 41' 40"E. along said south line, 1,323.72 feet to the north-south centerline of said Section; thence S. 0° 07' 05" E. along said north-south centerline 1,267.30 feet to the place of beginning. Containing 102.63 acres.

The annexation has a population of two elector residents.

Frank L. Spoden  
Frank L. Spoden  
City Clerk  
City of Janesville, Wisconsin

STATE OF WISCONSIN  
RECEIVED AND FILED

APR 12 1988

NICHOLAS LA FOLLETT  
SECRETARY OF STATE

ORDINANCE 88-559

An ordinance annexing territory in Section 33, T3N, R13E, Town of Harmony, Rock County, Wisconsin.

WHEREAS, a petition has been filed with the City Clerk, signed by the owner(s) of all the land within such territory; and

WHEREAS, all the electors residing in such territory have signed the petition; and

WHEREAS, the necessary notices have been given; and

WHEREAS, this ordinance does not contain temporary zoning, and

WHEREAS, the Department of Development has not found the proposed annexation to be against the public interest; and

WHEREAS, the Common Council has determined that the annexation is in the public interest.

NOW THEREFORE, THE COMMON COUNCIL OF THE CITY OF JANESVILLE DO ORDAIN AS FOLLOWS:

Section I. the territory described as follows is hereby annexed to the City of Janesville:

Part of the SW 1/4 of Section 33, T.3N., R.13E., of the 4th PM., Harmony Township, Rock County, Wisconsin.

Commencing at the south 1/4 corner of said Section, thence N. 0° 07' 05"W. along the north-south centerline of said Section, 50.02 feet to the place of beginning for the land to be herein described; thence N. 88° 38' 30"W. along a line parallel to and 50 feet northerly of the south line of said SW. 1/4, 2,288.59 feet to the east line of a certified survey map as recorded in Volume 11, Pages 31 and 32; thence N. 0° 04' 05"W. along said East line, 660.00 feet to the north line of said certified survey map; thence N. 88° 38' 30"W. along said north line 160.0 feet; thence N. 0° 04' 05"W. parallel with and 200 feet east of the west line of said SW 1/4, 1,920.07 feet to the east-west centerline of said Section; thence S. 88° 44' 50"E. along said east-west centerline 1,123.12 feet to the west line of the NE 1/4 of said SW 1/4; thence S. 0° 05' 35" E. along said West line 1,316.08 feet to the south line of the NE 1/4 of said SW 1/4; thence S. 88° 41' 40"E. along said south line, 1,323.72 feet to the north-south centerline of said Section; thence S. 0° 07' 05" E. along said north-south centerline 1,267.30 feet to the place of beginning. Containing 102.63 acres.

STATE OF WISCONSIN  
RECEIVED AND FILED

APR 12 1988

WILLIAM LA FOLLETT  
SECRETARY OF STATE

Section II. After the annexation becomes effective, the above described property shall be exempt from further taxation and assessments in the Town of Harmony and henceforth shall be subject to taxation and assessments as a part of the City of Janesville for any and all purposes provided by law.

Section III. All the territory annexed by this ordinance is hereby made part of Ward 16 of the City of Janesville.

Section IV. All territory annexed by this ordinance, being already a part of the Janesville School District, will have no effect on the size or shape of said school district.

ADOPTED: 21 MARCH 1988

APPROVED:

Steven E. Sheiffer  
City Manager

ATTEST:

Frank L. Spoden  
Frank Spoden, City Clerk

Proposed by: City Planning Department  
Prepared by: City Planning Department

STATE OF WISCONSIN  
RECEIVED AND FILED

APR 12 1988

WALDEMAR K. HOFF  
SECRETARY OF STATE

State of Wisconsin )  
County of Rock ) ss.

I do hereby certify that this is a true and correct copy of an ordinance adopted by the Common Council of the City of Janesville on 21 March 1988.

Frank L. Spoden  
(Deputy) City Clerk

7 April 1988  
Date

OFFICE OF CITY ATTORNEY	
APPROVED/FORN	<u>Waldemar Hoff</u>
DATE	<u>2/16</u> 19 <u>88</u>
CITY OF JANESVILLE	

FLOOD ANNEXATION TO THE CITY OF JANESVILLE  
WRIGHT ROAD / RACINE ST.

6901

DEPARTMENT OF  
PUBLIC SAFETY

FEB 22 1988

Received  
for File Service

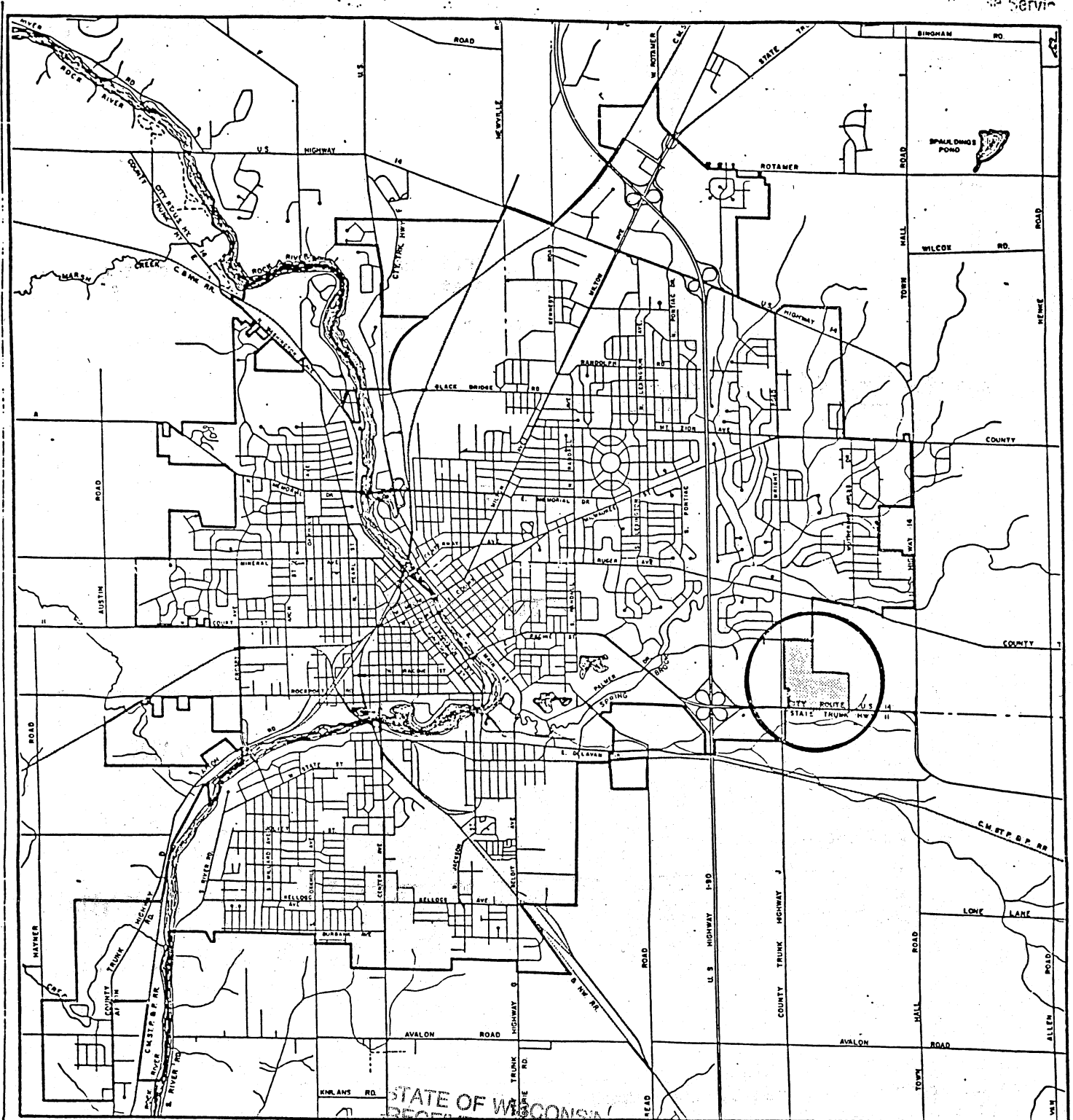

STATE OF WISCONSIN  
RECEIVED AND FILED

SCALE: 1" = 1 MILE

APR 12 1988

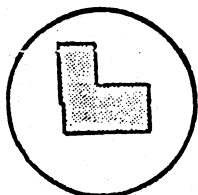

SUBJECT SITE  
SECRETARY OF STATE

FLOOD ANNEXATION TO THE CITY OF JANESVILLE  
WRIGHT ROAD / RACINE ST.

6901 OF  
IT

FEB 22 1988

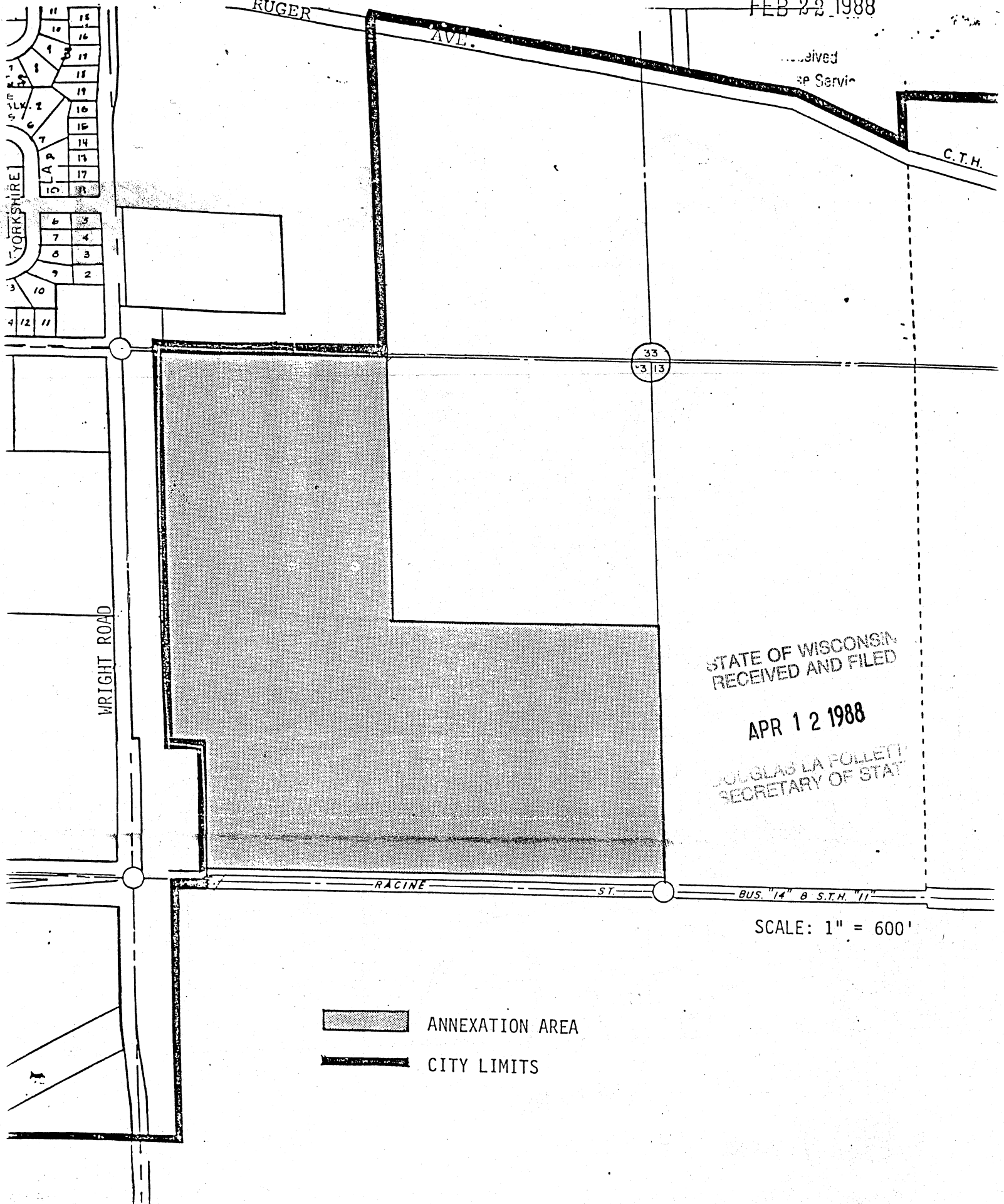

STATE OF WISCONSIN  
RECEIVED AND FILED

APR 12 1988

DOUGLAS LA FOLLETT  
SECRETARY OF STATE

ANNEXATION AREA  
CITY LIMITS

SCALE: 1" = 600'