

CITY OF JANESVILLE

COUNTY OF ROCK

Annexation and Plat Map

OFFICE OF THE SECRETARY OF STATE
State of Wisconsin

Filed: April 11, 1989

DOUGLAS LA FOLLETTE



SECRETARY OF STATE
WISCONSIN

Department of Transportation
Room 951
Hill Farm State Office Building
Madison WI

Attn: John Pamperin

Dear Sir:

Pursuant to Wis. Stats. 66.021/66.025, we are pleased to enclose, in duplicate, certificate and plat relating to annexation of territory adopted by the Common Council of the City of Janesville, County of Rock on April 3, 1989.

Sincerely,

A handwritten signature in cursive script that reads "Douglas La Follette".

DOUGLAS LA FOLLETTE
Secretary of State

cc: Depts. of:

Administration
Development
Public Instruction
Revenue

Clerk
File

CITY of JANESVILLE

Department of City Clerk-Treasurer

6 April 1989

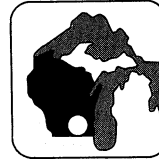

Municipal Building
18 North Jackson Street
Janesville, WI 53545

608-755-3000

The Honorable Douglas LaFollette
Secretary of State
State Capitol Building
Madison, Wisconsin 53702

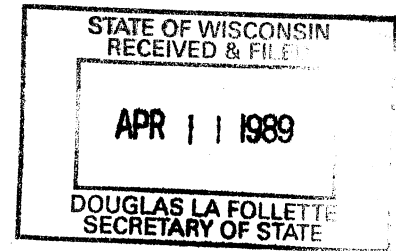

Greetings:

Pursuant to State Statute Section 66.021 (8), I am enclosing a copy of the following, pertaining to our recent annexation:

1. Certificate of Annexation
2. Certified copy of Ordinance No. 89-616
3. Plat of Annexation

The ordinance was adopted by the Common Council of the City of Janesville at their regularly scheduled meeting held 3 April 1989.

I hereby certify that there are no electors in this area. All territory covered by this ordinance is hereby made a part of Ward 16 - City of Janesville.

Sincerely,

Frank L. Spoden
City Clerk-Treasurer

hrp
Enclosures

CERTIFICATE OF ANNEXATION

STATE OF WISCONSIN)
 SS.
COUNTY OF ROCK)

I, Frank L. Spoden, City Clerk of the City of Janesville, Rock County, Wisconsin, do hereby certify that the following described territory was detached from the Town of Harmony, Rock County, Wisconsin, all pursuant to Section 66.021 (8) of the Wisconsin Statutes, by an ordinance adopted by the Common Council on 3 April 1989.

Part of the SE.1/4 of the NE.1/4 and part of the NE.1/4 of the SE.1/4 of Section 17, T.3N., R.13E. of the 4th P.M. Harmony Township, Rock County, Wisconsin.

Commencing at the East $\frac{1}{4}$ corner of said Section; then N.0° 54'40"W., along the east line of said NE. $\frac{1}{4}$ of said Section, 675.33 feet to the place of beginning for the land to be herein described; thence N.88° 18'45"W. 735.85 feet; thence S.24° 43'30"W. 133.76 feet; thence S.56° 55'40"W. 80.43 feet; thence S. 44° 55'45"W. 108.47 feet; thence N.56° 26'50"W. 21.73 feet; thence S.27° 01'50"W. 112.52 feet; thence S.1° 08'30"W. 78.47 feet; thence S.14° 07'35"W. 92.52 feet; thence S.34° 32'35"E. 108.17 feet; thence S.0° 51'E. 90.00 feet; thence S.89° 09'W. 130.0 feet; thence S.33° 04'35"W. 125.42 feet; thence N.88° 16'25"W. 150 feet more or less to the west line of said NE. $\frac{1}{4}$ of said SE. $\frac{1}{4}$ of said Section; thence northerly along said west line 125 feet more or less to the SW. corner of said SE. $\frac{1}{4}$ of said NE. $\frac{1}{4}$ of said Section; thence N.0° 51'W., along the west line of said SE. $\frac{1}{4}$ of said NE. $\frac{1}{4}$ of said Section, 738.88 feet to the SW. corner of a public park as dedicated upon Briar Crest East, a recorded subdivision; then S.88° 18'20"E. 1,323.57 feet to said East line of said NE. $\frac{1}{4}$; thence S.0° 54'40"E. along said east line 64.47 feet to the place of beginning. Containing 8.59 acres.

Attached to this Certificate is a map showing the boundaries of the area so attached to the City of Janesville, which map is incorporated in and forms a part of this Certificate by reference.

Dated: 6 April 1989

Frank L. Spoden
Frank L. Spoden
City Clerk, City of Janesville

Ref: Ord. No. 89-616

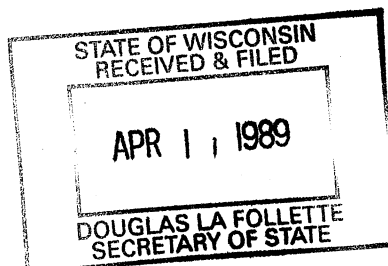

ORDINANCE 89-616

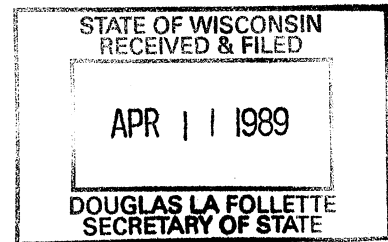

An ordinance annexing land in Section 17, T3N., R13E., Town of Harmony, Rock County, Wisconsin.

WHEREAS, a petition has been filed with the City Clerk, signed by all of the owners of real property within such territory; and

WHEREAS, there are no electors residing within such territory; and

WHEREAS, this ordinance does not contain temporary zoning; and

WHEREAS, the Department of Development has not found the proposed annexation to be against the public interest; and

WHEREAS, the City Council has determined that the annexation is in the public interest.

NOW THEREFORE, THE COMMON COUNCIL OF THE CITY OF JANESVILLE DO ORDAIN AS FOLLOWS:

SECTION I. The territory described as follows is hereby annexed to the City of Janesville:

Part of the SE.1/4 of the NE.1/4 and part of the NE.1/4 of the SE.1/4 of Section 17, T.3N., R.13E. of the 4th P.M. Harmony Township, Rock County, Wisconsin.

Commencing at the East $\frac{1}{4}$ corner of said Section; then N.0° 54'40"W., along the east line of said NE. $\frac{1}{4}$ of said Section, 675.33 feet to the place of beginning for the land to be herein described; thence N.88° 18'45"W. 735.85 feet; thence S.24° 43'30"W. 133.76 feet; thence S.56° 55'40"W. 80.43 feet; thence S. 44° 55'45"W. 108.47 feet; thence N.56° 26'50"W. 21.73 feet; thence S.27° 01'50"W. 112.52 feet; thence S.1° 08'30"W. 78.47 feet; thence S.14° 07'35"W. 92.52 feet; thence S.34° 32'35"E. 108.17 feet; thence S.0° 51'E. 90.00 feet; thence S.89° 09'W. 130.0 feet; thence S.33° 04'35"W. 125.42 feet; thence N.88° 16'25"W. 150 feet more or less to the west line of said NE. $\frac{1}{4}$ of said SE. $\frac{1}{4}$ of said Section; thence northerly along said west line 125 feet more or less to the SW. corner of said SE. $\frac{1}{4}$ of said NE. $\frac{1}{4}$ of said Section; thence N.0° 51'W., along the west line of said SE. $\frac{1}{4}$ of said NE. $\frac{1}{4}$ of said Section, 738.88 feet to the SW. corner of a public park as dedicated upon Briar Crest East, a recorded subdivision; then S.88° 18'20"E. 1,323.57 feet to said East line of said NE. $\frac{1}{4}$; thence S.0° 54'40"E. along said east line 64.47 feet to the place of beginning. Containing 8.59 acres.

SECTION II. After the annexation becomes effective, the above described property shall be exempt from further taxation and assessments in the Town of Harmony and henceforth be subject to taxation assessments as part of the City of Janesville for any and all purposes provided by law.

SECTION III. All of the territory covered by this ordinance is hereby made a part of Ward 16 of the City of Janesville.

Adopted: 3 April 1989

APPROVED:

Steven E. Sheiffer
Steven E. Sheiffer
City Manager

ATTEST:

Frank Spoden
Frank Spoden, City Clerk

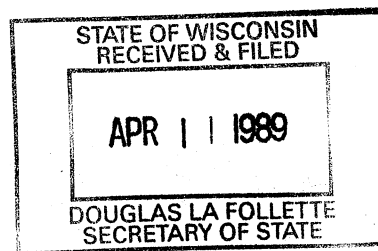

Proposed by: Applicant
Prepared by: City Planning Department

State of Wisconsin)
County of Rock)^{ss.}

I do hereby certify that this is a true and correct copy of an ordinance adopted by the Common Council of the City of Janesville, Wi. on 3 April 1989.

Frank Spoden
(Deputy) City Clerk

4-6-89
Date

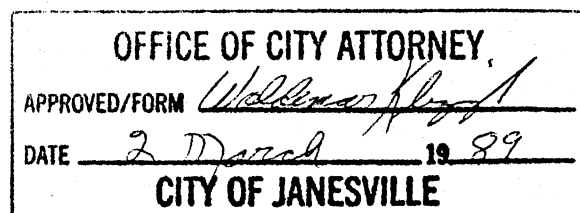

LOCATION
MAP

PROPOSED ANNEXATION & ZONING
DON MARKLEIN ET. AL.

MAP COORD
Q-21

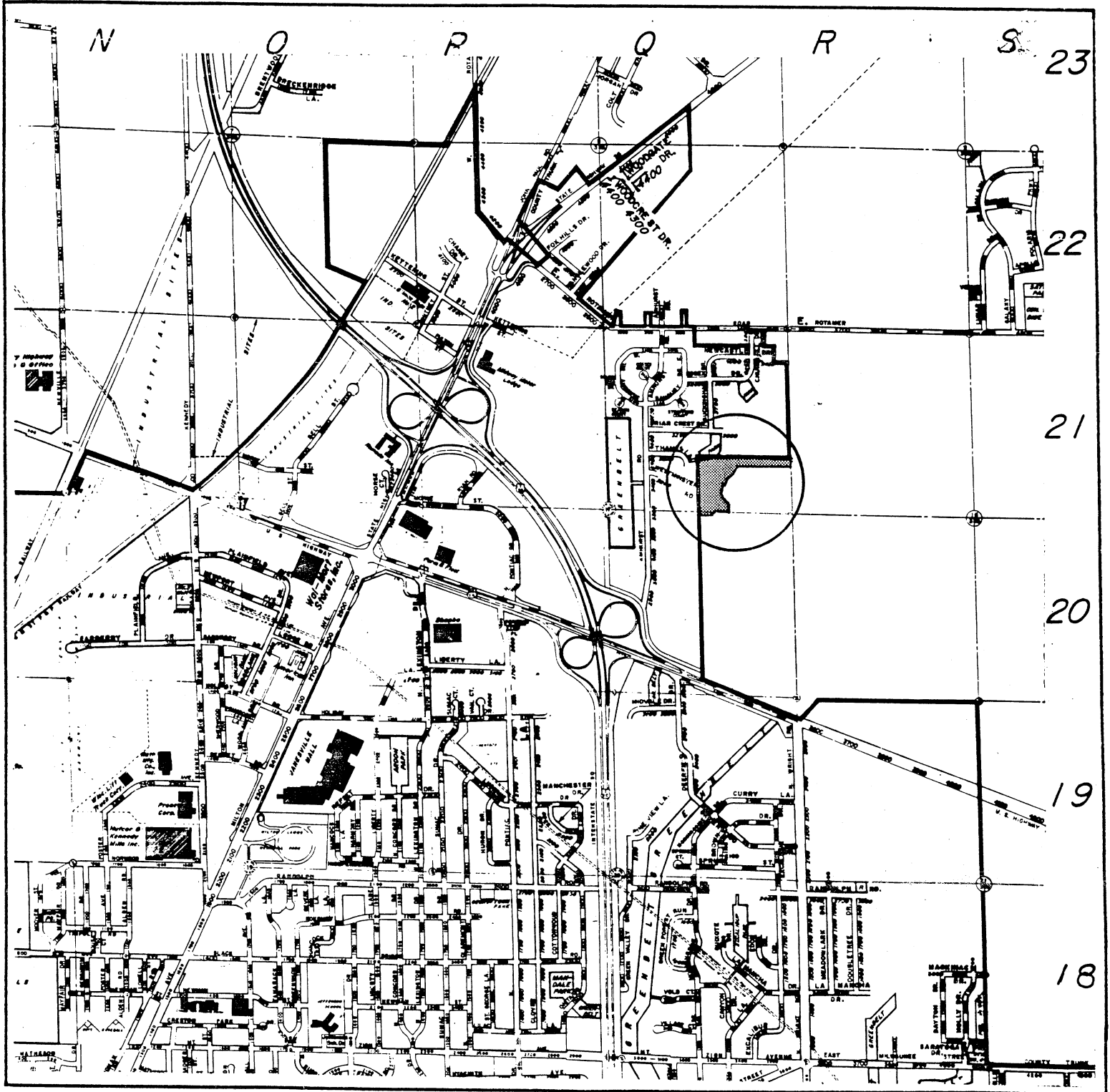

LEGEND

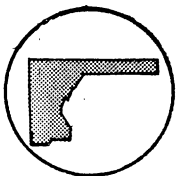

SUBJECT SITE

STATE OF WISCONSIN
RECEIVED & FILED

APR 11 1989

DOUGLAS LA FOLLETT
SECRETARY OF STATE

LAS

DATE:
2/89

SCALE:
1"=2000'



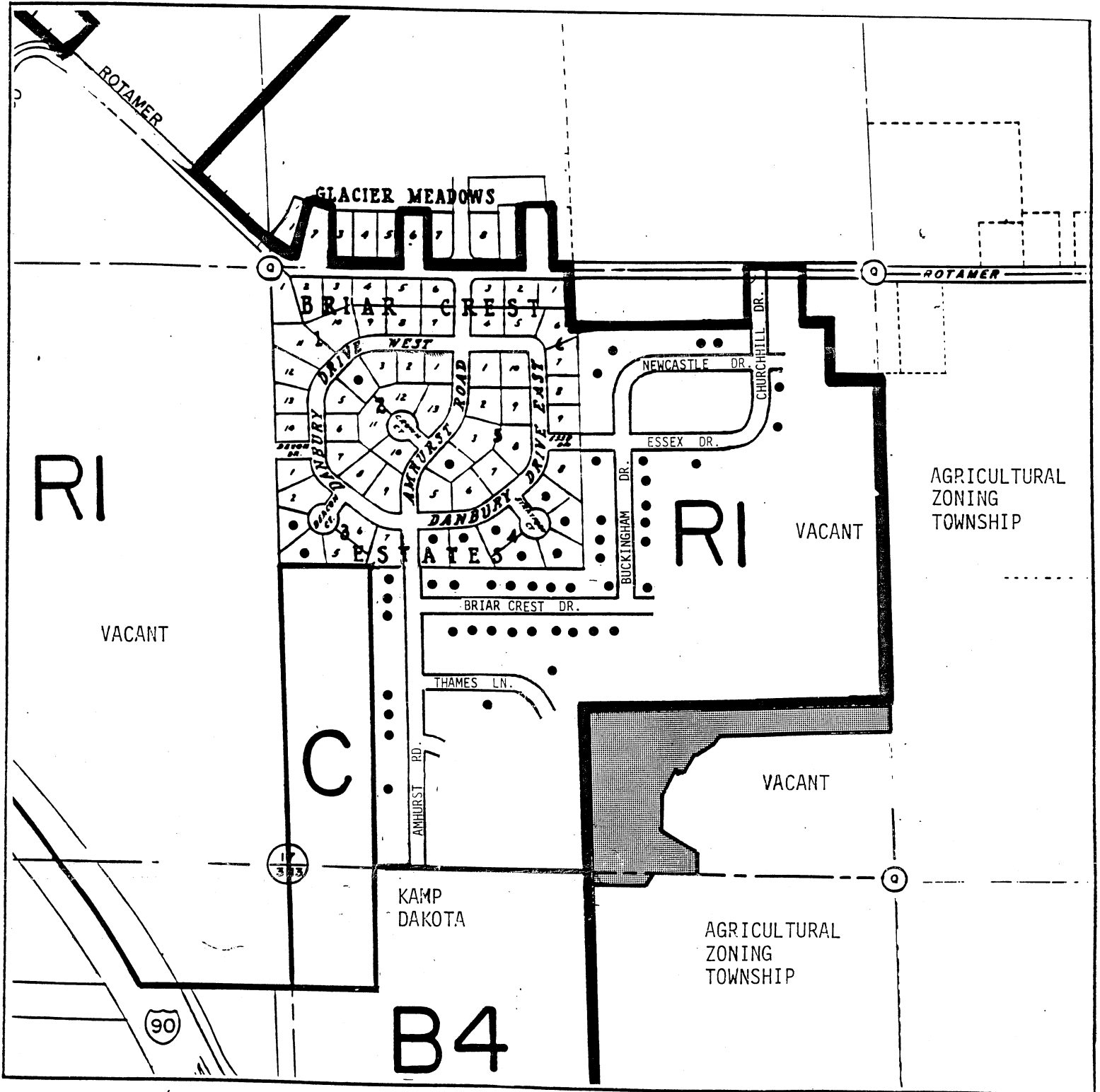

LEGEND



CITY LIMITS
SINGLE FAMILY

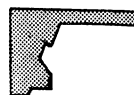

SUBJECT SITE

LAS

DATE:

3/89

SCALE:

1"=600'



NORTH