

CITY OF HARTFORD

COUNTIES OF WASHINGTON & DODGE

ANNEXATION & PLAT

ORDINANCE # 848

OFFICE OF THE SECRETARY OF STATE
State of Wisconsin

FILED JULY 25, 1994

MEMORANDUM

OFFICE OF THE SECRETARY OF STATE

STATE OF WISCONSIN

Date: 8-3-94

From: Government Records Division
Ginny Bormann, Records Specialist
30 West Mifflin Street, 10th Floor
P. O. Box 7848
Madison, WI 53707-7848

To: Mary Marsden
Department of Transportation
Room 951, Hill Farm State Office Bldg.

RE: Municipal filing distribution

Attached please find a municipal filing submitted to the Office of the Secretary of State pursuant to Chapter 66, Wis. Stats.

cc: Frank Humphrey, Dept of Revenue
Paul Endres, Dept of Public Instruction
George Hall, DOA/Energy & Intergovernmental Relations
Bob Naylor, Dept of Administration
Kate Lawton, DATCP
Scott Hausmann, Dept of Natural Resources
Clerk
File



CITY HALL
109 NORTH MAIN STREET
HARTFORD, WI 53027-1591

July 21, 1994

Mr. Douglas LaFollette
Secretary of State
State of Wisconsin
State Capitol
Madison, WI 53702

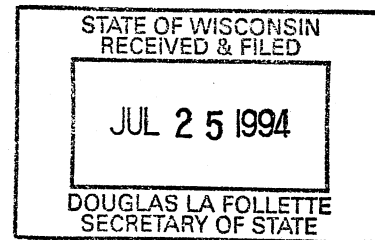

Dear Mr. LaFollette:

Enclosed are eight (8) certified copies each of Ordinances 845, 846, 848, and 850.

You will also find a map attached to each Ordinance indicating the location of the annexation.

If your office should need any additional information, please feel free to contact my office at (414) 673-8202.

Sincerely,

CITY OF HARTFORD

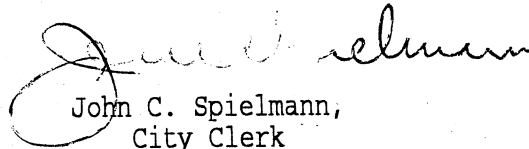
John C. Spielmann,
City Clerk

JCS:pb
072194L1
enclosures

cc: Washington County Register of Deeds
Washington County Clerk
Wisconsin Gas Company
Wisconsin Electric Power Company
Ameritech
Hartford Common School District Clerk
Hartford Union High School District Clerk

FAX (414) 673-8218

PUBLIC WORKS / ENGINEERING / INSPECTION / PLANNING

(414) 673-8260

CITY CLERK (414) 673-8202 • ADMINISTRATOR (414) 673-8204 • TREASURER (414) 673-8207 • UTILITIES (414) 673-8209

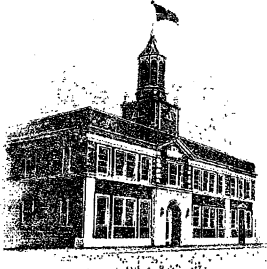

CITY HALL
 109 NORTH MAIN STREET
 HARTFORD, WI 53027-1591

CLERK'S CERTIFICATE

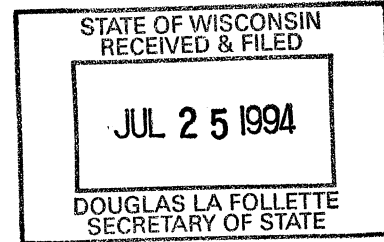

STATE OF WISCONSIN)
 COUNTIES OF WASHINGTON/DODGE) SS
 CITY OF HARTFORD)

I, JOHN C. SPIELMANN, the duly appointed, qualified and acting Clerk of the City of Hartford, Washington and Dodge Counties, Wisconsin, do hereby certify that the attached copy of Ordinance No. 848 (AN ORDINANCE ANNEXING TERRITORY TO THE CITY OF HARTFORD 5.70 ACRES OF LAND LYING SOUTH OF STATE TRUNK HIGHWAY 60 AND WEST OF TERI LANE, INCLUDING A PORTION OF THE TERI LANE RIGHT-OF-WAY (LANDS OWNED BY THOMAS AND ELAINE ZUERN, MICHAEL AND CHRISTINE TULACH, AND FRANKLIN AND MYRNA KEMPF)), as adopted at the City of Hartford Common Council meeting held on the 22nd day of March, 1994, is a true and exact copy of the original document that is on file in my office.

The description on said ordinance represents an area of land that was detached from the Town of Hartford and annexed to the City of Hartford.

In accordance with the current statutory requirements for annexation, I further certify that the population of said annexed territory was five (5) as of the date of the adoption of Ordinance 848.

Dated this 21st day of July, 1994.

(SEAL)

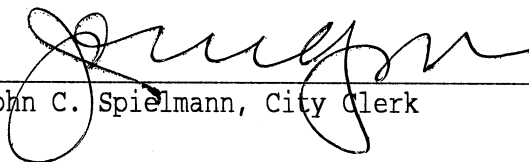

 John C. Spielmann, City Clerk

ORDINANCE 848

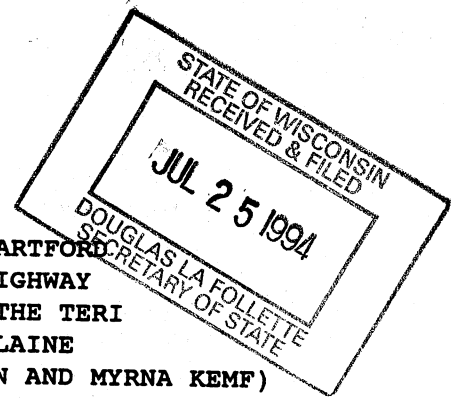

AN ORDINANCE ANNEXING TERRITORY TO THE CITY OF HARTFORD
5.70 ACRES OF LAND LYING SOUTH OF STATE TRUNK HIGHWAY
60 AND WEST OF TERI LANE, INCLUDING A PORTION OF THE TERI
LANE RIGHT-OF-WAY, (LANDS OWNED BY THOMAS AND ELAINE
ZUERN, MICHAEL AND CHRISTINE TULACH, AND FRANKLIN AND MYRNA KEMF)

The Common Council of the City of Hartford, Washington/Dodge
Counties, Wisconsin, do ordain as follows:

SECTION 1. TERRITORY ANNEXED. In accordance with Section 66.021
of Wisconsin Statutes, the following described territory located in the
Town of Hartford, Washington County, Wisconsin, is annexed to the City
of Hartford, Wisconsin.

All of Lots 5, 6, 7 and part of the right-of-way of Teri Lane of
the Plat of Lake View Acres, being located in the Southwest 1/4 of
the Northwest 1/4 of Section 23, Town 10 North, Range 18 East, Town
of Hartford, Washington County, Wisconsin, the Parcel is more
particularly described as follows:

Beginning at the Southwest corner of said Lot 5; thence, along the
Westerly line of Lots 5 and 6, N 19o 14' 00" W, 392.71 feet;
thence, along the North line of said Lots 6 and 7 and its Easterly
extension thereof, N 70o 46' 00" E, 698.01 feet to the Easterly
right-of-way line of Teri Lane; thence, along said right-of-way
line the following courses:

1. thence S 19o 14' 00" E, 75.00 feet to the beginning of a
curve to the right having a radius of 143.72 feet and a chord
which bears S 00o 43' 00" E, 91.29 feet;
2. thence, Southerly, 92.90 feet along the arc of said curve
through a central angle of 37o 02' 07" W to the point of
tangency thereof;
3. thence S 17o 48' 00", 125.15 feet to the beginning of a
curve to the right having a radius of 75.00 feet and a chord
which bears S 73o 23' 27" W, 123.75 feet;
4. thence Southwesterly, 145.54 feet along the arc of said curve
through a central angle of 111o 10' 53" to the Easterly line
of said Lot 5;

thence, along said Easterly line, S 06o 50' 00" W, 189.76 feet;
thence, continuing along said Easterly line, S 17o 48' 00" W, 61.69
feet to the Southerly line of said Lot 5; thence, along said
Southerly line, S 89o 42' 00" W, 170.57 feet; thence, continuing
along said Southerly line, S 79o 04' 00" W, 190.14 feet to the
point of beginning.

Bearings shown hereon are oriented to the Plat of Lake View Acres.

SECTION 2. EFFECT OF ANNEXATION. From and after the date and
filing of this Ordinance, the territory described in Section 1 shall be

a part of the City of Hartford for any all purposes provided by law and all persons coming or residing within such territory shall be subject to all ordinances, rules and regulations governing the City of Hartford.

SECTION 3. ZONING CLASSIFICATION. This property shall be zoned as follows: Lot 5 of Lake Acres Subdivision to be Rs-1 Residential Single Family District, the remainder of land annexed to be zoned A-1 Agricultural District.

SECTION 4. ALDERMANIC DISTRICT DESIGNATION. The territory described in Section 1 of this Ordinance is hereby made a part of the First Aldermanic District of the City of Hartford, subject to the ordinance, rules and regulations of the City governing aldermanic districts.

SECTION 5. EFFECTIVE DATE. This ordinance shall take effect upon passage and publication as provided by law.

Signed:

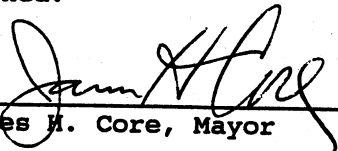
James M. Core, Mayor

Introduced: March 22, 1994

Adopted: March 22, 1994

Attest:

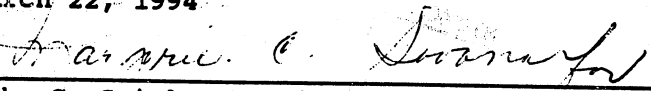
John C. Spielmann, City Clerk

ORD848

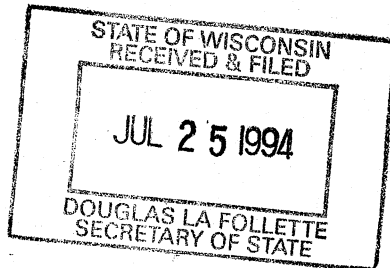

STATE OF WISCONSIN
 RECEIVED & FILED
 JUL 25 1994
 DOUGLAS LA FOLLETTE
 SECRETARY OF STATE

EXHIBIT "B" ANNEXATION MAP

ALL OF LOTS 5, 6, 7 AND A PART OF THE RIGHT-OF-WAY OF TERI LANE OF THE PLAT OF LAKE VIEW ACRES, BEING LOCATED IN THE SOUTHWEST 1/4 OF THE NORTHWEST 1/4 OF SECTION 23, TOWN 10 NORTH, RANGE 18 EAST, TOWN OF HARTFORD, WASHINGTON COUNTY, WISCONSIN.

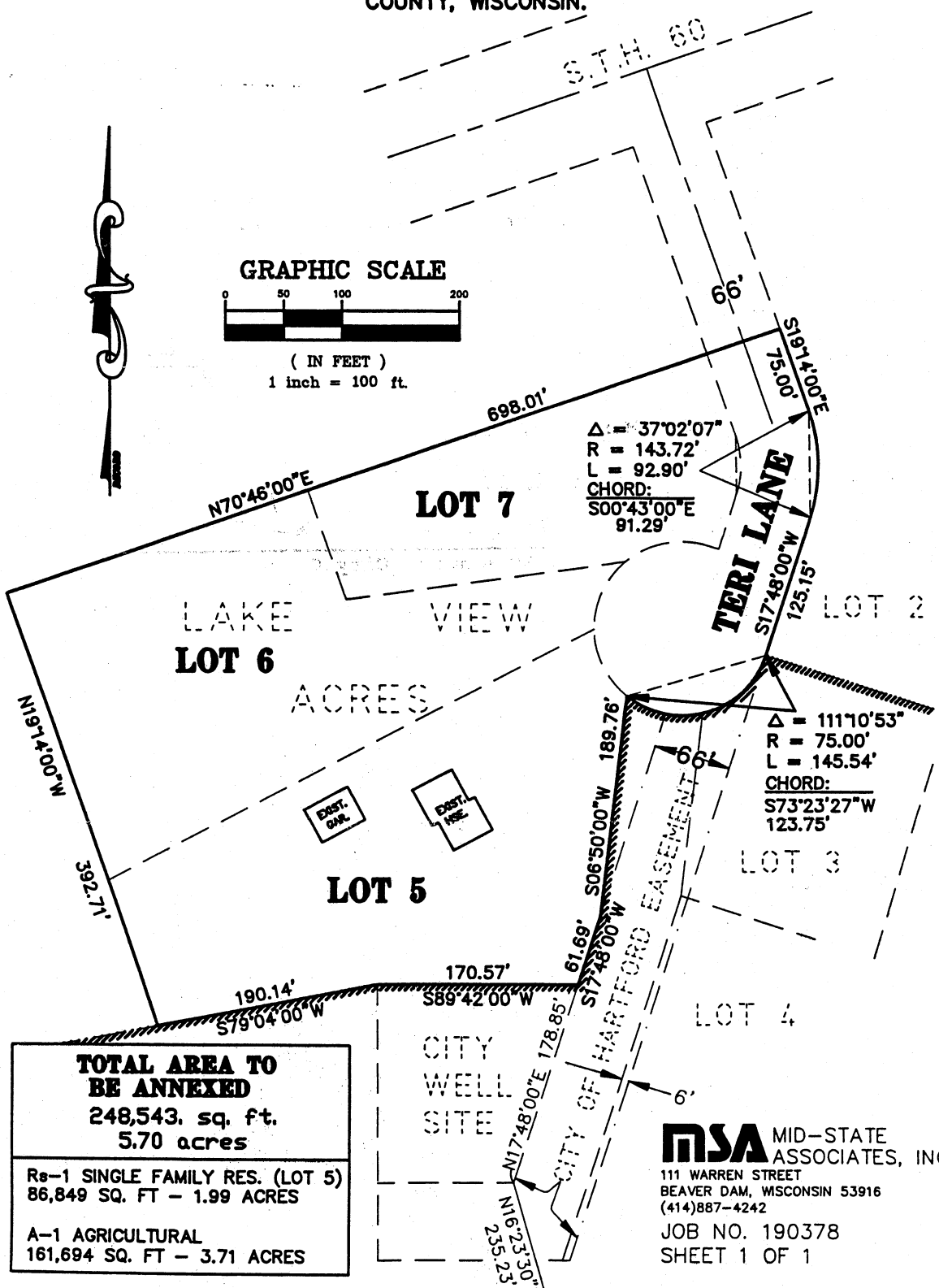
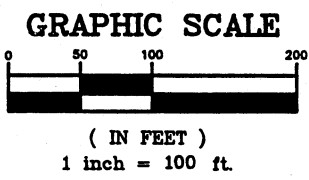

TOTAL AREA TO BE ANNEXED
 248,543. sq. ft.
 5.70 acres

Rs-1 SINGLE FAMILY RES. (LOT 5)
 86,849 SQ. FT - 1.99 ACRES

A-1 AGRICULTURAL
 161,694 SQ. FT - 3.71 ACRES

NSA MID-STATE ASSOCIATES, INC.
 111 WARREN STREET
 BEAVER DAM, WISCONSIN 53916
 (414)887-4242
 JOB NO. 190378
 SHEET 1 OF 1

WEST 1/4 CORNER SEC. 23-10-18 N88°33'00"E 696.83' E-W 1/4 LINE