

Wausau
(Marathon County)

ANNEXATION OF TERRITORY

State of Wisconsin)
Department of State) ss.

Received and filed this 23rd

day of April A.D. 19..... 76

Douglas LaFollette

.....
Secretary of State

CITY OF WAUSAU

WAUSAU, WISCONSIN 54401

C E R T I F I C A T I O N

I, Ernest J. Cherney, do hereby certify that I am the duly qualified and acting City Clerk of and for the City of Wausau, Marathon County, Wisconsin. Acting in that capacity, I do further certify that the accompanying ordinance annexing territory to the City of Wausau from the Town of Wausau is a true and correct copy of an ordinance adopted by the Common Council of the City of Wausau on the 13th day of April, 1976; and there was no change to the population of the City of Wausau as a result of this annexation.

Dated this 20th day of April, 1976.

City of Wausau, Marathon County, Wisconsin.



Ernest J. Cherney
City Clerk
Wausau, Wisconsin

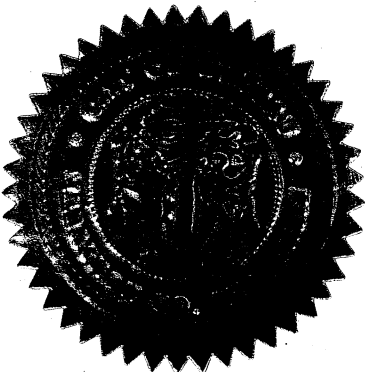

CITY OF WAUSAU, WISCONSIN

AN ORDINANCE Annexing Territory to the
City of Wausau, Wisconsin.

FILE NO. 76-0302
Ordinance No. 497-76C
Introduced April 13, 1976
Referred _____
Adopted April 13, 1976
Other _____

AN ORDINANCE

The Common Council of the City of Wausau, Wisconsin, do ordain as follows:

Section 1. Territory Annexed. In accordance with Chapter 66, Wisconsin Statutes (1973), and the petition for unanimous direct annexation signed by John Schauss, Jr. and Lydia Schauss, sole owners of the land within the territory described below, now located in the Town of Wausau, Marathon County, Wisconsin, is hereby annexed to the City of Wausau:

Maple Hill Addition to Arnold Taschler Subdivision, except Lot 165 thereof, and 60 feet South and adjacent to Lot 165, and also except the North 180.00 feet of said Addition.

Section 2. Effect of Annexation. From and after the date of publication of this ordinance the territory described in Section 1 shall be a part of the City of Wausau, for any and all purposes provided by law, and all persons coming or residing within such territory shall be subject to all ordinances, rules and regulations governing the City of Wausau.

Section 3. Zoning Classification. Zoning of the within lands shall be pursuant to sec. 23.04.040, Zoning of Annexed Lands, of the Wausau Municipal Code. Upon recommendation of the Planning Commission and Zoning, Annexation & Industrial Park Committee the annexed territory shall be designated as a temporary R-3 zone.

Section 4. Aldermanic District. The territory described in Section 1 of this ordinance is hereby made a part of the Seventh Aldermanic District of the City of Wausau, subject to the ordinances, rules and regulations of the city governing districts.

Section 5. Severability. If any provision of this ordinance is invalid or unconstitutional, or if the application of this ordinance to any person or circumstance is invalid or unconstitutional such invalidity or unconstitutionality shall not affect the other provisions or applications of this ordinance, which can be given effect without the invalid or unconstitutional provision or application.

Section 6. Effective Date. This ordinance shall take effect upon passage and publication, as provided by law.

Approved:

Adopted: April 13, 1976
Approved: April 14, 1976
Published: *April 17, 1976*
Attest: April 14, 1976

John L. Kannenberg

Mayor

Attest:

Ernest J. Cherney

Clerk

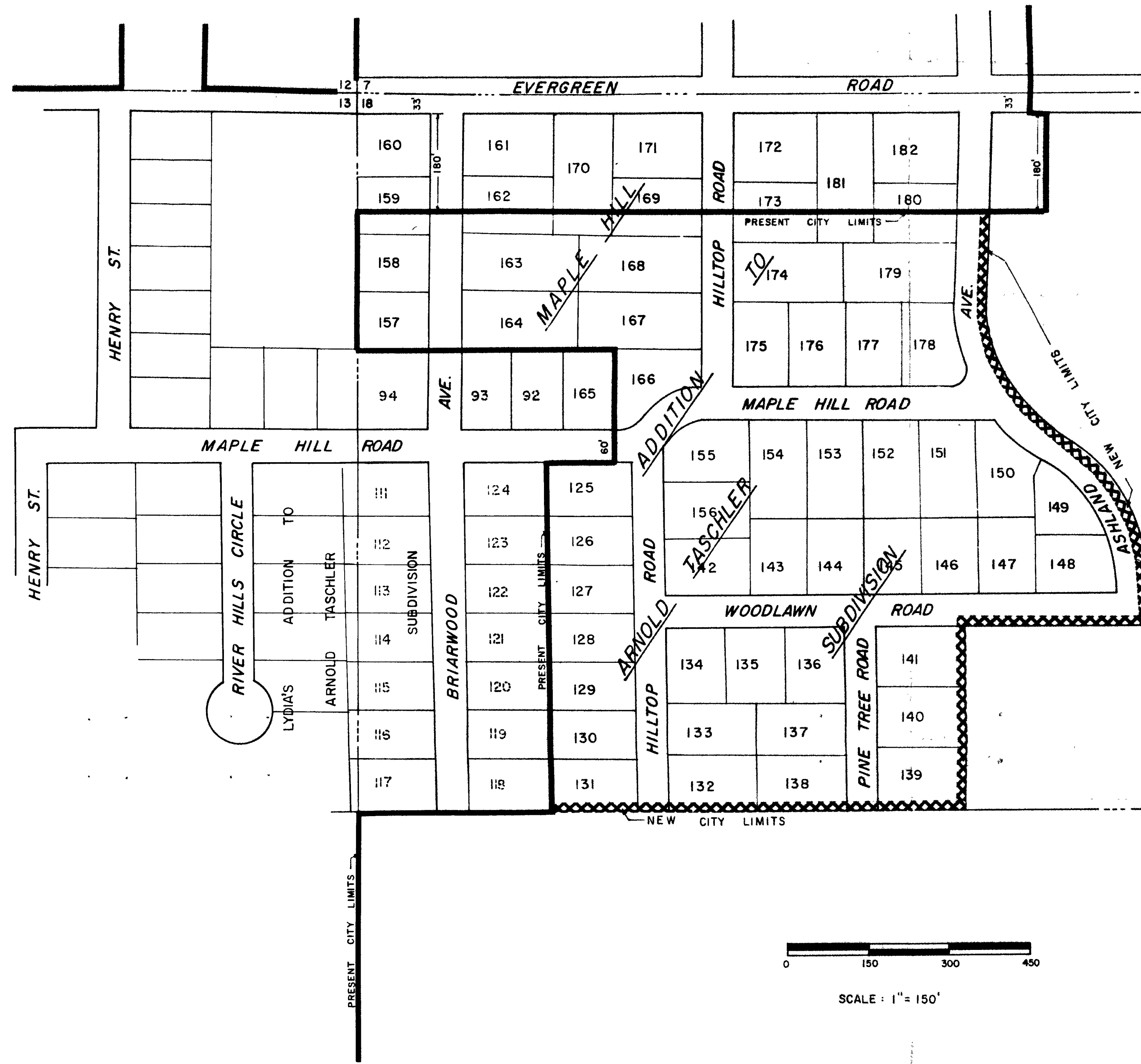
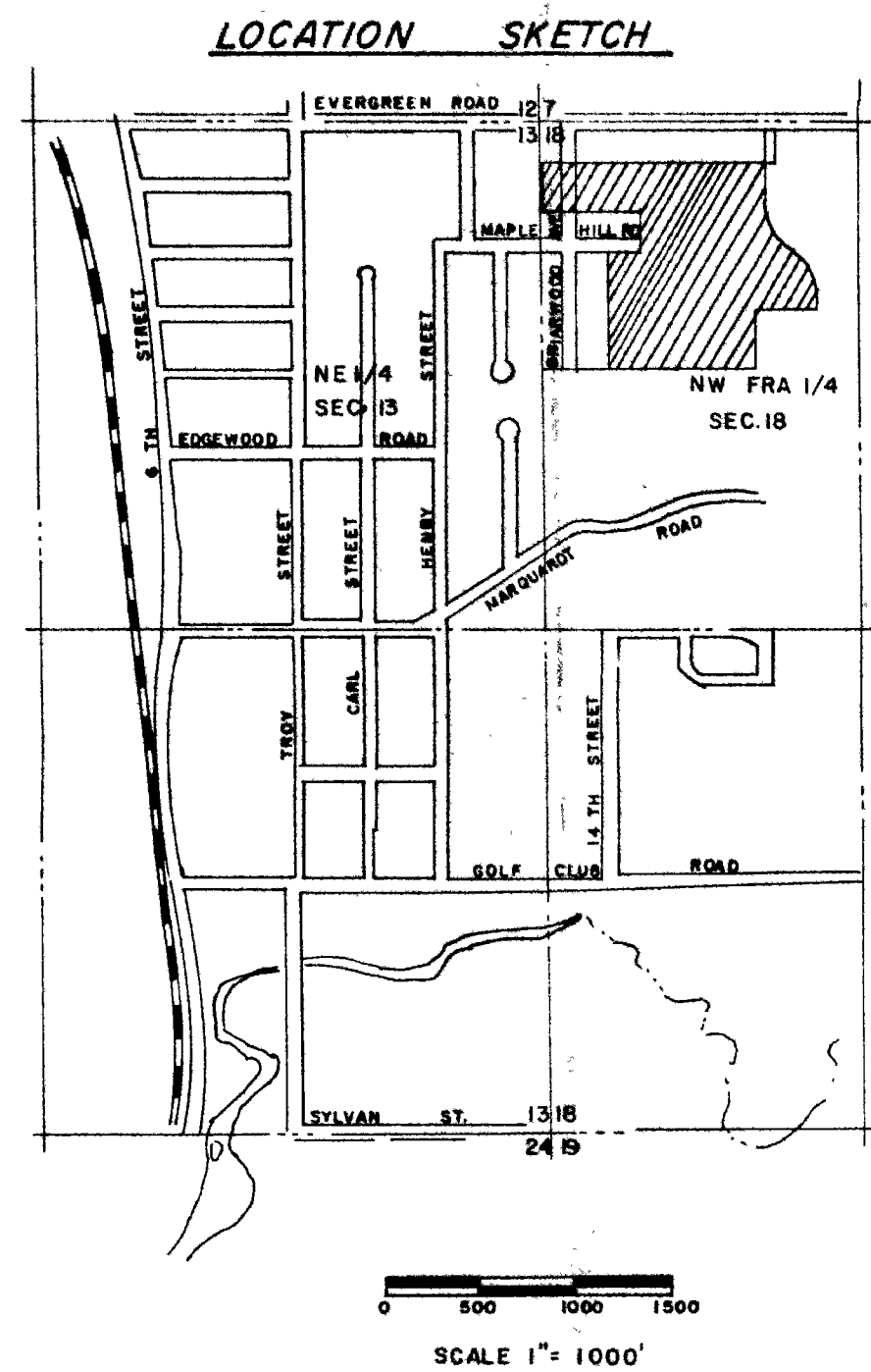

ENGINEER'S AFFIDAVIT

I, Fred B. Shrake, City Engineer (Registered Professional Engineer) do hereby certify that the herein disclosed land has been annexed to the City of Wausau, Wisconsin.

Maple Hill Addition to Arnold Taschler Subdivision, except Lot 165 thereof, and 60 feet South and adjacent to Lot 165, and also except the North 180.00 feet of said Addition.

Fred B. Shrake
Fred B. Shrake, P.E.

COMMON COUNCIL RESOLUTION

WHEREAS, a petition for annexation of a parcel of land located in the Town of Wausau and adjacent to the City of Wausau, has been properly submitted by the owners--John Schauss, Jr. and Lydia Schauss: Be it resolved that the proposed Ordinance No. 497-75C attached hereto be enacted by the Common Council.

State of Wisconsin)
County of Marathon) ss

I, Ernest J. Cherney, City Clerk, do hereby certify that the above was passed by the Common Council at its regular meeting held on the 13th day of April, 1976.

Ernest J. Cherney
Ernest J. Cherney
City Clerk

Subscribed and sworn to before me this 20th day of April, 1976,

Alice Cherney
Notary Public, Marathon County, WI
My commission: March 11, 1979

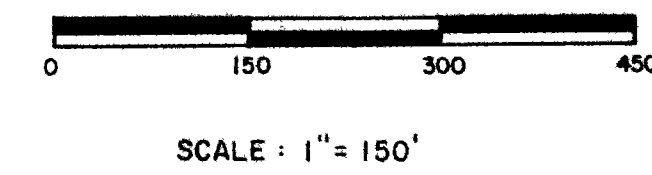

UTILITIES		CHK'D	PROJECT-- ANNEXATION OF LAND OF WAUSAU FROM THE
SANITARY			NO.--
STORM			LOCATION-- PART OF THE N1/2, N SEC. 18, TWP. 29 N., R. TOWN OF WAUSAU
WATER			RESOLUTION-- 76-0302 DA
TELEPHONE			ENGINEERING CITY of WAUSAU
ELECTRICAL			
GAS			FIELD BOOK
HEATING			SURVEYED
FIRE ALARM			DRAWN
LIGHTING			PRELIMINARY
BENCH MARKS			FINAL
MONUMENTS			CHECKED
			APPROVED
			REVISIONS
			PAGE
			SHEET NO.--
			TOTAL SH

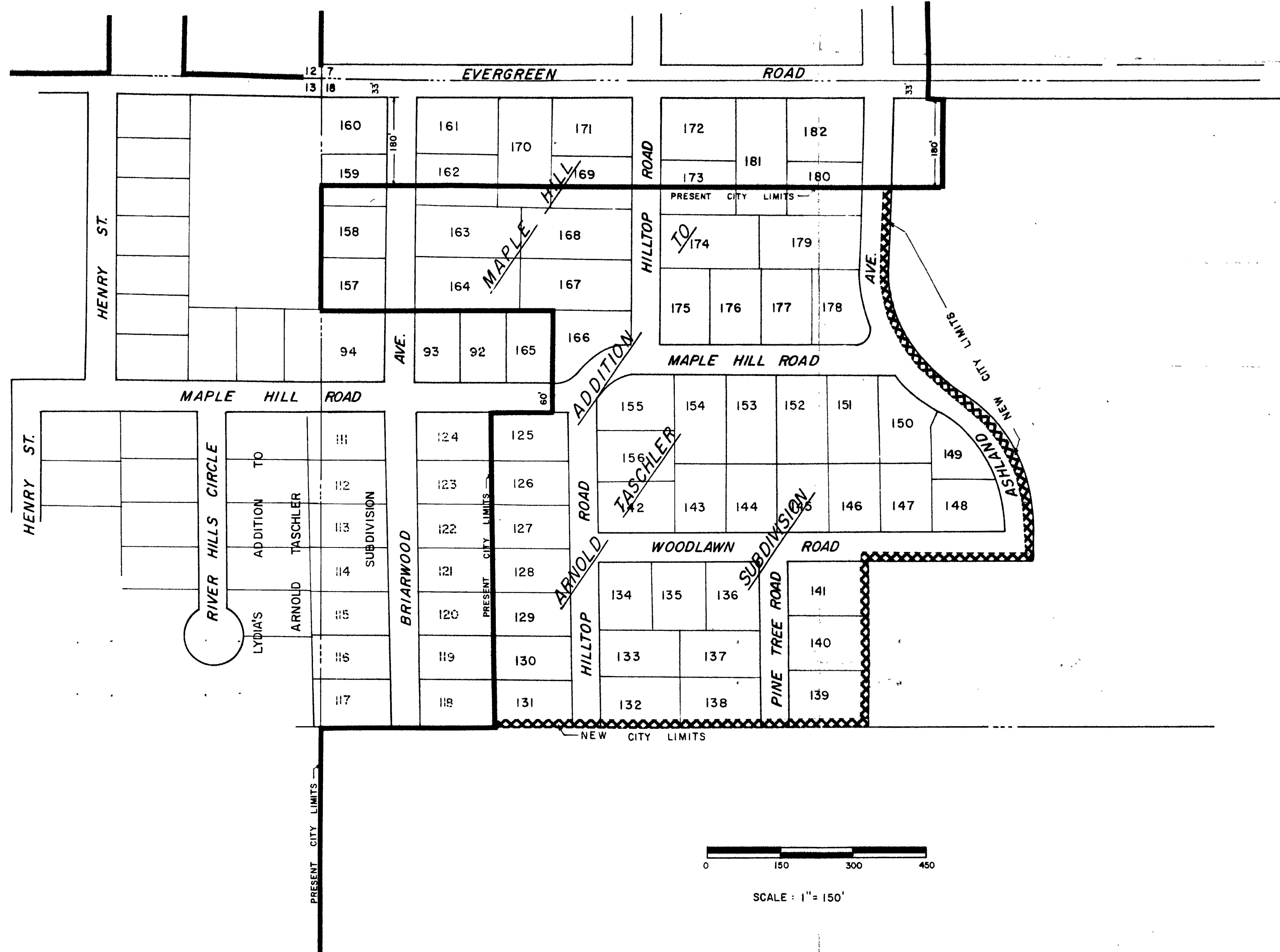
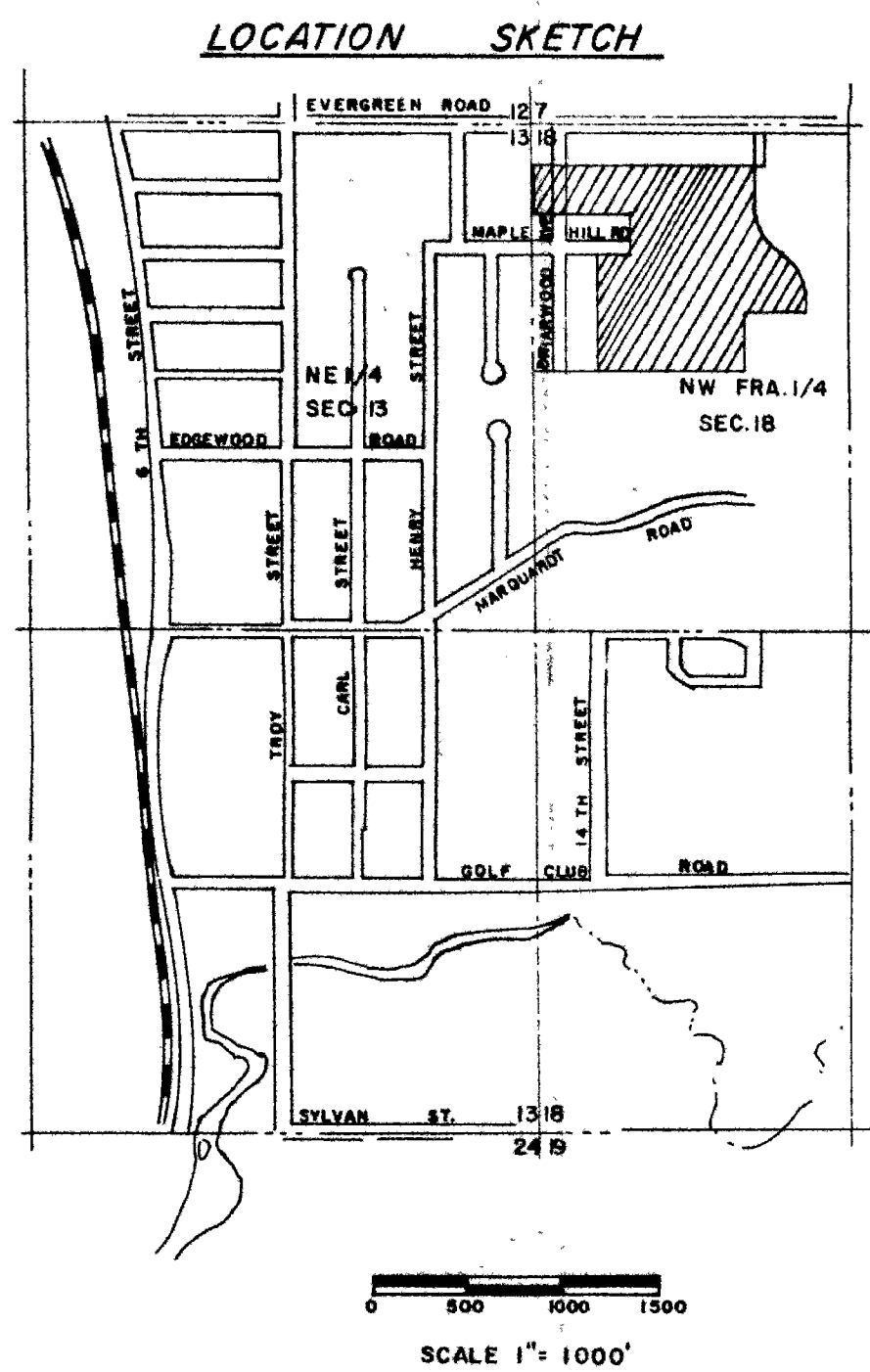

ENGINEER'S AFFIDAVIT

I, Fred B. Shrake, City Engineer (Registered Professional Engineer) do hereby certify that the herein disclosed land has been annexed to the City of Wausau, Wisconsin.

Maple Hill Addition to Arnold Taschler Subdivision, except Lot 165 thereof, and 60 feet South and adjacent to Lot 165, and also except the North 180.00 feet of said Addition.

Fred B. Shrake
Fred B. Shrake, P.E.

COMMON COUNCIL RESOLUTION

WHEREAS, a petition for annexation of a parcel of land located in the Town of Wausau and adjacent to the City of Wausau, has been properly submitted by the owners--John Schaus, Jr. and Lydia Schaus: Be it resolved that the proposed Ordinance No. 497-75C attached hereto be enacted by the Common Council.

State of Wisconsin) ss
County of Marathon)

I, Ernest J. Cherney, City Clerk, do hereby certify that the above was passed by the Common Council at its regular meeting held on the 13th day of April, 1976.

Ernest J. Cherney
Ernest J. Cherney
City Clerk

Subscribed and sworn to before me this 20th day of April, 1976,

Alice Cherney
Notary Public, Marathon County, WI
My commission: March 11, 1977

UTILITIES		CHK'D	PROJECT-- ANNEXATION OF LAND TO THE CITY OF WAUSAU FROM THE TOWN OF WAUSAU	
SANITARY			NO. --	
STORM			LOCATION-- PART OF THE N1/2, NW FRA. 1/4, SEC. 18, TWP. 29N., R8E. IN THE TOWN OF WAUSAU	
WATER			RESOLUTION-- 76-0302 DATE-- APRIL 13, 1976	
TELEPHONE			ENGINEERING DEPT.	
ELECTRICAL			CITY OF WAUSAU, WIS.	
GAS			FIELD BOOK	BY
HEATING				
FIRE ALARM			NUMBER	D.G.T.
LIGHTING				
BENCH MARKS			PAGE	D.E.K.
MONUMENTS				
			SHEET NO.-- TOTAL SHEETS--	