

CITY OF WAUSAU

COUNTY OF MARATHON

Annexation and Plat Map

OFFICE OF THE SECRETARY OF STATE
State of Wisconsin

FILED September 23, 1986



State of Wisconsin
OFFICE OF THE SECRETARY OF STATE
MADISON, WISCONSIN
53702

Douglas La Follette
SECRETARY OF STATE

Department of Transportation
Room 951
Hill Farm State Office Building
Madison, WI

Attn: Mr. John Pamperin

Dear Sir:

Pursuant to §. 66.021/66.025, we are pleased to enclose in duplicate, certificate and plat relating to annexation of territory adopted by the Common Council of the City of Wausau, County of Marathon on September 10, 1986.

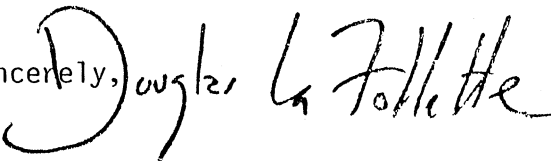
Sincerely, 

DOUGLAS LA FOLLETTE
Secretary of State

cc:

Dept. of Administration
Dept. of Development
Dept. of Public Instruction
Dept. of Revenue
Clerk
File

City of Wausau



Office of

CITY CLERK
(715) 845-5279

CITY HALL
407 Grant Street
Wausau, Wisconsin 54401

Secretary of State
Capitol Square
Madison, WI 53702

Dear Sir:

Enclosed are (9) certified copies of an ordinance and nine (9) copies of the map covering an annexation of land from the Town of Stettin to the City of Wausau.

Should you have any questions, please contact this office.

Sincerely,

A handwritten signature in cursive script that reads "Ruth A. Seubert".

Mrs. Ruth A. Seubert
Secretary to Common Council

ras

Enclosures

The population of the City of Wausau increased by 2 due to this annexation.

STATE OF WISCONSIN
RECEIVED AND FILED

SEP 23 1986

DOUGLAS LA FOLLETTE
SECRETARY OF STATE

City of Wausau



Office of
GARY LEE KLINGBEIL
CITY CLERK
(715) 845-5279

CITY HALL
407 Grant Street
Wausau, Wisconsin 54401

C E R T I F I C A T I O N

I, Gary Lee Klingbeil, do hereby certify that I am the duly qualified and acting City Clerk of and for the City of Wausau, Marathon County, Wisconsin. Acting in that capacity, I do further certify that the accompanying ordinance is a true and correct copy of the ordinance annexing territory to the City of Wausau from the Town of Stettin (Michigan Funding, Ltd./Hoag), adopted by the Common Council of the City of Wausau on the 10th day of September, 1986.

Dated this 18th day of September, 1986.

City of Wausau, Marathon County, Wisconsin.

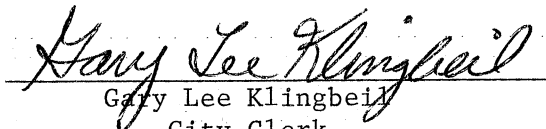

Gary Lee Klingbeil
City Clerk
Wausau, Wisconsin

SEAL

STATE OF WISCONSIN
RECEIVED AND FILED

SEP 23 1986

DOUGLAS LA FOLLETTE
SECRETARY OF STATE

CITY OF WAUSAU, WISCONSIN

AN ORDINANCE Annexing territory to the

City of Wausau, Wisconsin

(Town of Stettin - Michigan Funding, Ltd./Hoag)

FILE NO. 86-0748
Ordinance No. 497-86 I
Introduced September 10, 1986
Referred
Adopted September 10, 1986
Other

AN ORDINANCE

The Common Council of the City of Wausau, Wisconsin do ordain as follows:

Section 1. Territory Annexed. In accordance with Chapter 66, Wisconsin Statutes, and the petition for direct annexation signed by John St. Germain and James C. Bullock, Jr., partners of Michigan Funding, Ltd., and Arnold W. Hoag and Stella H. Hoag, all constituting 100 percent of the electors and 100 percent of the owners of the land, now located in the Town of Stettin, Marathon County, Wisconsin, the following described land is hereby annexed to the City of Wausau:

A parcel of land located in the NW 1/4 of the NW 1/4 of Section 34, Township 29 North, Range 7 East, Town of Stettin, Marathon County, Wisconsin, described as follows:

Commencing at the intersection of the Southerly right-of-way line of Stewart Avenue (formerly S.T.H. "29") and the East line of the said NW 1/4 of the NW 1/4; thence S74°20'30"W along the said Southerly right-of-way line, 340.30 feet to the point of beginning; thence S0°20'45"W, 152.26 feet; thence S11°10'10"W, 111.92 feet; thence S74°20'30"W, parallel with the said Southerly right-of-way line, 318.48 feet; thence North, parallel with the East line of the said NW 1/4 of the NW 1/4, 308 feet more or less, to the centerline of Stewart Avenue; thence Northeasterly along the said centerline to its intersection with the centerline of 26th Avenue; thence North to the Northerly right-of-way line of Stewart Avenue; thence Northeasterly along the said Northerly right-of-way line to a point which bears North from the point of beginning; thence South to the point of beginning.

Section 2. Effect of Annexation. From and after the date of publication of this ordinance, the territory described in Section 1 shall be a part of the City of Wausau and of the School District of Wausau for any and all purposes provided by law, and all persons coming or residing within such territory shall be subject to the ordinances, rules and regulations governing the City of Wausau, and governing the School District.

STATE OF WISCONSIN
RECEIVED AND FILED
SEP 23 1986
DOUGLAS LA FOLLETTE
SECRETARY OF STATE

Section 3. Zoning Classification. Zoning of the within real estate shall be pursuant to Section 23.04.020, Zoning of Annexed Lands, of the Wausau Municipal Code.

Section 4. Aldermanic District. The territory described in Section 1 of this ordinance is hereby made a part of the 10th Aldermanic District and the 23th Ward of the City of Wausau, subject to the ordinances, rules and regulations of the City, County, and State, governing districts.

Section 5. The State of Wisconsin, Department of Development, has favorably reviewed the annexation and found it not to be against the public interest.

Section 6. Severability. If any provision of this ordinance is invalid or unconstitutional, or if the application of this ordinance to any person or circumstance is invalid or unconstitutional, such invalidity or unconstitutionality shall not affect the other provisions or applications of this ordinance, which can be given effect without the invalid or unconstitutional provision or application.

Section 7. Effective Date. This ordinance shall take effect upon passage and publication as provided by law.

Approved:

John L. Kannenberg

Mayor

Attest:

Gary Lee Klingbeil

Clerk

Adopted: September 10, 1986
Approved: September 10, 1986
Published:
Attest: September 11, 1986

STATE OF WISCONSIN
RECEIVED AND FILED

SEP 23 1986

DOUGLAS LA FOLLETTE
SECRETARY OF STATE

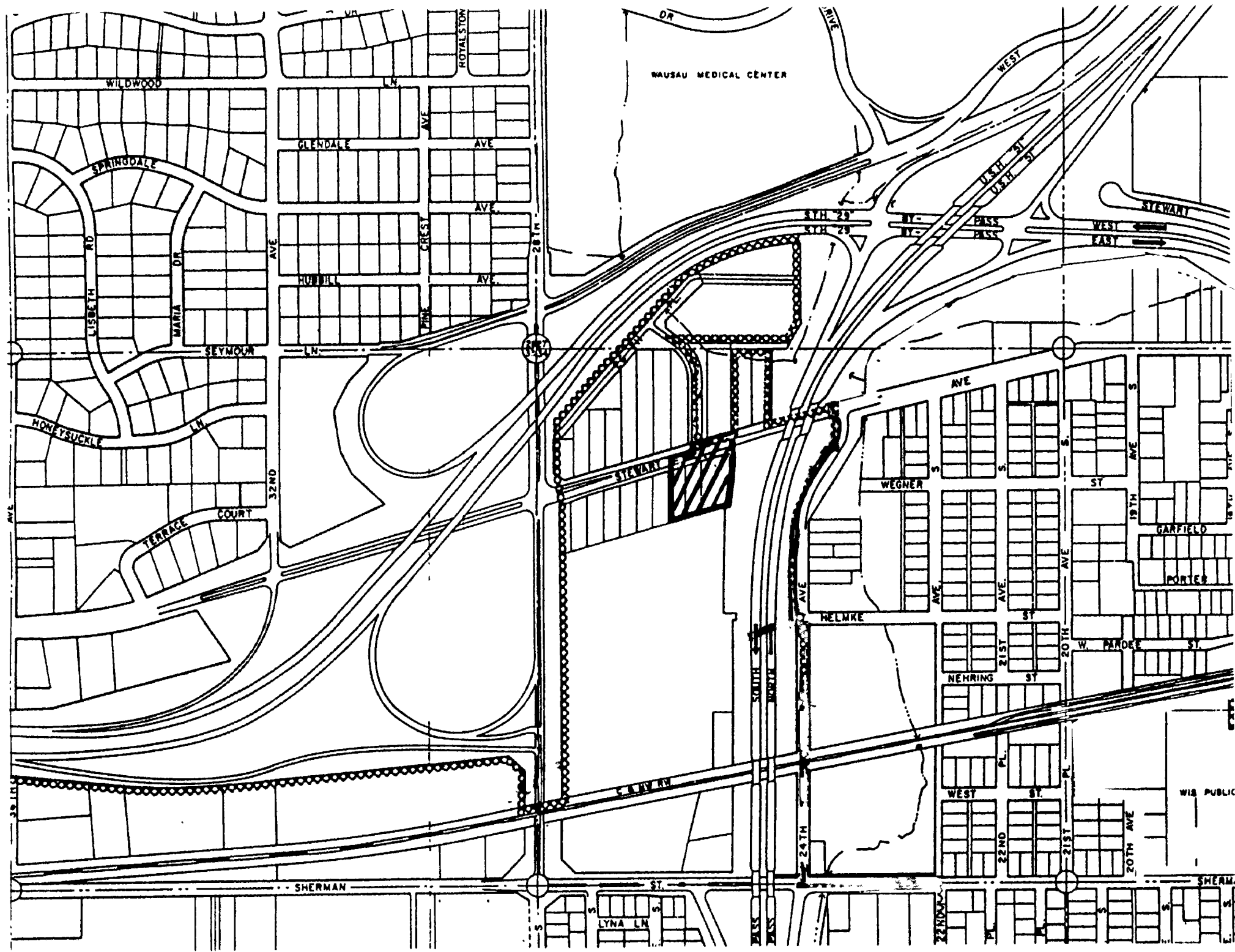

LOCATION SKETCH

LEGAL DESCRIPTION FOR ANNEXED LAND

A parcel of land located in the NW¼ of the NW¼ of Section 34, Township 29 North, Range 7 East, Town of Stettin, Marathon County, Wisconsin, described as follows

Commencing at the intersection of the Southerly right-of-way line of Stewart Avenue (formerly STH "29") and the East line of the said NW¼ of the NW¼; thence S74°20'30"W along the said Southerly right-of-way line, 340.30 feet to the point of beginning; thence S0°20'45"W, 152.26 feet; thence S11°10'10"W, 111.92 feet; thence S74°20'30"W, parallel with the said Southerly right-of-way line, 319.48 feet; thence North, parallel with the East line of the said NW¼ of the NW¼, 308 feet more or less, to the centerline of Stewart Avenue; thence Northeasterly along the said centerline to its intersection with the centerline of 26th Avenue; thence North to the Northerly right-of-way line of Stewart Avenue; thence Northeasterly along the said Northerly right-of-way line to a point which bears North from the point of beginning; thence South to the point of beginning.

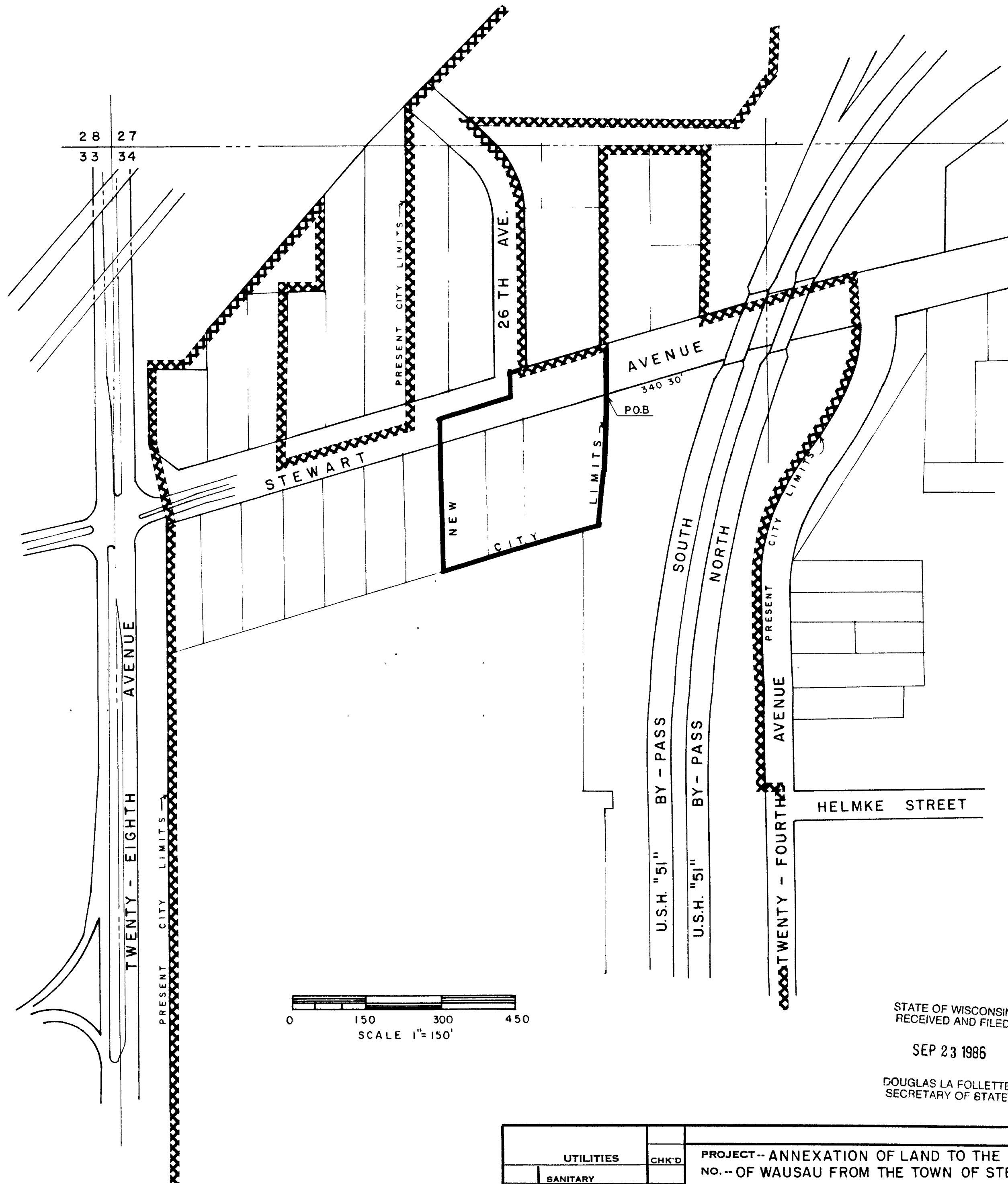

0 150 300 450
SCALE 1"=150'

STATE OF WISCONSIN
RECEIVED AND FILED

SEP 23 1986

DOUGLAS LA FOLLETTE
SECRETARY OF STATE

UTILITIES		CHK'D	PROJECT-- ANNEXATION OF LAND TO THE CITY NO.-- OF WAUSAU FROM THE TOWN OF STETTIN	
SANITARY			LOCATION-- PART OF THE NW 1/4 OF THE NW 1/4, SEC. 34, TWP 29 N, R 7 E	
STORM			RESOLUTION-- 86-0748 DATE-- SEPT. 10, 1986	
WATER			ENGINEERING DEPT.	
TELEPHONE			CITY of WAUSAU, WIS.	
ELECTRICAL			FIELD BOOK SURVEYED BY DATE	
GAS			DRAWN PRELIMINARY	
HEATING			CHECKED FINAL D.G.T. 8573/22	
FIRE ALARM			APPROVED	
LIGHTING			REVISIONS	
BENCH MARKS			SHEET NO.-- TOTAL SHEETS--	
MONUMENTS				