

Kiel
Manitowoc County

CORPORATE BOUNDARIES

as of

December 1, 1971

State of Wisconsin)
Department of State) ss.

Received and filed this23rd.....

day ofDecember.... A.D. 19.71..

Paul Zimmerman
.....
Secretary of State

CITY OF KIEL

STATE OF WISCONSIN 53042

Phone 414-894-2909

December 21, 1971

CERTIFICATE FOR REPORTING CORPORATE LIMITS OF CITY AFTER ALTERATION

I, Roy Duerrwaechter, City Clerk of the City of Kiel
County of Calumet and Manitowoc, State of Wisconsin, DO
HEREBY CERTIFY that the corporate boundaries of the said
city have been altered within the previous 12 month period
ending December 1, 1971, and that the following description
is the present corporate limits of said City December 1, 1971

December 21, 1971

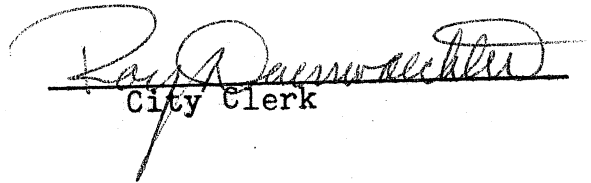
City Clerk

STATE OF WISCONSIN
DEPARTMENT OF STATE
RECEIVED AND FILED

DEC 23 1971

ROBERT C. ZIMMERMAN
SECRETARY OF STATE

C I T Y O F K I E L

CERTIFICATE FOR REPORTING CORPORATE LIMITS OF CITY AFTER
ALTERATION

I, Roy Duerrwaechter, City Clerk of the City of Kiel, County of Manitowoc, State of Wisconsin, DO HEREBY CERTIFY that the corporate boundaries of the said city have been altered within the previous 12 month period ending December 1, 1971 and that the following description is the present corporate limits of the said city as of December 1, 1971

Section 30 T. 17 N.R. 21 E. in Manitowoc County and
the E $\frac{1}{2}$ of the E $\frac{1}{2}$ of
Section 25 T. 17 N.R. 20 E. in Calumet County
and

The South One Half ($S\frac{1}{2}$) of the Southwest Quarter ($SW\frac{1}{4}$) of Section Number Twenty (20) Township Number Seventeen (17) North of Range Number Twenty One (21) East of the Fourth Principal Meridian; Except beginning at the Southwest Corner of the Southwest Quarter ($SW\frac{1}{4}$) of the Southwest Quarter ($SW\frac{1}{4}$) of said Section 20, Township 17 North, Range 21 East, thence running North Four Hundred Seventeen and $\frac{42}{100}$ (417.42) feet, thence East Two Hundred Eight and $\frac{71}{100}$ (208.71) feet, thence south Four Hundred Seventeen and $\frac{42}{100}$ (417.42) feet, thence West Two Hundred eight and $\frac{71}{100}$ (208.71) feet to the point of beginning.

and

Part of the South Half of the Southeast Quarter of Section 24, Township 17 North, Range 20 East, containing 17.49 Acres and being described as follows: Commencing at the South Quarter Corner of Section 24, thence East 1315.4 feet along the south line of the Southeast Quarter of said Section to the point of beginning, thence continuing East 855.00 feet, thence North 120.00 feet, thence N $29^{\circ}-38'-43''$. E. 76.31 feet, thence North $47^{\circ}-39'$ W. 208.71 feet, thence N $42^{\circ}-21'$ E. 208.71 feet to the center of State Trunk Highway 57, thence N $48^{\circ}-14'$ W 1178.27 feet along the center of State Trunk Highway 57, thence South 1266.00 feet to the point of beginning.

and

All of that part of the East One Half ($\frac{1}{2}$) of the Northeast One Quarter ($NE\frac{1}{4}$) of the Northwest One Quarter ($NW\frac{1}{4}$) of Section 29, Town 17 North, Range 21 East, Lying North of the Sheboygan River.

and

Part of the $SE\frac{1}{4}$ of Section 24, Town 17 North, Range 20 East containing 33.49 acres and being described as follows: Beginning at a point on the south line of said point being 1315.4 East of the south $\frac{1}{4}$ corner of Section 24, thence North 1266.00 feet to the center line of Hwy. 57, thence North $48^{\circ}-16'$ West 616.75 feet, thence Northwesterly on a curve in said center line, (chord bearing North $71^{\circ}-24'$ West 772.20 feet), thence South $65^{\circ}-26'$ West 112.7 feet to the intersection of said centerline and the West line of the $SE\frac{1}{4}$ of Section 24, thence South $0^{\circ}-35'$ West 489.3 feet along said West line to the Northeasterly r/w line of the Chicago, Milwaukee, St. Paul & Pacific Rwy., thence south $34^{\circ}-27'$, East 1295.9 East along said r/w line, thence East 217.8 feet, thence south $34^{\circ}-27'$ East 432.0 feet to the South line of the $SE\frac{1}{4}$ of Section 24, thence East 114.17 feet along said south line to the point of beginning.

STATE OF WISCONSIN
DEPARTMENT OF STATE
RECEIVED AND FILED

DEC 23 1971

ROBERT C. ZIMMERMAN
SECRETARY OF STATE

and

Commencing at the Southeast corner of the West Half of the Southwest Quarter of Section Nineteen (19) Township Seventeen (17) North of Range Twenty-one (21) East, thence West on Section line Four Hundred Seventy Five (475) feet, thence North parallel to the East line of said West Half of Southwest Quarter Four Hundred Fifty-eight and Fifty-two One hundredths (458.52) feet, thence East parallel with South line of Section Nineteen aforesaid Four Hundred Seventy-five (475) feet, thence South Four Hundred Fifty-eight and Fifty-two One-hundredths (458.52) feet to place of beginning, containing five acres of land.

and

Parcel 1: Part of the SW $\frac{1}{4}$ of the SE $\frac{1}{4}$ of Section 19, T. 17N, R 21 E., Town of Schleswig, Manitowoc County, Wisconsin and being described as follows: Commencing at the South $\frac{1}{4}$ Corner of Section 19, thence S 88°-27'-10" E 744.35 feet along the South line of said SE $\frac{1}{4}$, thence N 0°-24'-45" W 458.56 feet, thence S. 88°-29'-47" E 159.92 feet to the point of beginning, thence continuing S 88°-29'-47" E. 103.47 feet, thence N 0°-24'-00" E 862.99 feet, thence N 88°-20'-48" W 121.66 feet, thence S 0°-24'-45" E 863.63 feet to the point of beginning.

Parcel 2: Part of the Southeast $\frac{1}{4}$ of the Southwest $\frac{1}{4}$ and part of the Northwest $\frac{1}{4}$ of the Southeast $\frac{1}{4}$ and part of the Southwest $\frac{1}{4}$ of the Southeast $\frac{1}{4}$ of Section 19, Town 17 North, Range 21 East, Town of Schleswig, Manitowoc County, Wisconsin, bounded and described as follows: Commencing at the South $\frac{1}{4}$ corner of Section 19, thence North 0°-33'-53" East 458.08 feet along the North-South $\frac{1}{4}$ line of said Section to the point of beginning, thence continuing North 0°-33'-53" East 201.92 feet, thence North 88°-41'-10" West 330.00 feet, thence South 0°-33'-53" West 375.00 feet, thence North 88°-37'-43" West 797.93 feet, thence North 0°-33'-53" East 165.00 feet, thence North 88°-37'-43" West 200.00 feet to the West line of the Southeast $\frac{1}{4}$ of the Southwest $\frac{1}{4}$ of said Section, thence North 0°-33'-53" East 876.31 feet, thence South 88°-20'-48" East 1,320.35 feet to the North-South $\frac{1}{4}$ line of said Section, thence North 0°-33'-53" East 648.14 feet, thence South 87°-47'-16" East 444.04 feet, thence South 19.00 feet, thence South 87°-47'-16" East 422.47 feet, thence South 0°-24'-45" East 1480.52 feet, thence North 88°-29'-47" West 891.43 feet to the point of beginning.

Parcel 3: Part of the SE $\frac{1}{4}$ of the SW $\frac{1}{4}$ of Section 19, Township 17 North, Range 21 East, Town of Schleswig, Manitowoc County, Wisconsin, and being described as follows: Commencing at the South $\frac{1}{4}$ corner of said Section 19, thence North 0°-33'-53" East 458.08 feet (called North 0°-56' East 459.0 feet on the adjoining property) along the North-South $\frac{1}{4}$ line to the point of beginning, thence continuing North 0°-33'-53" East 201.92 feet, thence North 88°-41'-10" West 330.00 feet, thence South 0°-33'-53" West 200.83 feet, thence South 88°-29'-47" East 330.01 feet to the point of beginning.

Parcel 4: Part of the SE $\frac{1}{4}$ of the SW $\frac{1}{4}$ of Section 19, Township 17 North, Range 21 East, Town of Schleswig, Manitowoc County, Wisconsin described as follows: Commencing at the South $\frac{1}{4}$ Corner of said Section 19, thence North 88°-41'-10" West 330.00 feet, thence North 0°-33'-53" East 285.00 feet, thence North 88°-37'-43" West 67.00 feet this to be the point of beginning, thence continuing North 88°-37'-43" West 70.00 feet, thence South 0°-33'-53" West 115.00 feet to a point on the North line of Lot 7, Block 2, William Zick Addition, thence South 88°-37'-43" East 70.00 feet to a point on the North line of Lot 1, Block 3 of said Addition, thence North 0°-33'-53" East 115.00 feet to the true point of beginning.

STATE OF WISCONSIN
DEPARTMENT OF STATE
RECEIVED AND FILED

DEC 23 1971

ROBERT C. ZIMMERMAN
SECRETARY OF STATE

Parcel 5: The East Five (5) feet of Lot Seven (7) Block Two (2) William Zick Addition in the Southeast Quarter of the Southwest Quarter (SE $\frac{1}{4}$ SW $\frac{1}{4}$) of Section Nineteen (19), Township Seventeen (17) North, Range Twenty-one (21) East.

Parcel 6: The West Five (5) feet of Lot One (1) in Block Three (3) William Zick Addition in the Southeast Quarter of the Southwest Quarter (SE $\frac{1}{4}$ SW $\frac{1}{4}$) of Section (19), Township Seventeen (17) North Range Twenty-one (21) East.

Parcel 7: All of Fourth (4th) Street in William Zick Addition in the Southeast Quarter of the Southwest Quarter (SE $\frac{1}{4}$ SW $\frac{1}{4}$) of Section Nineteen (19), Township Seventeen (17) North, Range Twenty One (21) East and being described as commencing at the South $\frac{1}{4}$ Corner of Section 19, thence North 88°-41'-10" West 402.00 feet along the south line of the SW $\frac{1}{4}$ of said Section 19, thence to the point of beginning, thence continuing North 0°-33'-53" East 170.00 feet, thence North 88°-37'-43" West 60.00 feet, thence South 0°-33'-53" West 170.00 feet to the South line of said SW $\frac{1}{4}$, thence South 88°-41'-10" East 60.00 feet to the point of beginning.

Parcel 8: The South $\frac{1}{2}$ of the Northeast $\frac{1}{4}$ of the Southwest $\frac{1}{4}$ of Section 19, Town 17, North, Range 21 East, Town of Schleswig, Manitowoc County, Wisconsin, being fenced and occupied as follows: Commencing at the South $\frac{1}{4}$ corner of Section 19, thence North 88°-41'-10" West 1,320.50 feet along the South line of the Southeast $\frac{1}{4}$ of Section 19, thence North 0°-33'-53" East 1,326.11 feet along the West line of the Southeast $\frac{1}{4}$ of the Southwest $\frac{1}{4}$ to the point of beginning, thence continuing North 0°-33'-53" East 662.14 feet, thence South 88°-20'-48" East 1,320.35 feet to the North-South $\frac{1}{4}$ line of said section, thence South 0°-33'-53" West 662.14 feet along said $\frac{1}{4}$ line, thence North 88°-20'-48" West 1,320.35 feet to the point fo beginning.

Parcel 9: Part of the SW $\frac{1}{4}$ of the SE $\frac{1}{4}$ of Section 19, T.17N, R.21E., Town of Schleswig, Manitowoc County, Wisconsin, and being described as follows: Commencing at the South $\frac{1}{4}$ Corner of Section 19, thence S. 88°-27'-10", E. 674.31 feet along the south line of said SE $\frac{1}{4}$ to the point of beginning, thence N. 0°-24'-45" W. 458.62 feet parallel to 1st Street, if extended, thence S. 88°-29'-47" E. 70.04 feet, thence S. 0°-24'-45" E. 458.56 feet parallel to said 1st Street if extended, thence N. 88°-27'-10" W. 70.04 feet to the point of beginning.

and

The following described property, located in the S.W. $\frac{1}{4}$ of the S.W $\frac{1}{4}$ of the S.W. $\frac{1}{4}$ of Section 19, T.17N., R. 21E., in the Town of Schleswig, Manitowoc County, Wisconsin.

Commencing at the S.W. corner of said Section 19, thence East along the Section line 150.00 feet to the point of real beginning, thence continuing East along the Section line 459.30 feet, thence North 0°-55' West 458.52 feet, thence West 0°-459.30 feet, thence South 0° 458.52 feet to the point of real beginning.

and

Part of the South Half (S $\frac{1}{2}$) of the Southeast Quarter (SE $\frac{1}{4}$) of Section Twenty-four (24), Township Seventeen (17) North, Range Twenty (20) East containing Four hundred nineteen thousandths (0.419) of an Acre and being described as - Commencing at the South Quarter corner of Section 24, thence East 2170.40 feet along the South line of the Southeast Quarter of said Section to the point of beginning: thence continue East 106.70 feet, North 0°-49' West 66.50 feet; thence South 29°-38'-43" West 76.31 feet, thence South 120.00 feet to the point of beginning.

and

The following described property: Commencing at the SW corner of the SW $\frac{1}{4}$ of the SW $\frac{1}{4}$ of Section 20, Township 17 North, Range 21 East, thence running North 0° a distance of 440.42 feet, thence S. 89° 40' E. a distance of 248.71 feet, thence S 0° a distance 440.42 feet, thence N 89°40' W a distance of 248.71 feet to the place of beginning.

STATE OF WISCONSIN
DEPARTMENT OF STATE
RECEIVED AND FILED

DEC 23 1971

ROBERT C. ZIMMERMAN
SECRETARY OF STATE

and

The following described property: Part of the NW $\frac{1}{4}$ of the SE $\frac{1}{4}$ of Section 19, Township 17 North, Range 21 East, Town of Schleswig, Manitowoc County, Wisconsin, described as follows: Commencing at the South $\frac{1}{4}$ corner of Section 19, Township 17 North, Range 21 East, thence S. 88 $^{\circ}$ -27'-10" E., 744.35 feet along the South line of the SE $\frac{1}{4}$ of Section 19, thence N. 0 $^{\circ}$ -24'-45" W., 458.56 feet, thence S. 88 $^{\circ}$ -29'-47" E., 154.92 feet, thence N. 0 $^{\circ}$ -24'-45" W., 863.63 feet to the point of beginning, thence continuing N 0 $^{\circ}$ -24'-45" W., 616.89 feet, thence S. 87 $^{\circ}$ -47'-16" E., 35.02 feet, thence S. 0 $^{\circ}$ -24'-45" E., 616.55 feet, thence N. 88 $^{\circ}$ -20'-48" W., 35.00 feet to the point of beginning.

and

The following described property: Part of the SE $\frac{1}{4}$ Quarter of Section 29, Township 17N., Range 21E., Town of Schleswig, Manitowoc County, Wisconsin, containing 25.42 Acres and described as - Commencing at the intersection of the North line of said Section 29, with the centerline of S.T.H. "32": thence running S. 0 $^{\circ}$ -28'-00"W., 3208.40 feet along said centerline; thence running S. 89 $^{\circ}$ -32'-00" E., 210 feet to the point of beginning; thence N. 0 $^{\circ}$ -28'-00"E., 464.63 feet to an Iron Pipe; thence S. 89 $^{\circ}$ -32'-00" E., 1117.41 feet to a rock with a chisel cross; thence S. 0 $^{\circ}$ -00'-46" E., 1055.22 feet; thence N. 89 $^{\circ}$ -13'-00"W., 447.56 feet; thence S. 0 $^{\circ}$ -01'-03" E., 135.69 feet to the Northerly R/W line of S.T.H. "32" and "57"; thence N. 89 $^{\circ}$ -40'-49" W., 297.69 feet along said Northerly R/W line; thence 0 $^{\circ}$ -51'-26" E., 200.91 feet thence N. 89 $^{\circ}$ -38'-00" W., 534.72 feet to the Easterly R/W line of S.T.H. "32" as recorded in Vol. 192 D. Page 320 at Manitowoc County Court House; thence N. 0 $^{\circ}$ -28'-00" E., 43.70 feet; thence S. 89 $^{\circ}$ -32'-00" E., 327.00 feet; thence N. 0 $^{\circ}$ -28'-00" E., 450.00 feet; thence N. 89 $^{\circ}$ -32'-00" W., 177.00 feet to the point of beginning.

Commencing at the intersection of the North line of Section 29, Township 17 North, Range 21 East with the centerline of S.T.H. "32" thence S. 0 $^{\circ}$ -28'-00" W., 3208.40 feet along said centerline; thence S. 89 $^{\circ}$ -32'-00" E., 60.00 feet to the point of beginning; thence continue S. 89 $^{\circ}$ -32'-00" E., 327.00 feet; thence S. 0 $^{\circ}$ -28'-00" W., 450.00 feet; thence N. 89 $^{\circ}$ -32'-00" W. 327.00 feet to the Easterly line of R/W of S.T.H. "32"; thence N. 0 $^{\circ}$ -28'-00" E., 450.00 feet along said East R/W line to the point of beginning. This parcel contains 3.38 Acres.

and

All of the Eastern part cut off by the Milwaukee and Northern Railroad (now Chicago, Milwaukee, St. Paul and Pacific Railroad) of the following tract of land, to wit: The Eastern One third (E $\frac{1}{3}$) of the Northwest Quarter (NW $\frac{1}{4}$) of the Northeast Quarter (NE $\frac{1}{4}$) of Section Number Twenty-five (25), Township Number Seventeen (17) North of Range Number Twenty (20) East, containing about three (3) acres of land.

STATE OF WISCONSIN
DEPARTMENT OF STATE
RECEIVED AND FILED

DEC 23 1971

ROBERT C. ZIMMERMAN
SECRETARY OF STATE

and

A tract of land being the East Half ($E\frac{1}{2}$) of the Right-of-Way of S.T.H. "32", as Deeded to Manitowoc County and recorded in Volume 192 D Page 320, being a part of the Northwest Quarter ($NW\frac{1}{4}$) of the Southwest Quarter ($SW\frac{1}{4}$) of Section Twenty-Nine (29), Township Seventeen (17) North, Range Twenty-One (21) East, Town of Schleswig, Manitowoc County, Wisconsin, and containing 0.68 acres of land and being described as: Beginning at a point in the centerline of said S.T.H. "32", said point being S. $0^{\circ}-28'-00''$ W., 3208.40 feet from the intersection of the centerline of S.T.H. "32" with the North line of said Section 29; thence S. $89^{\circ}-32'-00''$ E., 60 feet to the East Right-of-Way line of S.T.H. "32"; thence S. $0^{\circ}-28'-00''$ W., 493.70 feet along said East Right-of-Way line; thence N. $89^{\circ}-38'-00''$ W., 60 feet to the centerline of S.T.H. "32"; thence N. $0^{\circ}-28'-00''$ E., 493.65 feet along the centerline of S.T.H. "32" to the point of beginning.

This description was prepared to enable the Stoelting Bros. Property to be contiguous to the City of Kiel.

STATE OF WISCONSIN
DEPARTMENT OF STATE
RECORDS DIVISION

DEC 23 1971

ROBERT C. ZIMMERMAN
SECRETARY OF STATE

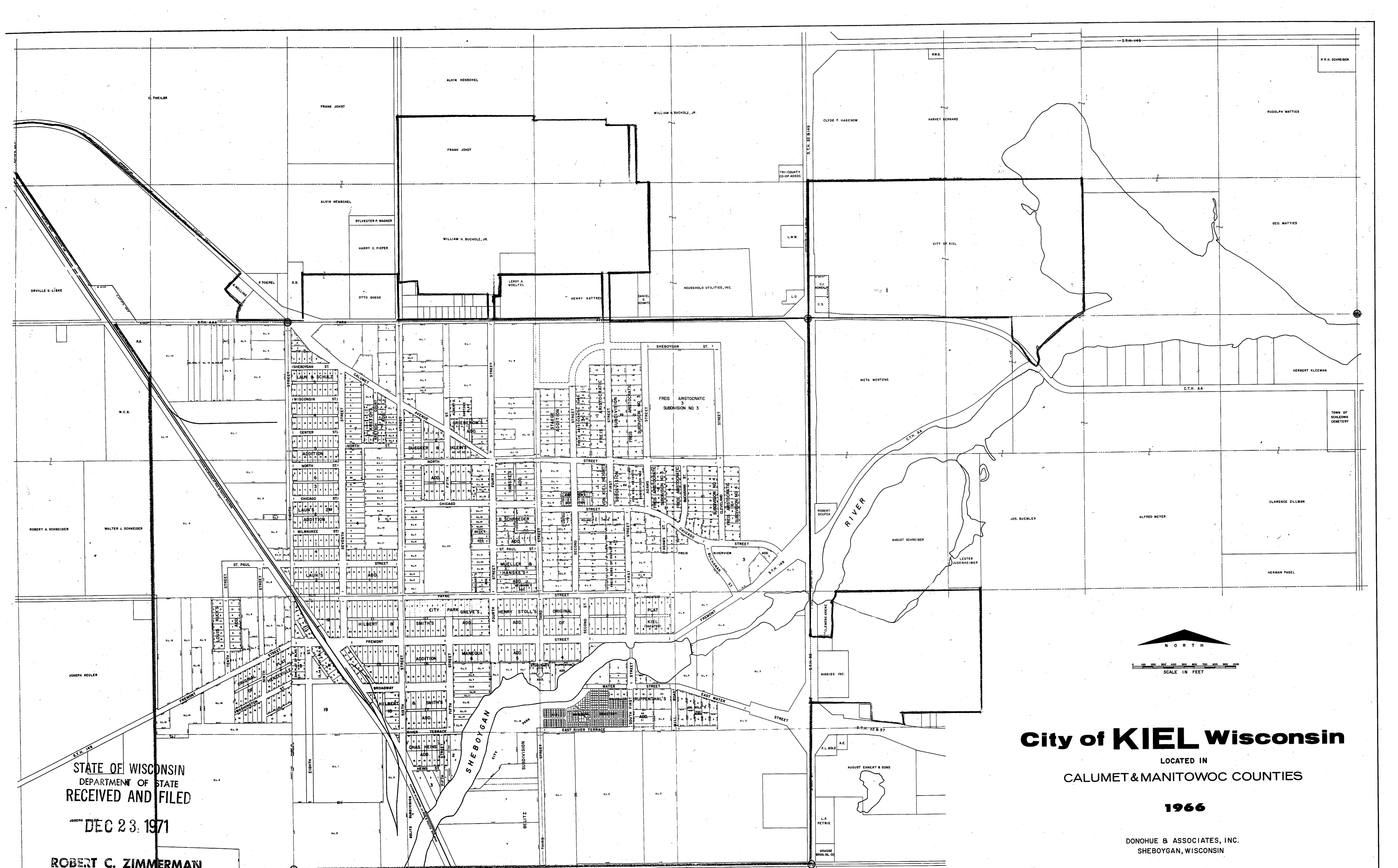

STATE OF WISCONSIN
 DEPARTMENT OF STATE
 RECEIVED AND FILED
 DEC 23 1971

ROBERT C. ZIMMERMAN
 SECRETARY OF STATE

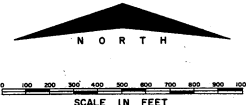

City of **KIEL** Wisconsin

LOCATED IN
 CALUMET & MANITOWOC COUNTIES

1966

DONOHUE & ASSOCIATES, INC.
 SHEBOYGAN, WISCONSIN