

CITY OF DODGEVILLE

COUNTY OF IOWA

CORPORATE BOUNDARIES

---

DOUGLAS LA FOLLETTE

Secretary of State

Filed February 18, 1986

---

I, Cheryl Voigts, City Clerk of the City of Dodgeville, Iowa County, State of Wisconsin, DO HEREBY CERTIFY that the corporate boundaries of the City have not been altered within the previous 12-month period ending December 1, 1985, and that the following description is the present limits of the said City as of December 1, 1985.

Commencing at the NW corner of Section 27, T6N, R3E; thence East, 487.3' to the point of beginning; thence continuing East 448'; thence North 540.74'; thence East, 142.38'; thence N 61°40'E. 400'; thence N 28°20'W, 250'; thence N 61°40'E, 100'; thence N 28°20'W, 50'; thence N 61°40'E, 1220'; thence S 28°20'E, 300'; thence N 61°40'E, 68.44'; thence South, 1389.57' to the South  $\frac{1}{4}$  corner of Section 22, T6N, R3E; thence East, 2640' more or less to the NE corner of Section 27; thence South, 7920' more or less to the East  $\frac{1}{4}$  corner of Section 34, T6N, R3E; thence West, 3960' more or less to the NW corner of the NE  $\frac{1}{4}$  of the SW  $\frac{1}{4}$  of Section 34; thence South, 1320' more or less to the SW corner of the NE  $\frac{1}{4}$  of the SW  $\frac{1}{4}$  of said Section 34; thence East, 1320' more or less to the SE corner of the NE  $\frac{1}{4}$  of the SW  $\frac{1}{4}$  of said Section 34; thence South, 1320' more or less to the South  $\frac{1}{4}$  corner of Section 34; thence West, 5280' more or less to the South  $\frac{1}{4}$  corner of Section 33, T6N, R3E; thence North, 5676' more or less to a point which is 396' North more or less of the North  $\frac{1}{4}$  corner of said Section 33; thence West, 660'; thence North, 924'; thence West, 660' more or less to the NW corner of the SE  $\frac{1}{4}$  of the SW  $\frac{1}{4}$  of Section 28, T6N, R3E; thence North, 1320' more or less to the NW corner of the NE  $\frac{1}{4}$  of the SW  $\frac{1}{4}$  of said Section 28; thence East, 1047.42'; thence North, 30'; thence East, 272.58'; thence North, 2610' more or less to the North  $\frac{1}{4}$  corner of said Section 28; thence West, 1320' more or less along the Southerly line of the SW  $\frac{1}{4}$  of Section 21, T6N, R3E to the SW corner of the SE  $\frac{1}{4}$  of the SW  $\frac{1}{4}$  of said Section 21; thence North, 2640' more or less to the NW corner of the NE  $\frac{1}{4}$  of the SW  $\frac{1}{4}$  of said Section 21; thence East, 1155' more or less to the Westerly right of way line of the Chicago and Northwestern Railroad; thence Southeasterly along said Westerly right of way line to a point on the North line of the S  $\frac{1}{2}$  of the SE  $\frac{1}{4}$  of the SE  $\frac{1}{4}$  of Section 21; thence Easterly along said North line to a point 125' Easterly of the centerline of the main track of the Chicago and Northwestern Railroad; thence Northwesterly on a line which shall be at all points 125' Easterly from the centerline of the main track of the Chicago and Northwestern Railroad to a point on the North line of the SE  $\frac{1}{4}$  of the SE  $\frac{1}{4}$  of said Section 21; thence East, along said North line, 1453' to the NE corner of the SE  $\frac{1}{4}$  of SE  $\frac{1}{4}$  of said Section 21; thence North, 203.2'; thence N 80°58'E, 1487.8'; thence N 76°19'E, 1185' to the East line of the SW  $\frac{1}{4}$  of Section 22, T6N, R3E; thence South, 100'; thence S 61°38'W., 3016' more or less along the North right of way line of the Chicago and Northwestern Railroad to the West line of said Section 22; thence South, to a point on the Southerly right of way line of S.T.H. 18, said point being 369' North of the NW corner of Section 27; thence N 61°40'E., 270' more or less; thence S 28°20'E, 130'; thence East, 242.3'; thence South, 363' to the point of beginning.

Date:

1-17-86

Cheryl Voigts

STATE OF WISCONSIN  
RECEIVED AND FILED  
Cheryl Voigts, City Clerk

FEB 18 1986

DOUGLAS LA FOLLETTE  
SECRETARY OF STATE

DOUGLAS LA FOLLETTE  
SECRETARY OF STATE

T. 5-6 N-R. 3 E.

23

**SEE PAGE 25**

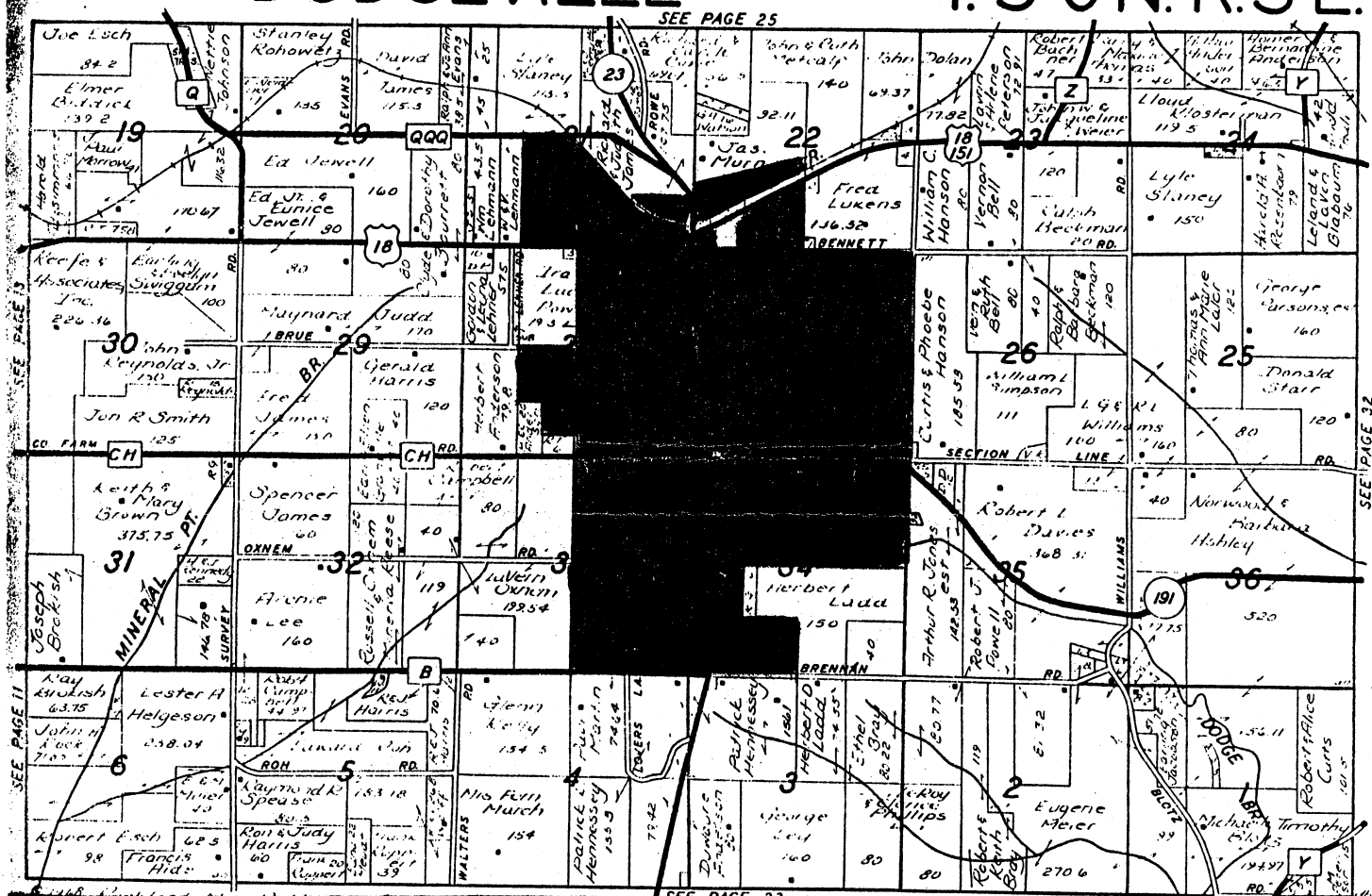

7  
6  
N.  
↓  
↑  
T.  
5  
N