

SHEBOYGAN

Sheboygan County

ANNEXATION OF TERRITORY
&
PLAT MAP

OFFICE OF THE SECRETARY OF STATE
State of Wisconsin

STATE OF WISCONSIN
DEPARTMENT OF STATE
RECEIVED AND FILED

MAY 31 1978

DOUGLAS LAFOLLETTE
SECRETARY OF STATE

Douglas LaFollette

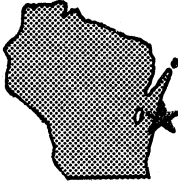

CITY OF **SHEBOYGAN**
WISCONSIN

53081

LAWRENCE FELTEN, CITY CLERK
CITY HALL

May 30, 1978

Secretary of State
Administrative Services Div.
State Capitol
Madison, Wisconsin 53702

Dear Sir:

At a regular meeting of the Common Council of the City of Sheboygan, Wisconsin held May 15, 1978, the following document was passed, and we are enclosing a certified copy thereof:

Gen. Ord. No. 188-77-78 by Aldermen Arpke & Leonhard, with Certificate and map.

Yours very truly

Lawrence Felten
LAWRENCE FELTEN
City Clerk

jb
Enclosure

CERTIFICATE OF ANNEXATION

I, Lawrence Felten, City Clerk of the City of Sheboygan, County of Sheboygan, State of Wisconsin, do hereby certify that the following described territory was detached from the Town of Sheboygan, County of Sheboygan, and annexed to the said City of Sheboygan, pursuant to Section 66.021 of the Wisconsin Statutes, by Gen. Ord. No. 188-77-78, adopted by the Common Council at a regular meeting held May 15, 1978. The following described annexation contains a population of 0.

DESCRIPTION OF TERRITORY ANNEXED

Part of the Northwest Quarter, Northeast Quarter (NW $\frac{1}{4}$ NE $\frac{1}{4}$) Section Sixteen (16), Town Fifteen (15) North, Range Twenty-three (23) East, commencing three hundred thirty (330) ft. west of the east line of said Quarter and two hundred fifty-one and six tenths (251.6) ft. north of the center line of Main Ave., thence west one hundred sixty-five (165) ft., thence north eighty-five and one hundredth (85.01) ft., thence east one hundred ninety-five (195) ft. to the east line of North 30th St., thence south eighty-five and one hundredth (85.01) ft., thence west thirty (30) ft. to beginning.

Dated May 30, 1978

Lawrence Felten
City Clerk

(S E A L)

STATE OF WISCONSIN
DEPARTMENT OF STATE
RECEIVED AND FILED

MAY 31 1978

DOUGLAS LAFOLLETTE
SECRETARY OF STATE

MAY 31 1978

**DOUGLAS LAFOLLETTE
SECRETARY OF STATE**

**OFFICE OF CITY CLERK
SHEBOYGAN, WISCONSIN
CITY HALL**

I hereby certify that this is a true copy of a document from the Common Council Proceedings of the City of Sheboygan.

Lawrence Felten
City Clerk

Gen. Ord. No. 188 - 77 - 78

By Alderman Arpke and Leonhard

Dated April 5, 1978

AN ORDINANCE annexing territory from the Town of Sheboygan to the City of Sheboygan, situated west of North 30th St. between North Ave. and Main Ave.

THE MAYOR AND COMMON COUNCIL OF THE CITY OF SHEBOYGAN DO ORDAIN AS FOLLOWS:

Section 1. In accordance with the provisions of Section 66.021 (12) of the Wisconsin Statutes, and a petition for direct annexation filed with the City Clerk on March 29, 1978, signed by the owners of all the land in the area sought to be annexed, and pursuant to the certification of the City Clerk that no electors reside therein, the following described area in the Town of Sheboygan, Sheboygan County, Wisconsin, is hereby annexed to the City of Sheboygan:

Part of the Northwest Quarter, Northeast Quarter (NW $\frac{1}{4}$ NE $\frac{1}{4}$) Section Sixteen (16), Town Fifteen (15) North, Range Twenty-three (23) East, commencing three hundred thirty (330) ft. west of the east line of said Quarter and two hundred fifty-one and six tenths (251.6) ft. north of the center line of Main Ave., thence west one hundred sixty-five (165) ft., thence north eighty-five and one hundredth (85.01) ft., thence east one hundred ninety-five (195) ft. to the east line of North 30th St., thence south eighty-five and one hundredth (85.01) ft., thence west thirty (30) ft. to beginning.

Section 2. From and after the date of the passage of this ordinance, the territory described in Section 1 of this ordinance shall be a part of the City of Sheboygan for any and all purposes provided by law, and all persons coming or residing within such territory shall be subject to all ordinances and regulations governing the City of Sheboygan.

Section 3. The territory described in Section 1 of this ordinance is hereby made a part of the 7th Ward, 1st Precinct of the City of Sheboygan.

Section 4. The territory described in Section 1 of this ordinance is hereby zoned R-1 Residential

Section 5. All ordinances or parts thereof in conflict with the provisions of this ordinance are hereby repealed to the extent of such conflict, and this ordinance shall be in effect from and after its passage and publication.

Frederic Arpke

Richard Leonhard

*Plan Com.
see 4 add
and be passed*

I HEREBY CERTIFY that the foregoing ordinance was duly passed by the Common Council of the City of Sheboygan, Wisconsin, on the 15th day of May 1978

Dated May 19 1978 Lawrence Felten City Clerk

Approved May 19 1978 Richard W. Sinsch Mayor

Proceedings Published May 26 1978 Atty.; Ord. book; Town Clerk; Don Sherman; Supt. of Assess.; Wis. Power & Lt. Co.; Eng.; Assess.; Comp. - Treas.

Ordinance Published - May 24, 1978
Certified May 30 1978 Police Dept.; Code book; Library; Dept. of City Dev.; Betty Bawden; Jerome Katte; R.C. Buttke; Kenneth Kornetzke; Water Dept.; Fire Dept.; Bldg. Insp. Dept. Supt.; Health Dept.; Robert Eirich; Richard Otte; Supt. of Streets; Mun. Code Corp.; Park & Transit Ut.; Supt. of Schools; Sec. of State; Reg. of Deeds.

STATE OF WISCONSIN
DEPARTMENT OF STATE
RECEIVED AND FILED

MAY 31 1978

DOUGLAS LAFOLLETTE
SECRETARY OF STATE

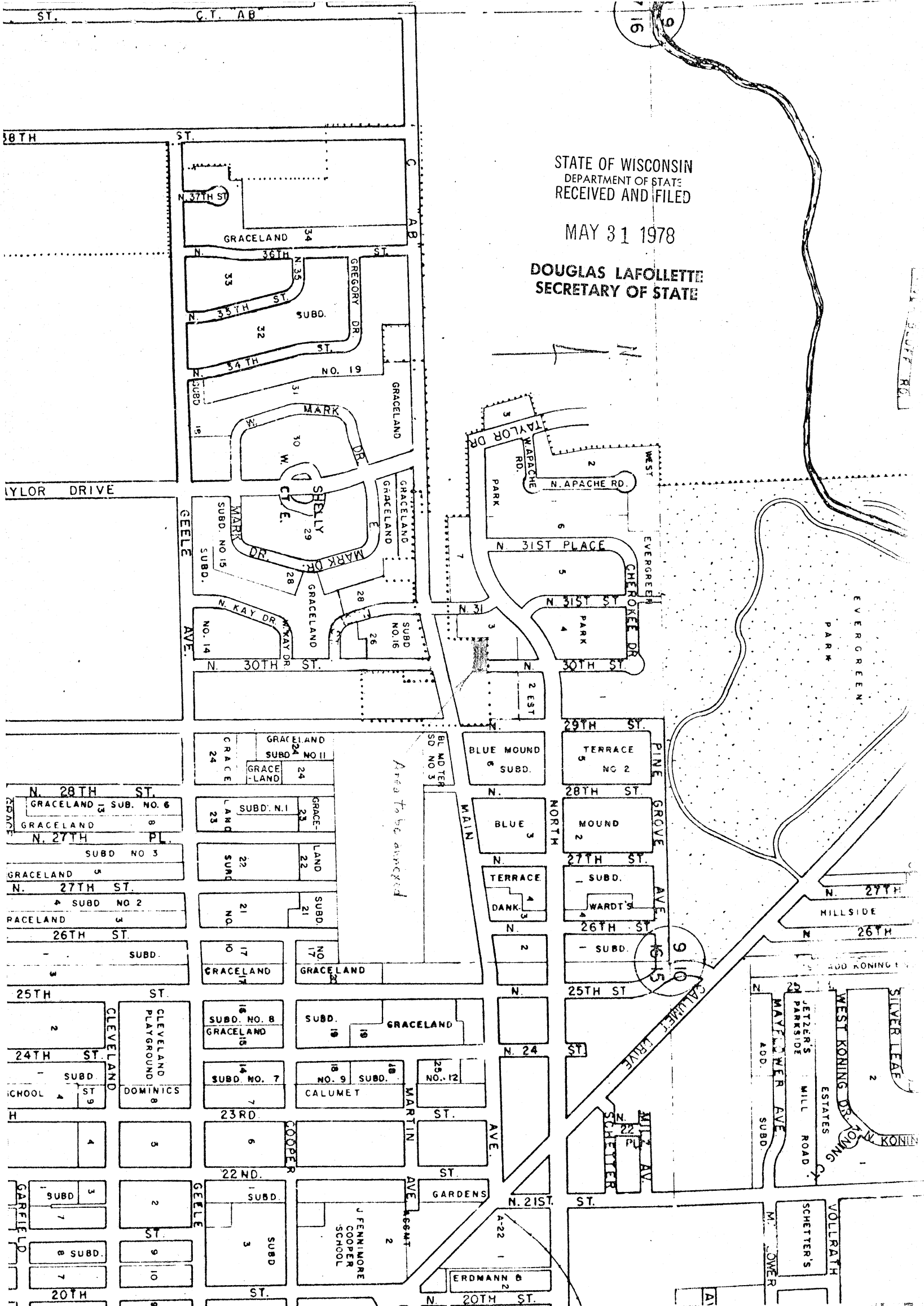

Area to be annexed

OFF RD

EVERGREEN PARK

SILVER LEAF

WEST KONING DR

JETZERS PARKSIDE MILL ROAD

MAYFLOWER AVE

SCHETTER'S

VOLLRATH

SCHETTER'S

MAYFLOWER AVE

SCHETTER'S

SCHETTER'S

SCHETTER'S

SCHETTER'S

SCHETTER'S

SCHETTER'S

SCHETTER'S

SCHETTER'S

SCHETTER'S

SCHETTER'S

SCHETTER'S

SCHETTER'S

SCHETTER'S

SCHETTER'S

SCHETTER'S

SCHETTER'S

SCHETTER'S

SCHETTER'S

SCHETTER'S

SCHETTER'S

SCHETTER'S

SCHETTER'S

SCHETTER'S

SCHETTER'S

SCHETTER'S

SCHETTER'S

SCHETTER'S

SCHETTER'S

SCHETTER'S

SCHETTER'S

SCHETTER'S

SCHETTER'S

SCHETTER'S

SCHETTER'S

SCHETTER'S

SCHETTER'S

SCHETTER'S

SCHETTER'S

ERDMANN

ERDMANN

ERDMANN

ERDMANN

ERDMANN

ERDMANN

ERDMANN

ERDMANN

ERDMANN

ERDMANN

ERDMANN

ERDMANN

ERDMANN

ERDMANN

ERDMANN

ERDMANN

ERDMANN

ERDMANN

ERDMANN

ERDMANN

ERDMANN

ERDMANN

ERDMANN

ERDMANN

ERDMANN

ERDMANN

ERDMANN

ERDMANN

ERDMANN

ERDMANN

ERDMANN

ERDMANN

ERDMANN

ERDMANN

ERDMANN

ERDMANN

ERDMANN

ERDMANN

ERDMANN

ERDMANN

ERDMANN

ERDMANN

ERDMANN

ERDMANN

ERDMANN

ERDMANN

ERDMANN

ERDMANN

ERDMANN

ERDMANN

ERDMANN

ERDMANN

ERDMANN

ERDMANN

ERDMANN

ERDMANN

ERDMANN

ERDMANN