

451.21

CITY

140

CITY OF COLBY

COUNTIES OF CLARK & MARATHON

ANNEXATION & PLAT
ORD 13-3-10

OFFICE OF THE SECRETARY OF STATE
State of Wisconsin

FILED MAY 20, 1996

MEMORANDUM

OFFICE OF THE SECRETARY OF STATE

STATE OF WISCONSIN

Date: 5-21-96

From: Government Records Division
Linda Nowaczyk, Records Specialist
Billie Zeien, Records Specialist
30 West Mifflin Street, 10th Floor
P. O. Box 7848
Madison, WI 53707-7848

Billie

To: Emily Jorenby
Department of Transportation
Room 951, Hill Farm State Office Bldg.

RE: Municipal filing distribution

City of Colby

Attached please find a municipal filing submitted to the Office of the Secretary of State pursuant to Chapter 66, Wis. Stats.

cc: Eugene Miller, DOR/Bureau of Equalization
Patricia Sweet, Dept of Public Instruction
George Hall, DOA/Energy & Intergovernmental Relations
Bob Naylor, Dept of Administration
Kate Lawton, DATCF
Scott Hausmann, Dept of Natural Resources
Clerk - 2

ORDINANCE

An ordinance annexing certain lands to the City of Colby from the Town of Hull, Marathon County, Wisconsin.

The Common Council of the City of Colby, Wisconsin, do ordain as follows:

SECTION I. Territory Annexed

In accordance with Section 66.021(2) of the Wisconsin Statutes, and the petition for direct annexation filed with the City Clerk on the 30th day of April, 1996, signed by a number of qualified electors residing in such territory equal to a majority of the votes cast for governor in the November, 1994 gubernatorial election, and by the owners of one-half the real property in assessed value within the territory proposed to be annexed, and it appearing that the petitioners have complied with all of the requirements set forth in Section 66.021 of the Wisconsin Statutes, the following described territories in the Town of Hull, Marathon County, Wisconsin, are hereby annexed to the City of Colby, Wisconsin, and detached from the Town of Hull, Marathon County, Wisconsin.

Part of the NW fractional 1/4 and SW fractional 1/4 of Section 7, T28N, R2E, Town of Hull, Marathon County, Wisconsin, To-wit: Beginning at the Northeast corner of Lot 2 of Marathon County Certified Survey Map No. 6848; Thence East on the extension of the North line of said Lot 2, to a point 856 feet West of the East line of the E1/2-S1/2-SW1/4 of said section; Thence South, parallel with the East line of said E1/2-S1/2-SW1/4, to a point 689 feet more or less South of the North line of said E1/2-S1/2-SW1/4; Thence Northeasterly to a point that is 421 feet more or less South, and 599 feet more or less West of the Northeast corner of said E1/2-S1/2-SW1/4; Thence East, parallel with the North line of said E1/2-S1/2-SW1/4, 599 feet more or less to the East line of the SW fractional 1/4; Thence North, along the East line of said SW and NW fractional 1/4 of said section, to the Northeast corner of said NW fractional 1/4; Thence West, along the North line of said NW fractional 1/4, to the West section line of Section 7, T28N, R2E; Thence South, along said section line, to the North line of Lot 1 of said Marathon County Certified Survey Map No. 6848 extended west; Thence East, along the aforementioned North line of said Lot 1, to the Northeast corner of said Lot 1; Thence South to the point of beginning.

RECEIVED & FILED

MAY 20 1996

DOUGLAS LA FOLLETTE
SECRETARY OF STATE

SECTION II. Effect of Annexation

From and after the date of the adoption and publication of this Ordinance, the territories described in Section I shall be a part of the City of Colby for any and all purposes provided by law and all persons coming or residing within such territories shall be subject to all ordinances, rules and regulations governing the City of Colby.

SECTION III. Severability

If any provision of this Ordinance is invalid or unconstitutional, or if the application of this Ordinance to any person or circumstance is invalid or unconstitutional, such unconstitutionality shall not affect the other provisions or applications of this Ordinance which can be given effect without the invalid or unconstitutional provision or application.

SECTION IV.

This Ordinance shall be known, and shall hereafter be referred to, as 13-3-10
_____ of the Municipal Code of the City of Colby.

SECTION V. Effective Date

The City Clerk shall file immediately with the Secretary of State a certified copy of the Ordinance, certificate and plat, and one copy with each company that provides any utility service in the annexed area, plus one such copy with the Register of Deeds and one copy with the Clerk of any affected school district. The Clerk's certificate shall include a reference to the population of the territories as set forth in the petition, which has been certified to be 17 persons.

ADOPTED 5-15-96

APPROVED 5-15-96

PUBLISHED 5-22-96

James W. Schmidt
Mayor

ATTEST: Connie L. Leuther
City Clerk

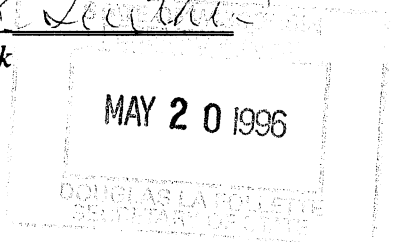



CITY OF COLBY

211 WEST SPENCE ST., P.O. Box 236
COLBY, WISCONSIN 54421
715 - 223-4435

16 May, 1996

Mr. Douglas La Follete,
Secretary of State - Wisconsin
30 West Mifflin Street
P.O. Box 7848
Madison, Wisconsin 53707

RE: City of Colby - LONGMORE ANNEXATION

Dear Sir;

Please be advised that I am enclosing the following copies regarding the Longmore Annexation to the City of Colby:

- 1- Copy of Notice of Intent to Circulate including...
 - Legal Description of Proposed Annexation
 - Copy of Scale Map
- 2- Copy of Affidavit of Publication on 17 January, 1996
- 3- Copy of Petition For Annexation
- 4- Copy of Ordinance 13-3-10 adopted by the Common Council, City of Colby on 15 May, 1996.
- 5- Affidavit of City Clerk - City of Colby

Further, I certify that the population in the area annexed is certified at 17 persons as of this date.

Sincerely,

Connie Gurtner
Clerk - City of Colby

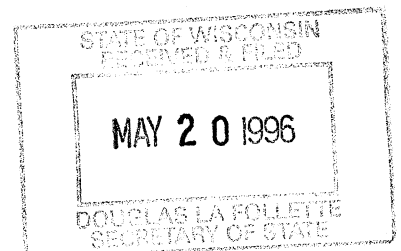



CITY OF COLBY

211 WEST SPENCE ST., P.O. BOX 236
COLBY, WISCONSIN 54421
715 - 223-4435

CERTIFICATE

I, *CONNIE GURTNER*, certify that I am the City Clerk of the City of Colby, and was such City Clerk on 15 May, 1996. I further certify that the foregoing Ordinance is a true and correct copy of the Ordinance adopted by the Common Council of the City of Colby on the 15th day of May, 1996, and to be published on the 22nd day of May, 1996.

Connie Gurtner

Connie Gurtner, Clerk

(SEAL)

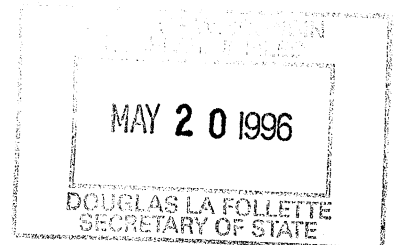

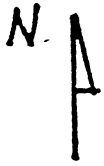
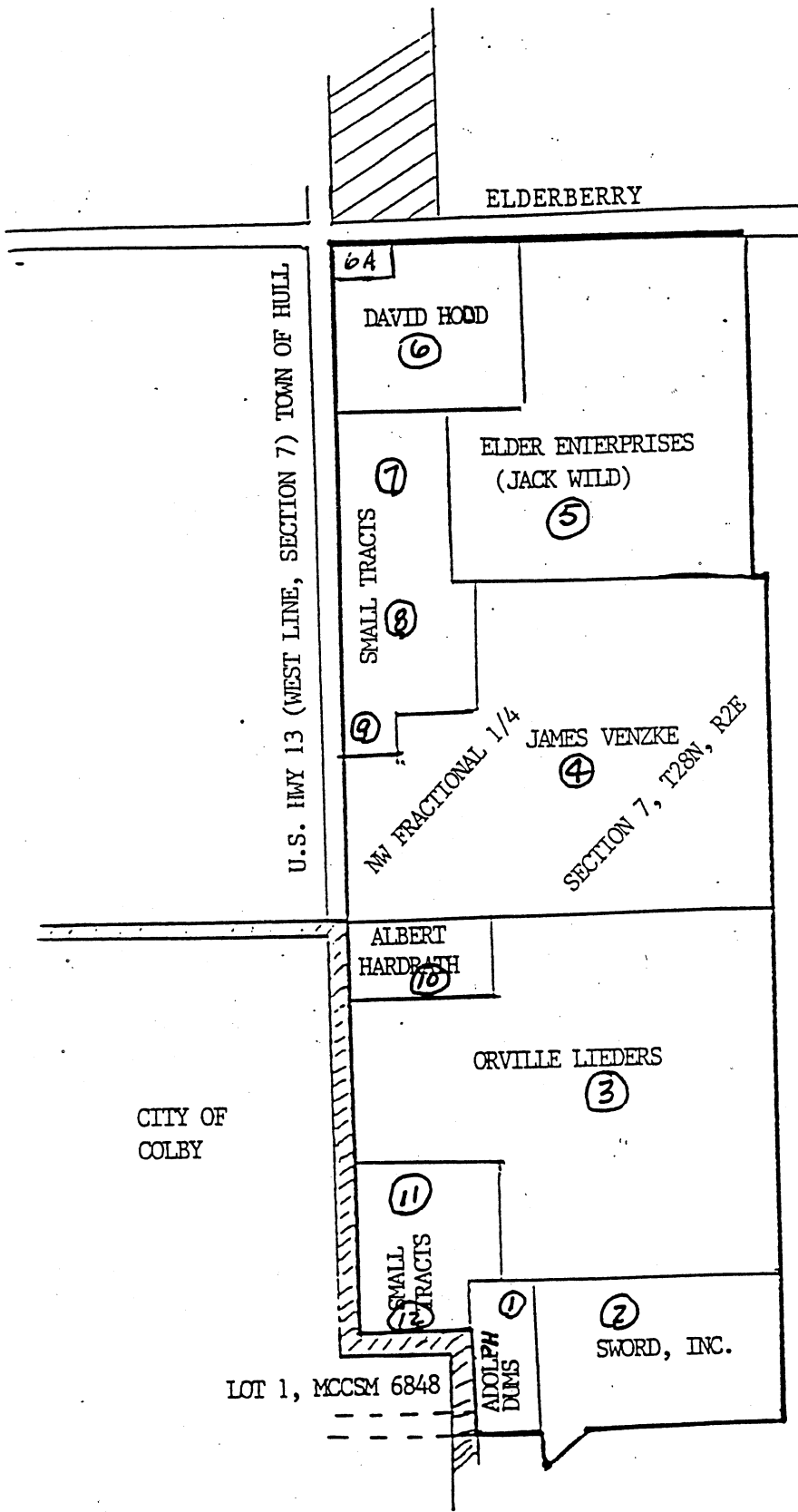

STATE OF WISCONSIN
 RECEIVED & FILED
 MAY 20 1996
 DOUGLAS LA FOLLETTE
 SECRETARY OF STATE

Proposed Annexation to the City of Colby, being a part of the Northwest and Southwest fractional quarters of Section 7 of the Town of Hull, Marathon County, Wisconsin.

17 January, 1996

LEGAL NOTICE

TO: All interested parties.

PLEASE TAKE NOTICE that the undersigned Kevin Longmore hereby gives notice, pursuant to the provisions of Section 66.021(3) Wisconsin Statutes, of his intention to circulate an annexation petition of the following described territory of the Town of Hull, Marathon County, Wisconsin:

Part of the NW fractional 1/4 and SW fractional 1/4 of Section 7, T28N, R2E, Town of Hull, Marathon County, Wisconsin, To-wit:

Beginning at the Northeast corner of Lot 2 of Marathon County Certified Survey Map No. 6848;

Thence East on the extension of the North line of said Lot 2, to a point 856 feet West of the East line of the E1/2-S1/2-SW1/4 of said section;

Thence South, parallel with the East line of said E1/2-S1/2-SW1/4, to a point 689 feet more or less South of the North line of said E1/2-S1/2-SW1/4;

Thence Northeasterly to a point that is 421 feet more or less South, and 599 feet more or less West of the Northeast corner of said E1/2-S1/2-SW1/4;

Thence East, parallel with the North line of said E1/2-S1/2-SW1/4, 599 feet more or less to the East line of the SW fractional 1/4;

Thence North, along the East line of said SW and NW fractional 1/4 of said section, to the Northeast corner of said NW fractional 1/4;

Thence West, along the North line of said NW fractional 1/4, to the West section line of Section 7, T28N, R2E;

Thence South, along said section line, to the North line of Lot 1 of said Marathon County Certified Survey Map No. 6848 extended west;

Thence East, along the aforementioned North line of said Lot 1, to the Northeast corner of said Lot 1;

Thence South to the point of beginning.

A petition will be circulated among the qualified electors residing in such territory and the owners of real estate therein, for the purpose of annexing said property to the City of Colby, Wisconsin.

Kevin Longmore

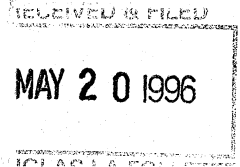

LEGAL NOTICE

TO: All interested parties.

PLEASE TAKE NOTICE that the undersigned Kevin Longmore hereby gives notice, pursuant to the provisions of Section 66.021(3) Wisconsin Statutes, of his intention to circulate an annexation petition of the following described territory of the Town of Hull, Marathon County, Wisconsin:

Part of the NW fractional 1/4 and SW fractional 1/4 of Section 7, T28N, R2E, Town of Hull, Marathon County, Wisconsin, To-wit:

Beginning at the Northeast corner of Lot 2 of Marathon County Certified Survey Map No. 6848;

Thence East on the extension of the North line of said Lot 2, to a point 856 feet West of the East line of the E1/2-S1/2-SW1/4 of said section.

Thence South, parallel with the East line of said E1/2-S1/2-SW1/4, to a point 689 feet more or less South of the North line of said E1/2-S1/2-SW1/4;

Thence Northeasterly to a point that is 421 feet more or less South, and 599 feet more or less West of the Northeast corner of said E1/2-S1/2-SW1/4;

Thence East, parallel with the North line of said E1/2-S1/2-SW1/4, 599 feet more or less to the East line of the SW fractional 1/4;

Thence North, along the East line of said SW and NW fractional 1/4 of said section, to the Northeast corner of said NW fractional 1/4;

Thence West, along the North line of said NW fractional 1/4, to the West section line of Sectional 7, T28N, R2E;

Thence South, along said section line, to the North line of Lot 1 of said Marathon County Certified Survey Map No. 6848 extended west;

Thence East, along the aforementioned North line of said Lot 1, to the Northeast corner of said Lot 1;

Thence South to the point of beginning.

A petition will be circulated among the qualified electors residing in such territory and the owners of real estate therein, for the purpose of annexing said property to the City of Colby, Wisconsin.

Kevin Longmore.

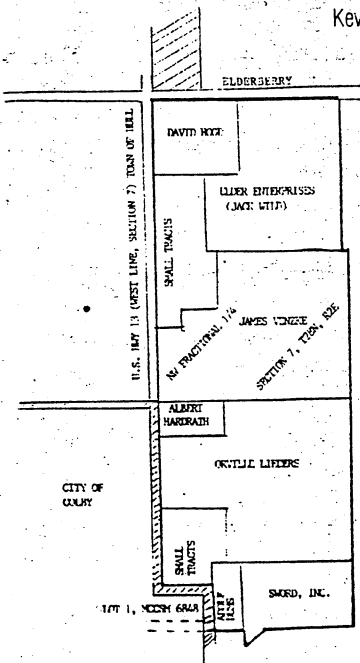

Proposed Annexation to the City of Colby, being a part of the Northwest and Southwest fractional quarters of Section 7 of the Town of Hull, Marathon County, Wisconsin.

J. A. O'Leary being first duly sworn on oath, says that he is the publisher and printer of the Tribune-Phonograph, a weekly newspaper of general circulation, printed and published in the city of Abbotsford, and city of Colby, Wisconsin, county of Clark and state of Wisconsin; that a notice of which the annexed is a true copy was published in said newspaper once a week on the following dates:

Jan. 17, 1996
 _____, 19____
 _____, 19____
 _____, 19____
 _____, 19____

J. A. O'Leary

Subscribed and sworn to before me this

30th day of April

A. D. 1996.

Carol A. O'Leary
 Notary Public

My Commission Expires

Jan. 10, 1999

Received of _____

the sum of _____ DOLLARS

_____ Cents in full payment for publishing notices as above stated.

 Publisher

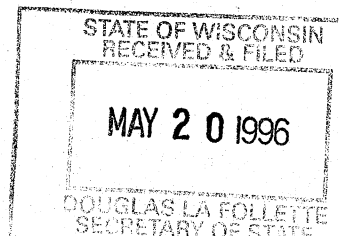

PETITION FOR ANNEXATION

The undersigned, being the owners of real estate and/or electors residing in the following described territory, hereby petition that the property be annexed to the City of Colby, Wisconsin. The property to be annexed is described as follows:

Part of the NW fractional 1/4 and SW fractional 1/4 of Section 7, T28N, R2E, Town of Hull, Marathon County, Wisconsin, To-wit: Beginning at the Northeast corner of Lot 2 of Marathon County Certified Survey Map No. 6848; Thence East on the extension of the North line of said Lot 2, to a point 856 feet West of the East line of the E1/2-S1/2-SW1/4 of said section; Thence South, parallel with the East line of said E1/2-S1/2-SW1/4, to a point 689 feet more or less South of the North line of said E1/2-S1/2-SW1/4; Thence Northeasterly to a point that is 421 feet more or less South, and 599 feet more or less West of the Northeast corner of said E1/2-S1/2-SW1/4; Thence East, parallel with the North line of said E1/2-S1/2-SW1/4, 599 feet more or less to the East line of the SW fractional 1/4; Thence North, along the East line of said SW and NW fractional 1/4 of said section, to the Northeast corner of said NW fractional 1/4; Thence West, along the North line of said NW fractional 1/4, to the West section line of Section 7, T28N, R2E; Thence South, along said section line, to the North line of Lot 1 of said Marathon County Certified Survey Map No. 6848 extended west; Thence East, along the aforementioned North line of said Lot 1, to the Northeast corner of said Lot 1; Thence South to the point of beginning.

(See attached map)

The estimated population residing in the territory to be annexed is 17 persons.

<u>NAME</u>	<u>ADDRESS</u>	<u>DATE</u>
<i>Tom Lyman</i>	<i>114 S. CHERRY MARSHFIELD WI 54449 (OWNER)</i>	<i>1-31-96</i>
<i>Charles J. Gerner</i>	<i>H-3646 West Colby Colby WI (owner)</i>	<i>1-31-96</i>
<i>Paul Fardman</i>	<i>H 4637 W 13th Colby WI in owner</i>	<i>1-96</i>
<i>Orville Lippert</i>	<i>608 E Terrace Colby WI owner</i>	<i>2-6-96</i>
<i>David Wood</i>	<i>St Hwy 13 N. - Colby - WI owner</i>	<i>2-7-96</i>
<i>Robert Wood</i>	<i>H 2671 Colby WI owner</i>	<i>2-7-96</i>

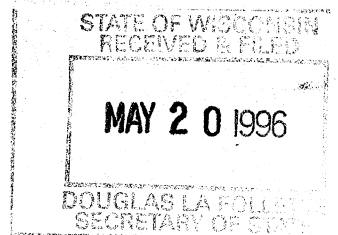

PETITION FOR ANNEXATION

Madford Veterinary Clinic Michael J. Riggall DVM Steven G. Longmore M 2/19/96
The Sword - Bonnie M. Weix owner 2/22/96 H3630 Huckleberry Colby

Multiple horizontal lines for additional text or signatures.

Respectfully submitted to the Clerk of the City of Colby this

30th day of ~~XXXXXX~~, 1996.
APRIL,

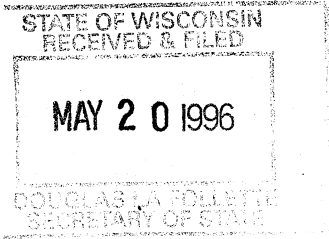

Kevin Longmore
Kevin Longmore

114 South Cherry Marshfield, WI 54449



CITY OF COLBY

211 WEST SPENCE ST., P.O. Box 236
COLBY, WISCONSIN 54421

AFFIDAVIT OF MAILING

State of Wisconsin)
County of Marathon / Clark) ss
City of Colby)

I, *CONNIE GURTNER*, Clerk of the City of Colby, Wisconsin, being sworn, states that on 16 May, 1996, I forwarded properly enclosed in a postpaid envelope a Copy of Ordinance 13-3-10 and Annexation Notice and Plat, addressed to each of the following at the proper post office address set after their name:

Secretary Of State - Wisconsin
30 West Mifflin Street
P.O. Box 7848
Madison, Wisconsin 53707

Clerk - Town of Hull
H 2628 CTH N
Colby, Wisconsin 54421

Register of Deeds - Marathon County
500 Forest Street
Wausau, Wisconsin 54403

Clark Electric Cooperative
124 North Main
Greenwood, Wisconsin 54437

Clerk - Board of Education
Colby School District
District Education Center
505 West Spence Street
Colby, Wisconsin 54421

General Telephone of Wisconsin
P.O. Box 1804
WA4170001-WI
Marion, Ohio 43301-1804

Kurtzweil/Schmidt Appraisals, Inc.
5022 Fairview Road
Edgar, Wisconsin 54426

Marcus Cable Partnership
123 West State
Medford, Wisconsin 54451

Mr. William C. Gamoke, Attorney
Nikolay, Jensen, Scott, Gamoke, Grunewald, SC
P.O. Box 465
Colby, Wisconsin 54421

Northern States Power, Inc.
P.O. Box 8
Eau Claire, Wisconsin 54702

Wisconsin Gas Company
833 West Third
Owen, Wisconsin 54460

Signed: *Connie Gurtner*
Connie Gurtner, City Clerk

Subscribed and sworn to before
me on this 16th day of May, 1996.

Darwin A. Kitz, Notary Public

My commission expires on June 22 1997

