

Kenosha

Annexation of Territory

State of Wisconsin)
Department of State) ss.

Received and filed this^{23rd}.....

day ofApril..... A.D. 19..73..

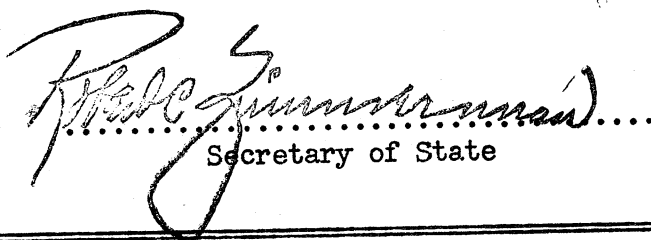
.....
Secretary of State



The State of Wisconsin

DEPARTMENT OF STATE

MADISON 53702

ROBERT C. ZIMMERMAN
SECRETARY OF STATE

State Highway Commission
Room 915
Hill Farm State Office Bldg.
Madison, Wisconsin

Attn: Mr. John Pamperin
Chief of Program & Needs
Division of Plannint

Dear Sir:

Pursuant to s. 66.021 / 66.025, we are pleased to enclose, in
duplicate, certificate and plat relating to annexation of territory
adopted by the Common Council of the City of Kenosha,
Kenosha March 5, 1973
County of _____ on _____.

Yours very truly,

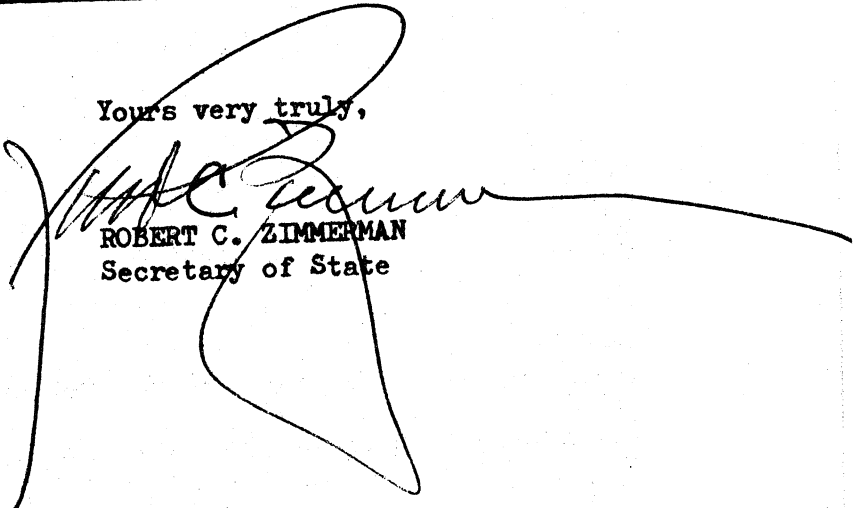
ROBERT C. ZIMMERMAN
Secretary of State

LJF:lsd

Enclosures

cc: Department of Taxation

City Clerk

File

CERTIFICATE OF ANNEXATION

I, Gail F. Procarione, City Clerk of the City of Kenosha, County of Kenosha, State of Wisconsin DO HEREBY CERTIFY that the attached described territory was detached from the Town of Pleasant Prairie, County of Kenosha, and was annexed to said City of Kenosha pursuant to Section 66.021 of the Wisconsin Statutes, by Ordinance duly adopted by the Common Council at a regular meeting held March 5, 1973.

Dated this 20th day of April, 1973

Gail F. Procarione, City Clerk-Treasurer

S E A L

STATE OF WISCONSIN
DEPARTMENT OF STATE
RECEIVED AND FILED

APR 23 1973

ROBERT C. ZIMMERMAN
SECRETARY OF STATE

CITY OF KENOSHA

DISTRICT MAP

ANNEXATION ORD. NO.

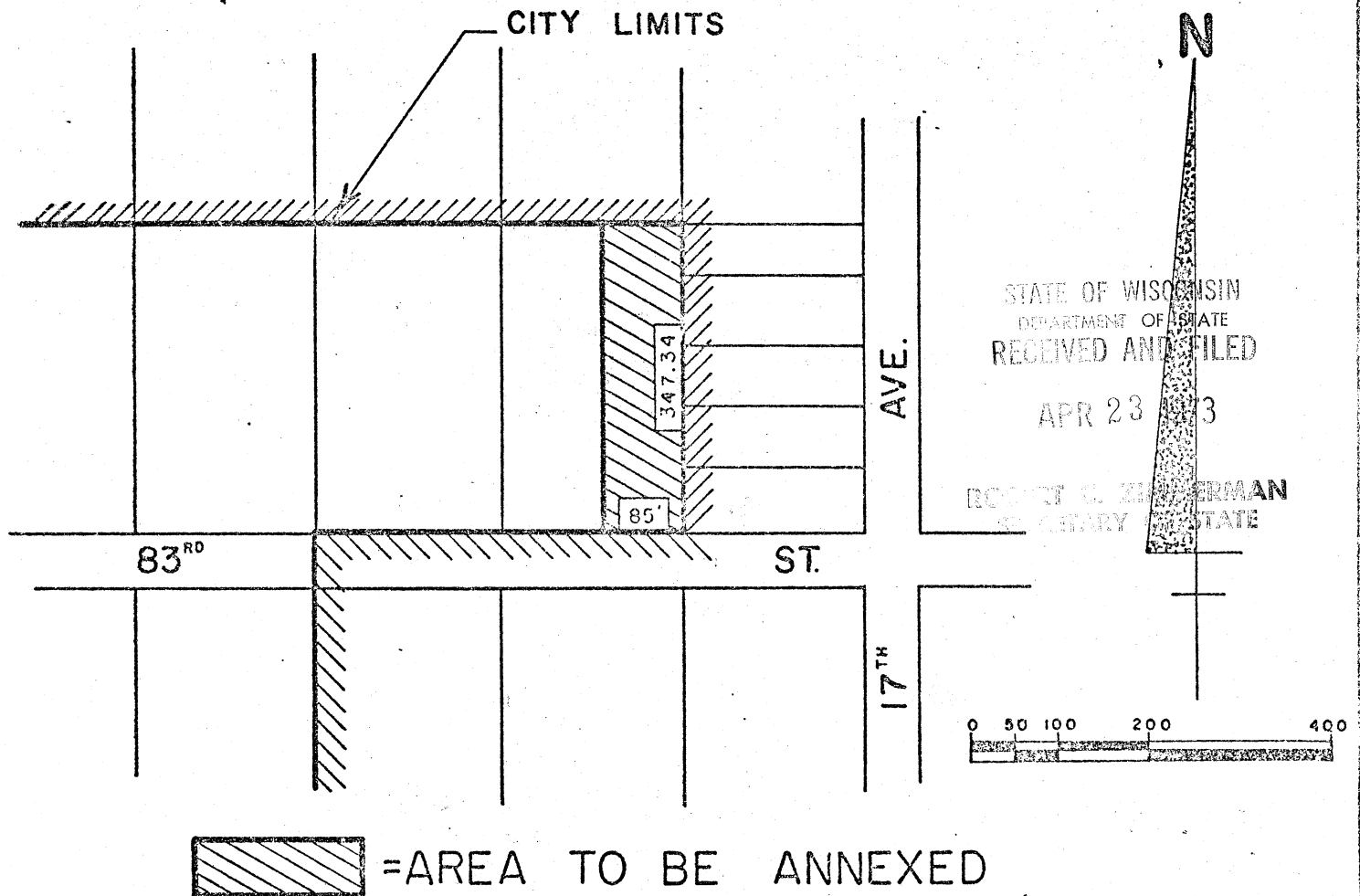

LEGAL DISCRIPTION

A parcel of land in the Southwest Quarter of Section 7, Town 1 North, Range 23 East of the Fourth Principal Meridian, in the Township of Pleasant Prairie, more particularly described as follows:

Beginning at the Southwest corner of Lot 72 in Sunnydale Estates Subdivision, a plat of record in the City of Kenosha; thence N. 2° 09' 49" E. along the west line of said subdivision and the present city limits line 347.34 feet; thence N. 87° 50' 11" W. parallel to the north line of 83rd Street 85.0 feet; thence S. 2° 09' 49" W. 347.34 feet to the north line of 83rd Street; thence S. 87° 50' 11" E. along the north line of 83rd Street 85.0 feet to the point of beginning and containing 0.68 acres more or less.