

Milton
Rock County

ANNEXATION OF TERRITORY

June 15, 1971

State of Wisconsin)
Department of State) ss.

Received and filed this22nd.....

day ofJune... A.D. 19.71...

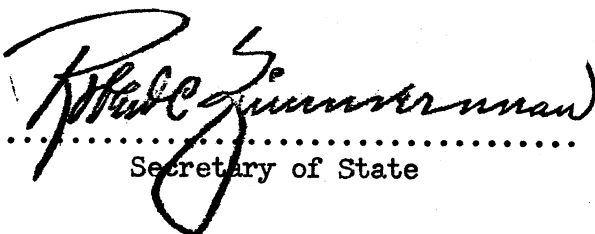
.....
Secretary of State



The State of Wisconsin

DEPARTMENT OF STATE

MADISON 2

June 22, 1971

ROBERT C. ZIMMERMAN

SECRETARY OF STATE

State Highway Commission
State Office Building
Madison, Wisconsin

Attention: Mr. C. A. Lewis
~~XXXXXXXXXXXXXXXXXXXXXXXXXXXX~~
Planning & Research Division
Cartographic Unit

Dear Sir:

Pursuant to s. 66.021 - ~~66.025~~, we are pleased to enclose, in duplicate, certificate and plat relating to annexation of territory adopted by the Common Council of the City of MILTON, County of ROCK on 6-15-71.

Yours very truly,

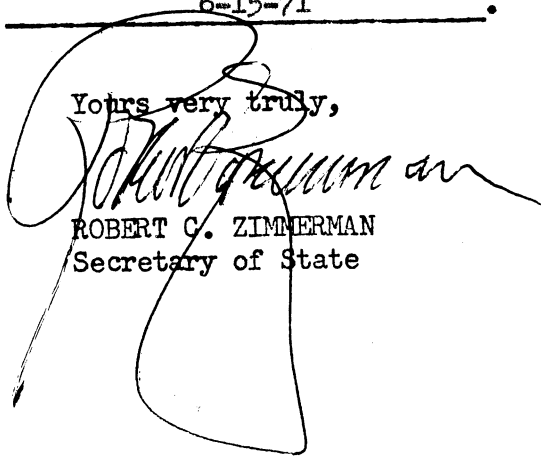
ROBERT C. ZIMMERMAN
Secretary of State

LJF:l
encs.

cc - Dept. of Taxation

cc - City Clerk



STATE OF WISCONSIN
DEPARTMENT OF STATE
120 Parkview Drive
Milton, Wisconsin 53563
Dial 608/868-3645
RECEIVED AND FILED

JUN 22 1971

ROBERT C. THOMAS
DEPUTY CLERK OF STATE

CERTIFICATE OF ANNEXATION

I, Clifford H. Boehm, Clerk-Treasurer of the City of Milton, County of Rock, State of Wisconsin, DO HEREBY CERTIFY that the following described territory was detached from the Town of Milton, County of Rock, and was annexed to the said City of Milton, pursuant to Section 66.021 of the Wisconsin Statutes, by an ordinance adopted by the Common Council at a regular meeting held June 15, 1971:

- (A) Outlot number one hundred fifty (150) of the Assessor's Plat of a part of the Township of Milton, including Milton Junction, in the $W\frac{1}{2}$ of the $SW\frac{1}{4}$ of Section 27, Town 4 North, Range 13 East of the 4th P.M., in the Township of Milton, Rock County, Wisconsin, EXCEPTING, however, the 2 parcels described below:
- (1) A strip of land of uniform width off from the South end of said Outlot number one hundred fifty (150), being Eighty-five and five tenths (85.5) feet from North to South lines and Five Hundred eight and 86/100th (508.86) feet from East to West lines and containing one (1) acre of land, more or less;
 - (2) That part of said Outlot number One hundred fifty (150) described as follows: Beginning at an iron pipe monument in the East line of Hill Top Drive, 430.17 feet South of an iron pipe monument at the intersection of said East line with the Southerly right-of-way line of the C. M. St. P. & P. Ry. land; thence East, at right angles, 113 feet to an iron pipe monument; thence South, at right angles and parallel with the East line of Hill Top Drive, aforesaid, 120 feet to an iron pipe monument; thence West at right angles, 113 feet to an iron pipe monument in the East line of Hill Top Drive, aforesaid; thence North, at right angles and along said East line, 120 feet to the place of beginning. Containing 0.311 of an acre.
- (B) The $E\frac{1}{2}$ of Hill Top Drive commencing in the center of Hill Top Drive from a Westerly extension of the North line of Orchard Row; thence Northerly and along the center of Hill Top Drive to the Southerly right-of-way line of the C. M. St. P. & P. Railroad; (It is the intention in the annexation of the above two properties to include all of Hill Top Drive within the city limits of the City of Milton).

Dated: June 21, 1971

CITY OF MILTON

Clifford H. Boehm
Clifford H. Boehm,
Clerk-Treasurer

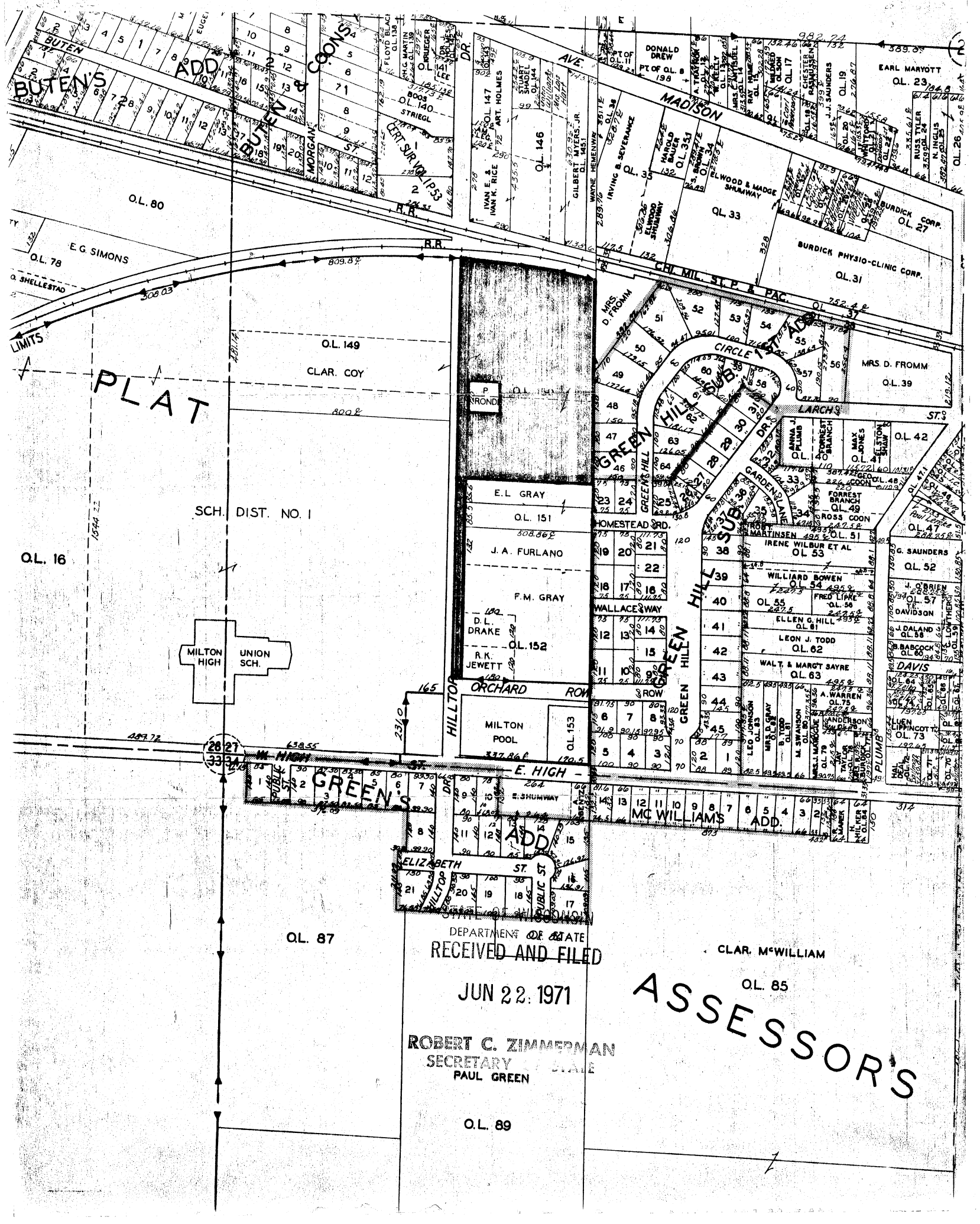

DEPARTMENT OF STATE
RECEIVED AND FILED

JUN 22, 1971

ROBERT C. ZIMMERMAN
SECRETARY OF STATE
PAUL GREEN

ASSESSOR'S