

The State of Wisconsin

Office of the Secretary of State

CITY 41

CITY OF MARSHFIELD

COUNTY OF MARATHON AND WOOD

ANNEXATION ORDINANCE NUMBER 963

FILED DECEMBER 20, 2002

City of Marshfield
Central Plaza
630 S. Central Avenue
P.O. Box 727
Marshfield, Wisconsin 54449-0727



C-41

Deb M. Hall
City Clerk
(715) 384-3636
(715) 384-7831 fax
Email: debbieh@ci.marshfield.wi.us

CERTIFICATE OF CITY CLERK

STATE OF WISCONSIN)
COUNTY OF WOOD)

I, Deb M. Hall, hereby certify that I am the duly elected, qualified and acting CITY CLERK of the CITY OF MARSHFIELD, Wood and Marathon Counties, State of Wisconsin, and as such have charge of the official records of the City:

I further certify that this is a true and correct copy of ORDINANCE NO. 963, adopted by the Common Council on December 17, 2002, and the original is on file in my office.

IN WITNESS WHEREOF, I have hereunto set my hand and the seal of the City of Marshfield, this 18th day of December, 2002.

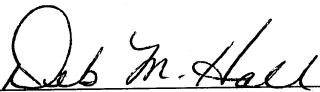
Deb M. Hall, City Clerk

F:\HOME\CL\Certifications\Certification for Ordinances.doc

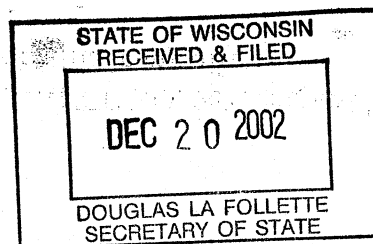

ORDINANCE NO. 963 (REVISED)

AN ORDINANCE ATTACHING CERTAIN LANDS FROM THE TOWN OF LINCOLN, WOOD COUNTY, TO THE CITY OF MARSHFIELD, WISCONSIN.

The Common Council of the City of Marshfield, Wisconsin, does ordain as follows:

SECTION I. Territory Attached

In accordance with the Petition for Direct Annexation filed with the City Clerk on the 20th day of September, 2002, which Petition is acknowledged by the City to be a Petition for Attachment, and which Petition was signed by all of the qualified electors residing in such territory and by all of the owners of all of the real property within the territory proposed to be attached, now, therefore, the following described territory in the Town of Lincoln, Wood County, Wisconsin, is hereby attached to the City of Marshfield, Wisconsin, and is detached from the Town of Lincoln, Wood County, Wisconsin, to-wit:

Lot 1, Wood County CSM No. 7657, Volume 26 Page 157, located in the Southeast Quarter of the Southeast Quarter, Section 1, Township 25 North, Range 2 East, in the Town of Lincoln, Wood County, Wisconsin, and that portion of the Northerly half of Adler Road described as follows:

Commencing in the centerline of Adler Road 33 feet West of the Southeast corner of Section 1, Township 25 North, Range 2 East; thence West along the centerline of Adler Road a distance of 496.70 feet; thence North at a right angle 33 feet; thence East at a right angle 496.70 feet to the West line of Lincoln Avenue; thence South at a right angle 33 feet to the point of beginning.

SECTION II. Effect of Annexation

From and after the date of the adoption and publication of this Ordinance, the territory described in Section I shall be a part of the City of Marshfield for any and all purposes provided by law and all persons coming and residing within such territories shall be subject to all ordinances, rules and regulations governing the City of Marshfield.

SECTION III. Zoning

The attached territory shall be classified for zoning purposes as R-3, Standard – Single Family, as of the effective date to this ordinance.

SECTION IV. Severability

If any provision of this Ordinance is invalid or unconstitutional, or if the application of this Ordinance to any person or circumstance is invalid or unconstitutional, such unconstitutionality shall not affect the other provisions or obligations of this Ordinance which can be given effect without the invalid or unconstitutional provision or application.

SECTION V. Required Filings

The City Clerk shall file immediately with the Secretary of State a certified copy of the Ordinance, with a copy of the map and the legal description and the City Clerk shall send one copy to each company that provides any utility service in the area that is attached. The City Clerk shall also record the Ordinance with the Register of Deeds and file a signed copy of the Ordinance with the Clerk of any affected school district. The Clerk's certificate shall include reference to the population of the territory being attached as set forth in the Petition, which population is zero (0) persons.

SECTION VI. Effective Date

This Ordinance shall be effective upon passage and publication as required by law.

ADOPTED 12-17-02

APPROVED 12-17-02

PUBLISHED _____

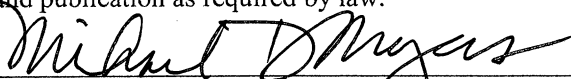
Michael D. Meyers, Mayor

ATTEST: _____

Deb M. Hall, City Clerk

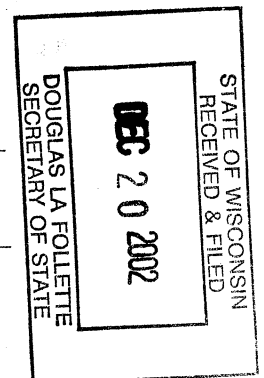

CERTIFIED SURVEY MAP

WOOD COUNTY NO. 7657 VOL. 26 PAGE 157

ALL OF LOT 3 OF CSM 7104-24-204, LOCATED IN THE SE1/4 SE1/4, SECTION 1, TOWNSHIP 25 NORTH, RANGE 2 EAST, TOWN OF LINCOLN, WOOD COUNTY, WISCONSIN.

STATE OF WISCONSIN
RECEIVED & FILED

DEC 20 2002

DOUGLAS LA FOLLETTE
SECRETARY OF STATE

VREELAND ASSOCIATES, INC.
6103 DAWN STREET WESTON, WI. 54476
PH (715) 241-0947 OR (866) 693-3979
FAX (715) 241-9826

PREPARED FOR: **JOE MELLA**
OWNER: **HAROLD MACHTAN**

FILE #: M-29-02 MELLA CSM DRAFTED AND DRAWN BY: TIMOTHY G. VREELAND

SHEET 1 OF 2
SEE SHEET 2 OF 2

BEARINGS REFERENCED TO THE
SOUTH LINE SE1/4, S4D SEC 1,
RECORDED TO BEAR N 88°27'32" W

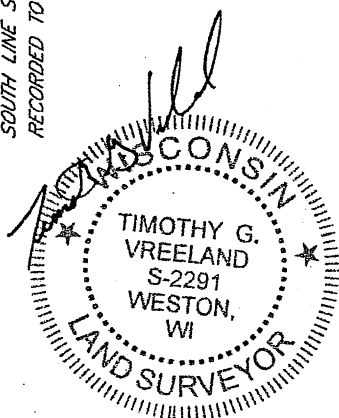

NOTE

7 FEET OF RIGHT-OF-WAY BEING
DEDICATED WITH THIS SURVEY.

SE1/4 CORNER
SEC 1-25-2E

2082.07'

ADLER ROAD
COUNTY ROAD "Y"

LEGEND

- ⊙ = GOVERNMENT CORNER LOCATION PER
COUNTY SURVEY RECORDS
- = 7/8" REBAR FOUND IN PLACE
- = 1" OD x 18" IRON PIPE 1.13lbs/ft. SET
- ⊙ = 3/4" REBAR FOUND IN PLACE
- = 10' UTILITY EASEMENT
- ////// = NO ACCESS
- = 30' SETBACK

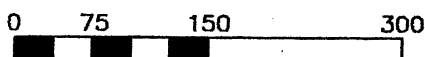

SCALE 1" = 150'

OWNER: HAROLD J. MACHTAN
317 OAK ST. BARABOO, WI 53913
608-356-8339

SURVEYORS CERTIFICATE

I, TIMOTHY G. VREELAND, REGISTERED LAND SURVEYOR, DO HEREBY CERTIFY THAT AT THE DIRECTION OF JOE MELLA, I SURVEYED, MAPPED AND DIVIDED ALL OF LOT 3 OF WOOD COUNTY CERTIFIED SURVEY MAP NUMBER 7104, RECORDED IN VOLUME 24, ON PAGE 204, LOCATED IN THE SOUTHEAST QUARTER OF THE SOUTHEAST QUARTER OF SECTION 1, TOWNSHIP 25 NORTH, RANGE 2 EAST, TOWN OF LINCOLN, WOOD COUNTY, WISCONSIN, DESCRIBED AS FOLLOWS:

COMMENCING AT THE SOUTHEAST CORNER OF SAID SECTION 1; THENCE N 88°27'32" W 529.83 FEET; THENCE N 0°10'48" E 33.01 FEET TO THE NORTH LINE OF ADLER ROAD AND TO THE POINT OF BEGINNING; THENCE N 0°10'48" E 561.50 FEET; THENCE S 88°27'32" E 498.14 FEET TO THE WEST LINE OF LINCOLN AVENUE; THENCE S 0°19'37" W ALONG THE WEST LINE OF LINCOLN AVENUE 87.54 FEET; THENCE N 89°35'17" W 200.15 FEET; THENCE S 0°17'55" W 299.10 FEET; THENCE S 89°40'23" E 200.00 FEET; THENCE S 0°19'37" W ALONG THE WEST LINE OF LINCOLN AVENUE 175.13 FEET; THENCE N 88°27'32" W ALONG THE NORTH LINE OF ADLER ROAD 496.70 FEET TO THE POINT OF BEGINNING. SUBJECT TO ALL EASEMENTS, RESTRICTIONS AND RIGHTS-OF-WAY OF RECORD OR USAGE.

THAT SUCH MAP IS A CORRECT REPRESENTATION OF ALL EXTERIOR BOUNDARIES OF THE LAND SURVEYED AND THE CERTIFIED SURVEY MAP THEREOF MADE.

THAT I HAVE FULLY COMPLIED WITH CHAPTER 236.34 OF THE WISCONSIN STATUTES, CHAPTER A-E 7 OF THE WISCONSIN ADMINISTRATIVE CODE AND THE LAND DIVISION ORDINANCE OF WOOD COUNTY AND THE TOWN OF LINCOLN, ALL TO THE BEST OF MY KNOWLEDGE AND BELIEF IN SURVEYING, DIVIDING AND MAPPING THE SAME.

Timothy G. Vreeland

DATED THIS 2nd DAY OF OCTOBER, 2002

TIMOTHY G. VREELAND

R.L.S. 2291

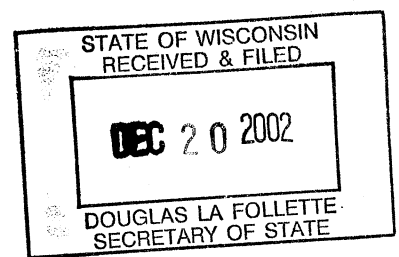

CERTIFIED SURVEY MAP

WOOD COUNTY NO. _____ VOL. _____ PAGE _____
ALL OF LOT 3 OF CSM 7104-24-204, LOCATED IN THE SE1/4 SE1/4,
SECTION 1, TOWNSHIP 25 NORTH, RANGE 2 EAST, TOWN OF LINCOLN,
WOOD COUNTY, WISCONSIN.

VREELAND ASSOCIATES, INC. 6103 DAWN STREET WESTON, WI. 54476 PH (715) 241-0947 OR (866) 693-3979 FAX (715) 241-9826	PREPARED FOR: JOE MELLA OWNER: HAROLD MACHTAN
FILE #: M-29-02 MELLA CSM DRAFTED AND DRAWN BY: TIMOTHY G. VREELAND	

This Certified Survey Map is approved in
accordance with Chapter 18.04(3) of the
Municipal Code.

12/6/02 Thomas R. Tunk.
Date City Engineer

OWNERS CERTIFICATE OF DEDICATION

AS OWNERS, WE HEREBY CERTIFY THAT WE CAUSED THE LAND DESCRIBED ON THIS MAP TO BE
SURVEYED, DIVIDED, MAPPED AND DEDICATED AS REPRESENTED ON THE MAP. WE ALSO CERTIFY
THAT THIS MAP IS REQUIRED BY s.236.10 OR s.236.12 TO BE SUBMITTED TO THE FOLLOWING FOR
APPROVAL OR OBJECTION: TOWN OF LINCOLN, CITY OF MARSHFIELD AND WOOD COUNTY.

Ronald R. Machtan
RONALD R. MACHTAN
Wayne G. Machtan
WAYNE G. MACHTAN
Marvin R. Machtan
MARVIN R. MACHTAN
Roger A. Machtan
ROGER A. MACHTAN

Harold J. Machtan
HAROLD J. MACHTAN
Betty Lou Stargardt
BETTY LOU STARGARDT
Gary R. Machtan
GARY R. MACHTAN

STATE OF WISCONSIN)
WOOD COUNTY) SS

PERSONALLY CAME BEFORE ME THIS 5 DAY OF December, 2002, THE ABOVE NAMED HAROLD
J. MACHTAN, BETTY LOU STARGARDT, GARY R. MACHTAN, RONALD R. MACHTAN, WAYNE G. MACHTAN,
MARVIN R. MACHTAN AND ROGER A. MACHTAN TO ME KNOWN TO BE THE SAME PERSONS WHO
EXECUTED THE FOREGOING INSTRUMENT AND ACKNOWLEDGED THE SAME.

Marietta J. T. Machtan
NOTARY PUBLIC, WOOD COUNTY, WISCONSIN

MY COMMISSION EXPIRES 5/28/06

COMMON COUNCIL RESOLUTION

RESOLVE, THAT THIS MAP IN THE TOWN OF LINCOLN, HAROLD J. MACHTAN, BETTY LOU
STARGARDT, GARY R. MACHTAN, RONALD R. MACHTAN, WAYNE G. MACHTAN, MARVIN R. MACHTAN AND
ROGER A. MACHTAN, OWNERS, IS HEREBY APPROVED BY THE COMMON COUNCIL, CITY OF
MARSHFIELD.

DATE 12/11/02

APPROVED Michael Dreyer
MAYOR

DATE 12/11/02

SIGNED Michael Dreyer
MAYOR

I HEREBY CERTIFY THAT THE FOREGOING IS A COPY OF A RESOLUTION ADOPTED BY THE COMMON
COUNCIL OF THE CITY OF MARSHFIELD.

DATE 12/11/02

Deb M. Hall
CITY CLERK