

The State of Wisconsin

Office of the Secretary of State

VILLAGE 201

VILLAGE OF SAUKVILLE

COUNTY OF OZAUKEE

ANNEXATION ORDINANCE NUMBER 611

FILED FEBRUARY 9, 2004



V-201

639 E. Green Bay Avenue • Saukville, WI 53080 • 262-284-9423 • METRO 262-375-1884 • FAX 262-284-9527

February 5, 2004

Annexations and Railroads
Division of Government Records
Office of the Secretary of State
P. O. Box 7848
Madison, Wisconsin 53707-7848

Enclosed please find the annexation papers for Ordinance #611 for the Village of Saukville with regard to property being annexed from the Town of Port Washington to the Village of Saukville. Current population of the annexed territory is three.

Sincerely,

Mary K. Baumann
Deputy Clerk

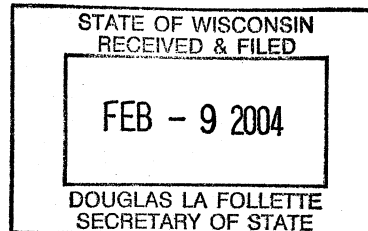

ORDINANCE #611

**ORDINANCE PROVIDING FOR DIRECT ANNEXATION OF A PORTION OF
THE TOWN OF PORT WASHINGTON, OZAUKEE COUNTY, WISCONSIN, TO
THE VILLAGE OF SAUKVILLE, OZAUKEE COUNTY, WISCONSIN**

BE IT ORDAINED, by the Village Board of the Village of Saukville, Ozaukee County,
Wisconsin, as follows:

Section 1. Territory Annexed.

In accordance with Sec. 66.0217 of the Wisconsin Statutes, and the petition for direct annexation filed with the Village Clerk on the 19th of November, 2003, signed by all of the Electors in the territory and the owners of all the real property in the territory, the territory described below in the Town of Port Washington, Ozaukee County, Wisconsin, is annexed to the Village of Saukville, Ozaukee County, Wisconsin.

Part of the southwest quarter of the southwest quarter of section 30, T.11N., R.22 E., Town of Port Washington, Ozaukee County, Wisconsin containing 0.70 acres of land and described as: commencing at the southwest corner of said section 30; thence north 347.45 feet to the point of beginning; thence continue north 164.00 feet; thence east 187.00 feet; thence south 164.00 feet; thence west 187.00 feet to the point of beginning.

Section 2. Population

The population of the territory annexed is three (3).

Section 3. Effect of Annexation.

From and after the date of this ordinance the territory described in Section 1, shall be a part of the Village of Saukville for any and all purposes provided by law and all persons coming and residing within such territory shall be subject to all ordinances, rules and regulations governing the Village of Saukville.

Section 4. Zoning Classification.

- (a) Pursuant to Sec. 11.0401 F., of the Zoning Ordinance of the Village of Saukville, the territory annexed to the Village of Saukville by this ordinance is zoned as follows: A-1, Agricultural.
- (b) The Plan Commission is directed to evaluate the permanent zoning classification for the annexed area and submit its recommendation to the Village Board no later than May 1, 2004.

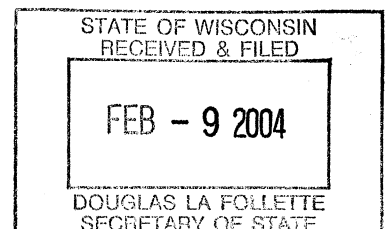

Section 5. Ward Designation.

This Ordinance hereby creates Ward 8 of the Village of Saukville. The territory described in Section 1 of this Ordinance is hereby designated Ward 8 of the Village of Saukville, Wisconsin. This Ward shall be part of Supervisory District 6, Assembly District 60, and School District: Port Washington/Saukville.

Section 6. Severability.

If any provision of this ordinance is invalid or unconstitutional, or if the application of this ordinance to any person or circumstances is invalid or unconstitutional, such invalidity or unconstitutionality shall not affect the other provisions or applications of this ordinance which can be given effect without the invalid or unconstitutional provision or application.

Section 7. Filing and Recording.

The Village Clerk is hereby directed, pursuant to Section 66.0217(9) Wis. Stats., to file immediately with the Secretary of State a certified copy of this ordinance, certificate and plat, and send one copy of each company that provides any utility service in the area annexed, and record the Ordinance with the Register of Deeds, and file a signed copy of the Ordinance with the Clerk of any affected school district.

Section 8. Effective Date.

This ordinance shall take effect upon passage and posting as provided by law.

Introduced and adopted this 3rd day of February, 2004.

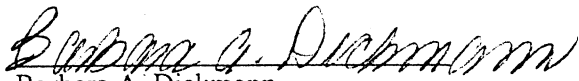
Barbara A. Dickmann
Village President

ATTEST:

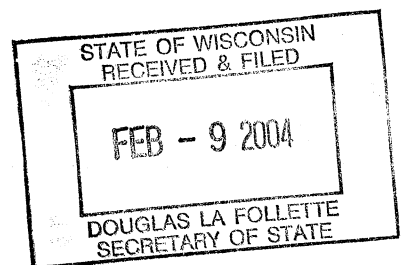

Dawn M. Wagner
Village Administrator/Clerk



D & H LAND SURVEYS LLC
526 S. 8TH STREET
SHEBOYGAN, WISCONSIN

ANNEXATION MAP OF 2934 NORTHWOODS ROAD

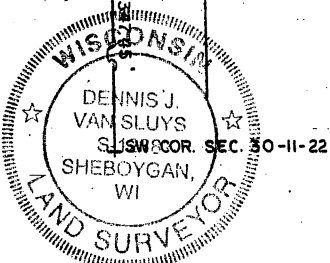
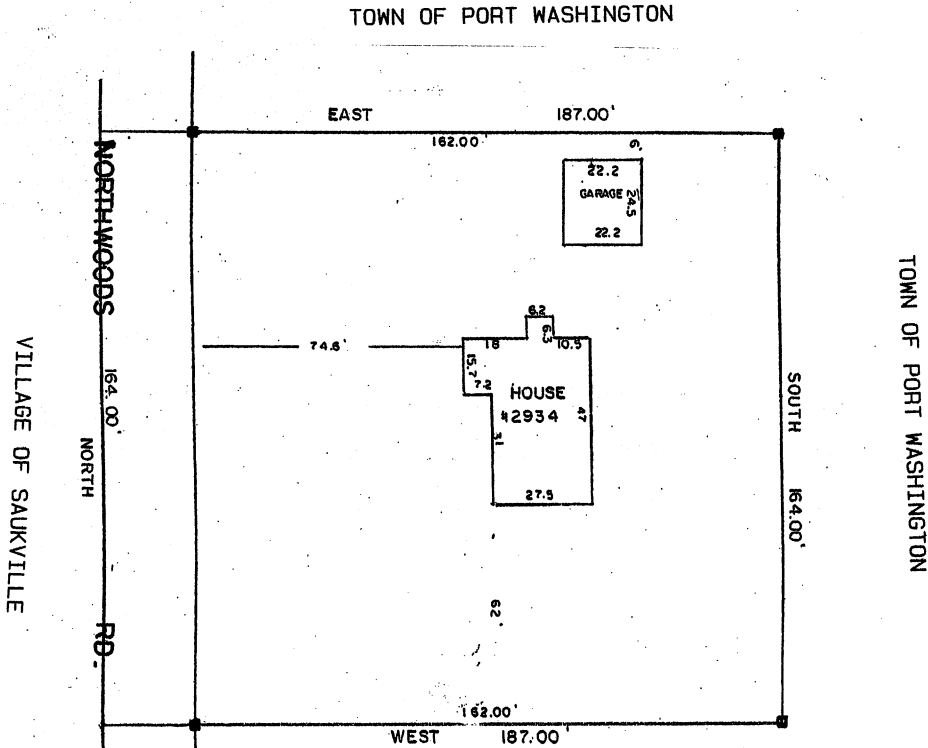
PART OF THE SOUTHWEST QUARTER OF THE SOUTHWEST QUARTER OF SECTION 30, T.11 N., R.22 E., TOWN OF PORT WASHINGTON, OZAUKEE COUNTY, WISCONSIN CONTAINING 0.70 ACRES OF LAND AND DESCRIBED AS: COMMENCING AT THE SOUTHWEST CORNER OF SAID SECTION 30; THENCE NORTH 347.45 FEET TO THE POINT OF BEGINNING; THENCE CONTINUE NORTH 164.00 FEET; THENCE EAST 187.00 FEET; THENCE SOUTH 164.00 FEET; THENCE WEST 187.00 FEET TO THE POINT OF BEGINNING.



THIS IS AN ORIGINAL PRINT ONLY
IF SEAL IS IMPRINTED IN RED

This is to certify that the information shown hereon is correct to the best of my knowledge and belief.

Dennis J. Van Sluys
Dennis J. Van Sluys S-1238

dated this 31st day of *Oct*, 2003

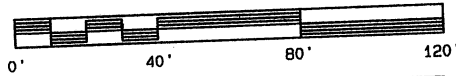

1" = 40'

= CONC. MON. FOUND 7/25/1990

L-19064

