

The State of Wisconsin

Office of the Secretary of State

VILLAGE 226

VILLAGE OF HAMMOND

COUNTY OF ST CROIX

CORPORATE BOUNDARIES AND PLAT MAP

FILED AUGUST 4, 2004

V-226

VILLAGE OF HAMMOND

The Heart of St. Croix County

Clerk/Treasurer: Wanda M. Madsen

President: Thomas J. Kinney

Trustees: Karl Ausland

David Benkufsky

Douglas Doll

Mark Iverson

Steve Peterson

Mary Rivard

August 2, 2004

Government Records Division
Contact Person: Tineisha Scott
30 West Mifflin Street, 10th Floor
Post Office Box 7848
Madison, WI 53707-7848

I, Wanda M. Madsen, clerk/treasurer, of the Village of Hammond do hereby certify that the attach documents of the Village of Hammond Corporate Boundaries are true and correct originals.

By its original signature and original corporate seal of Village Clerk and Village Seal.

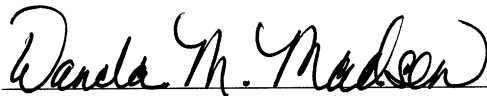

Wanda M. Madsen CMC/CMTW
Village Clerk/Treasurer

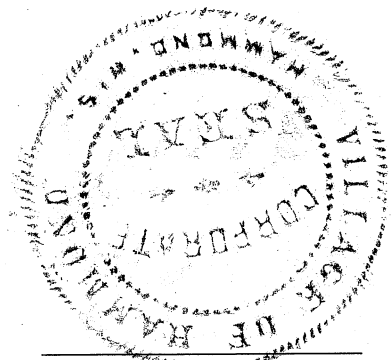

Corporate Seal

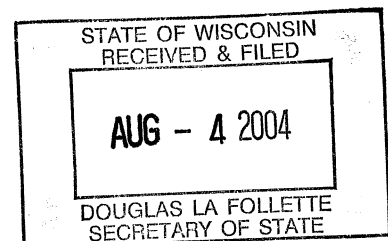

VILLAGE OF HAMMOND CORPORATE BOUNDARY
December 31, 2003

Prepared by: Harry B. Warden, LS
Ayres Associates
Eau Claire, WI
April 15, 2004 (Revised April 24, 2004, Gregory J. Raymond, LS)

Part of the Southeast Quarter of the Southwest Quarter, all of the Northeast Quarter of the Southwest Quarter, all of the Southwest Quarter of the Southeast Quarter, all of the Southeast Quarter of the Southeast Quarter and part of the Northeast Quarter of the Southeast Quarter, Section 21; part of the Northwest Quarter of the Southwest Quarter, all of the Southwest Quarter of the Southwest Quarter and all of the Southeast Quarter of the Southwest Quarter, Section 22; all of the Northwest Quarter of the Northwest Quarter, all of the Northeast Quarter of the Northwest Quarter, all of the Southwest Quarter of the Northwest Quarter, all of the Southeast Quarter of the Northwest Quarter, part of the Southwest Quarter of the Northeast Quarter, all of the Northeast Quarter of the Southwest Quarter, all of the Northwest Quarter of the Southwest Quarter and all of the Southeast Quarter of the Southwest Quarter, Section 27; all of the Northeast Quarter of the Northeast Quarter, all of the Northwest Quarter of the Northeast Quarter, all of the Southwest Quarter of the Northeast Quarter, all of the Southeast Quarter of the Northeast Quarter, all of the Northeast Quarter of the Southeast Quarter, all of the Northwest Quarter of the Southeast Quarter, all of the Southwest Quarter of the Southeast Quarter, all of the Southeast Quarter of the Southeast Quarter, all of the Northeast Quarter of the Southwest Quarter and all of the Southeast Quarter of the Southwest Quarter, Section 28, all of the Northeast Quarter of the Northeast Quarter, all of the Southeast Quarter of the Northeast Quarter, all of the Southwest Quarter of the Northeast Quarter and all of the Northwest Quarter of the Northeast Quarter, Section 33; all in Township 29 North, Range 17 West, Village of Hammond, St. Croix County, Wisconsin bounded by a line described as follows:

Beginning at the northeast corner of said Section 33;
Thence S00°14'22"E, 2619.98 feet to the east one-quarter corner of said Section 33;
Thence N89°25'04"W, 2598.31 feet to the center one-quarter corner of said Section 33;
Thence N00°10'39"W, 2625.04 feet to the south one-quarter corner of said Section 28;
Thence N89°18'59"W, 1303.90 feet to the southwest corner of the Southeast Quarter of the Southwest Quarter of said Section 28;
Thence N00°01'10"W, 1320.26 feet to the northwest corner of the Southeast Quarter of the Southwest Quarter of said Section 28;
Thence N00°01'10"W, 1320.26 feet to the northwest corner of the Northeast Quarter of the Southwest Quarter of said Section 28;
Thence S89°12'56"E, 1308.25 feet to the northeast corner of the Northeast Quarter of the Southwest Quarter of said Section 28;
Thence N00°04'28"E, 1318.23 feet to the northwest corner of the Southwest Quarter of the Northeast Quarter of said Section 28;
Thence N00°04'28"E, 1318.23 feet to the southeast corner of the Southeast Quarter of the Southwest Quarter of said Section 21;
Thence N88°51'47"W, along the south line of said southeast quarter of the southwest quarter, 471.52 feet;
Thence N01°08'13"E, 480.00 feet;
Thence N88°51'47"W, 453.75 feet;
Thence S01°08'13"W, 480.00 feet to the south line of the Southeast Quarter of the Southwest Quarter of said Section 21;

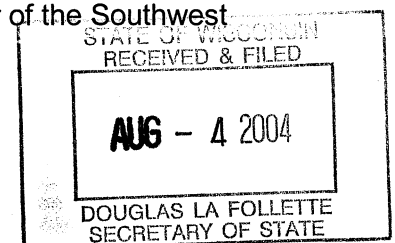

Thence N88°51'47"W, 387.37 feet to the southwest corner of the Southeast Quarter of the Southwest Quarter of said Section 21;
 Thence N00°15'24"W, 1313.77 feet to the northwest corner of the Southeast Quarter of the Southwest Quarter of said Section 21;
 Thence N00°15'24"W, 1313.77 feet to the northwest corner of the Northeast Quarter of the Southwest Quarter of said Section 21;
 Thence S88°40'04"E, 1317.25 feet to the northeast corner of the Northeast Quarter of the Southwest Quarter of said Section 21;
 Thence S00°09'29"E, 1311.47 feet to the southeast corner of the Northeast Quarter of the Southwest Quarter of said Section 21;
 Thence S88°45'55"E, 1303.72 feet to the northwest corner of the Southeast Quarter of the Southeast Quarter of said Section 21;
 Thence S88°45'55"E, along the north line of the said southeast quarter of the southeast quarter, 519.83 feet;
 Thence N00°01'55"W, 327.07 feet;
 Thence S88°44'27"E, 784.14 feet to the east line of the Northeast Quarter of the Southeast Quarter of said Section 21;
 Thence S00°00'36"W, along said line, 326.73 feet to the northwest corner of the Southwest Quarter of the Southwest Quarter of said Section 22;
 Thence N90°00'00"E, along the north line of the said southwest quarter of the southwest quarter, 340.40 feet;
 Thence N13°21'11"E (recorded as N13°06'13"E), 241.53 feet;
 Thence N86°26'11"E (recorded as N86°11'13"E), 173.73 feet;
 Thence S71°34'09"E (recorded as S71°49'07"E), 178.15 feet;
 Thence S89°38'09"E (recorded as S89°53'07"E), 191.69 feet;
 Thence S01°24'41"W (recorded as S01°09'43"W), 71.83 feet;
 Thence S88°17'29"E (recorded as S88°32'27"E), 389.01 feet, more or less, to the east line of the Northwest Quarter of the Southwest Quarter of said Section 22;
 Thence S00°00'00"W, 104.85 feet, more or less, to the southeast corner of the Northwest Quarter of the Southwest Quarter of said Section 22;
 Thence S90°00'00"E, 1311.97 feet, more or less, to the northeast corner of the Southeast Quarter of the Southwest Quarter of said Section 22;
 Thence S00°00'00"W, 1315.74 feet, more or less, to the southeast corner of the Southeast Quarter of the Southwest Quarter of said Section 22;
 Thence S00°03'41"W, 1315.24 feet to the southeast corner of the Northeast Quarter of the Northwest Quarter of said Section 27;
 Thence S89°41'46"E, 1316.36 feet to the northeast corner of the Southwest Quarter of the Northeast Quarter of said Section 27;
 Thence S00°00'37"W, along the east line of the said southwest quarter of the northeast quarter, 1129.93 feet to the north right-of-way line of the Union Pacific Railroad;
 Thence S86°29'24"W, along said right-of-way line, 624.93 feet to the southeast corner of Lot 1 of the certified survey map recorded in Volume 3 of Certified Survey Maps, Page 785;
 Thence N00°03'41"E, 628.12 feet to the northeast corner of said Lot 1;
 Thence S86°29'24"W, along the north line of said lot, 694.98 feet to the east line of the Southeast Quarter of the Northwest Quarter of said Section 27;
 Thence S86°29'24"W, 58.67 feet, to the westerly right-of-way line of Town Line Road;
 Thence S00°03'41"W, on said line, 628.06 feet;
 Thence N86°29'47"E, 58.67 feet, to the east line of the Southeast Quarter of the Northwest Quarter of said Section 27;
 Thence S00°03'41"W, 97.58 feet; to the southeast corner of the Southeast Quarter of the Northwest Quarter of said Section 27;

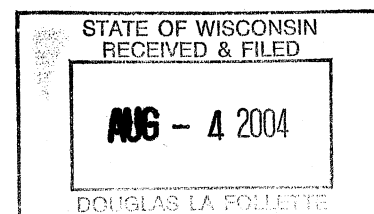

Thence S00°03'41"W, 1318.73 feet to the southeast corner of the Northeast Quarter of the Southwest Quarter of said Section 27;
Thence S00°03'41"W, 1318.73 feet to the southeast corner of the Southeast Quarter of the Southwest Quarter of said Section 27;
Thence N89°30'57"W, 1319.26 feet; to the southwest corner of the Southeast Quarter of the Southwest Quarter of said Section 27
Thence N00°06'36"E, 1317.88 feet to the northwest corner of the Southeast Quarter of the Southwest Quarter of said Section 27;
Thence N89°33'09"W, 1318.10 feet to the southwest corner of the Northwest Quarter of the Southwest Quarter of said Section 27;
Thence S00°09'26"W, 1317.04 feet to the southwest corner of said Section 27 and the point of beginning.

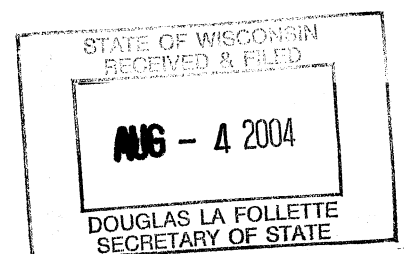

22

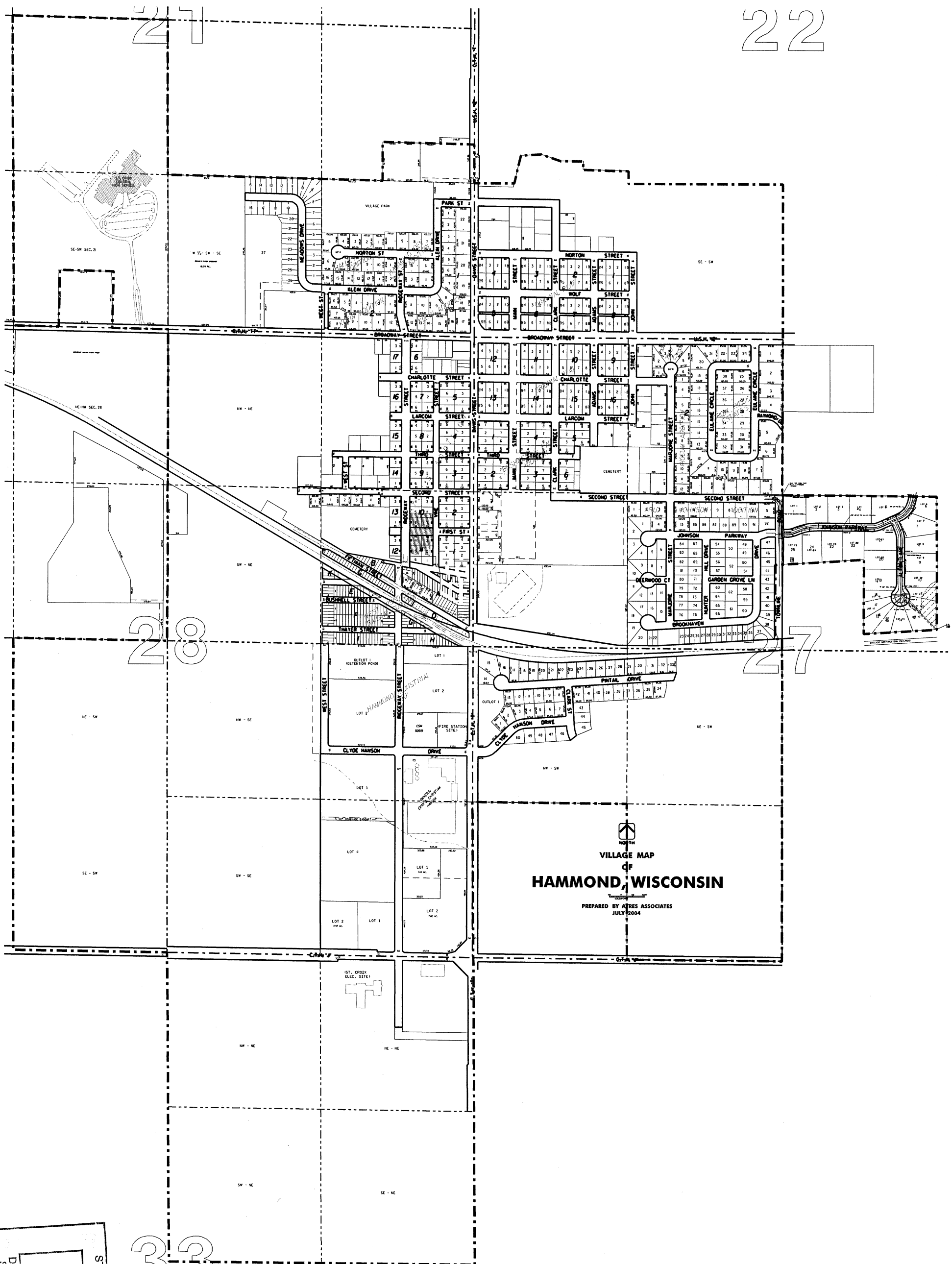

3!3

STATE OF WISCONSIN
RECEIVED & FILED
AUG - 4 2004
DOUGLAS LA FOLLETTE
SECRETARY OF STATE