

The State of Wisconsin

Office of the Secretary of State

VILLAGE 314

VILLAGE OF ADELL

COUNTY OF SHEBOYGAN

CORPORATE BOUNDARIES & PLAT MAP

FILED DECEMBER 12, 2006



VILLAGE OF ADELL

508 Seifert Street
Adell, WI 53001-0047

Adell Village Clerk/Treasurer
508 Seifert Street
OFFICE: (920)994-8620
FAX: (920)994-2750
E-MAIL: villageadell@voyager.net

Adell Municipal Garage
608 Tower Avenue
OFFICE: (920)994-4473
PAGER: (920)576-4430
MOBILE: (920)946-5363

V-314

Friday, December 08, 2006

I, Rhonda J. Klatt, certify that the copies enclosed of the Village of Adell Corporate Boundaries are indeed true, actual and correct.

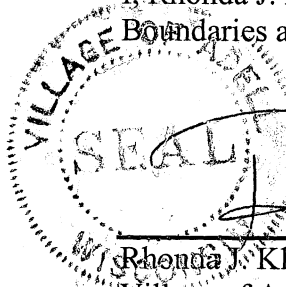

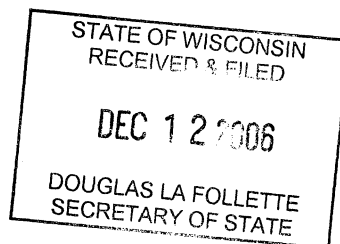

Rhonda J. Klatt
Village of Adell Clerk/Treasurer



Adell Cooperate Boundary Description

COPY
orig mailed
2/20/06

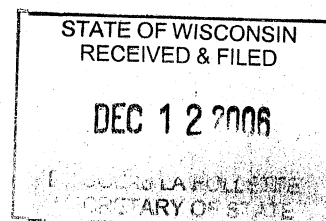
Commencing at the Northeast corner of the Northeast quarter of Section 11, Town 13 North, Range 21 East, in the Village of Adell, Sheboygan County; thence South 88° 52' 17" West along the North line of the Northeast Quarter of said Section, 317.86' to the point of beginning; thence South 45° 36' 15" East, 203.18' to the west right of way of State Highway "57"; thence South 00° 11' 53" West, along the west Right of Way line of State Highway "57", 829.15 feet; thence South 88° 51' 39" West, 457.95 feet; thence North 00° 09' 48" West, 974.13 feet to the North line of said Quarter Section; thence South 88° 52' 17" West, along the North line of said Quarter section 944.92 feet; thence South 01° 31' 00" East, 249.00 feet; thence South 88° 29' 00" West, 360.00 feet; thence North 01° 31' 00" West, 251.44 feet to the said Quarter line; thence South 88° 52' 17" West along said section line 710.91 feet to the North Quarter corner of Section 11; thence South 89° 12' 25" West, 1314.33 feet; thence North 00° 36' 41" East 1325.76 feet; thence North 89° 07' 26" East, 461.10 feet to the west Right Of Way of Chicago Milwaukee Rail Road; thence North 07° 29' 17" West, along the west Right Of Way of said Rail Road 2808.34 feet to the North line of the Northwest Quarter of the Southwest Quarter of section 2; thence North 89° 25' 32" East, 1250.68 feet to the Northeast Quarter corner of the Northwest Quarter of the Southwest Quarter of said section; thence North 00° 38' 30" East, 359.35 feet; thence North 87° 11' 31" East, 674.78 feet; thence South 05° 27' 26" West, 387.72 feet; thence North 89° 25' 32" East 633.18 feet; thence North 00° 51' 00" East, 321.40 feet; thence North 01° 25' 45" East, 835.15 feet; thence North 89° 59' 25" East, 220.00 feet; thence North 01° 25' 50" East, 290.00 feet; thence North 89° 53' 52" East, 391.08 feet; thence South 00° 06' 08" East 33.02, feet; thence South 86° 40' 07" East, 200.36 feet; thence North 89° 53' 52" East, 194.95 feet; thence South 45° 05' 16" East, 84.81 feet to the west Right of Way of State Highway "57"; thence South 00° 02' 24" East, along the west Right Of Way of State Highway "57", 269.84 feet; thence South 00° 23' 26" West, along said Highway 881.75'; thence North 87° 31' 50" West, 203.13 feet; thence South 02° 24' 13" West, 298.56 feet; thence North 88° 26' 31" East, 108.86 feet; thence South 00° 22' 16" West, 254.45 feet; thence North 80° 39' 05" West, 259.95 feet; thence North 00° 22' 16" East, 198.87 feet; thence Southwesterly, along a curve 332.92 feet, having a radius of Southern convexity of 954.84 feet, with a chord which bears South 70° 37' 18" West, 351.93 feet; thence South 00° 06' 07" East, 348.94 feet; thence South 79° 51' 4" West, 380.86 feet; thence South 00° 06' 9" East, 803.69 feet; thence North 88° 57' 57" East, 1151.47 feet to the west Right Of Way of State Highway "57"; thence South 00° 11' 27" West, along said highway Right Of Way, 2501.96 feet; thence South 45° 23' 53" West, 216.19 feet to the point of beginning.



COPY
orig mailed 9/20/06

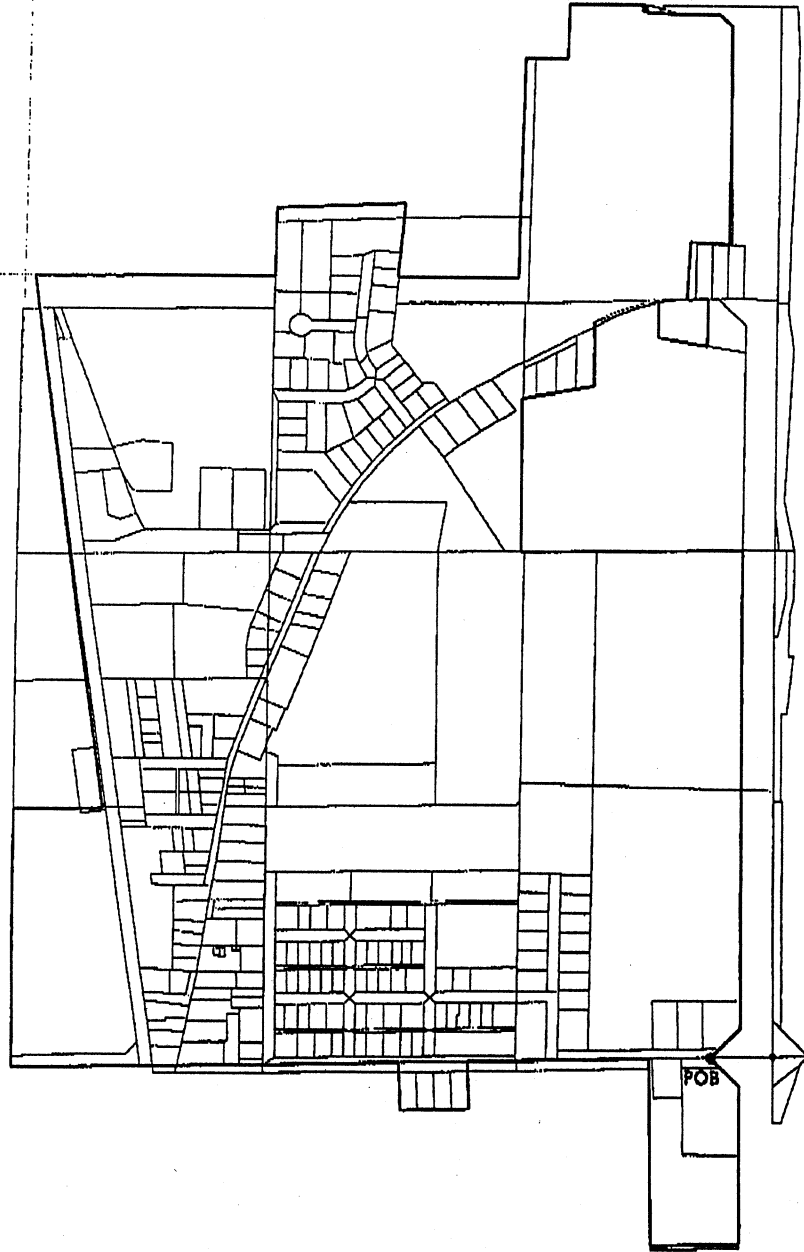

REVISED ON/PLOT DATE COOPERATIVE BOUNDARY SHEET 1 - DCS 46 8/2/06

STATE OF WISCONSIN
RECEIVED & FILED

DEC 12 2006

DOUGLAS LA FOLLETTE
SECRETARY OF STATE

ADELL COOPERATE BOUNDARY

06-0438-003



CRISPELL-SNYDER, INC.
PROFESSIONAL CONSULTANTS
1400 E. Sherman St. #200, Sheboygan, WI 53081-1400 Phone: (920) 861-1313 Fax: (920) 861-1314

LOCATION: VILLAGE OF ADELL

SHEBOYGAN COUNTY, WISCONSIN

SCALE: NTS

DATE: AUGUST 2006

DRAWN BY: MJG

VILLAGE of ADELL ZONING MAP - 82

2002 Dwyer











Detachment 1995

2002 Huber

2005

BIRENBAUM

STATE OF WISCONSIN
RECEIVED & FILED
DEC 12 2006
DOUGLAS LA FOLLETTE
SECRETARY OF STATE

-  R-1 Single Family
-  R-2 Single Family and 2 Family
-  R-3 Multiple Dwelling, Family and Apartment
-  B-1 Business and Professional Offices
-  B-2 General Business
-  B-3 Highway Business
-  L-1 Light Industrial
-  H-1 Heavy Industrial
-  AGR. Agricultural
-  Conservancy

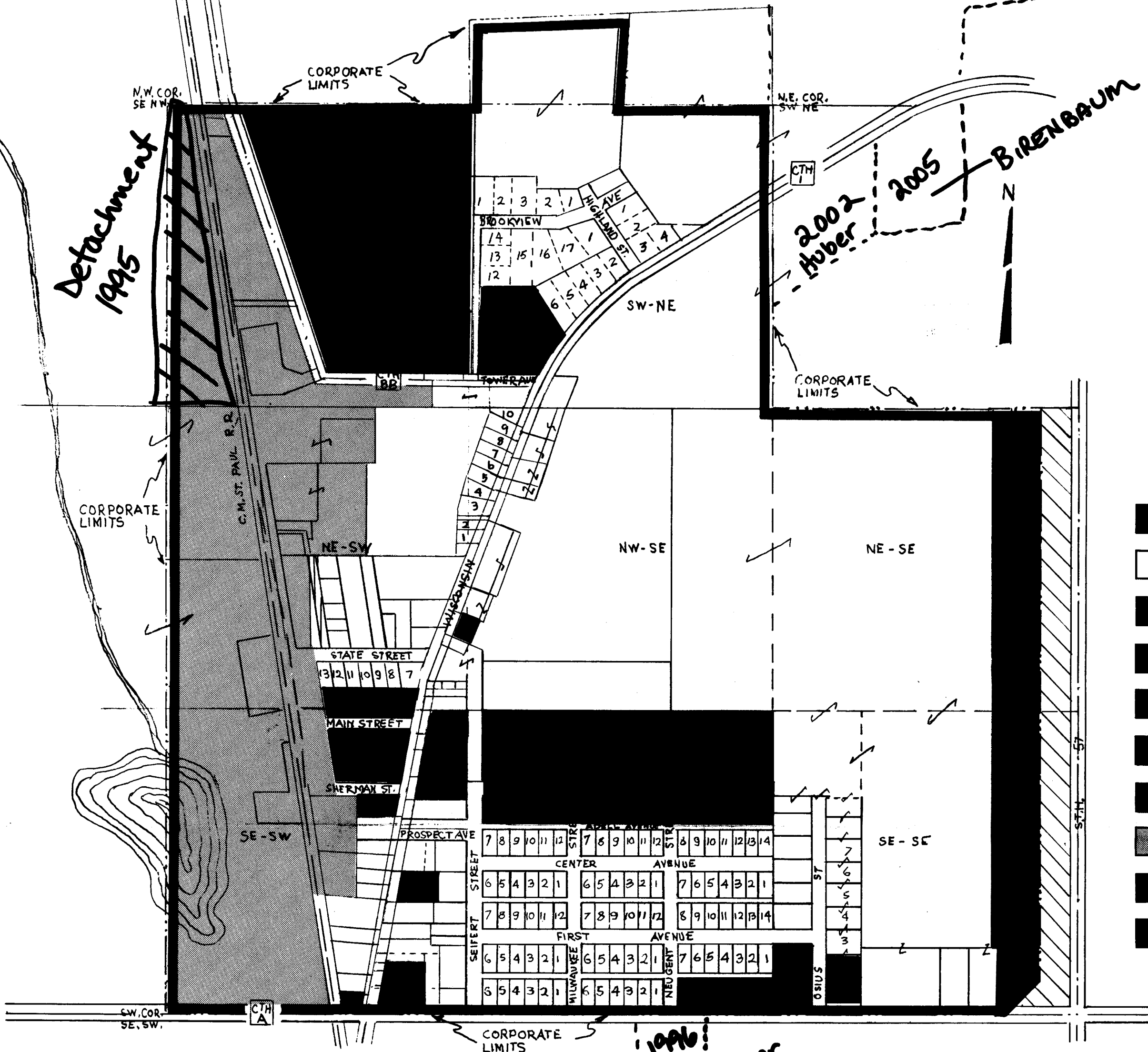

1996 Zillner