

The State of Wisconsin

Office of the Secretary of State

CITY 64

CITY OF FOND DU LAC

COUNTY OF FOND DU LAC

ANNEXATION ORDINANCE NUMBER 3299

FILED SEPTEMBER 18, 2006

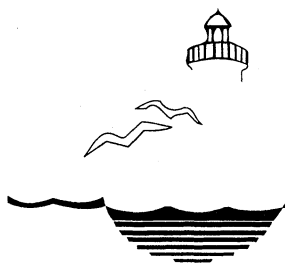

City of Fond du Lac

First on the Lake

C-64

City-County Government Center
160 S. Macy Street ~ P.O. Box 150 ~ Fond du Lac, WI 54936-0150

September 14, 2006

Secretary of State
Government Records Division
P.O. Box 7848
Madison, WI 53707-7848

Dear Sir or Madam:

Forwarded hereby, in accordance with s.66.0217 (9)(a), Wisconsin Statutes, is a certified copy of Ordinance No. 3299 annexing territory to the City of Fond du Lac from the Town of Fond du Lac, Wisconsin.

Sue L. Strands
City Clerk

cc County Treasurer
Alliant Eng. Div.
Clerk, Town of Fond du Lac
Tax Listings
FDL School District
Russ Raube, FDL County Planning
Charter Communication – Sheboygan
Community Development Director

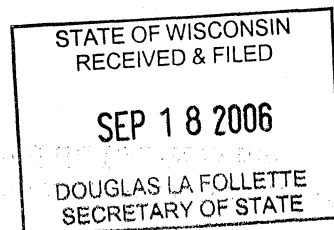

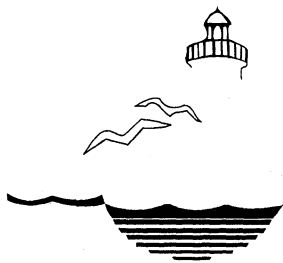

City of Fond du Lac

First on the Lake

City-County Government Center
160 S. Macy Street ~ P.O. Box 150 ~ Fond du Lac, WI 54936-0150

STATE OF WISCONSIN)
)
FOND DU LAC COUNTY)

I, Sue L. Strands, hereby certify that I am the duly appointed qualified City Clerk of the City of Fond du Lac, Wisconsin, a Municipal Corporation, and as such official, I am the legal custodian of all papers and records of said City. I further certify that I have compared the attached Ordinance No. 3299, An Ordinance Annexing Property to The City of Fond du Lac with the original in my possession and that the same is a true, correct and complete copy thereof.

I further certify that the petition for direct annexation reflects 2 (ESTIMATED) total residents of the area annexed.

IN WITNESS WHEREOF, I have hereunto set my hand and the seal of said City at the City of Fond du Lac, Wisconsin, this 14th day of September, 2006.

MBR number 12930

SUE L. STRANDS
CITY CLERK

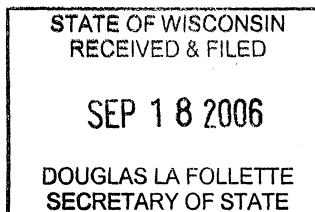
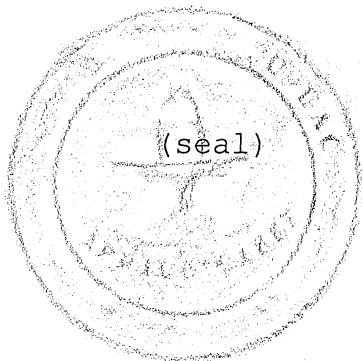



WISCONSIN DEPARTMENT OF
ADMINISTRATION

CC: WAYNE ROLLIN

JIM DOYLE
GOVERNOR

STEPHEN BABLITCH
SECRETARY

Division of Intergovernmental Relations
Municipal Boundary Review
101 E. Wilson Street, 10th Floor
Madison, WI 53702-0001
(608) 264-6102, Fax (608) 267-6917
<http://www.doa.wi.gov/>

September 13, 2006

DOA PETITION FILE NO. 12930

SUE STRANDS, CLERK
CITY OF FOND DU LAC
PO BOX 150
FOND DU LAC, WI 54936

PATTI S. SUPPLE, CLERK
TOWN OF FOND DU LAC
N5256 COUNTY RD V
FOND DU LAC, WI 54935

Subject: RMM INVESTMENTS ANNEXATION

The proposed annexation submitted to our office on August 21, 2006, has been reviewed and found to be in the public interest.

The subject petition is for territory that is reasonably shaped and contiguous to the City of FOND DU LAC.

This annexation petition is submitted pursuant to a City of Fond du Lac 1996 intergovernmental agreement with surrounding towns, including the Town of Fond du Lac. The City can immediately provide municipal sewer and water services.

The Department reminds clerks of annexing municipalities of the requirements of s. 66.0217 (9)(a), Wis. Stats., which states:

"The clerk of a city or village which has annexed shall file immediately with the secretary of state a certified copy of the ordinance, certificate and plat, and shall send one copy to each company that provides any utility service in the area that is annexed. The clerk shall record the ordinance with the register of deeds and file a signed copy of the ordinance with the clerk of any affected school district..."

State and federal aids based on population and equalized value may be significantly affected through failure to file with the Secretary of State. Please file a copy of your annexing ordinance, including a statement certifying the population of the annexed territory. **Please also include the MBR number with your ordinance as this assists with record keeping. Your MBR number is: 12930**

The address of the Office of the Secretary of State is:

Annexations and Railroads
Division of Government Records
Office of the Secretary of State
P.O. Box 7848
Madison, WI 53707-7848

Please call me at (608) 266-0683, should you have any questions concerning this annexation review letter. I am enclosing a copy of Act 317, as this legislation may affect the passage of any annexation ordinance.

Sincerely,

George Hall
Municipal Boundary Review

Cc: RMM Investments

STATE OF WISCONSIN
RECEIVED & FILED

SEP 18 2006

DOUGLAS LA FOLLETTE
SECRETARY OF STATE

RECEIVED BY CITY CLERK

9-14-06

ORDINANCE NO. 3299

AN ORDINANCE ANNEXING PROPERTY
TO THE CITY OF FOND DU LAC

The City Council of the City of
Fond du Lac do ordain as follows:

Section 1. Property Annexed. In accordance with Wisconsin Statutes Section 66.0217 and a Petition for Direct Annexation filed with the City Clerk's office, signed by all of the owners of the land in the area and assessed value in the territory proposed to be annexed, and all of the electors residing in said territory, the following described territory, which is contiguous to the City of Fond du Lac, Fond du Lac County, Wisconsin, is hereby annexed to the City of Fond du Lac:

See attached Exhibit B

Section 2. Effect of Annexation. From and after the date of adoption of this Ordinance, the property described in Section 1 hereof shall be part of the City of Fond du Lac for any and all purposes provided by law, and all persons coming or residing within such property shall be subject to all ordinances, rules and regulations governing the City of Fond du Lac.

Section 3. Ward Designation. The property described in Section 1 is hereby made a part of the 28th Ward of the City of Fond du Lac.

Section 4. Effective Date. This Ordinance shall take effect and be in force upon its passage as provided by law.

ADOPTED: SEP 13 2006

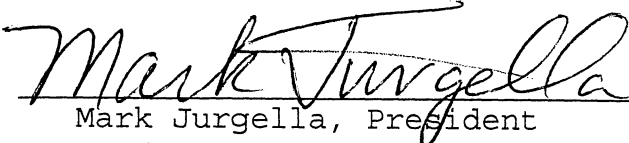
Mark Jurgella, President
Fond du Lac City Council

Attest:

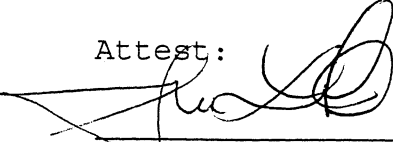
Sue L. Strands, City Clerk

City Attorney:

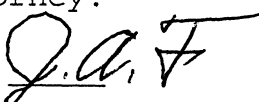
Reviewed 

STATE OF WISCONSIN
RECEIVED & FILED

SEP 18 2006

DOUGLAS LA FOLLETTE
SECRETARY OF STATE

EXHIBIT "A" ANNEXATION MAP

FOR LANDS LOCATED IN THE
S.W. 1/4 OF THE S.E. 1/4 OF SECTION 22
T.15 N. - R. 17 E. TOWN OF FOND DU LAC,
FOND DU LAC COUNTY, WISCONSIN



SCALE 1" = 100'

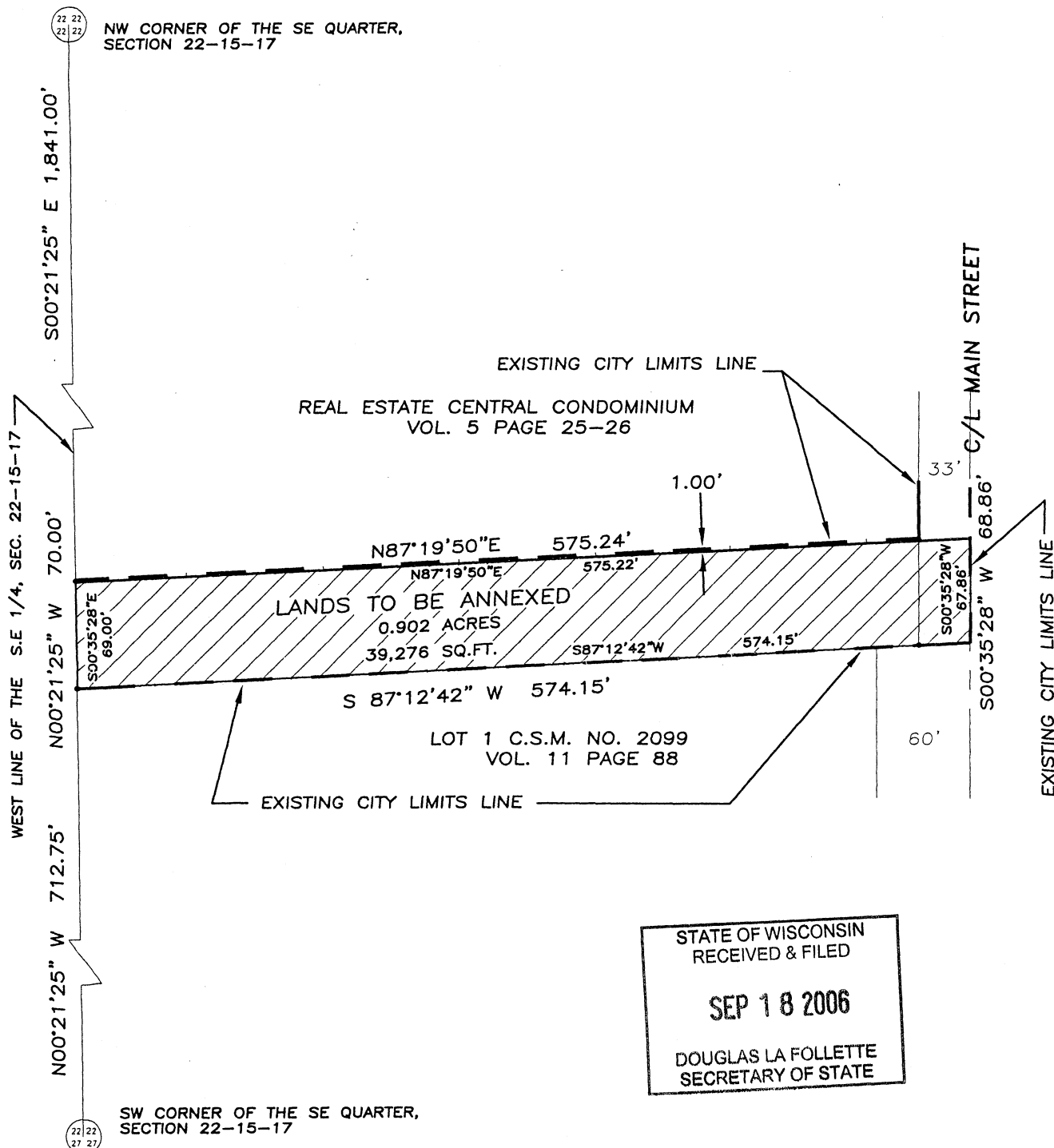

Description for Annexation

A part of the Southwest 1/4 of the Southeast 1/4 of Section 22, T.15N., R.17E., Town of Fond du Lac, Fond du Lac County, Wisconsin and being more particularly described as follows:

Commencing at the Southwest corner of the Southeast 1/4 of said Section 22; thence North 00°21'25" West along the West line of said Southeast 1/4, 712.75 feet to the Northwest corner of Lot 1, Certified Survey Map No. 2099, recorded in Volume 11, Page 88, Certified Survey Maps, Fond du Lac County Register of Deeds Office, also being the point of beginning; thence continuing North 00°21'25" West along the West line of said Southeast 1/4, 69.00 feet to a line 1.00 feet southerly of and parallel with the South line of the "Real Estate Central Condominium", recorded in Volume 5, Pages 25-26, Condominium Plats, said Register of Deeds Office; thence North 87°19'50" East along said parallel line and on its Easterly extension 575.22 feet to the centerline of South Main Street, also being an existing City Limits Line; thence South 00°35'28" West along said centerline, 67.86 feet to the easterly extension of the North line of said Lot 1, also being an existing City Limits Line; thence South 87°12'42" West along said North line and its Easterly extension, 574.15 feet to the point of beginning, and containing 0.902 acres (39,276 sq. ft.) of land more or less.

STATE OF WISCONSIN
RECEIVED & FILED

SEP 18 2006

DOUGLAS LA FOLLETTE
SECRETARY OF STATE

PETITION FOR DIRECT ANNEXATION

To: City Council
City of Fond du Lac, Wisconsin

We, the undersigned electors and/or landowners, pursuant to Chapter 66 of the Wisconsin Statutes, respectfully petition the City of Fond du Lac for direct annexation to the City of Fond du Lac of the following described territory which is presently in the Town of Fond du Lac, Fond du Lac County, Wisconsin.

Legal Description of Territory to be Annexed

See Exhibit "A"

A scale map of the territory to be annexed is attached hereto and marked Exhibit "A".

In support of this petition, the petitioners say to the City Council:

1. The total number of residents in the territory proposed to be annexed is 12.
2. Your petitioners constitute the owners of all of the land in area within such territory, and in assessed value.
3. There is 1 dwelling unit(s) on the property being annexed.
4. The area will be located in the 28 Ward of the City upon annexation.

We, the undersigned, elect that this annexation shall take affect to the full extent consistent with outstanding priorities of other annexations, incorporation or consolidation proceedings, if any.

We, the petitioners herein, do affirm that we have filed a copy of this petition with the Town Clerk of the town in which this territory is located, together with a scale map of such territory and that within five (5) days of the filing of this petition we will mail a copy of said scale map and description of such territory to be annexed to the State of Wisconsin Department of Administration.

We further respectfully request that the subject property be zoned B-4.

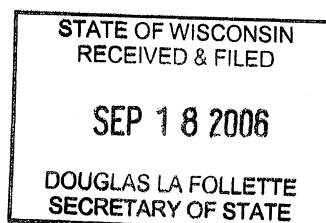

SIGNATURE

DATE

OWNER

ELECTOR

Melba Dorado
NAME

8 11 06

X

ADDRESS
N 5758 Hwy 175
Fond Du Lac WI 54935

NAME
Joan Kiesten
ADDRESS

N 5758 Hwy 175
FDL

8/11/06

X

NAME

ADDRESS

Dave Crouch / Rmm

8/11/06

X

NAME
294 E HARBOR VIEW
ADDRESS
FDL

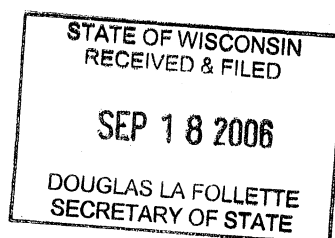

Vicinity Map

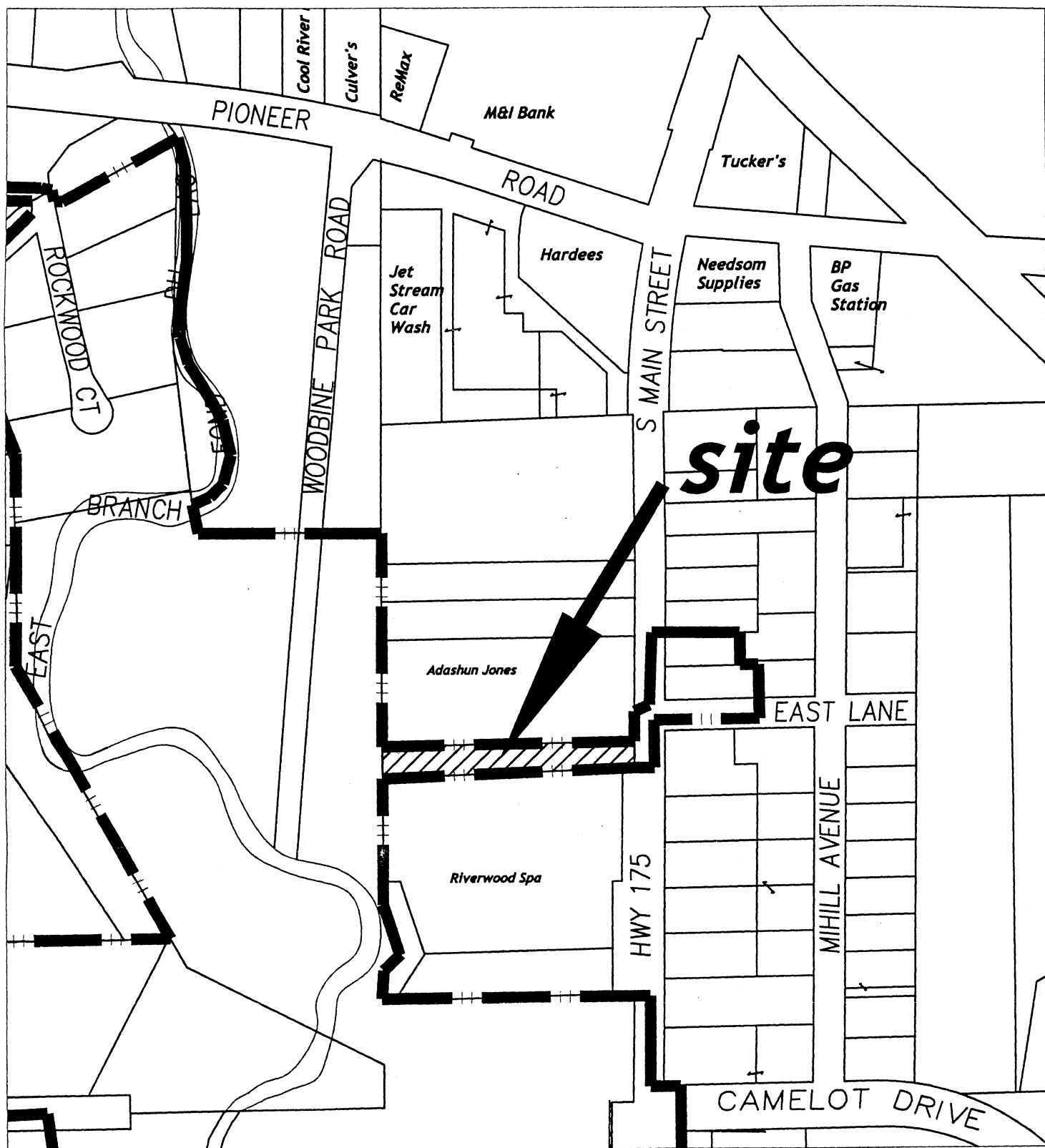

Annexation – RMM INVESTMENTS

STATE OF WISCONSIN
RECEIVED & FILED

SEP 18 2006

DOUGLAS LA FOLLETTE
SECRETARY OF STATE