

# The State of Wisconsin

Office of the Secretary of State

**C-66**

City of Appleton

County of Outagamie

Annexation Ordinance #171-08 and Plat Map

Filed November 25, 2008



"...meeting community needs...enhancing quality of life."

**OFFICE OF THE CITY CLERK**

100 North Appleton Street  
Appleton, WI 54911-4799  
920-832-6443 FAX: 920-832-5823

November 20, 2008

DOUGLAS LA FOLLETTE  
SECRETARY OF STATE

NOV 25 2008

STATE OF WISCONSIN  
RECEIVED & FILED

Annexations and Railroads  
Division of Government Records  
Office of the Secretary of State  
P. O. Box 7848  
Madison, WI 53707-7848

RE: Fieck Annexation  
Town of Grand Chute

Greetings:

Pursuant to the Wisconsin Statutes, here is one (1) copy of the Certificate of Annexation with plat map attached thereto and one (1) certified copy of the Ordinance #171-08 (MBR #13310), detaching a parcel of land from the Town of Grand Chute and annexing the same to the City of Appleton.

The Ordinance annexing this territory will be published in the Official Newspaper of the City of Appleton on November 24, 2008.

Very truly yours,

CYNTHIA I. HESSE, MMC/WCPC  
City Clerk

CH:mw

Enclosures (2)

CERTIFIED MAIL

# CERTIFICATION OF CLERK

I, CYNTHIA I. HESSE, the duly elected and qualified City Clerk of the City of Appleton, Wisconsin, DO HEREBY CERTIFY that the attached Ordinance is a true and compared copy of an ordinance adopted by the Mayor and Common Council of the City of Appleton, Outagamie/Calumet/Winnebago Counties, at a regular meeting held November 19, 2008.

Dated at Appleton, Wisconsin this 20<sup>th</sup> day of November, 2008.

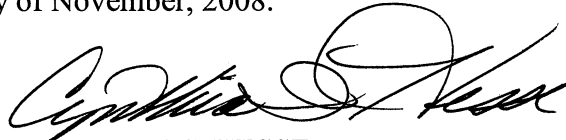

CYNTHIA I. HESSE  
CITY CLERK

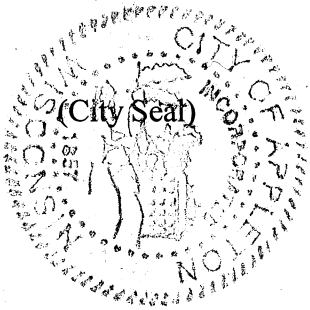

DOUGLAS LA FOLLETTE  
SECRETARY OF STATE

NOV 25 2008

STATE OF WISCONSIN  
RECEIVED & FILED

171 - 08

DOUGLAS LA FOLLETTE  
SECRETARY OF STATE

**AN ORDINANCE ANNEXING TERRITORY  
TO THE CITY OF APPLETON, WISCONSIN.  
(Fieck Annexation)**

NOV 25 2008

STATE OF WISCONSIN  
RECEIVED & FILED

The Common Council of the City of Appleton does ordain as follows:

**Section 1. Territory Annexed.** In accordance with §66.0217 of the Wisconsin Statutes for 2005 – 2006 and the *Unanimous Petition for Direct Annexation* filed with the City Clerk on September 16, 2008, the following described territory in the Town of Grand Chute, Outagamie County, Wisconsin, lying contiguous to the City of Appleton, is hereby annexed to the City of Appleton, Wisconsin:

*A parcel of land located in the Southeast ¼ of the Southeast ¼ of Section 2, Township 21 North, Range 17 East, Town of Grand Chute, Outagamie County, Wisconsin, containing 0.70 Acres of land m/l and being described as follows:*

*Commencing at the Southeast corner of said Section 2;  
Thence S.89°49'W. 473.00', along the South line of the SE ¼ of said Section 2 to the point of beginning;  
Thence continue S.89°49'W. 187.00', along the South line of the SE ¼ of said Section 2;  
Thence N.00°20'W. 214.00' parallel with the East line of the SE ¼ of said Section 2;  
Thence N.89°49'E. 187.00', parallel with the South line of the SE ¼ of said Section 2;  
Thence S.0°20'E. 214.00' to the point of beginning.  
Except all those lands described in a Warranty Deed recorded in J.13402, I.5, as document #1063387 and excepting all those lands previously dedicated for roadway purposes.*

*The above-described lands intended to be all of tax parcel 10-1-0102-02-0.*

*The current population of such territory is 2 people.*

**Section 2. Effect of Annexation.** From and after the date of this ordinance, the territory described in Section 1 shall be a part of the City of Appleton for any and all purposes provided by law and all persons coming or residing within such territory shall be subject to all ordinances, rules and regulations governing the City of Appleton.

**Section 3. Ward Designation.** The territory described in Section 1 of this ordinance is hereby made a part of the Thirty-first (31st) Ward, attached to the Thirteenth (13th) Aldermanic District of the City of Appleton, Outagamie County, subject to the ordinances, rules and regulations of the City governing wards.

**Section 4. Zoning Classification.** The territory described in Section 1 is hereby zoned as follows, pursuant to §66.0217(7)(a), Stats., and §23-65(e), Appleton Municipal Code:

R-1A (Single-Family District)

**Section 5. Severability.** If any provision of this ordinance is invalid or unconstitutional, or if the application of this ordinance to any person or circumstances is invalid or unconstitutional, such invalidity or unconstitutionality shall not affect the other provisions or applications of this ordinance, which can be given without the invalid or unconstitutional provision or application.

**Section 6. Effective Date.** This ordinance shall take effect upon passage and publication.

Dated: November 20, 2008

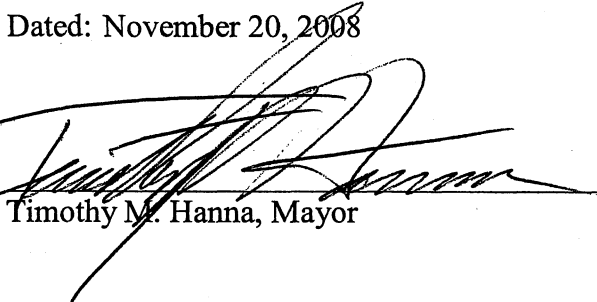

Timothy M. Hanna, Mayor



Cynthia I. Hesse, City Clerk

DOUGLAS LA FOLLETTE  
SECRETARY OF STATE

NOV 25 2008

STATE OF WISCONSIN  
RECEIVED & FILED

**CERTIFICATE OF ANNEXATION  
City of Appleton**DOUGLAS LA FOLLETTE  
SECRETARY OF STATE

NOV 25 2008

STATE OF WISCONSIN  
RECEIVED & FILED

I, CYNTHIA I. HESSE, the duly elected and qualified City Clerk of the City of Appleton, County of Outagamie, State of Wisconsin, DO HEREBY CERTIFY, that the following described territory was detached from the Town of Grand Chute and was annexed to said City of Appleton pursuant to 66.0217 of the Wisconsin Statutes of 2007, by an Ordinance adopted by the Common Council at a regular meeting held November 19, 2008

*A parcel of land located in the Southeast ¼ of the Southeast ¼ of Section 2, Township 21 North, Range 17 East, Town of Grand Chute, Outagamie County, Wisconsin, containing 0.70 Acres of land m/l and being described as follows:*

Record and return to:  
City of Appleton  
City Clerk's Office  
100 N. Appleton Street  
Appleton, WI 54911

*Commencing at the Southeast corner of said Section 2;  
Thence S.89°49'W. 473.00', along the South line of the SE ¼ of said Section 2 to the point of beginning;  
Thence continue S.89°49'W. 187.00', along the South line of the SE ¼ of said Section 2;  
Thence N.00°20'W. 214.00' parallel with the East line of the SE ¼ of said Section 2;  
Thence N.89°49'E. 187.00', parallel with the South line of the SE ¼ of said Section 2;  
Thence S.0°20'E. 214.00' to the point of beginning.  
Except all those lands described in a Warranty Deed recorded in J.13402, I.5, as document #1063387 and excepting all those lands previously dedicated for roadway purposes.*

*The above-described lands intended to be all of tax parcel 10-1-0102-02-0.*

*The current population of such territory is 2 people.*

November 20, 2008

  
CYNTHIA I. HESSE  
CITY CLERK



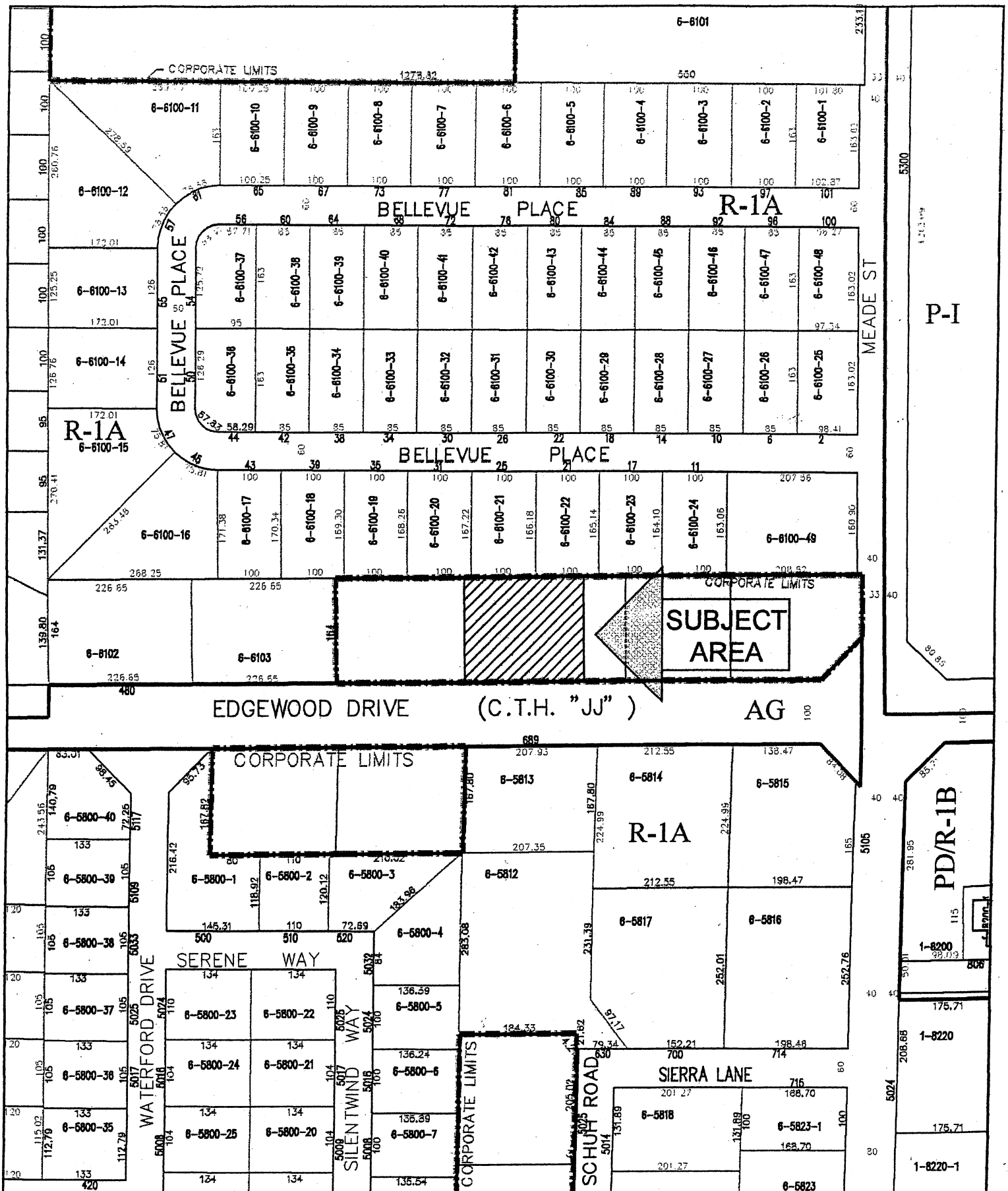

N  
W ← → E  
S  
1"=200'  
prepared by: [illegible]

**Fieck Annexation**  
**680 E. Edgewood Drive**  
**Zoning Map**

DOUGLAS A. FOLLETTE  
 SECRETARY OF STATE  
 City Plan Commission  
 Appleton, Wisconsin  
 NOV 25 2008  
 10-06-08  
 STATE OF WISCONSIN  
 RECEIVED & FILED