

# The State of Wisconsin

Office of the Secretary of State

**C-175**

City of Gillett

County of Oconto

Annexation Ord #21-2009 and Plat Map

Filed August 10, 2009

C-174

# CITY OF GILLETT

CHARTERED IN 1944

08/07/2009

Secretary of State  
Douglas LaFollette  
P O Box 7848  
Madison, WI 53707-7848

DOUGLAS LA FOLLETTE  
SECRETARY OF STATE

AUG 10 2009

STATE OF WISCONSIN  
RECEIVED & FILED

Re: annexation

Dear Sir:

At the City Council meeting last night, the enclosed Ordinance, annexing a railroad right of way, that the city owns, from the Town of Gillett into the City of Gillett, was passed.

At this time, there is no one living within this annexed territory.

I am enclosing 7 copies of the Ordinance, as well as copies of the area that is being annexed.

If you have any questions on this, please advise.

Yours truly,

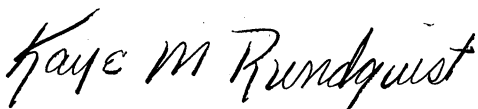

Kaye Rundquist  
City Clerk/Treasurer

encl

# CITY OF GILLETT

TIMOTHY J. SCHMID  
City Attorney

OFFICE OF THE CITY ATTORNEY  
208 West Green Bay Street  
SHAWANO, WISCONSIN 54166

TELEPHONE  
(715) 526-3191

ORDINANCE NO.:

21-2009

SPONSORED BY:

Planning Committee - Duke

INTRODUCED BY:

Mohr

SECONDED BY:

Smith

DOUGLAS LA FOLLETTE  
SECRETARY OF STATE

AUG 10 2009

STATE OF WISCONSIN  
RECEIVED & FILED

**THE COMMON COUNCIL OF THE CITY OF GILLETT, WISCONSIN, DO ORDAIN**  
that the Municipal Code of the City of Gillett is hereby amended to annex the following property as follows:

1. AUTHORITY. Pursuant to Section 66.0223, Stats., the Common Council may annex territory owned by and lying near but not necessarily contiguous to the City by Ordinance adopted by the Common Council of said City.

2. TERRITORY ANNEXED. The City of Gillett Common Council hereby annexes *A strip of land 100 feet in width extending over and across; the Southwest Quarter of the Northeast Quarter, and the Southeast Quarter, of Section 22; the Southwest Quarter of Section 23; the Northwest Quarter, and the Southwest Quarter of the Northeast Quarter, of Section 26, all in Township 28 North, Range 18 East of the Fourth Principal Meridian, said strip of land being 50 feet in width on each side of the center line of the main track (now removed) of the Manitowoc, Green Bay and North Western Railway Company (now the Chicago and North Western Transportation Company), as said main track center line was originally located and established over and across said Sections 22, 23, and 26.*

Also:

*A strip of land 100 feet in width extending over and across part of the Northwest Quarter of the Southeast Quarter of said Section 26, said strip of land being 50 feet in width on each side of said original main track center line, and lying Northerly of a line drawn radially to said center line at a point thereon distant 902 feet Southerly from the intersection thereof with the North line of the Southeast Quarter of said Section 26.*

The above described property is hereby annexed to the City of Gillett, Oconto County, Wisconsin.

3. ZONING CLASSIFICATION. The property shall be temporarily zoned FD Future Development District until permanent zoning can be established. The Planning Committee is hereby authorized and directed to recommend to the Council an amendment to the Gillett Zoning Map setting forth a permanent classification and regulations for the annexed area, after the Committee considers the most appropriate use consistent with the adopted Comprehensive Plan. Such recommendation for permanent zoning district classification shall be submitted to the Common Council within ninety (90) days after passage of the Annexation Ordinance.

4. WARD DESIGNATION. The territory described in this ordinance is hereby made a part of the 1, 4 Ward, 1st Aldermanic District of the City of Gillett.

5. DETACHMENT. The area which is hereby annexed is presently located in the Town of Gillett, Wisconsin and said territory shall be detached from said Town and shall be attached to the City of Gillett upon the City Clerk-Treasurer complying with Section 66.0223, Stats.

6. COMPLIANCE WITH SECTION 66.0217(14), STATS. The City has or agrees to pay the township from which the described property is being detached, the payment required under Section 66.0217(14), Stats.

7. EFFECT OF ANNEXATION. From and after the date of this ordinance, and upon the City Clerk filing seven (7) certified copies of this ordinance in the office of the Secretary of State, together with seven (7) copies of a plat showing the boundaries of the territory attached, the territory described herein shall be a part of the City of Gillett, Wisconsin, for any and all purposes provided by law and all persons coming or residing within such territory shall be subject to all ordinances, rules and regulations governing the City of Gillett.

This Ordinance shall take effect upon passage and publication provided by law.

CITY OF GILLETT

By:   
Thomas Lietz, Mayor

By:   
Kaye Rundquist, Clerk-Treasurer

Adopted: 08-06-2009  
Published: 08-12-2009

DOUGLAS LA FOLLETTE  
SECRETARY OF STATE

AUG 10 2009

STATE OF WISCONSIN  
RECEIVED & FILED

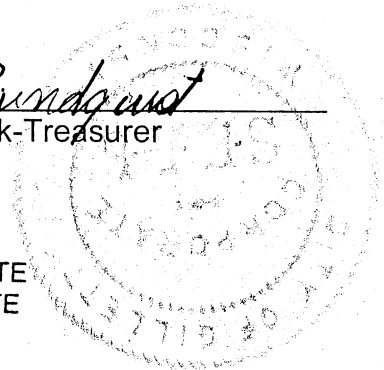

See MAPLE VALLEY Page 34

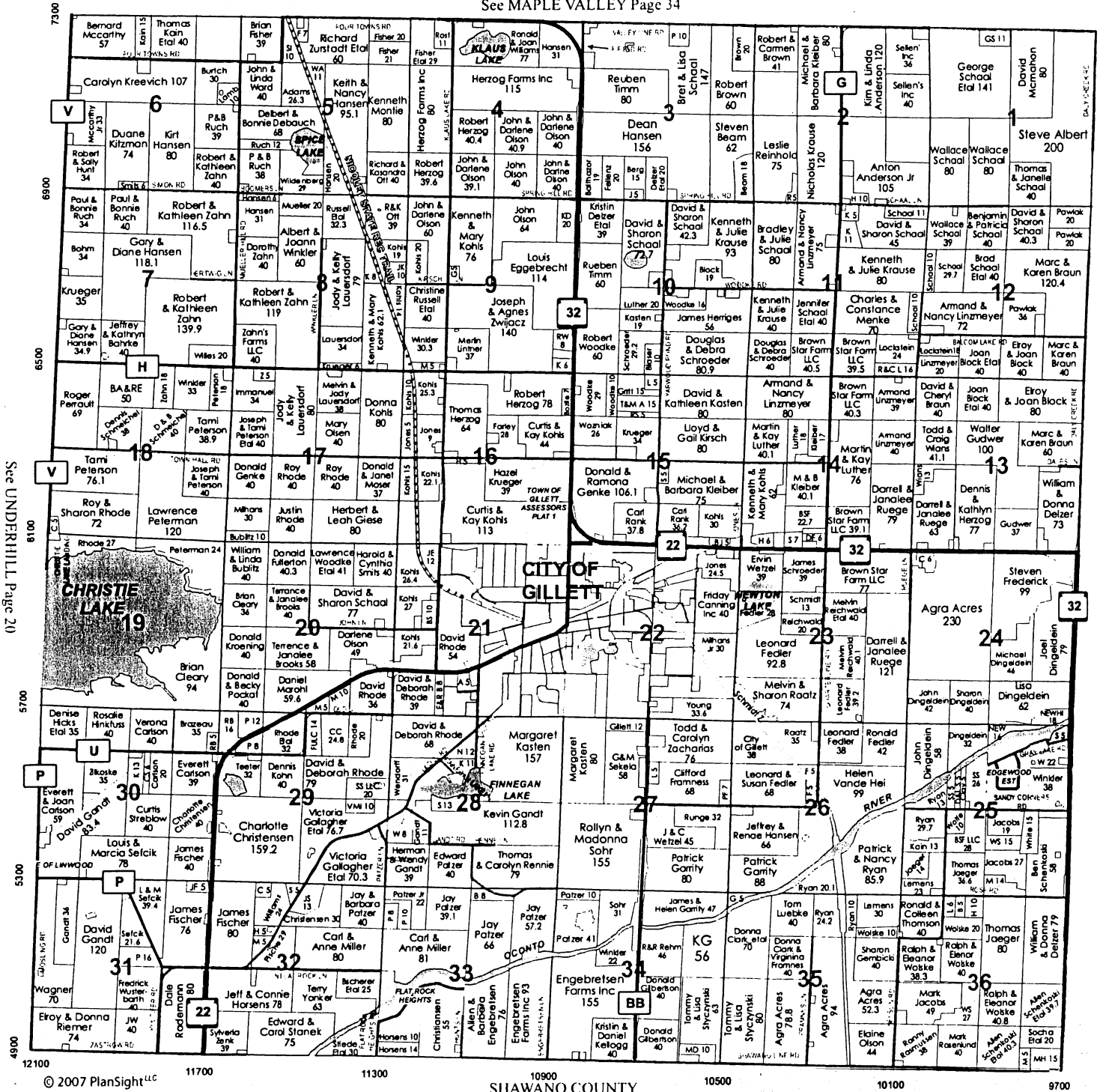

© 2007 PlanSight LLC

SHAWANO COUNTY

DOUGLAS LA FOLLETTE  
SECRETARY OF STATE

Cecil Office  
200 Golf View Road Suite 6  
Cecil, WI 54111  
715-745-2600

Community Bank Financial  
Community Financial Group

204 E. Main Street  
Gillett, WI 54124

AUG 10 2009  
STATE OF WISCONSIN  
RECEIVED & FILED

Little Suamico Office  
1288 E. Frontage Road  
Little Suamico, WI 54141  
920-826-6446

Mountain Lakewood Office  
14353 Hwy 32/64  
Mountain, WI 54149  
715-276-1820

Oconto Falls Office  
500 Cherry Avenue  
Oconto Falls, WI 54154  
920-846-2810



Member  
FDIC

See OCONTO FALLS Page 24

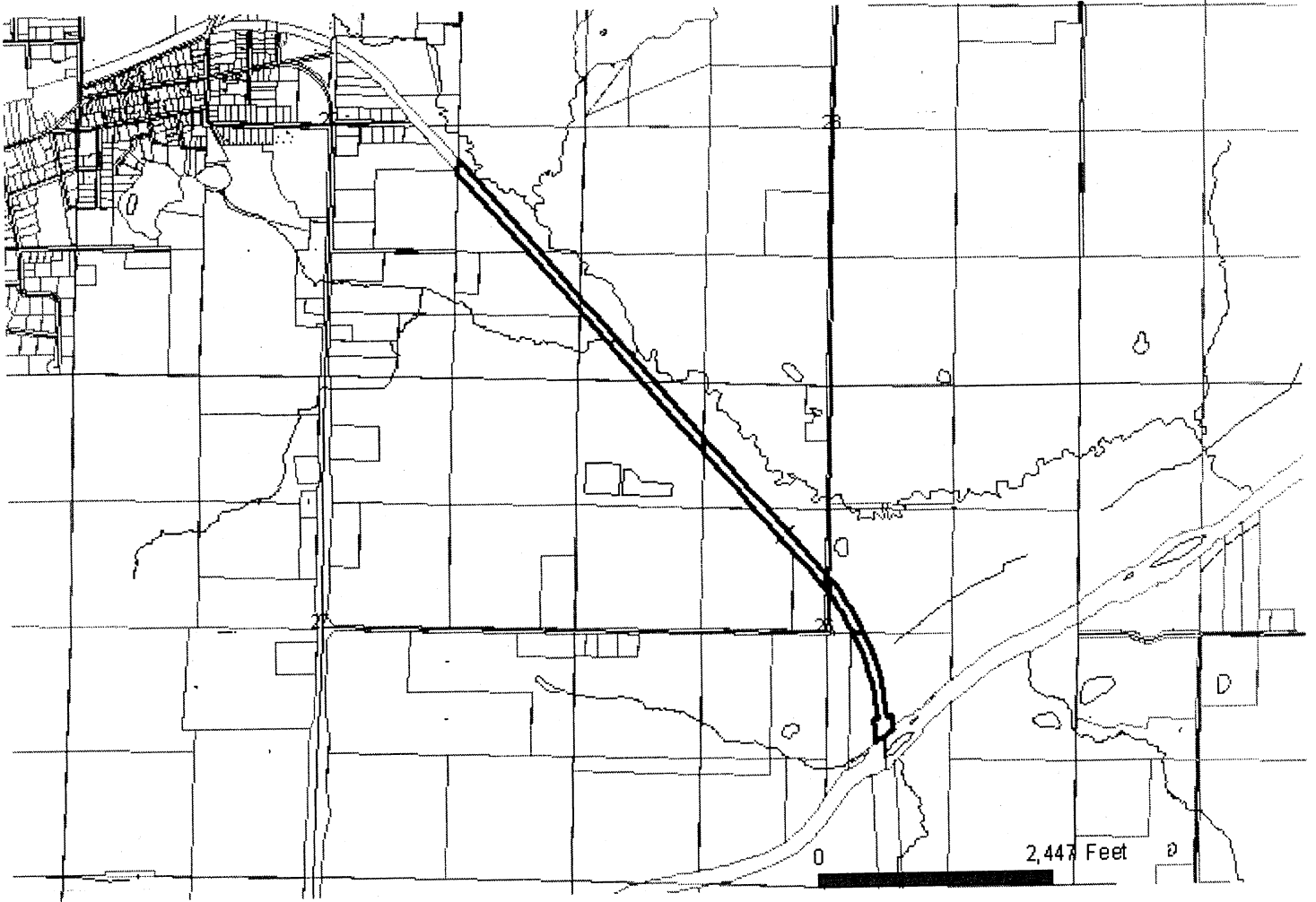

DOUGLAS LA FOLLETTE  
SECRETARY OF STATE

AUG 10 2009

STATE OF WISCONSIN  
RECEIVED & FILED