

The State of Wisconsin

Office of the Secretary of State

C-208

City of Pewaukee

County of Waukesha

Annexation Ord #06-10 and plat map

Filed June 26, 2006

Note: Corrections made to original preservation filing 43757 on 9/1/2009.

C-208

LAW OFFICES OF
ARENZ, MOLTER, MACY & RIFFLE, S.C.

720 N. EAST AVENUE
P.O. BOX 1348

WAUKESHA, WISCONSIN 53187-1348

DALE W. ARENZ
DONALD S. MOLTER, JR.
JOHN P. MACY,
COURT COMMISSIONER
H. STANLEY RIFFLE,
COURT COMMISSIONER

TELEPHONE 548-1340
FACSIMILE 548-9211
AREA CODE 262

RICK D. TRINDL
ERIC J. LARSON
JULIE A. AQUAVIA
DYAN E. BARBEAU
JOSEPH D. MELENDES

June 8, 2006

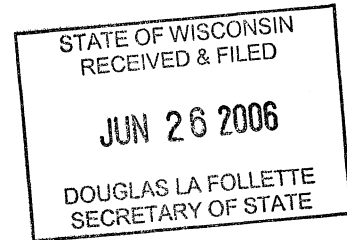

Mr. Douglas La Follette
Secretary of State
P.O. Box 7848
Madison, WI 53707-7848

Re: Annexation of Municipal Owned Land under §66.0223, Wis. Stats.
City of Pewaukee

Dear Mr. La Follette:

This law firm represents the City of Pewaukee. Pursuant to statute, §66.0223(1), Stats., please find enclosed 7 certified copies of the City's annexation ordinance with the copies of the plat attached. According to the statute, the territory is attached to the City upon filing the ordinance with your office, therefore, I would appreciate it if you could indicate on the 8th copy that date and time and return the same to our office in the envelope provided.

Thank you for your attention to this matter.

Very truly yours,

ARENZ, MOLTER, MACY & RIFFLE, S.C.,

H. Stanley Riffle

HSR/asc

cc: Ms. Kelly DeMotto, Clerk
Ms. Tammy LaBorde, City Administrator
Mr. Scott Klein, Mayor
Ms. Jane Carlson, Town of Brookfield Clerk
Attorney James Hammes



Office of the Clerk/Treasurer

W240N3065 Pewaukee Road
Pewaukee, WI 53072
(262) 691-0770 Fax: 691-1798

I, Kelly DeMotto, Clerk/Treasurer for the City of Pewaukee do hereby certify that the attached reproductions of Ordinance 06-10 are true and correct copies that were approved by the Common Council on the 17th day of April 2006. The population for the territory annexed is zero (0).

Kelly DeMotto
Clerk/Treasurer
June 23rd, 2006

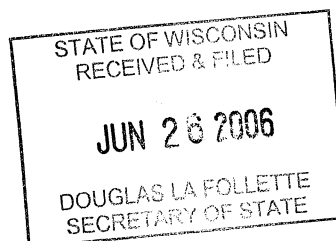

ORDINANCE NO. 06-10**AN ORDINANCE ANNEXING LAND OWNED BY THE CITY OF PEWAUKEE**

WHEREAS, the City of Pewaukee has purchased land in the Town of Brookfield for the purpose of building a fire station; and,

WHEREAS, the City wishes to annex that property into the City in order to proceed with the proper zoning and planning necessary to enable it to construct a fire station.

NOW THEREFORE, the Common Council of the City of Pewaukee hereby enacts the following ordinance:

SECTION 1:

Pursuant to §66.0223, Wis. Stats., the City of Pewaukee annexes from the Town of Brookfield, the parcel commonly known as the Gumina parcel more fully described as: Lot 2 of CSM 10,132 recorded on December 15, 2005, Volume 95 of Certified Survey Maps on pages 191 to 194 as Document No. 3346475 being a division of part of the Northwest 1/4 and the Southwest 1/4 of the Northwest 1/4 of section 7, Town 7 North, Range 21 East, in the Town of Brookfield, County of Waukesha, State of Wisconsin.

SECTION 2:

This annexation ordinance is accompanied by a plat of the parcel attached hereto as Exhibit A. Seven certified copies of this ordinance and the plat must be sent to the Wisconsin Secretary of State and one copy each to the Waukesha County Clerk and the Town of Brookfield Clerk.

SECTION 3: Severability.

The several sections of this ordinance are declared to be severable. If any section or portion thereof shall be declared by a court of competent jurisdiction to be invalid, unlawful or unenforceable, such decision shall apply only to the specific section or portion thereof directly specified in the decision, and shall not affect the validity of any other provisions, sections or portions thereof of the ordinance. The remainder of the ordinance shall remain in full force and effect. Any other ordinance whose terms are in conflict with the provisions of this ordinance are hereby repealed as to those terms that conflict.

SECTION 4: Effective Date.

This ordinance shall be effective upon the filing of the required copies with the Secretary of State, pursuant to §66.0223, Wis. Stats.

Dated this 17th day of April 2006.

ATTEST:

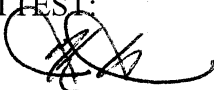

Kelly DeMotto, City Clerk

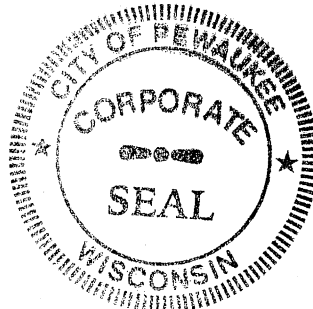

CITY OF PEWAUKEE

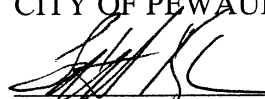
Scott Klein, Mayor

STATE OF WISCONSIN
RECEIVED & FILED

JUN 26 2006

DOUGLAS LA FOLLETT
SECRETARY OF STATE



UC3346475-004

3346475

CERTIFIED SURVEY MAP NO. 10,132

A division of part of the Northwest 1/4 and the Southwest 1/4 of the Northwest 1/4 of Section 7, Town 7 North, Range 20 East in the Town of Brookfield, Waukesha County, Wisconsin.

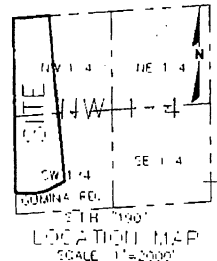

NOTES

- 1" IRON PIPE FOUND
- 1.315 (OUTSIDE DIAMETER) 1/8" IRON PIPES SET WT. 1.68 LBS. PER LINEAL FOOT
- ALL DIMENSIONS ARE SHOWN TO THE NEAREST HUNDREDTH OF A FOOT
- ALL BEARINGS SHOWN REFERENCE TO THE WEST LINE OF THE NORTHWEST 1/4 OF SECTION 7-20, WHICH IS ASSUMED TO BEAR N01°14'05"W



STATE OF WISCONSIN
RECEIVED & FILED

JUN 26 2006

DOUGLAS LA FOLLETTE
SECRETARY OF STATE

**National
Survey &
Engineering**

A Division of R.A. Smith & Associates, Inc.



262-781-1000
Fax 262-797-7373
16745 W. Bluemound Road
Suite 200
Brookfield, WI 53005-5938
www.nsae.com

S: 5162672.dwg
CS10112H.dwg CS10112H
SHEET 1 OF 4 SHEETS

191

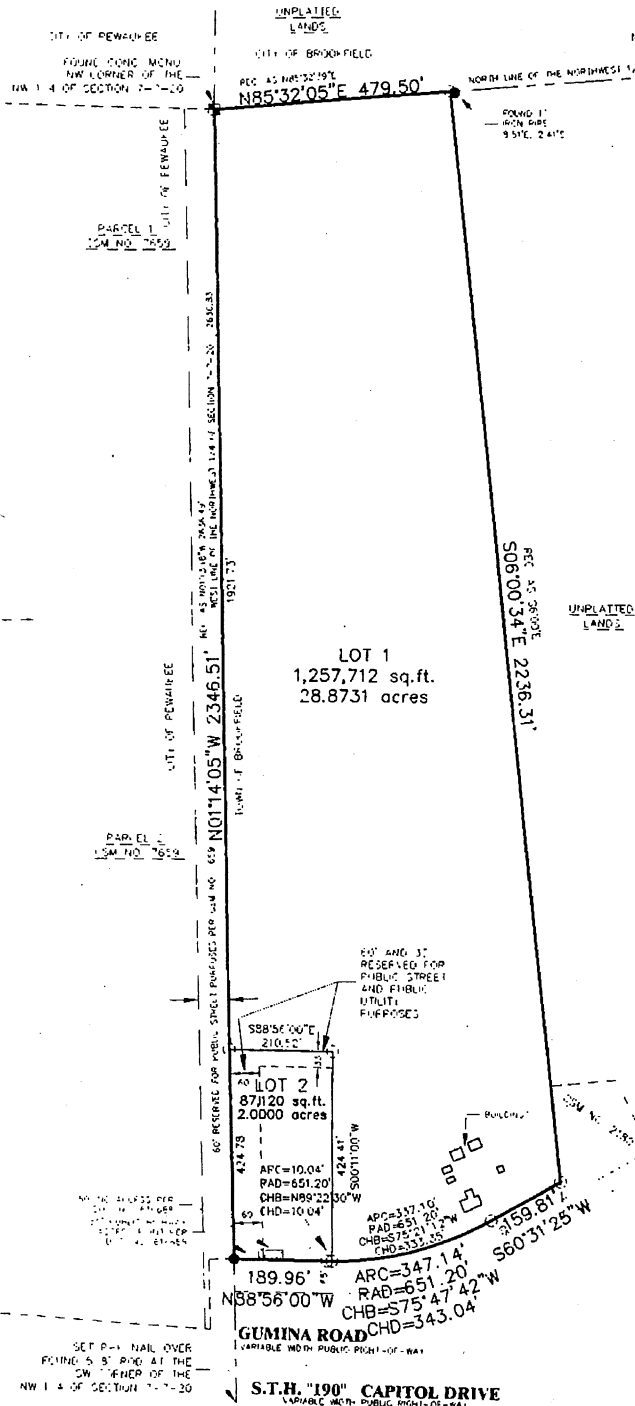

GRAPHIC SCALE

150 0 75 150 300 600

(IN FEET)
1 inch = 300 ft.

CERTIFIED SURVEY MAP NO. 10132

A division of part of the Northwest 1/4 and the Southwest 1/4 of the Northwest 1/4 of Section 7, Town 7 North, Range 20 East, Town of Brookfield, Waukesha County, Wisconsin.

SURVEYOR'S CERTIFICATE

STATE OF WISCONSIN }
 :SS
WAUKESHA COUNTY }

I, PAUL A. KUBICEK, registered land surveyor, do hereby certify:

THAT I have surveyed, divided and mapped a division of part of the Northwest 1/4 and the Southwest 1/4 of the Northwest 1/4 of Section 7, Town 7 North, Range 20 East, Town of Brookfield, Waukesha County, Wisconsin, bounded and described as follows:

BEGINNING at the Northwest corner of the Northwest 1/4 of Section 7; thence North 85°32'05" East along the North line of said Northwest 1/4 Section 479.50 feet to a point; thence South 06°00'34" East 2236.31 feet to a point on the North line of Gumina Road; thence South 60°31'25" West along said North line 159.81 feet to a point; thence Southwesterly 347.14 feet along said North line and the arc of a curve whose center lies to the North, whose radius is 651.20 feet and whose chord bears South 75°47'42" West 343.04 feet to a point; thence North 88°56'00" West along said North line 189.96 feet to a point on the West line of said Northwest 1/4 Section; thence North 01°14'05" West along said West line 2346.51 feet the point of beginning.

Containing 1,344,832 square feet or 30.8731 acres.

THAT I have made this survey, land division and map by the direction of PETER J. GUMINA, owner of said land.

THAT such map is a correct representation of all the exterior boundaries of the land surveyed and the land division thereof made.

THAT I have fully complied with the provisions of Chapter 236 of the Wisconsin Statutes and the Land Division and Platting Regulations of the Town of Brookfield in surveying, dividing and mapping the same.

October 7, 2005
DATE

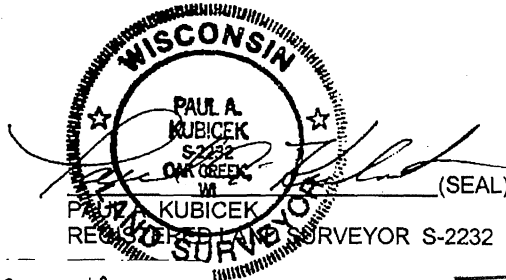

VOL 95 PAGES 191-194
3346475

REGISTER'S OFFICE
WAUKESHA COUNTY, WI
RECORDED ON

12-15-2005 2:51 PM

MICHAEL J. HASSLINGER
REGISTER OF DEEDS

REC. FEE: 10.00
REC. FEE-CO: 5.00
REC. FEE-ST: 2.00
TRAN. FEE:
TRAN. FEE-STATE:
PAGES: 4

Sheet 2 of 4 Sheets

STATE OF WISCONSIN
RECEIVED & FILED

JUN 26 2006

DOUGLAS LA FOLLETTE
SECRETARY OF STATE

194

CERTIFIED SURVEY MAP NO. 10.132

A division of part of the Northwest 1/4 and the Southwest 1/4 of the Northwest 1/4 of Section 7,
Town 7 North, Range 20 East, Town of Brookfield, Waukesha County, Wisconsin.

OWNER'S CERTIFICATE

PETER J. GUMINA, as owner, certifies that he caused the land described on this map to
be surveyed, divided and mapped as represented on this map in accordance with the regulations
of the Town of Brookfield.

PETER J. GUMINA, does further certify that this map is required by S.236.10 or 236.12 to
be submitted to the following for approval or objection:

Town of Brookfield and Waukesha County Department of Parks and Land Use

WITNESS THE HAND AND SEAL of PETER J. GUMINA, this 5th day of December, 2005.

Peter J. Gumina
PETER J. GUMINA

STATE OF WISCONSIN }
Waukesha COUNTY } :SS



PERSONALLY came before me this 5th day of December, 2005.
PETER J. GUMINA, to me known to be the person who executed the foregoing instrument and
acknowledged that he executed the foregoing instrument.

[Signature] (SEAL)
Notary Public, State of _____
My commission expires _____
My commission is permanent.

STATE OF WISCONSIN
RECEIVED & FILED

JUN 26 2006

DOUGLAS LA FOLLETTE
SECRETARY OF STATE

COUNTY PLANNING AFFECTED

The above, which has been filed for approval and approval by Chapter 236 of the Wisconsin
Statutes, is hereby approved and _____ day of _____, 2006.

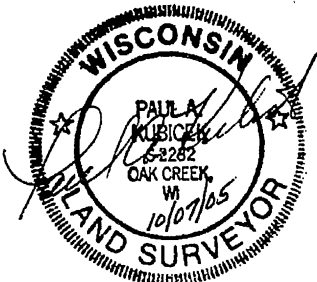

PAUL A. SHAVER, DIRECTOR

197

CERTIFIED SURVEY MAP NO. 10.130

A division of part of the Northwest 1/4 and the Southwest 1/4 of the Northwest 1/4 of Section 7, Town 7 North, Range 20 East, Town of Brookfield, Waukesha County, Wisconsin.

TOWN BOARD APPROVAL

APPROVED and accepted by the Town Board of the Town of Brookfield this 6th day of December, 2005.

CHAIRMAN/Supervisor Robert W. Flessas

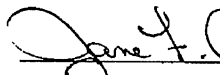
Jane F Carlson
TOWN CLERK



TOWN PLANNING COMMISSION APPROVAL

APPROVED and accepted by the Town Planning Commission of the Town of Brookfield this 22 day of November, 2005.

CHAIRMAN/Supervisor Robert W Flessas

TOWN CLERK Jane F Carlson

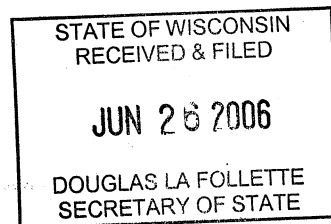
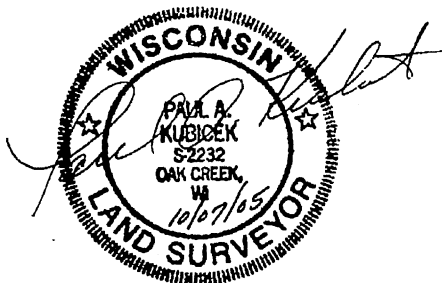

10/14