

# The State of Wisconsin

## Office of the Secretary of State

V321

VILLAGE OF ROCKLAND

LA CROSSE AND MONROE COUNTIES

ANNEXATION ORDINANCE 15.5

FILED DECEMBER 16, 2013

✓ 321

## Village of Rockland

PO Box 124

Rockland, WI 54653

Phone: 608-486-4037

FAX: 608-486-4078

Email: villageofrockland@charter.net

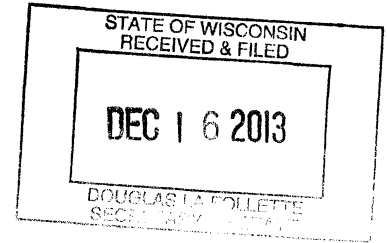

August 8, 2013

State of Wisconsin  
La Crosse County  
Village of Rockland

I, Sue Donskey, hereby certify that I am the duly appointed qualified Village Clerk of the Village of Rockland, La Crosse County, a Municipal Corporation, and as such official, I am the legal custodian of all papers and records of said Village. I further certify that I have compared the attached Ordinance No. 15.5, an Ordinance annexing property to the Village of Rockland with the original in my possession and that the same is a true and correct copy thereof.

This property was previously located in the Town of Sparta, Monroe County, Wisconsin. I have also attached the resolution from the Town of Sparta authorizing the annexation and the accompanying maps.

I further certify that the petition for direct annexation reflects zero (0) total residents in the area annexed.

**IN WITNESS WHEREOF**, I have hereunto set my hand and the seal of said Village of Rockland, in Rockland, La Crosse County, Wisconsin this 8th day of August, 2013.

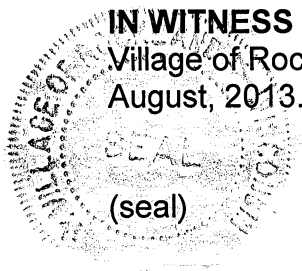

(seal)

Sue Donskey  
Rockland Village Clerk

VILLAGE OF ROCKLAND

ORDINANCE NO.: 15.5

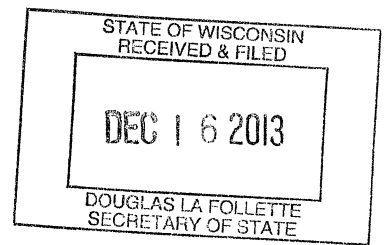

AN ORDINANCE to annex a parcel of land from the Town of Sparta, Monroe County, Wisconsin to the Village of Rockland, Wisconsin.

THE VILLAGE BOARD of The Village of Rockland, La Crosse County, Wisconsin, does ordain as follows:

SECTION I. A proper petition having been presented to the Village Board of the Village of Rockland praying annexation of the following territory, to-wit:

A parcel of land located in part of the SW1/4-NW1/4, Section 31, Township 17 North, Range 4 West, Town of Sparta, Monroe County, Wisconsin:

Commencing at the northwest corner of Section 31, Township 17 North, Range 4 West; thence S00°06'20"E along the west line of the Fractional NW1/4-NW1/4 of Section 31, 1149.63 feet to the Point of Beginning;

Thence N89°33'56"E 1315.04 feet to the East line of the Fractional W1/2 of the NW1/4;

Thence S00°16'27" E along the East line of the Fractional W1/2 of the NW1/4 662.01 feet to the Northeast corner of Lot 1 of Certified Survey Map (CSM) Volume 11, Page 70 as Document No. 454166;

Thence continuing South along the East line of said Lot 1 of CSM Volume 11, Page 70, to a point of intersection with the north line of a railroad right of way on the southeasterly side of Lot 1 of 11 CSM 70;

Thence southwesterly along said northern railroad right of way line to a point of intersection with the south line of the Fractional W1/2 of the NW1/4, also being the south line of said Lot 1 of CSM Volume 11, Page 70;

Thence west along said south line to the Southwest corner of said Lot 1 of CSM Volume 11, Page 70 to the Southeast corner of Lot 1 of Certified Survey Map Volume 9, Page 99 as Document No. 427218;

Thence West along the south line of CSM Volume 9, Page 99 to the southwest corner of said CSM, point being on the west line of the Fractional W1/2 of the NW1/4;

Thence north along the west line of said CSM Volume 9, Page 99 and west line of the Fractional W1/2 of the NW1/4 to the northwest corner of CSM;

Thence continuing N00°06'20"W along the west line of the Fractional W1/2 of the NW1/4 662.01 feet to the point of beginning.

SECTION II: Payment to the Town of Sparta. Pursuant to Wisconsin Statute §66.0217(14), the Village Board agrees to pay to the Town of Sparta, Monroe County, Wisconsin, annually for five years an amount equal to the amount of property taxes that the Town levied on the annexed territory, as shown by the tax roll under Wisconsin Statute §70.65 in 2013 (the year in which the annexation is final).

SECTION III: EFFECTIVE DATE: This Ordinance shall take effect upon its enactment.

  
\_\_\_\_\_  
Ole Mathison, Acting Village President

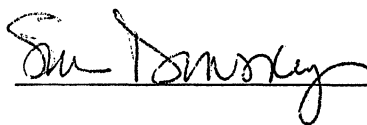
  
\_\_\_\_\_  
Sue Donskey, Village Clerk

Passed: 8/6/13

Approved: 8/6/13

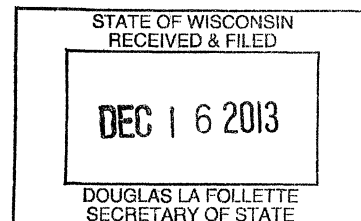

638500

**Town of Sparta  
Resolution #7-16-13**

Document Number

Document Name

**WHEREAS**, Rockland Flooring is a business that is currently located in the Town of Sparta, Monroe County, Wisconsin; and,  
**WHEREAS**, Rockland Flooring has a large volume of heavy truck traffic traveling to and from its business on a daily basis; and,  
**WHEREAS**, Rockland Flooring's heavy truck traffic travels on Rock Street, located in the Village of Rockland, La Crosse County, Wisconsin; and,  
**WHEREAS**, the Village of Rockland recently became aware that said Rock Street is a Village Street and not a County Highway as previously thought, thereby leaving all of the maintenance and repair of the road solely within the budget of the Village of Rockland; and,  
**WHEREAS**, La Crosse County discovered the true ownership of said road while researching funding for the repair and rebuilding of said Street; and,

**WHEREAS**, the trucks traveling to and from Rockland Flooring are a major contributor to the need for the rebuilding and increased cost of maintenance of said Rock Street; and,

**WHEREAS**, this annexation will also allow for providing for fire protection by Bangor Burns Rockland Fire Department and other applicable Village services as needed; and,

**WHEREAS**, Rockland Flooring, by and through its owner, Chorney Holdings, LLP, has requested approval from the Town Board of the Town of Sparta, to have its real properties located in said Town to be annexed into the Village of Rockland, La Crosse County, because the Village of Rockland incurs the cost of the damage to the roads and needs the tax revenue from Rockland Flooring to help offset this substantial and continuous expense; and,

**WHEREAS**, such annexation would preserve the amount of Property Tax Revenue that the Town of Sparta would receive for the next five years pursuant to §66.0217(14), Wisconsin Statutes; and,

**WHEREAS**, Wisconsin Statute Section 66.0217(2), provides for direct annexation upon petition of all of the electors residing in the territory to be annexed and the owners of all of the real property on the territory to be annexed; and,

**WHEREAS**, there are no electors residing in the lands described on Exhibit A and depicted on Exhibit B, and Chorney Holdings, LLP is the sole owner of said property;

**NOW THEREFORE BE IT RESOLVED**, by the Town Board, of the Town of Sparta, Monroe County, Wisconsin, that it hereby approves of the proposed annexation of the real property owned by Chorney Holdings, LP, dba Rockland Flooring LLC to the Village of Rockland, La Crosse County, Wisconsin with respect to the real property described on Exhibit A as Monroe County Tax Parcel Nos. 040-01015-3000, 040-01015-0000, 040-01015-5000, and 040-01014-2000, shown on Exhibit B attached hereto.

ADOPTED THIS 6<sup>TH</sup> DAY OF JULY, 2013

**REGISTER'S OFFICE  
County of Monroe, WI**

Received for record this 21  
 day of June A.D., 2013  
 at 2:50 o'clock P.M.  
Rob Mahat Register

000101

Recording Area

Name and Return Address

Sue Donskey  
 711 Cardinal Ave  
 Rockland, WI 54653  
 30/17

STATE OF WISCONSIN  
RECEIVED & FILED

DEC 16 2013

DOUGLAS LA FOLLETTE  
SECRETARY OF STATE

Howard Garves

\* Town of Sparta Chair, Howard Garves  
 HOWARD

Sue Justin

\* Attest: Town of Sparta Clerk, Sue Justin

(SEAL)

**ACKNOWLEDGMENT**

STATE OF WISCONSIN

Monroe

COUNTY

Personally came before me on 11-7-13  
 the above-named Howard Garves  
Sue Justin

to me known to be the person(s) who executed the foregoing  
 instrument and acknowledged the same.

Mary L. McClintock  
 \* Mary L. McClintock

Notary Public, State of Wisconsin

My Commission (is permanent) (expires: 6/20/17)

THIS INSTRUMENT DRAFTED BY:

Sue Donskey

Exhibit A

Annexation for the Village of Rockland, La Crosse County, Wisconsin  
Part of the Town of Sparta - Monroe County, WI

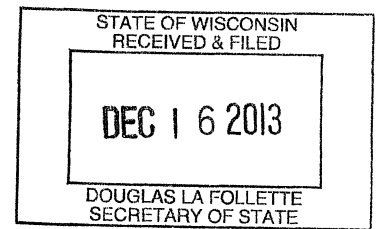

A parcel of land located in part of the SW1/4-NW1/4, Section 31, Township 17 North, Range 4 West, Town of Sparta, Monroe County, Wisconsin:

Commencing at the northwest corner of Section 31, Township 17 North, Range 4 West; thence S00°06'20"E along the west line of the Fractional NW1/4-NW1/4 of Section 31, 1149.63 feet to the Point of Beginning:

Thence N89°33'56"E 1315.04 feet to the East line of the Fractional W1/2 of the NW1/4;

Thence S00°16'27"E along the East line of the Fractional W1/2 of the NW1/4 662.01 feet to the Northeast corner of Lot 1 of Certified Survey Map (CSM) Volume 11, Page 70 as Document No. 454166;

Thence continuing South along the East line of said Lot 1 of CSM Volume 11, Page 70, to a point of intersection with the north line of a railroad right of way on the southeasterly side of Lot 1 of 11 CSM 70;

Thence southwesterly along said northern railroad right of way line to a point of intersection with the south line of the Fractional W1/2 of the NW1/4, also being the south line of said Lot 1 of CSM Volume 11, Page 70;

Thence west along said south line to the Southwest corner of said Lot 1 of CSM Volume 11, Page 70 to the Southeast corner of Lot 1 of Certified Survey Map Volume 9, Page 99 as Document No. 427218;

Thence West along the south line of CSM Volume 9, Page 99 to the southwest corner of said CSM, point being on the west line of the Fractional W1/2 of the NW1/4;

Thence north along the west line of said CSM Volume 9, Page 99 and west line of the Fractional W1/2 of the NW1/4 to the northwest corner of CSM;

Thence continuing N00°06'20"W along the west line of the Fractional W1/2 of the NW1/4 662.01 feet to the point of beginning.

Village of Rockland, Wisconsin  
Annexation Map - April 10th, 2013

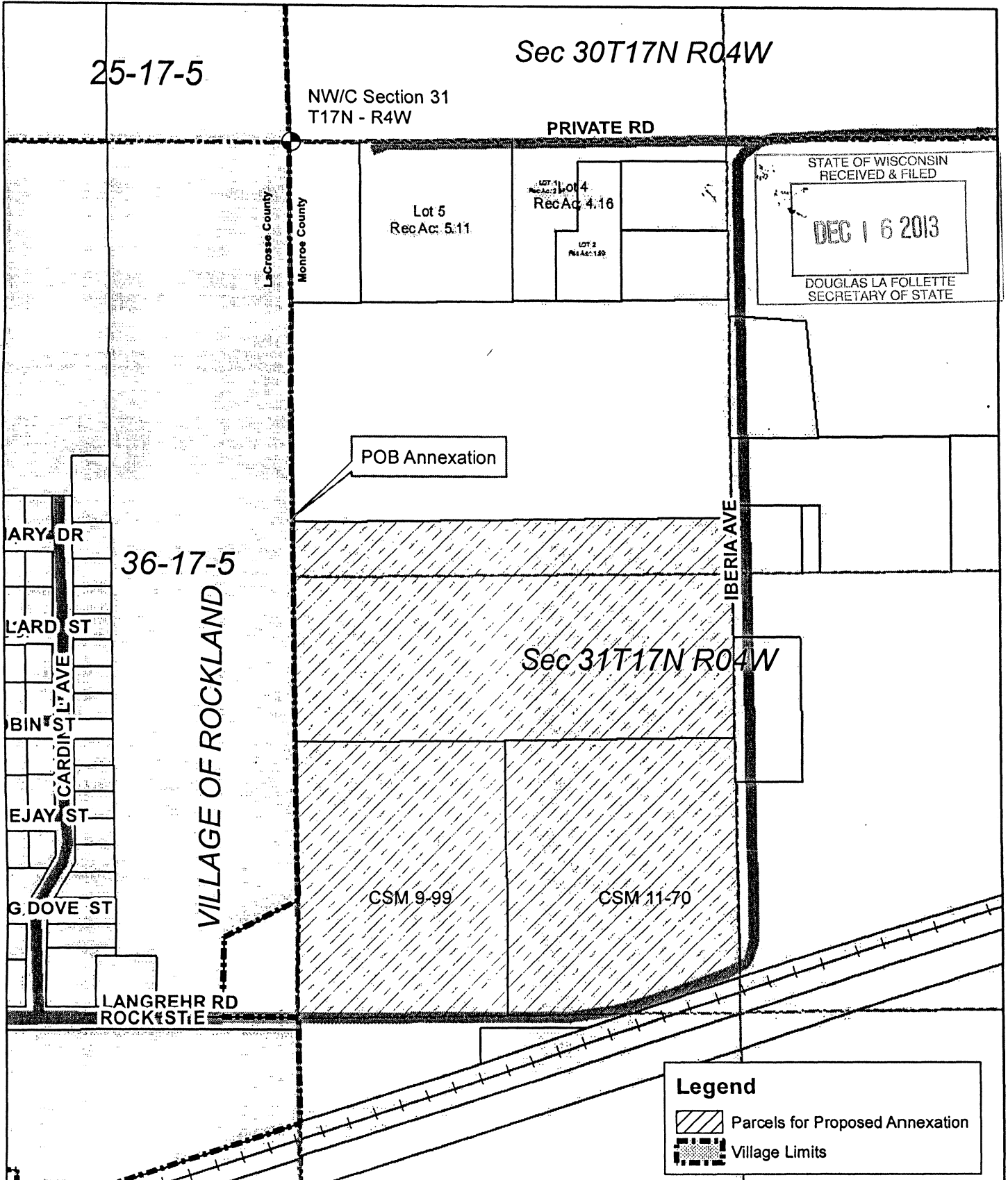

**Legend**

Parcels for Proposed Annexation

Village Limits

1 inch = 400 feet



Document Number

Document Name

Received for record this 21  
day of Dec A.D., 2013  
at 2:50 o'clock P.M.  
WLB Register

000101

Recording Area

Name and Return Address  
Sue Donskey  
711 Cardinal Ave  
Rockland, WI 54653  
30/rd

WHEREAS, Rockland Flooring is a business that is currently located in the Town of Sparta, Monroe County, Wisconsin; and,  
WHEREAS, Rockland Flooring has a large volume of heavy truck traffic traveling to and from its business on a daily basis; and,  
WHEREAS, Rockland Flooring's heavy truck traffic travels on Rock Street, located in the Village of Rockland, La Crosse County, Wisconsin; and,  
WHEREAS, the Village of Rockland recently became aware that said Rock Street is a Village Street and not a County Highway as previously thought, thereby leaving all of the maintenance and repair of the road solely within the budget of the Village of Rockland; and,  
WHEREAS, La Crosse County discovered the true ownership of said road while researching funding for the repair and rebuilding of said Street; and,  
WHEREAS, the trucks traveling to and from Rockland Flooring are a major contributor to the need for the rebuilding and increased cost of maintenance of said Rock Street; and,  
WHEREAS, this annexation will also allow for providing for fire protection by Bangor Burns Rockland Fire Department and other applicable Village services as needed; and,  
WHEREAS, Rockland Flooring, by and through its owner, Chorney Holdings, LLP, has requested approval from the Town Board of the Town of Sparta, to have its real properties located in said Town to be annexed into the Village of Rockland, La Crosse County, because the Village of Rockland incurs the cost of the damage to the roads and needs the tax revenue from Rockland Flooring to help offset this substantial and continuous expense; and,  
WHEREAS, such annexation would preserve the amount of Property Tax Revenue that the Town of Sparta would receive for the next five years pursuant to §66.0217(14), Wisconsin Statutes; and,  
WHEREAS, Wisconsin Statute Section 66.0217(2), provides for direct annexation upon petition of all of the electors residing in the territory to be annexed and the owners of all of the real property on the territory to be annexed; and,  
WHEREAS, there are no electors residing in the lands described on Exhibit A and depicted on Exhibit B, and Chorney Holdings, LLP is the sole owner of said property;  
NOW THEREFORE BE IT RESOLVED, by the Town Board, of the Town of Sparta, Monroe County, Wisconsin, that it hereby approves of the proposed annexation of the real property owned by Chorney Holdings, LLP, dba Rockland Flooring LLC to the Village of Rockland, La Crosse County, Wisconsin with respect to the real property described on Exhibit A as Monroe County Tax Parcel Nos. 040-01015-3000, 040-01015-0000, 040-01015-5000, and 040-01014-2000, shown on Exhibit B attached hereto.

ADOPTED THIS 6<sup>TH</sup> DAY OF JULY, 2013

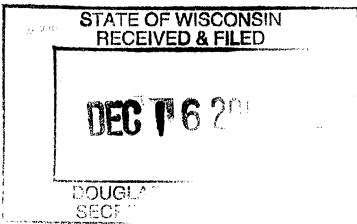

Howard Garves  
\* Town of Sparta Chair, ~~Howard~~ Garves  
HOWARD

Sue Ellen Justin (SEAL)  
\* Attest: Town of Sparta Clerk, Sue Justin

ACKNOWLEDGMENT

STATE OF WISCONSIN )  
Monroe ) ss. COUNTY )  
Personally came before me on 11-7-13  
the above-named Howard Garves  
Sue Justin  
to me known to be the person(s) who executed the foregoing  
instrument and acknowledged the same.  
Mary L. McClintock  
\* Mary L. McClintock  
Notary Public, State of Wisconsin  
My Commission (is permanent) (expires: 6/20/17)

THIS INSTRUMENT DRAFTED BY:  
Sue Donskey