

# The State of Wisconsin

## Office of the Secretary of State

V418

VILLAGE OF SIREN

BURNETT COUNTY

DETACHMENT ORDINANCE 2012-06

Filed SEPTEMBER 20, 2012

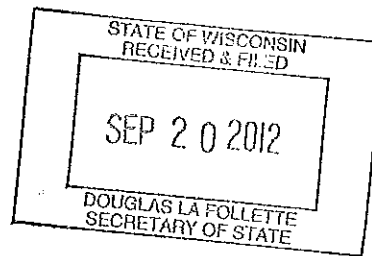

✓418

CERTIFICATION

I, Ann L. Peterson, Village Clerk for the Village of Siren, Burnett County, Wisconsin, hereby certify that the attached documents:

1. Ordinance No. 2012-06.
2. Village of Siren Regular Village Board Meeting Minutes for Thursday, May 10, 2012.

Are true and correct copies of the original records of the Village of Siren, Burnett County, Wisconsin.

Dated this 18 day of September, 2012.

Village of Siren, by:

Ann L. Peterson

Ann L. Peterson, Village Clerk

STATE OF WISCONSIN    )  
  ) ss.  
COUNTY OF BURNETT    )

Personally came before me this 18<sup>th</sup> day of September, 2012, the above-named Ann L. Peterson, Siren Village Clerk, to me known to be the person who executed the foregoing instrument and acknowledged the same.

Janet J. Thomas  
Janet J. Thomas

, Notary Public

Burnett County, Wisconsin

My commission exp. 6-28-15

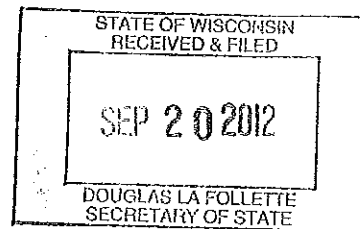

ORDINANCE #2012 – 06:

AN ORDINANCE PROVIDING FOR DETACHMENT OF A PORTION OF THE VILLAGE OF SIREN, BURNETT COUNTY, WISCONSIN, TO THE TOWN OF SIREN, BURNETT COUNTY, WISCONSIN.

WHEREAS, the Village has received a petition for detachment of land from the Village of Siren in the County of Burnett, Wisconsin to the Town of Siren in the County of Burnett, Wisconsin for the subject property and whereas the Village Board by at least a three-fourths majority has approved the detachment petition. It is hereby ordained that the following Property is detached from the Village of Siren and is therefore attached to the Town of Siren.

Lot One (1) of Certified Survey Map recorded in Vol. 23, CSM Pages 258-260 as Doc. 405211, located in the NW ¼ of Section 8, Township 38 North, Range 16 West, Village of Siren and Town of Siren, Burnett County, Wisconsin.

Said territory contains approximately 1.89 acres with a current population of two (2) persons, as defined in Wisconsin Statutes Section 66.0227. The property is currently zoned W-1 Conservancy. A scale map reasonably showing the boundaries of said territory and the relation of said territory to the municipalities involved is attached hereto as Exhibit A.

We, the undersigned, elect that this detachment shall take effect to the full extent.

WHEREAS, it appears by affidavit on file herein that the petitioner has filed a duplicate original of said Petition for Detachment with the Town Clerk of the Town of Siren, Burnett County, Wisconsin, and

WHEREAS, it further appears that there are no electors residing in the territory proposed to be detached and the Petition has been signed by the owner of the Property within such territory; and

WHEREAS, it further appears that all of the requirements of Sections 66.0227 of the Wisconsin Statutes have been fully complied with; and

WHEREAS, it appears in the best interest of the Village of Siren that the afore described Village of Siren territory be detached from the Village of Siren;

NOW, THEREFORE, the Village Board of the Village of Siren, Burnett County, Wisconsin does ordain as follows:

THAT the afore described territory situated in the Village of Siren be and the same is hereby detached and attached to the Town of Siren, Burnett County, Wisconsin;

THAT the property shall continue to be zoned W-1 Conservancy until such time as it is re-zoned by the Town of Siren;

THAT the Village Clerk is hereby directed to provide the Ordinance to the Town of Siren so that they Town of Siren may act upon the Ordinance with the time period as set forth in Section 66.0227 Wis. Stats. The Village Clerk is further directed to make the mailings pursuant to Wis. Stats. Section 66.02271, i.e., to mail a copy of the Ordinance of Detachment to the Town Clerk of the Town of Siren, to the Secretary of State of the State of Wisconsin, and the Clerk of the Siren School District, and one copy to any company that provides any utility service to the area detached, a copy to the Register of Deeds of Burnett County, Wisconsin. All mailings shall occur within thirty (30) days of the date hereof pursuant to Wis. Stats. section 66.03.

Dated this 10<sup>th</sup> day of May, 2012

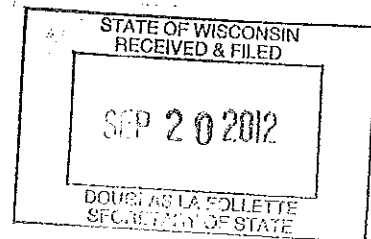

Motion by: \_\_\_\_\_

Seconded by: \_\_\_\_\_

Ayes: \_\_\_\_\_  
Absent: \_\_\_\_\_

Nays: \_\_\_\_\_  
Abstained: \_\_\_\_\_

\_\_\_\_\_  
Janet Hunter, Village President

\_\_\_\_\_  
Ann L. Peterson, Village Clerk

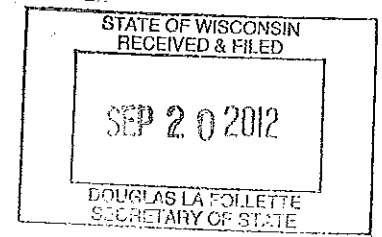

**PARCEL NUMBER**

**07-181-2-38-16-18-4 02-000-011100**

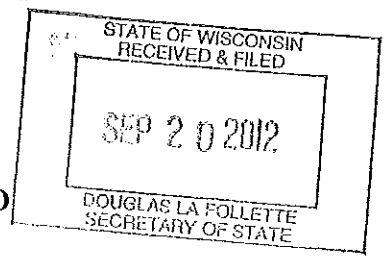

**LEGAL DESCRIPTION OF PARCEL DETACHED  
FROM VILLAGE OF SIREN AND  
ACQUIRED BY TOWNSHIP OF SIREN, BURNETT COUNTY, WISCONSIN**

Lot One (1) of Certified Survey Map No. 4351 recorded in Volume 23 of Certified Survey Maps at Pages 258 through 260 as Document No. 405211, Burnett County, Wisconsin records, excepting therefrom the following-described parcel of land:

A parcel of land in the Northwest Quarter of the Southeast Quarter of Section 18, Township 38 North, Range 16 West, described as follows: Commencing at the Northwest corner of the SW SE, 18-38-16, thence North 0°21'28" East 482.12 feet along the Quarter line to the point of beginning, thence continuing North 0°21'28" East 240.76 feet along the Quarter line, thence North 89°41'07" East 600 feet, thence North 0°21'28" East 410 feet, thence North 89°41'07" East 715.64 feet, thence South 0°21'18" West 641.68 feet along the forty line, thence South 89°17'23" West 1315.81 feet to the point of beginning. Said land being situate in Burnett County, Wisconsin.

# BURNETT COUNTY CERTIFIED SURVEY MAP NO. 4351

Approval of this minor subdivision does not grant approval for a building site permit or a private onsite wastewater treatment system. Refer to Comm. 83.

Approval for filing on behalf of the Burnett County Land Use and Information Committee.

*James Flanigan* 8-11-09  
James Flanigan Date.  
Burnett County Zoning Administrator

405211

Vol. 23 Pg. 258

BURNETT COUNTY  
WISCONSIN  
Received and Recorded

September 11, 2009

at 3:10 PM

Janine Chell

Register of Deeds

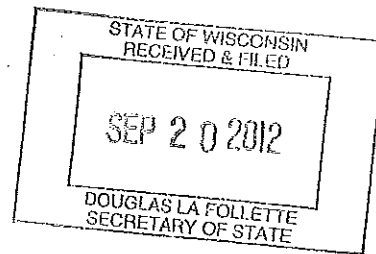

A Parcel of Land Located in the Northwest 1/4 of the Southeast 1/4, Section 18, Township 38 North, Range 16 West, Village and Town of Siren, Burnett County, Wisconsin

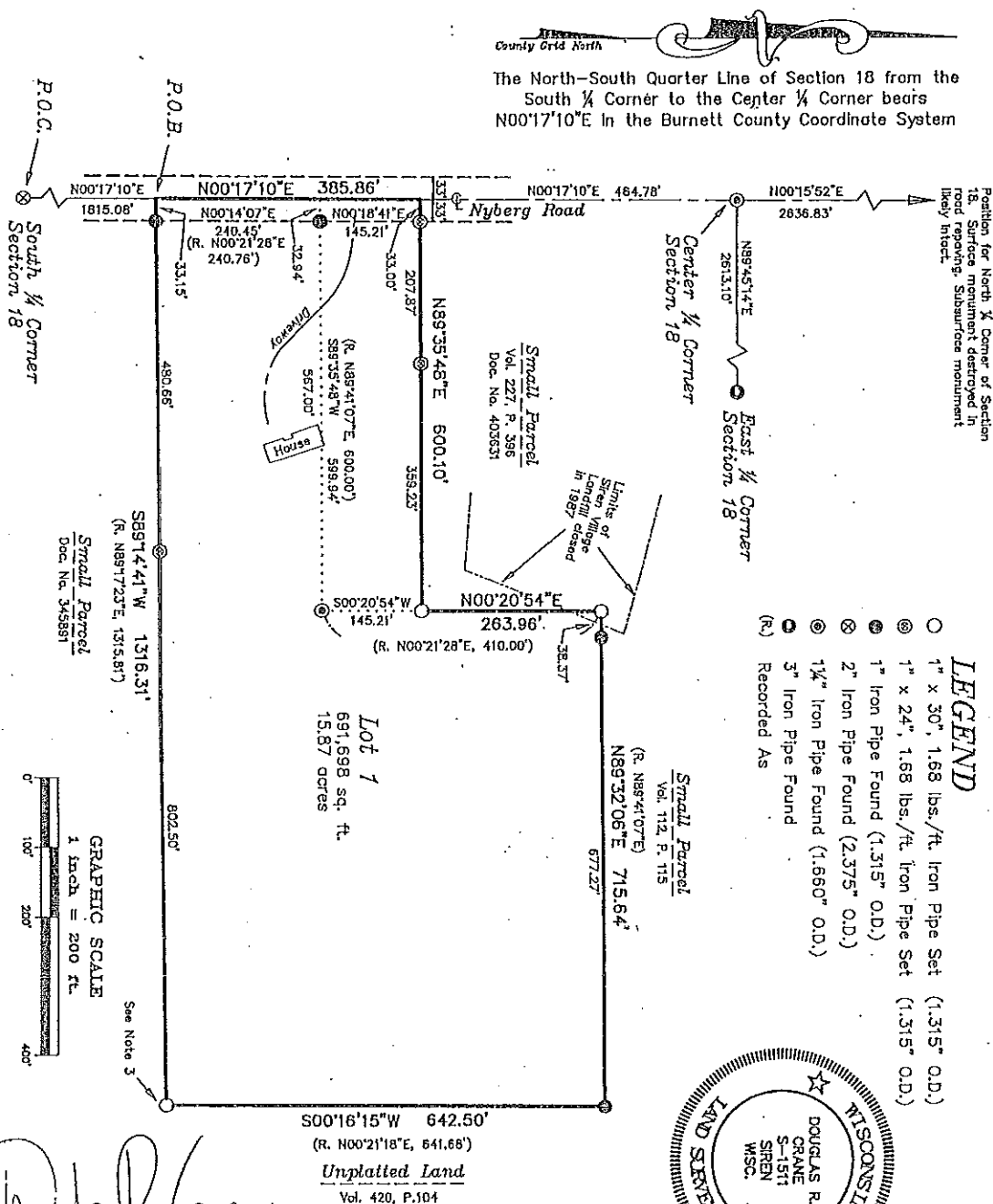

*D.R. Crane*

July 30, 2009

Page 1 of 3

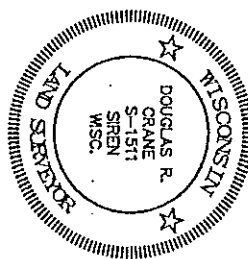

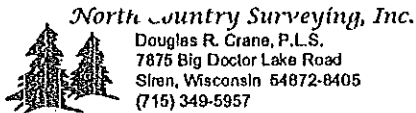

North Country Surveying, Inc.  
Douglas R. Crane, P.L.S.  
7875 Big Doctor Lake Road  
Siren, Wisconsin 54872-8405  
(715) 349-5957

**BURNETT COUNTY**  
**CERTIFIED SURVEY MAP NO. 4351**

**SURVEYOR'S NOTES:**

- 1) The lot depicted on this survey includes the parcel described in Document No. 338211 (Kosloski - Parcel 13, Map of Survey filed as D-605) and 2 acres of a parcel described in Deed., Volume 227, p.396 (Village of Siren). The sale of the 2 acres to Mr. Kosloski has been approved by the Village of Siren. The lot shown hereon shows the parcel as it will end up after the deeding is completed. At this time the 2 acre parcel remains in the Village Limits, while the parcel currently owned by Kosloski is in the Town of Siren.
- 2) The parcel described in Vol. 227, p. 396 contains a reversion clause that is released in a Quit Claim Deed recorded as Document No. 403631.
- 3) At the southeast corner of Lot 1, a 4" wide by 4.3' long wood post split in half was found protruding up 18" above the swamp. The position for the base of the post was found to fit the position of the lot corner based on D'Jock's 1975 Map of Survey (D-605). We accepted this monument and placed 1" by 30" iron pipe in position for the wood post. The wood post was left alongside the iron pipe.
- 4) In providing this boundary survey, no attempt has been made to obtain or show data concerning the existence, size, depth, condition, capacity, or location of any utility existing on this site or affecting this site, whether private, municipal or public owned.
- 5) No abstract of title, nor title commitment, or results of a title search were furnished to the surveyor. All documents of record reviewed are noted hereon. There may exist other documents of record that may affect this surveyed parcel.
- 6) The professional surveyor has made no investigation or independent search for easements of record, encumbrances, restrictive covenants, ownership title evidence, or any other facts that an accurate and current title search may disclose.
- 7) Subsurface and environmental conditions were not surveyed or examined or considered as part of this survey. No evidence or statement is made concerning the existence of underground or overhead conditions, containers or facilities that may affect the use or development of this property.
- 8) Copyright © North Country Surveying, Inc. All rights reserved. No part of this drawing may be reproduced by photocopying, recording or any other means, or stored, processed or transmitted in or by any computer or other systems without the prior written permission of North Country Surveying, Inc. and the surveyor responsible for this map. Copies of this map without an original signature and seal are not valid. Permission is hereby granted to the Burnett County Register of Deeds to perform their statutory business.

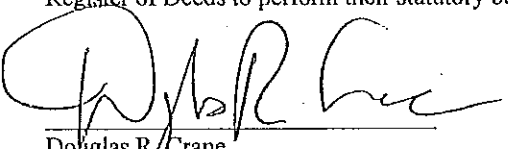
  
Douglas R. Crane  
July 30, 2009

Page 2 of 3



405211

Vol. 23 Pg. 259

BURNETT COUNTY  
WISCONSIN

Received and Recorded

September 11, 2009

at 3:10 PM

Jeanine Chell

Register of Deeds

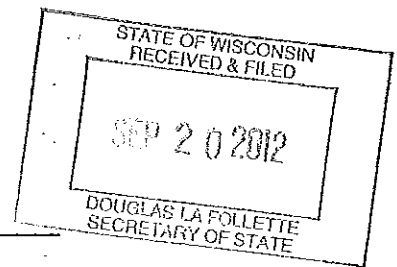



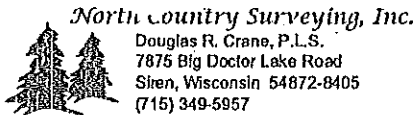

North Country Surveying, Inc.

Douglas R. Crane, P.L.S.  
7875 Big Doctor Lake Road  
Siren, Wisconsin 54872-8405  
(715) 349-5957

405211

Vol. 23 Pg. 260

BURNETT COUNTY  
WISCONSIN  
Received and Recorded

September 11, 2009

at 3:10 PM  
Jeanine Chell

Register of Deeds

**BURNETT COUNTY**  
**CERTIFIED SURVEY MAP NO. 4351**

**VILLAGE OF SIREN APPROVAL**

Resolved, that this Certified Survey Map for Rick Kosloski and Randy Surbaugh, representing the Village of Siren, located in the Northwest Quarter of the Southeast Quarter, Section 18, Township 38 North, Range 16 West, Village of Siren, Burnett County, Wisconsin, is hereby approved by the Village of Siren.

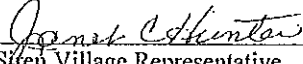
  
Siren Village Representative

9/10/09  
Date

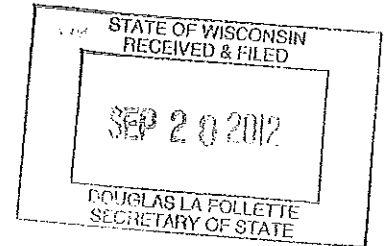

I hereby certify that the above is a true and correct copy of a resolution adopted by the Village of Siren, Wisconsin.

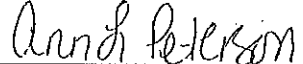
  
Village Clerk

Sept 10, 2009  
Date

**SURVEYOR'S CERTIFICATE:**

I, Douglas R. Crane, a Wisconsin Registered Land Surveyor, do hereby certify that at the direction of Rick Kosloski and Randy Surbaugh, representing the Village of Siren, I have surveyed, mapped and described the parcel of land which is represented by this Certified Survey Map;

that the exterior boundaries of said parcel surveyed and mapped are described as follows:

A parcel of land located in the Northwest Quarter of the Southeast Quarter, Section 18, Township 38 North, Range 16 West of the Fourth Principal Meridian, Village and Town of Siren, County of Burnett, State of Wisconsin, more specifically described as follows:

Commencing at the South Quarter Corner of Section 18; thence N00°17'10"E, 1815.08 feet to the Point of Beginning;  
thence N00°17'10"E, 385.86 feet;  
thence N89°35'48"E, 600.10 feet;  
thence N00°20'54"E, 263.96 feet;  
thence N89°32'06"E, 715.64 feet;  
thence S00°16'15"W, 642.50 feet;  
thence S89°14'41"W, 1316.31 feet to the Point of Beginning;

that to the best of my knowledge and belief this Certified Survey Map is a correct representation of the exterior boundaries of the parcel surveyed and described;

that I have fully complied with the applicable provisions of Chapter 236 of the Wisconsin Statutes, the Village of Siren Subdivision Ordinance, and the Burnett County Subdivision Control Ordinance in surveying and mapping the same.

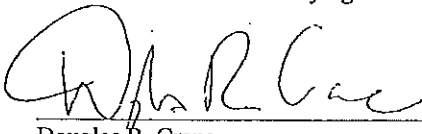
  
Douglas R. Crane  
July 30, 2009

