

# The State of Wisconsin

## Office of the Secretary of State

---

C23

CITY OF JEFFERSON

JEFFERSON COUNTY

ANNEXATION ORDINANCE 18-12

Filed FEBRUARY 8, 2012

CITY OF

317 S. MAIN ST.  
JEFFERSON, WISCONSIN 53549  
674-7700

Jefferson  
SPECIAL PLACE  
IN WISCONSIN

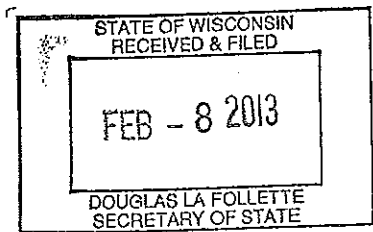

February 6, 2013

Wisconsin Secretary of State  
ATTN: Douglas LaFollette  
PO Box 7848  
Madison, WI 53707-7848

RE: Annexation

The City of Jefferson recently annexed property into our City limits. In accordance with Wisconsin State Statutes 66.0217(9)(a), please find enclosed a copy of our ordinance describing the annexed property.

The population of the annexed territory is 0.

If you need any further information on this annexation, please contact me at [tanya@jeffersonwis.com](mailto:tanya@jeffersonwis.com) or (920) 674-7700.

Sincerely,

Tanya N. P. Stewart  
City Clerk/Treasurer  
City of Jefferson

**CITY OF JEFFERSON  
PROPOSED ORDINANCE #18-12**

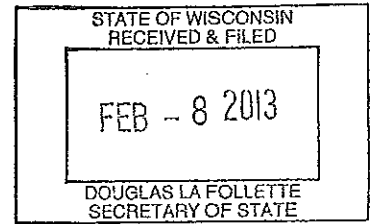

The Common Council of the City of Jefferson, Wisconsin, do ordain as follows:

**SECTION 1. Territory Annexed.** In accordance with Section 66.0217 of the Wisconsin Statutes and the petition for direct annexation filed with the City Clerk on the 7<sup>th</sup> day of December, 2012, signed by the owners of at least ½ of the land in area and real property in assessed value in the territory, the following described territory in the Town of Jefferson, Jefferson County, Wisconsin, is annexed to the City of Jefferson, Wisconsin:

Part of the SE¼ of the NW¼ of Section 3, T6N, R14E, Town of Jefferson, Jefferson County, Wisconsin, to-wit:

Commencing at an aluminum monument at the W ¼ corner of said Section 3; thence S85°39'24"E, along the E-W ¼ line of said Section 3, 2303.91 feet to the easterly line of the S.T.H. 26 Bypass and the point of beginning; thence continue S85°39'24"E, along said E-W ¼ line, 174.14 feet more or less to the westerly line of the East 153 feet of said SE¼ of the NW¼; thence N0°02'27"E, 694.98 feet more or less to said easterly line of the S.T.H. 26 Bypass; thence S9°26'09"W, 321.99 feet more or less to R/W Monument; thence S18°25'43"W, along said easterly line, 383.85 feet to the point of beginning containing 1.164 acres more or less.

**SECTION 2. Effect of Annexation.** From and after the date of this ordinance the territory described in section 1 shall be a part of the City of Jefferson for any and all purposes provided by law and all persons coming or residing within such territory shall be subject to all ordinances, rules and regulations governing the City of Jefferson.

**SECTION 3. Temporary Zoning Classification.** The Plan Commission has recommended a temporary zoning designation of AG (Agriculture).

**SECTION 4. Ward Designation.** The territory described in Section 1 of this ordinance is hereby made a part of the 5<sup>th</sup> Ward, District C of the City of Jefferson, subject to the ordinances, rules and regulation of the City of Jefferson governing wards.

**SECTION 5. Severability.** If any provision of this ordinance is invalid or unconstitutional, or if the application of this ordinance to any person or circumstances is invalid or unconstitutional, such invalidity or unconstitutionality shall not affect the other provision or application of this ordinance which can be given effect without the invalid or unconstitutional provision or application.

**SECTION 6. Tax Payment.** In compliance with Section 66.0217(14)(a) Wis. Stats., the City of Jefferson acknowledges that it must pay annually the Town of Jefferson, for 7 years, an amount equal to the amount of property taxes (\$81.62), that the town levied on the annexed territory, as shown by the 2012 tax roll under Section 70.65 Wis. Stats.

**SECTION 7. Effective Date.** This ordinance shall take effect upon passage and publication as provided by law.

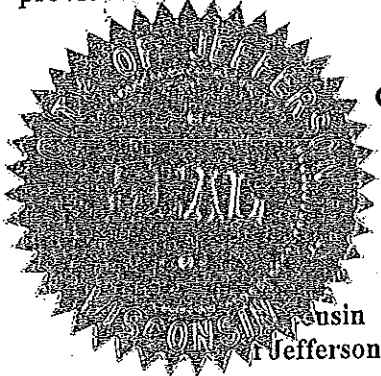

City Official Seal

First Reading: December 18, 2012  
Second Reading: February 5, 2012  
Passed By A Vote 7 of 0

I certify that this is a true and correct copy of a document in the possession of the City of Jefferson.

Dated: February 6, 2013

A handwritten signature in cursive script, appearing to read "Tanya NP Stewart".

Tanya NP Stewart  
City of Jefferson City Clerk/Treasurer  
County of Jefferson/State of Wisconsin  
Notary Public  
Commission expires 9/11/16

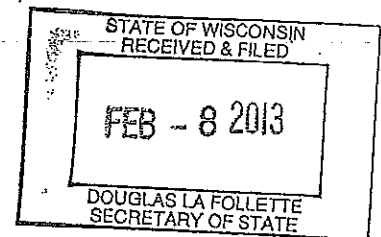

Pénicilina

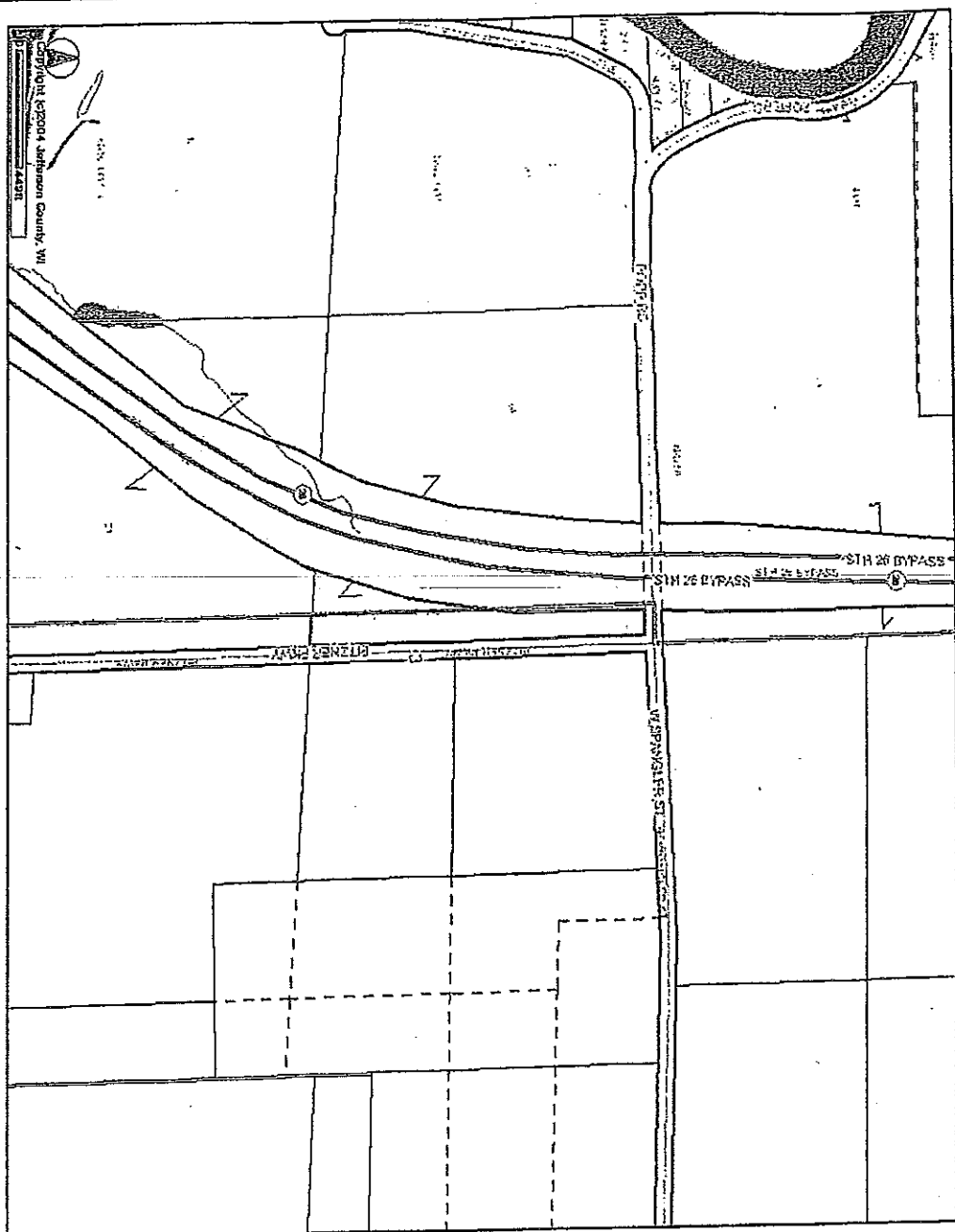

- [illegible]

STATE OF WISCONSIN  
RECEIVED & FILED

FEB - 8 2013

DOUGLAS LA FOLLETTE  
SECRETARY OF STATE

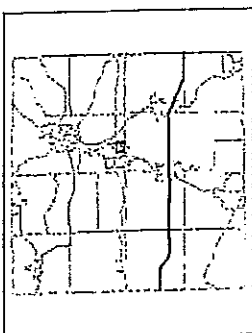

## - variation systems

Disfranchisement