

ORD -10493

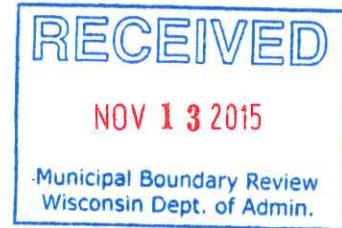

Debra L. Salas  
City Clerk/Treasurer



November 9, 2015

Phil Wells, Program & Policy Analyst, Advanced  
Wisconsin Department of Administration  
Division of Intergovernmental Relations  
Demographic Services Center  
P.O. Box 8944  
Madison WI 53708-8944

RE: Attachment and Zoning District Classification Ordinance Under Section 66.0307, Wisconsin Statutes, City of Kenosha/Town of Somers State Approved Cooperative Plan (CTH N - 38th Street ROW).

The City of Kenosha Common Council on November 2, 2015 adopted Ordinance 40-15 - By the Mayor - Attachment and Zoning District Classification Ordinance Under Section 66.0307, Wisconsin Statutes, City of Kenosha/Town of Somers State Approved Cooperative Plan (CTH N - 38th Street ROW).

Enclosed is a copy of said ordinance, including map and legal description of the territory, Certificate of Annexation and Certificate of Population relative to the above annexation.

Sincerely,

CITY OF KENOSHA



Debra L. Salas  
City Clerk

RE:

**CERTIFICATE OF ANNEXATION, SECTION 66.0217**  
**WISCONSIN STATUTES**

I, Debra L. Salas, City Clerk of the City of Kenosha, Wisconsin do hereby certify that on the 2nd day of November, 2015, the Kenosha Common Council by Ordinance duly adopted, and did annex to the City of Kenosha, territory in the Town of Somers, KENOSHA COUNTY, WISCONSIN.

I further certify that attached thereto and made a part hereof is a true and correct copy of the legal description and plat of the territory so annexed.

Dated this 9th day of November, 2015.



---

Debra L. Salas  
City Clerk

SEAL

RE: Attachment and Zoning District Classification Ordinance Under Section 66.0307, Wisconsin Statutes, City of Kenosha/Town of Somers State Approved Cooperative Plan (CTH N - 38th Street ROW).

**CERTIFICATE OF POPULATION**

I, Debra L. Salas, City Clerk of the City of Kenosha, County of Kenosha, State of Wisconsin, do hereby certify that the population of the area so annexed to the City of Kenosha with the passage of Kenosha Ordinance 40-15 is Zero (0).



---

Debra L. Salas  
City Clerk

SEAL

**ATTACHMENT AND ZONING DISTRICT CLASSIFICATION ORDINANCE**  
**Under Section 66.0307, Wisconsin Statutes,**  
**City of Kenosha/Town of Somers**  
**State Approved Cooperative Plan**

**Property Name:** CTH N – 38<sup>th</sup> Street ROW

**Located at:** East of I94 to CTH S

Town of Somers  
[CTH N – 38<sup>th</sup> Street ROW]

**ORDINANCE NO. 40-15**

**BY: THE MAYOR**

THIS IS TO CERTIFY THAT THIS  
IS A TRUE AND CORRECT COPY  
OF THE RECORD ON FILE IN THE  
OFFICE OF THE CITY CLERK  
TREASURER, CITY OF KENOSHA  
WISCONSIN

*Ramon J. August*  
*Dep. City Clerk - Treasurer*  
*11/9/15*

Attaching to the City of Kenosha, Wisconsin, territory in the Town of Somers, Kenosha County, Wisconsin, City of Kenosha/Town of Somers State Approved Cooperative Plan:

The Common Council of the City of Kenosha, Wisconsin, does ordain as follows:

**Section One:**        **Territory Attached.**    In accordance with City of Kenosha/Town of Somers Cooperative Plan under Section 66.0307 of the Wisconsin Statutes, approved by the Wisconsin Department of Administration, Intergovernmental Relations, Municipal Boundary Review, on August 8, 2005, and pursuant to the First Amendment to the City of Kenosha and Town of Somers Cooperative Boundary Plan as approved by the Wisconsin Department of Administration on September 14, 2015, the territory in the Town of Somers, Kenosha County, Wisconsin, road rights-of-way, described on the attached legal description, Exhibit "A", and map, Exhibit "B", is hereby attached to the City of Kenosha, Wisconsin, as hereinafter provided.

**Section Two:**        **Effect of Attachment.**    From and after the effective date

of this ordinance, the territory described in Section One shall be a part of the City of Kenosha for any and all purposes provided by law, and all persons coming or residing within such territory shall be subject to all Ordinances, rules and regulations governing the City of Kenosha.

**Section Three: Severability.** If any provision of this Ordinance is invalid or unconstitutional, or if the application of this Ordinance to any person or circumstances is invalid or unconstitutional, such invalidity or unconstitutionality shall not affect the other provisions or applications of this Ordinance which can be given effect without the invalid or unconstitutional provision or application.

**Section Four: Effective Date.** This Ordinance shall become effective upon passage and publication.

ATTEST:   
Debra L. Salas City Clerk

APPROVED:   
Keith G. Bosman Mayor Date: November 3, 2015

Passed: November 2, 2015

Published: November 6, 2015

Drafted By:  
Edward R. Antaramian  
City Attorney

**Roadway Jurisdictional legal descriptions**  
**City/Somers**  
**(6-5-2015)**

**County Trunk Highway "N" – 38<sup>th</sup> Street**

- 1) Commencing at the West  $\frac{1}{4}$  corner of Section 30 Town 2 North, Range 22 East of the Fourth Principal Meridian; thence East along the North line of the Southwest  $\frac{1}{4}$  of said Section 30 (said line also being the centerline of 38<sup>th</sup> Street) 846.8 feet to the West line of Certified Survey Map 620 as recorded in the Kenosha County Register of Deeds Office as document number 643225. (said line also being the East line of the West  $\frac{1}{4}$  of the Southwest  $\frac{1}{4}$  of said Section 30) and the place of beginning of lands described; thence southerly along the West line of said Certified Survey Map 620 40 feet thence; N  $86^{\circ}59'16''$  E 52 feet; thence North parallel with the West line of said Certified Survey Map 620, 7 feet thence N  $86^{\circ}59'16''$  E 856.95 feet; thence N  $87^{\circ}49'39''$  E 225 feet; thence N  $87^{\circ}28'34''$  E 188.665 feet to the east line of the Southwest  $\frac{1}{4}$  of said Section 30; thence continuing N  $87^{\circ}28'34''$  E 21.335 feet thence N  $87^{\circ}36'38''$  E 150 feet; thence N  $86^{\circ}24'38''$  E 444.53 feet; thence N  $88^{\circ}13'04''$  E 588.86 feet; thence N  $87^{\circ}30'45''$  E 453.25 feet; thence N  $87^{\circ}44'47''$  E 694.665 feet; thence N  $87^{\circ}59'34''$  E 319.98 feet to the East line of said Section 30 at a point which is 53.42 feet N  $02^{\circ}01'47''$  W of the East  $\frac{1}{4}$  corner of said Section 30; thence N  $02^{\circ}01'47''$  W along the East line of the Northeast  $\frac{1}{4}$  of said Section 30 to a point which is 118.7 feet N  $02^{\circ}03'20''$  W of the east  $\frac{1}{4}$  corner of said Section 30; thence S  $87^{\circ}59'34''$  W 243.4 feet to the East line of Certified Survey Map 921 as recorded in the Kenosha County Register of Deeds Office as document 703095; thence southerly along the East line of said Certified Survey Map 921, 33 feet to the south line of said Certified Survey Map 921 which is also the centerline of 38<sup>th</sup> Street; thence S  $87^{\circ}59'34''$  W (recorded as S  $87^{\circ}44'41''$  W) along the south line of said Certified Survey Map 921, 76.58 feet to an angle point; thence continuing along the south line of said Certified Survey Map 921 S  $87^{\circ}44'47''$  W (recorded as  $87^{\circ}44'41''$  W) 103.71 feet; thence northerly along the West line of Certified Survey Map 921, 33 feet (recorded as 30 feet) to the North line of 38<sup>th</sup> Street; thence S  $87^{\circ}44'47''$  W 590.955 feet; thence S  $87^{\circ}30'45''$  W 453.25 feet; thence S  $88^{\circ}13'04''$  W 588.86 feet to the East line of Certified Survey Map 2765 a Certified Survey Map recorded with the Kenosha County Register of Deeds Office as document 1734027 which point is also the centerline of Kilbourn Road Ditch, also known as Kilbourn Ditch Creek; thence S  $86^{\circ}24'38''$  W along the South line of Certified Survey Map 2765 439.25 feet, more or less; thence S  $87^{\circ}36'38''$  W 0.53 feet; thence S  $02^{\circ}23'22''$  E 33 feet to the centerline of 38<sup>th</sup> Street; thence S  $87^{\circ}36'38''$  W 149.13 feet; thence S  $87^{\circ}28'34''$  W 210 feet thence; S  $87^{\circ}43'34''$  W 225.19; thence N  $02^{\circ}31'26''$  W 33 feet; thence S  $87^{\circ}43'34''$  W 31.5 feet; thence S  $86^{\circ}59'16''$  W 875.57 feet; thence southerly along the northerly extension of the West line of Certified Survey Map 620, 33 feet to the place of beginning. Said lands being in the Town of Somers, County of Kenosha, State of Wisconsin.

- 2) Commencing at a point on the West line of the Northwest  $\frac{1}{4}$  of Section 29, Township 2 North, Range 22 East of the Fourth Principal Meridian which is 118.7 feet north of the west  $\frac{1}{4}$  corner of said Section; thence S  $89^{\circ}37'10''$  E 337 feet to the place of beginning; thence south parallel with the West line 33 feet; thence S  $89^{\circ}37'10''$  E 505.5 feet; thence north parallel with the West line 33 feet; thence N  $89^{\circ}37'10''$  W 505.5 feet to the place of beginning. Said lands being in the Town of Somers, County of Kenosha, State of Wisconsin.
  
- 3) Commence at a point on the West line of the Northwest  $\frac{1}{4}$  of Section 29, Township 2 North, Range 22 East of the Fourth Principal Meridian, which is 85.7 feet north of the west  $\frac{1}{4}$  corner of said Section, thence S  $89^{\circ}37'10''$  E 1,011 feet to the point of beginning; thence north parallel to the West line 33 feet; thence S  $89^{\circ}37'10''$  E 1,083.45 feet; thence N  $79^{\circ}08'05''$  E 56 feet; thence N  $30^{\circ}34'44''$  E 31.4 feet; thence N  $37^{\circ}19'32''$  W 29.6 feet thence Southeasterly to the northwest corner of Certified Survey Map 927 recorded in the Kenosha County Register of Deeds Office as document 703101; thence N  $89^{\circ}37'10''$  W 200.21 feet along the South line of 38<sup>th</sup> Street to the West line of the East  $\frac{1}{2}$  of the Southwest  $\frac{1}{4}$  of said Section 29, thence north along the west line of the East  $\frac{1}{2}$  of the East  $\frac{1}{2}$  of the Southwest  $\frac{1}{4}$  of said Section 29, 33 feet thence; N  $89^{\circ}37'10''$  W to a point 1,011 feet S  $89^{\circ}37'10''$  E from the West line of said Section 29 and the place of beginning of said parcel. Said lands being in the Town of Somers, County of Kenosha, State of Wisconsin.

Interstate 94

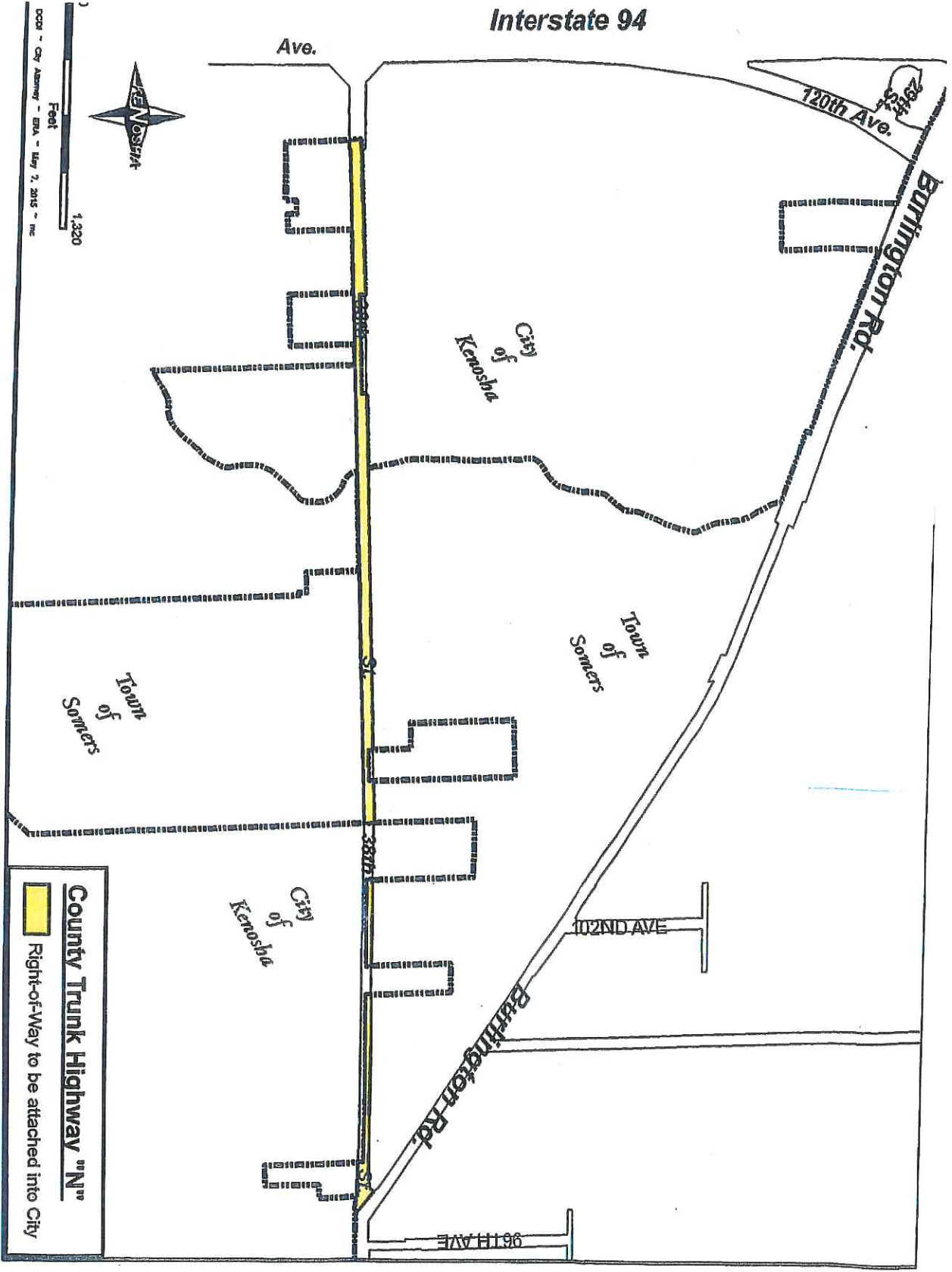

0 1,320  
 Feet  
 Date: City Attorney - BSA - May 2, 2015 - Inc



**County Trunk Highway "N"**  
 Right-of-Way to be attached into City

Ave.

120th Ave.

City of Kenosha

Town of Somers

Town of Somers

City of Kenosha

102ND AVE

96TH AVE

Burlington Rd.

Burlington Rd.

St.

St.

St.