



Debra L. Salas
City Clerk/Treasurer

10514

December 21, 2015

Phil Wells, Program & Policy Analyst, Advanced
Wisconsin Department of Administration
Division of Intergovernmental Relations
Demographic Services Center
P.O. Box 8944
Madison WI 53708-8944

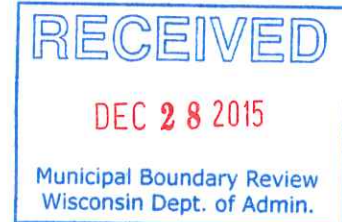

RE: Attachment and Zoning District Classification Ordinance (Under Section 66.0307, Wisconsin Statutes, City of Kenosha/Town of Somers State Approved Cooperative Plan) for property West of 60th Avenue to the Union Pacific Railroad (CTH K - 60th Street ROW).

The City of Kenosha Common Council on December 7, 2015 adopted Ordinance 46-15 - By the Mayor - Attachment and Zoning District Classification Ordinance (Under Section 66.0307, Wisconsin Statutes, City of Kenosha/Town of Somers State Approved Cooperative Plan) for property West of 60th Avenue to the Union Pacific Railroad (CTH K - 60th Street ROW).

Enclosed is a copy of said ordinance, including map and legal description of the territory, Certificate of Attachment and Certificate of Population relative to the above attachment.

Sincerely,

CITY OF KENOSHA

Debra L. Salas
City Clerk

ATTACHMENT AND ZONING DISTRICT CLASSIFICATION ORDINANCE
Under Section 66.0307, Wisconsin Statutes,
City of Kenosha/Town of Somers
State Approved Cooperative Plan

Property Name: CTH K-60th Street Right-Of-Way

Located at: West of 60th Avenue to the
Union Pacific Railroad

Town of Somers
[CTH K – 60th Street Right-Of-Way]

ORDINANCE NO. 46-15

BY: THE MAYOR

THIS IS TO CERTIFY THAT THIS
IS A TRUE AND CORRECT COPY
OF THE RECORD ON FILE IN THE
OFFICE OF THE CITY CLERK
TREASURER, CITY OF KENOSHA
WISCONSIN

Karen J. August
Karen J. August
Deputy City Clerk
12/24/15

Attaching to the City of Kenosha, Wisconsin, territory in the Town of Somers, Kenosha County, Wisconsin, City of Kenosha/Town of Somers State Approved Cooperative Plan:

The Common Council of the City of Kenosha, Wisconsin, does ordain as follows:

Section One: **Territory Attached.** In accordance with City of Kenosha/Town of Somers Cooperative Plan under Section 66.0307 of the Wisconsin Statutes, approved by the Wisconsin Department of Administration, Intergovernmental Relations, Municipal Boundary Review, on August 8, 2005, and pursuant to the First Amendment to the City of Kenosha and Town of Somers Cooperative Boundary Plan as approved by the Wisconsin Department of Administration on September 14, 2015, the territory in the Town of Somers, Kenosha County, Wisconsin, comprising road rights-of-way, described on the attached legal description, Exhibit "A", and map, Exhibit "B", is hereby attached to the City of Kenosha, Wisconsin, as hereinafter provided.

Section Two: **Effect of Attachment.** From and after the effective date

of this ordinance, the territory described in Section One shall be a part of the City of Kenosha for any and all purposes provided by law, and all persons coming or residing within such territory shall be subject to all Ordinances, rules and regulations governing the City of Kenosha.

Section Three: **Severability.** If any provision of this Ordinance is invalid or unconstitutional, or if the application of this Ordinance to any person or circumstances is invalid or unconstitutional, such invalidity or unconstitutionality shall not affect the other provisions or applications of this Ordinance which can be given effect without the invalid or unconstitutional provision or application.

Section Four: **Effective Date.** This Ordinance shall become effective upon passage and publication.

ATTEST:  _____ City Clerk
Debra L. Salas

APPROVED:  _____ Mayor
Keith G. Bosman

Date: December 8, 2015

Passed: December 7, 2015

Published: December 11, 2015

Drafted By:
Edward R. Antaramian
City Attorney

Exhibit A

Commencing at the intersection of the East line of the Union Pacific Railroad with the south line of the Southeast $\frac{1}{4}$ of Section 33 Town 2 North, Range 22 East of the Fourth Principal Meridian; thence N $89^{\circ}33'30''$ E along the south line of said section 656.68 feet to the southwest corner of the Southwest $\frac{1}{4}$ of Section 34, Town 2 North, Range 22 East of the Fourth Principal Meridian; thence east along the South line of said Southwest $\frac{1}{4}$ of Section 34 1337.08 feet to the east line of the Southwest $\frac{1}{4}$ of said $\frac{1}{4}$ section; thence continue east along the south line of said $\frac{1}{4}$ section 782.68 feet; thence continue east along south line of said $\frac{1}{4}$ section 300 feet; thence N $00^{\circ}26'36''$ W 50 feet; thence East parallel with the south line of said Section 34, 100 feet; thence N $01^{\circ}50'16''$ W 10 feet to a point being 60 feet North of the south line of said section; thence N $89^{\circ}33'19''$ E 152.73 feet (recorded as 154.46 feet); thence N $89^{\circ}40'04''$ E 162.37 feet (recorded as 160.7 feet); thence easterly to a point being 60.02 feet North of and 406.54 feet east of the centerline of State Trunk Highway 31 said distance of said lands being measured off of the south line of said section; thence S $01^{\circ}50'18''$ E, 10 feet to a point 50 feet north of the south line of said section; thence East parallel with the south line of said section 383.35 feet; thence S $01^{\circ}50'18''$ E, 50 feet to the south line of said section 34; thence east to a point being 61 feet west of and 50 feet north of the northwest corner of Certified Survey Map 1978 recorded in the Kenosha County Register of Deeds Office as document number 1062134; thence South to a point being 50 feet South of the south line of said section; thence westerly parallel with and 50 feet south of the south line of said Section 34, 400 feet; thence north to the south line of said section; thence west along the south line of said section to the S $\frac{1}{4}$ corner of said Section 34; thence S $02^{\circ}48'51''$ E along the east line of the Northwest $\frac{1}{4}$ of Section 3, Town 1 North, Range 22 East of the Fourth Principal Meridian 60.06 feet; thence N $80^{\circ}12'18''$ W 56.3 feet to a point that is 50 feet south of the north line of the Northwest $\frac{1}{4}$ of Section 3; thence parallel with and 50 feet south of the north line of said section 501.48 feet; thence N $88^{\circ}26'59''$ W being 50 feet south of the centerline of 60th Street 344.72 feet; thence S $89^{\circ}33'19''$ W 1306.57 feet; thence N $02^{\circ}48'49''$ W 2 feet; thence S $89^{\circ}33'19''$ W 52.04 feet; thence S $02^{\circ}48'49''$ E 2 feet; thence S $89^{\circ}33'19''$ W 417.01 feet; thence S $87^{\circ}33'31''$ W, 144.07 feet; thence S $87^{\circ}33'31''$ W, 199.78 feet; thence S $89^{\circ}33'31''$ W, 312.19 feet; thence S $01^{\circ}10'48''$ E, 10 feet; thence S $89^{\circ}33'31''$ W, 100.01 feet; thence N $01^{\circ}10'48''$ W 120 feet; thence N $89^{\circ}33'31''$ E 100.01 feet; thence S $01^{\circ}10'48''$ E, 60 feet to the place of beginning. Said lands being in the Town of Somers, County of Kenosha, State of Wisconsin.

EXHIBIT B

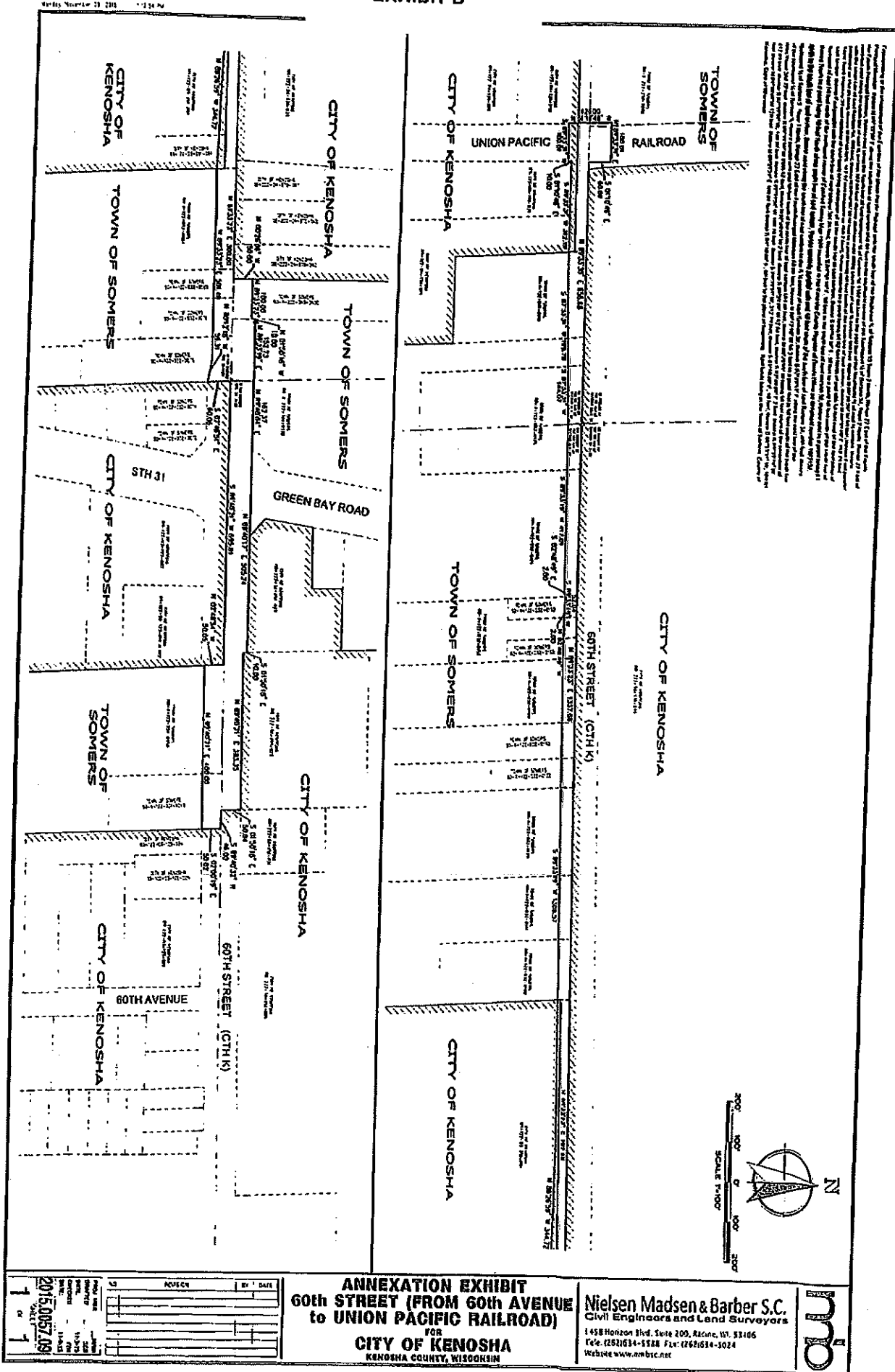

[Vertical text block containing legal descriptions and survey details, oriented vertically on the right side of the map.]

DATE	2015.09.27.09
PROJECT	ANNEXATION EXHIBIT
SCALE	1" = 100'
BY	
CHECKED	
DATE	

ANNEXATION EXHIBIT
60th STREET (FROM 60th AVENUE
to UNION PACIFIC RAILROAD)
FOR
CITY OF KENOSHA
 KENOSHA COUNTY, WISCONSIN

Nielsen Madsen & Barber S.C.
 Civil Engineers and Land Surveyors
 1458 Horizon Blvd., Suite 205, Racine, WI 53106
 Tel: (262)634-5528 Fax: (262)634-3024
 Website www.nmbc.net



RE: Attachment and Zoning District Classification Ordinance (Under Section 66.0307, Wisconsin Statutes, City of Kenosha/Town of Somers State Approved Cooperative Plan) for property West of 60th Avenue to the Union Pacific Railroad (CTH K - 60th Street ROW).

CERTIFICATE OF POPULATION

I, Debra L. Salas, City Clerk of the City of Kenosha, County of Kenosha, State of Wisconsin, do hereby certify that the population of the area so attached to the City of Kenosha with the passage of Kenosha Ordinance 46-15 is Zero (0).



Debra L. Salas
City Clerk

SEAL



RE: Attachment and Zoning District Classification Ordinance (Under Section 66.0307, Wisconsin Statutes, City of Kenosha/Town of Somers State Approved Cooperative Plan) for property West of 60th Avenue to the Union Pacific Railroad (CTH K - 60th Street ROW).

CERTIFICATE OF ATTACHMENT, SECTION 66.0217
WISCONSIN STATUTES

I, Debra L. Salas, City Clerk of the City of Kenosha, Wisconsin do hereby certify that on the 7th day of December, 2015, the Kenosha Common Council by Ordinance duly adopted, and did attach to the City of Kenosha, territory in the Town of Somers, KENOSHA COUNTY, WISCONSIN.

I further certify that attached thereto and made a part hereof is a true and correct copy of the legal description and plat of the territory so attached.

Dated this 21st day of December, 2015.



Debra L. Salas
City Clerk

SEAL