

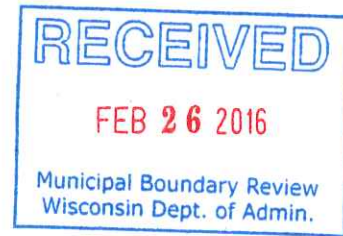

Debra L. Salas
City Clerk/Treasurer



February 22, 2016

Phil Wells, Program & Policy Analyst, Advanced
Wisconsin Department of Administration
Division of Intergovernmental Relations
Demographic Services Center
P.O. Box 8944
Madison WI 53708-8944

RE: Attachment and Zoning District Classification Ordinance (Under Section 66.0307, Wisconsin Statutes, City of Kenosha/Town of Somers State Approved Cooperative Plan), Parcel #80-4-222-294-0110 at 9407 38th Street (Harpe).

The City of Kenosha Common Council on December 21, 2015 adopted Ordinance 55-15 -by the Mayor - Attachment and Zoning District Classification Ordinance (Under Section 66.0307, Wisconsin Statutes, City of Kenosha/Town of Somers State Approved Cooperative Plan), Parcel #80-4-222-294-0110 at 9407 38th Street (Harpe).

Enclosed is a copy of said ordinance, including map and legal description of the territory, Certificate of Attachment and Certificate of Population relative to the above attachment.

Sincerely,

CITY OF KENOSHA

Debra L. Salas
City Clerk

ATTACHMENT AND ZONING DISTRICT CLASSIFICATION ORDINANCE
Under Section 66.0307, Wisconsin Statutes,
City of Kenosha/Town of Somers
State Approved Cooperative Plan

Parcel No(s): 80-4-222-294-0110

Located at: 9407 38th Street

Town of Somers
[Harpe, Property Owner]

ORDINANCE NO. 55-15

BY: THE MAYOR

THIS IS TO CERTIFY THAT THIS
IS A TRUE AND CORRECT COPY
OF THE RECORD ON FILE IN THE
OFFICE OF THE CITY CLERK
TREASURER, CITY OF KENOSHA
WISCONSIN

Raven August
Raven J. August 2/22/16
Deputy City Clerk
City of Kenosha

Attaching to the City of Kenosha, Wisconsin, territory in the Town of Somers, Kenosha County, Wisconsin, and providing zoning district classifications under Section 66.0307, Wisconsin Statutes, City of Kenosha/Town of Somers State Approved Cooperative Plan:

The Common Council of the City of Kenosha, Wisconsin, does ordain as follows:

Section One: **Territory Attached.** In accordance with City of Kenosha/Town of Somers Cooperative Plan under Section 66.0307 of the Wisconsin Statutes, approved by the Wisconsin Department of Administration, Intergovernmental Relations, Municipal Boundary Review, on August 8, 2005, the territory in the Town of Somers, Kenosha County, Wisconsin, with an associated population of one (1), described on the attached legal description, Exhibit "A", and map, Exhibit "B", is hereby attached to the City of Kenosha, Wisconsin, as hereinafter provided.

Section Two: Effect of Attachment. From and after December 21, 2015, the date of attachment, the territory described in Section One shall be a part of the City of Kenosha for any and all purposes provided by law, and all persons coming or residing within such territory shall be subject to all Ordinances, rules and regulations governing the City of Kenosha.

Section Three: Zoning District Classifications. The territory described in Section One, upon attachment, shall have the zoning district classifications shown on Exhibit "C". This zoning district classification shall be and remain in effect for the parcel of land described therein until this Zoning District Classification Ordinance is amended as prescribed in Section 62.23(7)(d), Wisconsin Statutes.

Section Four: Connection To City Utilities. The territory described in Section One shall, by submission of the Attachment Petition, require connection of existing and any future habitable buildings to municipal water and sewer, within the time limits established by Chapter 32 of the Code of General Ordinances for the City of Kenosha, Wisconsin.

Section Five: Severability. If any provision of this Ordinance is invalid or unconstitutional, or if the application of this Ordinance to any person or circumstances is invalid or unconstitutional, such invalidity or unconstitutionality shall not affect the other provisions or applications of this Ordinance which can be given effect without the invalid or unconstitutional provision or application.

Section Six: Effective Date. This Ordinance, the Attachment, and the Zoning District Classifications shall become effective upon passage and publication, as provided by law.

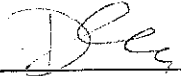
ATTEST:  _____ City Clerk
Debra L. Salas

APPROVED:  _____ Mayor Date: December 22, 2015
Keith G. Bosman

Passed: December 21, 2015

Published: January 1, 2016

Drafted By:
EDWARD R. ANTARAMIAN
City Attorney

EXHIBIT A

***Harpe Legal Description
Property at 9407 38th Street
Parcel #80-4-222-294-0110***

Exhibit drawing of land to be annexed by the CITY OF KENOSHA, being Lot 1 of Certified Survey Map Number 928, a parcel of land located in the West 1/2 of the Southeast 1/4 of Section 29, Town 2 North, Range 22 East, in the Town of Somers, County of Kenosha, State of Wisconsin, more fully described as follows:

Commencing at the East 1/4 corner of said Section 29; thence S89°14'03"W, along the North line of said 1/4, 1334.66 feet, to the Point of Beginning; thence S01°29'13"E, along the East line of the West 1/2 of said Southeast 1/4, 244.43 feet; thence S62°20'13"W 1482.89 feet; thence N01°43'18"W, along the West line of said Southeast 1/4 915.38 feet to the Center of said Section 29; thence continuing N01°43'18"W, 8.54 feet, to the South right-of-way line of Highway "S"; thence N89°46'42"E, along and upon the South line of said Highway, 899.07 feet; thence N89°14'03"E, along the North line of the Southeast 1/4, 435.78 feet, to the Point of Beginning. Subject to a public road right-of-way on the North.

EXHIBIT B

Harpe Attachment Map

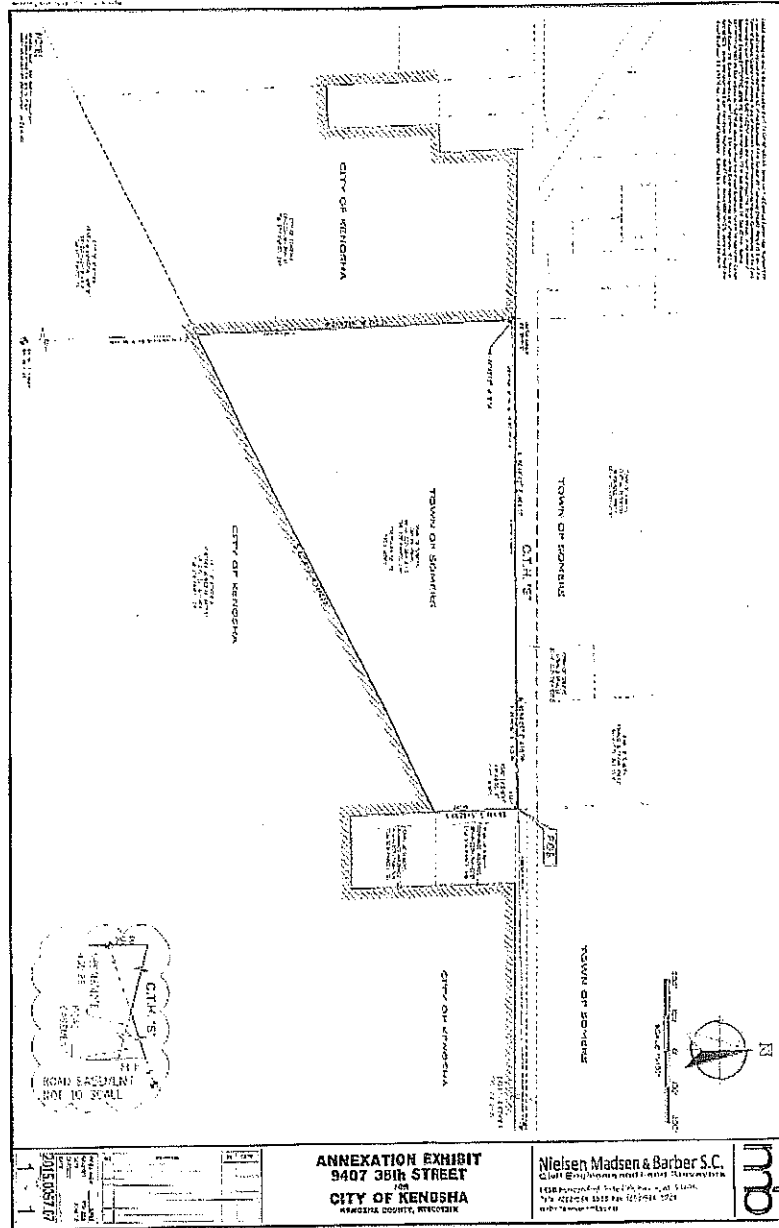

RE: Attachment and Zoning District Classification Ordinance (Under Section 66.0307, Wisconsin Statutes, City of Kenosha/Town of Somers State Approved Cooperative Plan), Parcel #80-4-222-294-0110 at 9407 38th Street (Harpe).

CERTIFICATE OF ATTACHMENT, SECTION 66.0217
WISCONSIN STATUTES

I, Debra L. Salas, City Clerk of the City of Kenosha, Wisconsin do hereby certify that on the 21st day of December, 2015, the Kenosha Common Council by Ordinance duly adopted, and did attach to the City of Kenosha, territory in the Town of Somers, KENOSHA COUNTY, WISCONSIN.

I further certify that attached thereto and made a part hereof is a true and correct copy of the legal description and plat of the territory so attached.

Dated this 21st day of December, 2015.



Debra L. Salas
City Clerk

SEAL

RE: Attachment and Zoning District Classification Ordinance (Under Section 66.0307, Wisconsin Statutes, City of Kenosha/Town of Somers State Approved Cooperative Plan), Parcel #80-4-222-294-0110 at 9407 38th Street (Harpe).

CERTIFICATE OF POPULATION

I, Debra L. Salas, City Clerk of the City of Kenosha, County of Kenosha, State of Wisconsin, do hereby certify that the population of the area so attached to the City of Kenosha with the passage of Kenosha Ordinance 55-15 is one (1).



Debra L. Salas
City Clerk

SEAL