

REVISED FILE ORDINANCE NO. 2019-761

**An ordinance annexing territory located in Section 12 of T.3N., R.12E. of the 4th P.M.,
Janesville Township, Rock County, Wisconsin.**

WHEREAS, a petition signed by the owner of the land within such territory proposed to be annexed has been filed with the City Clerk; and

WHEREAS, there are no electors residing in the territory; and

WHEREAS, the necessary notices have been duly prepared, provided and served as required by law to all persons affected; and

WHEREAS, this ordinance does not contain temporary zoning; and

WHEREAS, the Department of Administration has determined that the City of Janesville can provide municipal services to the annexing territory and that while the shape of the territory is found to be compact and regular, the use of road right-of-way as the sole means of connecting the territory to city boundaries does not establish contiguity pursuant to the Department's review; and

WHEREAS, the Department of Administration's review, as provided under s. 66.0217(6), is advisory to the Common Council; and

WHEREAS, the Common Council has determined that this annexation is in the public interest.

**NOW THEREFORE THE COMMON COUNCIL OF THE CITY OF JANESVILLE DO ORDAIN
AS FOLLOWS:**

SECTION I. The territory described as follows is hereby attached to the City of Janesville.

Located in the NE ¼ of the NE ¼ of Section 12, all in T.3N., R.12E of the 4th P.M., Janesville Township, Rock County, Wisconsin described as follows:

Commencing at an aluminum monument at the NE corner of Section 12; thence S.1°21'30"W 1105.38 feet to the SE corner of Lot 3, CSM 1730430, also being at the place of beginning for the land to be herein described; thence N.87°1'16"W 151.82 feet; thence N.0°31'13"W 361.00 feet; thence N.87°1'37"W 120.00 feet; thence S.0°33'28"E 401.00 feet to the centerline of Russell Road; thence S.0°33'28"E 33.00 feet to the south ROW line of Russell Road; thence S.87°1'16"E 310.20 m/l along the south ROW line to the centerline of Newville Road; thence S.90°E 36.15 feet m/l to the original East line of Newville Road also being the annexation boundary as referenced in ordinance 2004-226; thence N.0°48'31"W 75.00 feet m/l along said original East line; thence S.90°W 74.35 feet m/l to the place of beginning. Containing approximately 1.57 Acres.

SECTION II. After this annexation becomes effective, the above described property shall be exempt from and not subject to further taxation and assessments in the Town of Janesville and thence forth shall be subject to taxation and assessment as part of the City of Janesville for any and all purpose provided by law.

REVISED FILE ORDINANCE NO. 2019-761
PAGE 2

SECTION III. All the territory attached by this ordinance is hereby made part of Ward 35 of the City of Janesville.

SECTION IV. There are no residents in the area proposed for annexation.

SECTION V. The annexation is within the Milton School District.

SECTION VI. This ordinance shall take effect immediately upon adoption by the Common Council, the public health, welfare, peace, tranquility, good order, public benefit, and police power so requiring.

ADOPTED: September 9, 2019

APPROVED:

Mark A. Freitag, City Manager

ATTEST:



David T. Godek, City Clerk-Treasurer

APPROVED AS TO FORM:

Wald Klimczyk, City Attorney

Proposed by: Applicant
Prepared by: Planning Division

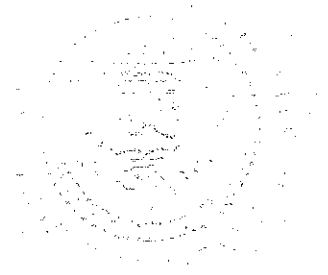
Motion by: Williams				
Second by: Conley				
Councilmember	Aye	Nay	Pass	Absent
Benson	X			
Conley	X			
Farrell	X			
Gruber	X			
Marklein	X			
Williams	X			
Wolfe	X			





CITY OF JANESVILLE CERTIFICATE OF ANNEXATION

STATE OF WISCONSIN)
SS.
COUNTY OF ROCK)

I, David T. Godek, City Clerk-Treasurer of the City of Janesville, Rock County, Wisconsin, do hereby certify that the following described territory was detached from the Town of Janesville, Rock County, Wisconsin, all pursuant to Section 66.0217(2) of the Wisconsin Statutes, by an ordinance adopted by the Common Council on September 9, 2019. The annexation petition is referenced in MBR file no. 14235.

PART OF JANESVILLE TOWNSHIP, ROCK COUNTY, WISCONSIN, DESCRIBED AS FOLLOWS:

SECTION I. The territory described as follows is hereby attached to the City of Janesville.

Located in the NE $\frac{1}{4}$ of the NE $\frac{1}{4}$ of Section 12, all in T.3N., R.12E of the 4th P.M., Janesville Township, Rock County, Wisconsin described as follows:

Commencing at an aluminum monument at the NE corner of Section 12; thence S.1°21'30"W 1105.38 feet to the SE corner of Lot 3, CSM 1730430, also being at the place of beginning for the land to be herein described; thence N.87°1'16"W 151.82 feet; thence N.0°31'13"W 361.00 feet; thence N.87°1'37"W 120.00 feet; thence S.0°33'28"E 401.00 feet to the centerline of Russell Road; thence S.0°33'28"E 33.00 feet to the south ROW line of Russell Road; thence S.87°1'16"E 310.20 m/l along the south ROW line to the centerline of Newville Road; thence S.90°E 36.15 feet m/l to the original East line of Newville Road also being the annexation boundary as referenced in ordinance 2004-226; thence N.0°48'31"W 75.00 feet m/l along said original East line; thence S.90°W 74.35 feet m/l to the place of beginning. Containing approximately 1.57 Acres.

SECTION II. After this annexation becomes effective, the above described property shall be exempt from and not subject to further taxation and assessments in the Town of Janesville and thence forth shall be subject to taxation and assessment as part of the City of Janesville for any and all purpose provided by law.

SECTION III. All the territory attached by this ordinance is hereby made part of Ward 35 of the City of Janesville.

SECTION IV. There are no residents in the area proposed for annexation.

SECTION V. The annexation is within the Milton School District.

SECTION VI. This ordinance shall take effect immediately upon adoption by the Common Council, the public health, welfare, peace, tranquility, good order, public benefit, and police power so requiring.

Ordinance 2019-761 was published in the Monday, September 16, 2019 edition of the Janesville Gazette Legal Ads.

Attached to this Certificate is a map showing the boundaries of the area so attached to the City of Janesville, which map is incorporated in and forms a part of this Certificate by reference.

Dated: September 26, 2019

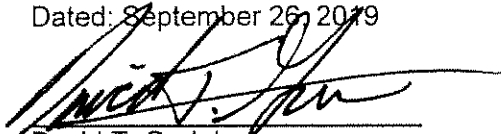
David T. Godek
City Clerk-Treasurer

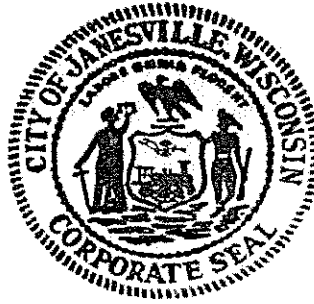

Ref:
MBR 14235
Ord. No. 2019-761

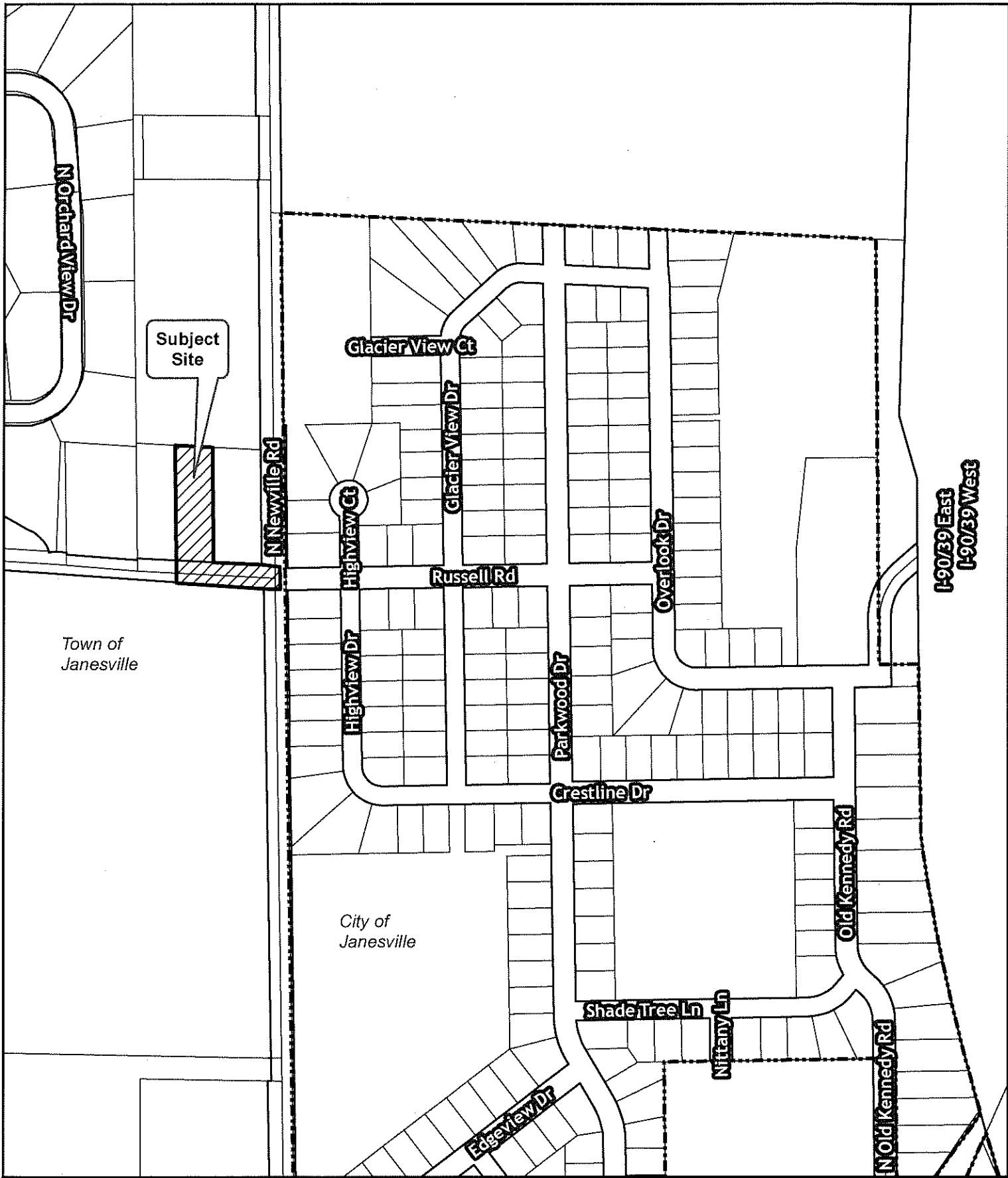

Subject Site



City of Janesville Boundary

N



Date: 7/16/19
Map Coordinate: M-23
1 inch = 400 feet

LOCATION / ZONING MAP

Annexation and Zoning to R1
925 Russell Road

MAP 1



CITY OF JANESVILLE
PLANNING DIVISION