



P.O. Box 197, Somers, WI 53171 • PH: (414) 221-1313

RECEIVED

July 27, 2021

Municipal Boundary Review
Wisconsin Dept. of Admin.

July 26, 2021

Erich Schmidtke
Wisconsin Department of Administration, Division of Intergovernmental Relations
Municipal Boundary Review
PO Box 1645
Madison, WI 53701

**RE: Attachment of Properties to the Village of Somers from the Town of Paris:
Parcel Nos: 45-4-221-131-0203; 45-4-221-131-0202; 45-4-221-131-0210; 45-4-221-131-0201; and 45-4-221-131-0301. The owner of these parcels is Enrico Moscani
Declaration of Trust.**

Dear Erich Schmidtke,

I, Mary A. Cole, Village Clerk for the Village of Somers, County of Kenosha, State of Wisconsin, **DO HEREBY CERTIFY** adoption of attachment Ordinance 20-011, adopted by the Village Board of the Village of Somers on November 24, 2020, thereby attaching Parcel Nos: 45-4-221-131-0203; 45-4-221-131-0202; 45-4-221-131-0210; 45-4-221-131-0201; and 45-4-221-131-0301 from the Town of Paris to the Village of Somers.

A certified copy of Ordinance 20-011 which contains an accurate metes and bounds description of the territory so affected and population identified in attached territory is one (1). The effective date of this Ordinance is December 28, 2020.

If you have any questions, please contact me at (262) 859-2822 or via email at mcole@somers.org

Sincerely,

Mary A. Cole
Village Clerk / Treasurer

Enclosure: Ordinance 20-011

ORDINANCE

Document Number

Document Title

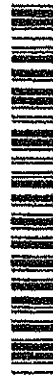

DOCUMENT

1886776

RECORDED

At Kenosha County, Kenosha WI 53140
JoEllyn H. Storz, Register of Deeds
December 28, 2020 11:49 AM
\$30.00

Pages 4

Recording Area

Name and Return Address
Village of Somers Clerk
PO Box 197
Somers, WI 53171

4

Parcel Identification Number (PIN)

This instrument was
drafted by

Attorney Jeffrey J.
Davison
Davison Law Office,
Ltd.

ORDINANCE NO. 20-011

AN ORDINANCE TO CREATE SECTION 29.01
OF THE CODE OF ORDINANCES OF THE VILLAGE OF SOMERS
REGARDING

The Village Board of Trustees of the Village of Somers, Kenosha County,

Wisconsin, hereby creates Section 29.01 of the Code of Ordinances of the Village of Somers relating to attachment of Enrico Mosconi Declaration of Trust property to read as follows:

29.01 ATTACHMENT OF ENRICO MOSCONI DECLARATION OF TRUST PROPERTY.

(A) **Request for Attachment.** On October 23, 2020, the Enrico Mosconi Declaration of Trust ("Owner"), declared its intent to file an attachment petition with the Village of Somers, Kenosha County, Wisconsin, requesting that the real property described in subsection (b), below, which property is owned by the Owner, be attached to the Village of Somers and from the Town of Paris, Kenosha County, Wisconsin, pursuant to Section 5.13 of the "2017 City of Kenosha/Village of Somers/Town of Somers/Town of Paris/County of Kenosha/Kenosha Water Utility/Village of Somers Water Utility/Village of Somers Sewerage District/County Highway Commissioner Cooperative Plan and Intergovernmental Agreement Under Sections 66.0301, 66.0305 and 66.0307, Wisconsin Statutes" as approved by the Wisconsin Department of Administration on November 10, 2017.

(B) **Description of Land to be Attached.**

Parcel 1:

Part of the Northeast Quarter of Section 13, Town 2 North, Range 21 East of the Fourth Principal Meridian, lying and being in the Town of Paris, Kenosha County, Wisconsin, and being more particularly described as. Beginning on the North line of said Quarter Section at a point North 89°38'12" East 330.00 feet from the Northwest corner thereof; thence North 89°38'12" East along the North line of said Quarter Section 1697.35 feet and to a point that is 626.76 feet Westerly from the Northeast corner of said Quarter Section; thence South 1°49'37" East parallel to the East line of said Quarter Section 208.50 feet, thence North 89°38'12" East 236.76 feet; thence South 1°49'37" East 534.00 feet; thence North 89°38'12" East 390.00 feet to the East line of said Quarter Section; thence South 1°49'37" East along said East line 581,045 feet and to the South line of the North Half of said Quarter Section; thence South 89°32'54.5" West along said South line 2658.06 feet and to the West line of said Quarter Section; thence North 1°39'09" West along said West line 666.555 feet and to a point that is 661.00 feet Southerly from the Northwest corner of said Quarter Section; thence North 89°38'12" East parallel to the North line of said Quarter Section 330.00 feet; thence North 1°39'09" West 661.00 feet to the point of beginning; subject to public highways over the

Northerly and Easterly 33 feet thereof. EXCEPTING THEREFROM lands conveyed for road purposes in Trustee's Deed recorded on November 7, 2008, as Document No. 1571979.

Parcel Nos.. 45-4-221-131-0203; 45-4-221-131-0202, 45-4-221-131-0210; Part of 45-4-221-131-0201
Address: Land situated along Frontage Road and 122nd Avenue

Parcel 2:

The South one-half of the Northeast Quarter of Section 13, in Town 2 North, Range 21 East of the Fourth Principal Meridian, lying and being in the Township of Paris, Kenosha County, Wisconsin, EXCEPTING THEREFROM the parcel conveyed to Kenosha County for highway purposes. ALSO EXCEPTING THEREFROM lands conveyed for road purposes in Trustee's Deed recorded on November 7, 2008, as Document No. 1571979.

Parcel Nos.: 45-4-221-131-0301; Part of 45-4-221-131-0201
Address: 1420 120th Avenue and 1242 122nd Avenue

(C) **Notice.** The Village has caused a notice to be forwarded to the Clerk of the Town of Paris and a photocopy of the petition for attachment of real property from the Town of Paris to the Village of Somers as described above pursuant to Section 5.13 of the referenced agreement.

(D) **Attachment.** The Village of Somers shall attach the territory described in subsection (B), above, consisting of approximately 135.35 acres more or less, pursuant to the 2017 City of Kenosha/Village of Somers/Town of Somers/Town of Paris/County of Kenosha/Kenosha Water Utility/Village of Somers Water Utility/Village of Somers Sewerage District/County Highway Commissioner Cooperative Plan and Intergovernmental Agreement Under Sections 66.0301, 66.0305 and 66.0307, Wisconsin Statutes" as approved by the Wisconsin Department of Administration on November 10, 2017.

(1) **Zoning.** The attached territory shall continue to be zoned A-1 Agricultural Preservation District and R-2 Suburban Single-Family Residential District under the Code of Ordinances of the Town of Paris, as may be amended from time to time.

(2) **Designation of ward.** For electoral purposes, the territory attached shall become part of the 13th ward of the Village of Somers, Wisconsin.

(3) **Clerk/Treasurer to act.** The Clerk/Treasurer of the Village shall file with the office of the Department of Administration a certified copy of this attachment ordinance. The Village Clerk/Treasurer shall record a certified copy of the ordinance with the Kenosha County Register of Deeds and file a signed copy of the attachment ordinance with the Clerk of any affected school district. For purposes of establishing population within the attached property as of the date of attachment, the resident population is one (1).

Dated at Somers, Wisconsin, this 24th day of November, 2020.



VILLAGE OF SOMERS

By: *George Stoner*
George Stoner, President

Attest: *Mary A. Cole*
Mary Ann Cole, Deputy Clerk/Treasurer

SCALE MAP
VILLAGE OF SOMERS ANNEXATION



EXISTING VILLAGE OF SOMERS



AREA OF TOWN OF PARIS TO ATTACH

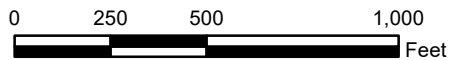
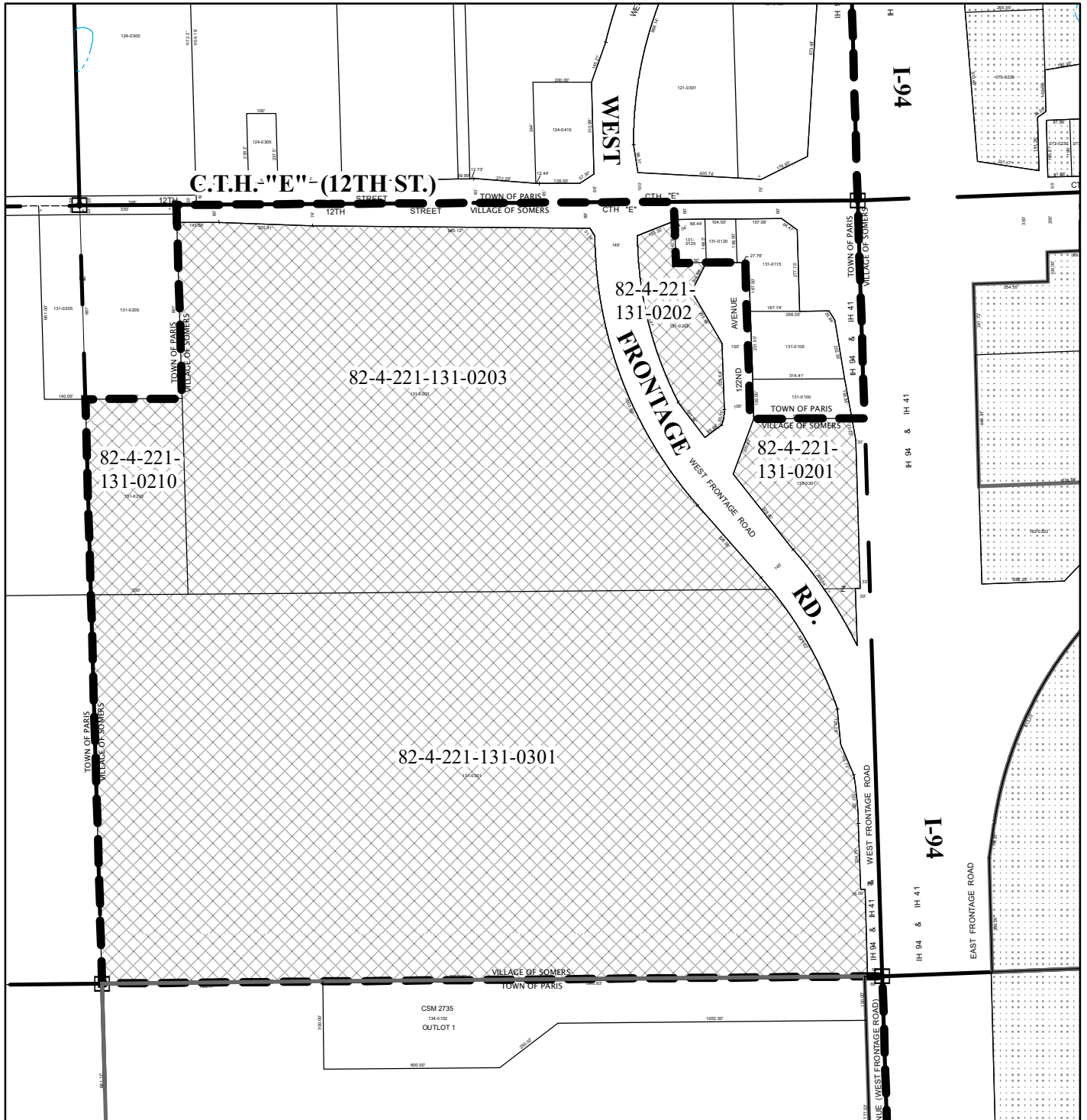

1 INCH = 500 FEET
 Map Created: August 2021

Kenosha County



Parcel #
82-4-221-131-0201
82-4-221-131-0202
82-4-221-131-0203
82-4-221-131-0210
82-4-221-131-0301

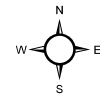

1 inch = 400 feet

THIS MAP IS NEITHER A LEGALLY RECORDED MAP NOR A SURVEY AND IS NOT INTENDED TO BE USED AS ONE. THIS DRAWING IS A COMPILATION OF RECORDS, DATA AND INFORMATION LOCATED IN VARIOUS STATE, COUNTY AND MUNICIPAL OFFICES AND OTHER SOURCES AFFECTING THE AREA SHOWN AND IS TO BE USED FOR REFERENCE PURPOSES ONLY. KENOSHA COUNTY IS NOT RESPONSIBLE FOR ANY INNACURACIES HEREIN CONTAINED. IF DISCREPANCIES ARE FOUND, PLEASE CONTACT KENOSHA COUNTY.

