



May 13, 2025

ORD11942

Wisconsin Department of Administration  
Municipal Boundary Review  
PO Box 1645  
Madison, WI 53701-1645

RECEIVED

05/13/2025

Municipal Boundary Review  
WI Dept. of Administration

Re: **Petition File No: 14751**

Dear MBR Team:

**ORDINANCE 1818-2025**  
**John & Mary Haese Annexation**

I, JoAnn Marcon, City Clerk of the City of Onalaska, County of La Crosse, State of Wisconsin, HEREBY CERTIFY the adoption of annexation Ordinance No. 1818-2025 on May 13, 2025; thereby annexing territory from the Town of Onalaska to the City of Onalaska.

A certified copy of Ordinance 1818-2025, annexation map and legal description are enclosed.

The population of the territory so affected is two (2).

The effective date of this Ordinance is May 13, 2025.

Sincerely,

JoAnn A. Marcon  
City Clerk

Enclosures

cc: Mary Rinehart, Clerk, Town of Onalaska  
Riverland Energy  
Charter Communications  
CenturyLink  
Metronet  
TDS Telecom  
Harter's Quick Clean Up  
Hilltopper Refuse & Recycling



415 Main Street | Onalaska, WI 54650 | (608) 781-9530 | [CityofOnalaska.com](http://CityofOnalaska.com)

**ORDINANCE NO. 1818-2025**

**AN ORDINANCE TO ANNEX LAND LOCATED IN PART OF THE NORTHEAST QUARTER OF THE SOUTHWEST QUARTER, AND BEING PART OF THE NORTHWEST QUARTER OF THE SOUTHEAST QUARTER, ALL IN SECTION 29, TOWNSHIP 17 NORTH, RANGE 7 WEST FROM THE TOWN OF ONALASKA TO THE CITY OF ONALASKA**

THE COMMON COUNCIL OF THE CITY OF ONALASKA DOES HEREBY ORDAIN AS FOLLOWS:

SECTION I. Proper petition for direct annexation by unanimous approval including a scale map, signed by all the owners of all real property in such territory and all of the electors residing in such territory, having been presented to the Common Council of the City of Onalaska, requesting the annexation of the territories described in Exhibit A which is attached hereto and incorporated herein to the City of Onalaska, Wisconsin from the Town of Onalaska, La Crosse County, Wisconsin. The population of the area annexed is two (2).

Notice has been provided to the Town of Onalaska. Investigation by the City of Onalaska discloses that as of this date the above representations are true and the Common Council accepts the petition as sufficient and determines that said annexation proceedings meet the requirements of Sec. 66.0217(2), Wis. Stat.

IT IS HEREBY ORDAINED that the above-described property is hereby annexed to the City of Onalaska, Wisconsin, and it is further ordained that the corporate limits of the City of Onalaska are hereby amended to include the above-described property within the corporate limits of the City of Onalaska, Wisconsin.

SECTION II. Sec. 2.01.13 of the Code of Ordinances of the City of Onalaska entitled Aldermanic District Boundaries is hereby amended to include the above-described properties within the boundaries of the 1st Aldermanic District, Ward 1.

SECTION III. The property is hereby zoned Low Density Residential (R-1) and all of the provisions of the Code of Ordinances of the City of Onalaska governing said zoning classification shall apply hereto.

SECTION IV. If any provision of this ordinance is invalid or unconstitutional, or if the application of this ordinance to any person or circumstances is invalid or unconstitutional, such invalidity or unconstitutionality shall not affect the other provisions or applications of this ordinance which can be given effect without the invalid or unconstitutional provision or application.

SECTION V. This Ordinance shall take effect and be in force from and after its passage.

Dated this 13<sup>th</sup> day of May, 2025.



CITY OF ONALASKA

By: \_\_\_\_\_

Kim Smith, Mayor

By: \_\_\_\_\_

JoAnn Marcon, Clerk

PASSED: 05/13/2025

APPROVED: 05/13/2025

PUBLISHED: 05/20/2025

# SURVEY MAP

OF LOT 7, BLOCK 3, STRAWBERRY COMMONS, TOWN OF ONALASKA, LA CROSSE COUNTY, WISCONSIN

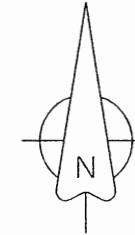

BEARINGS ARE REFERENCED TO THE EAST LINE OF BLOCK 3, STRAWBERRY COMMONS, WHICH IS ASSUMED TO BEAR NORTH 23°31'44" WEST.

JOHN HAESE PROPERTY DESCRIPTION  
Lot 7, Block 3, Strawberry Commons, Town of Onalaska, LaCrosse County, Wisconsin.

## LEGEND

● = FOUND MONUMENT AS NOTED  
(R.A.) = RECORDED AS

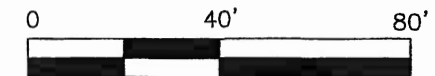

SCALE: 1" = 40'

GARY C. KAISER  
TERRI J. KAISER  
10-2379-0

LOT 6

(R.A. S 66°44'29" W 158.16')  
S 66°11'18" W 158.22'

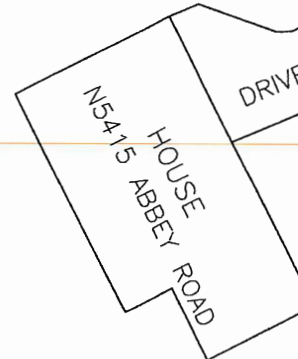

LOT 7

21,836.8 Sq. Feet  
(0.50 Acres)

TOWN OF ONALASKA

S 89°57'23" E 157.64'  
(R.A. N 89°48'01" W 157.40')  
TERRY J. WEILAND  
18-4511-2313

JEFFREY P. HAGGERTY  
10-2374-0

TOWN OF ONALASKA

ELH TRUST  
10-1021-29

S 00°48'16" E TOWN OF ONALASKA  
1330.66'

SOUTH QUARTER CORNER,  
SECTION 29, T17N, R7W  
COUNTY MONUMENT

I HEREBY CERTIFY THAT THIS SURVEY, PLAN  
OR REPORT WAS PREPARED BY ME OR UNDER  
MY DIRECT SUPERVISION AND IS CORRECT  
TO THE BEST OF MY KNOWLEDGE AND BELIEF.

STEPHEN M. HORTON, PLS 2706

DATE 8-1-2021



SURVEY FOR JOHN HAESE  
DATE DRAWN: 8/1/2021  
DATE SURVEYED: 4/20/2021  
FILE NAME: 17-8/Haese.dwg

HORTON SURVEYING  
N6183 JASON STREET  
ONALASKA, WI 54650  
(608) 780-7283  
email:  
surveyor.steve@yahoo.com

LEGAL DESCRIPTION

Lot 7, Block 3, Strawberry Commons, being part of the Northeast Quarter of the Southwest Quarter, and being part of the Northwest Quarter of the Southeast Quarter, all in Section 29, Township 17 North, Range 7 West, Town of Onalaska, La Crosse County, Wisconsin.