

13835

David Linskens

13835	Date Sent	Reply	Status
Town Quest	3/2	3/9	
Muni Quest	3/2	3/17	
Prop. Lister	3/2	3/3	

TOWN OF BUCHANAN
VILLAGE OF COMBINED LOCKS
03/22/2015

OK / COMMENTS 3/18/15

Request for Annexation Review

Wisconsin Department of Administration

WI Dept. of Administration
Municipal Boundary Review **13835**
101 E. Wilson Street, 9th Floor
Madison WI 53703
608-264-6102 Fax: 608-264-6104
wimunicipalboundaryreview@wi.gov
<http://doa.wi.gov/municipalboundaryreview/>

Petitioner Information

Name: **DAVID J LINSKENS**

Address: **N501 COUNTY RD HH**
KAUKAUNA WI 54130

Email:

Office use only:

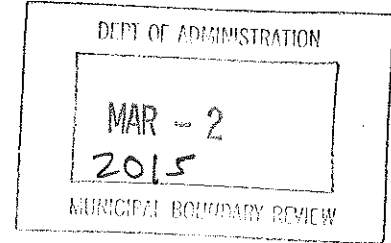

1. Town where property is located: **TOWN OF BUCHANAN**

2. Petitioned City or Village: **VILLAGE OF COMBINED LOCKS**

3. County where property is located: **OUTAGAMIE**

4. Population of the territory to be annexed: **1**

5. Area (in acres) of the territory to be annexed: **2.71**

6. Tax parcel number(s) of territory to be annexed
(if the territory is part or all of an existing parcel): **030 074100**

Petitioners phone:

920-766-9210

Town clerk's phone:

920-734-8599

City/Village clerk's phone:

920-788-7740

Contact Information if different than petitioner:

Representative's Name and Address:

Surveyor or Engineering Firm's Name & Address:

Phone:

Phone:

E-mail:

E-mail:

Required Items to be provided with submission (to be completed by petitioner):

- Legal Description meeting the requirements of s.66.0217 (1) (c) [see attached annexation guide]
- Map meeting the requirements of s. 66.0217 (1) (g) [see attached annexation guide]
- Signed Petition or Notice of Intent to Circulate is included
- Indicate Statutory annexation method used:
 - Unanimous per s. 66.0217 (2), or,
OR
 - Direct by one-half approval per s. 66.0217 (3)
- Check or money order covering review fee [see next page for fee calculation]

405 Wallace Street
Combined Locks, WI 54113

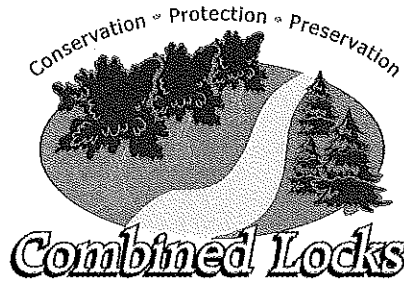

13835

Ph.: 920-788-7740
Fax: 920-788-7742

02/24/15

Wisconsin Department of Administration
Municipal Boundary Review
101 E Wilson St, 9th Floor
Madison WI 53703

To Whom It May Concern:

Enclosed is a copy of an annexation petition that was filed with the Village of Combined Locks on 02/20/15. The proposed annexation was filed by David J Linskens of N501 County Rd HH, Kaukauna WI 54130 and is by unanimous consent of the property owners and electors of the described lands. The parcel in the petition contains one homestead property.

The owner of this property wishes to annex in order to connect to municipal water and sewer because of a failing well.

Please feel free to contact me with any questions.

Best Regards,

Racquel Shampo-Giese
Racquel Shampo-Giese
Administrator/Clerk/Treasurer
Village of Combined Locks

PD CK # 5208 2/20/15
3/2 DAVID LINSKENS \$950

73835

PETITION FOR DIRECT ANNEXATION BY UNANIMOUS CONSENT PURSUANT TO
66.0217(2), Wis. Stats

I, the undersigned, constituting all of the owners of the real property and all of the electors in the following territory of the Town of Buchanan, Outagamie County, Wisconsin, lying contiguous to the Village of Combined Locks, petition the Village President and Village Board of said village to annex the territory described below and shown on the attached scale map, to the Village of Combined Locks. This is a petition for direct annexation by unanimous consent.

The current population of the territory petitioned for annexation is one (1).

THE PROPERTY PRESENTLY EXISTING IN THE TOWN OF BUCHANAN, OUTAGAMIE COUNTY, WISCONSIN, TO BE ANNEXED IS DESCRIBED AS FOLLOWS:

William Lamures Plat N208ft of E625ft of Lot 2 Less Highway, Town of Buchanan, Outagamie County, Wisconsin.

A scale map is attached hereto, showing the boundaries of the above described territory. The land to be annexed contains one single family dwelling.

I understand and agree that all of the costs associated with providing water and sewer service to the above described parcels, from the main to connection to the property, must be paid by the property owner, and is a condition of annexation.

Signature of Petitioner	Date of Signing	Owner/ Elector	Address
----------------------------	--------------------	-------------------	---------

<u>David J. Linkens</u>	<u>2-20-15</u>	<u>Owner</u>	<u>N501 County HHI Kaukauna, WI 54130</u>
-------------------------	----------------	--------------	---

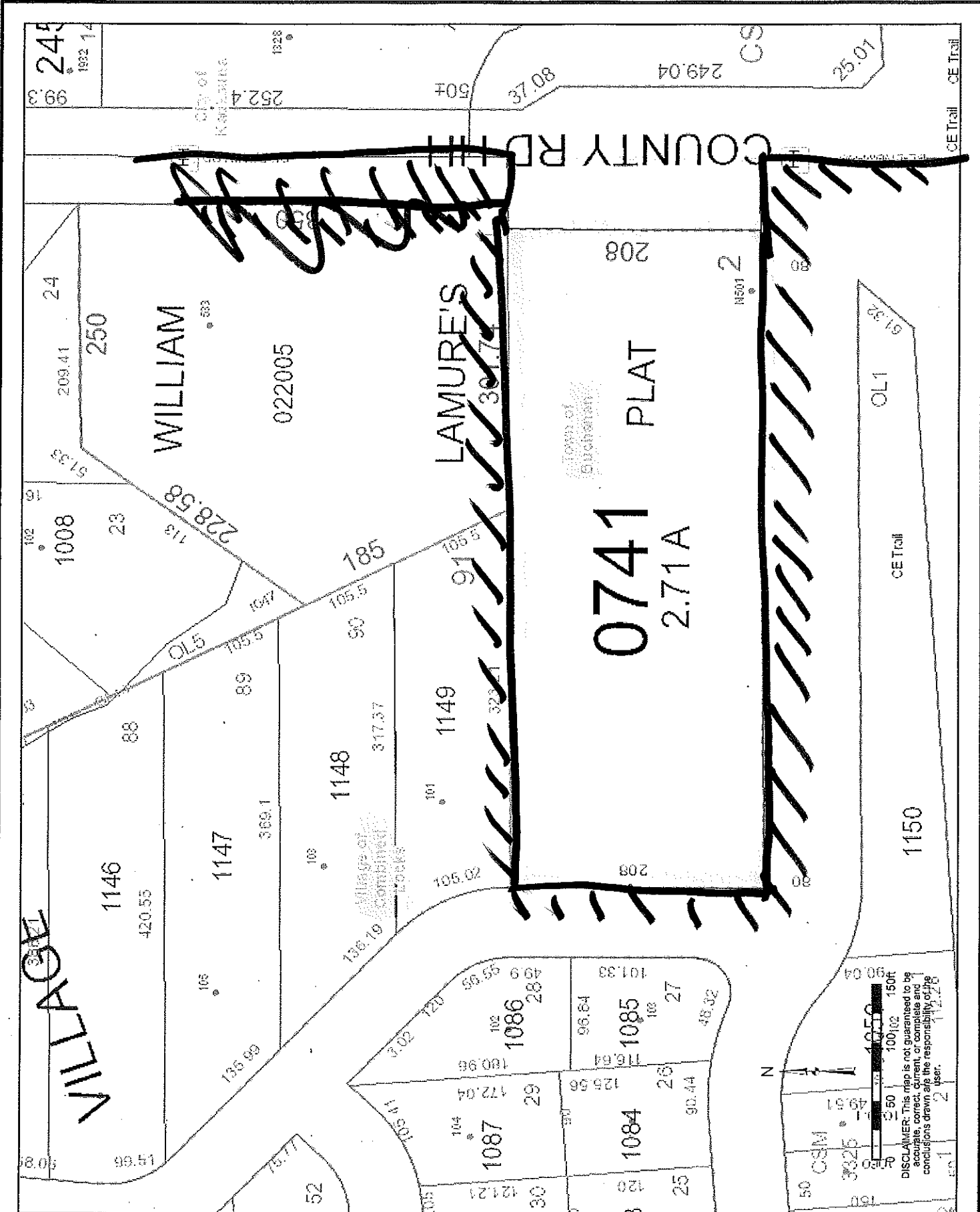



**WISCONSIN DEPARTMENT OF
ADMINISTRATION**

SCOTT WALKER
GOVERNOR
SCOTT A. NEITZEL
SECRETARY

Municipal Boundary Review
PO Box 1645, Madison WI 53701
Voice (608) 264-6102 Fax (608) 264-6104
Email: wimunicipalboundaryreview@wi.gov
Web: <http://doa.wi.gov/municipalboundaryreview/>

March 02, 2015

PETITION FILE NO. 13835

RACQUEL SHAMPO-GIESE, CLERK
VILLAGE OF COMBINED LOCKS
405 WALLACE ST
COMBINED LOCKS, WI 54113-1129

ANGELA GORALL, CLERK
TOWN OF BUCHANAN
N178 COUNTY RD N
APPLETON, WI 54915-9459

Subject: DAVID LINSKENS ANNEXATION

Section 66.0217 (6), Wis. Stats., provides that the annexation of lands to cities and villages within a county having a population of 50,000 or more shall be reviewed by the Department of Administration in order to determine if the proposed annexation is in the public interest or against the public interest. The proposed annexation from the TOWN OF BUCHANAN to the VILLAGE OF COMBINED LOCKS (see attached description) must be reviewed pursuant to the statute.

To assist us in making this determination, we urge that you promptly supply the data requested on the enclosed questionnaire (where possible) and return the questionnaire to the department.

The purpose of this questionnaire is to assist the department in determining "Whether the governmental services, including zoning, to be supplied to the territory could clearly be better supplied by the town...." The statute further stipulates that the department shall study the "shape of the proposed annexation and the homogeneity of the territory with the annexing municipality." In addition, we would appreciate receiving from you any comments or information bearing on governmental services or shape and homogeneity that would indicate whether the annexation is in or against the public interest.

Please return the questionnaire as soon as possible so that the information can be reviewed prior to the department's statutory deadline of March 22, 2015. Direct any questions and comments to Erich Schmidtke at (608) 264-6102. Thank you for your cooperation.

For additional information on annexation or other land use issues, visit our web site at <http://doa.wi.gov/municipalboundaryreview/>.

Sincerely,

Erich Schmidtke

Enclosures

Annexation Review Questionnaire

Wisconsin Department of Administration

WI Dept. of Administration
Municipal Boundary Review
101 E. Wilson Street, 9th Floor
Madison WI 53703
608-264-6102 Fax: 608-264-6104
wimunicipalboundaryreview@wi.gov
<http://doa.wi.gov/municipalboundaryreview/>

Petitioner: David Linskens

Petition Number: 13835

1. Territory to be annexed: From TOWN OF BUCHANAN To VILLAGE OF COMBINED LOCKS

2. Area (Acres): 2.71

3. Pick one: Property Tax Payments

OR Boundary Agreement

a. Annual town property tax on territory to be annexed:

\$ 598.33

a. Title of boundary agreement _____

b. Year adopted _____

b. Total that will be paid to Town

(annual tax multiplied by 5 years) \$ 2,991.65

c. Participating jurisdictions _____

d. Statutory authority (pick one)

c. Paid by: Petitioner City Village

s.66.0307 s.66.0225 s.66.0301

Other: _____

4. Resident Population: Electors: 2 Total: 2

5. Approximate present land use of territory:

Residential: _____% Recreational: _____% Commercial: _____% Industrial: _____%

Undeveloped: _____%

6. If territory is undeveloped, what is the anticipated use?

Residential: 100% Recreational: _____% Commercial: _____% Industrial: _____%

Other: _____%

Comments: Zoned general agriculture; rural residential use

7. Has a preliminary or final plat been submitted to the Plan Commission: Yes No

Plat Name: _____

8. What is the nature of land use adjacent to this territory in the city or village?

In the town?: General Agriculture

9. What are the basic service needs that precipitated the request for annexation?

Sanitary sewer Water supply Storm sewers

Police/Fire protection EMS Zoning

Other _____

10. Is the city/village or town capable of providing needed utility services?

City/Village Yes No Town Yes No

If yes, approximate timetable for providing service: City/Village Town

Sanitary Sewers immediately
or, write in number of years. _____

Water Supply immediately
or, write in number of years. _____

Will provision of sanitary sewers and/or water supply to the territory proposed for annexation require capital expenditures (i.e. treatment plant expansion, new lift stations, interceptor sewers, wells, water storage facilities)?

Yes No

If yes, identify the nature of the anticipated improvements and their probable costs: _____

11. Planning:

a. Do you have a comprehensive plan for the City/Village/Town? Yes No
Is this annexation consistent with your comprehensive plan? Yes No

Describe: _____

b. Annual appropriation for planning? \$ _____

c. How is the annexation territory now zoned? General Agriculture

d. How will the land be zoned and used if annexed? _____

12. Other relevant information and comments bearing upon the public interest in the annexation:

Prepared by: Town City Village

Name: Joel Gregozeski

Email: joelg@townofbuchanan.org

Phone: 920-734-8599

Date: 3-5-15

Please RETURN PROMPTLY to:

wimunicipalboundaryreview@wi.gov

Municipal Boundary Review

PO Box 1645, Madison WI 53701

Fax: (608) 264-6104

PETITION # 13835

REAL PROPERTY LISTERS ANNEXATION REVIEW

1. Territory to be annexed: <u>Parcel # 030 074100</u>	From Town of: <u>BUCHANAN</u>	To City/Village of: <u>COMBINED LOCKS</u>
2. Checklist: (Y) Yes; (N) No; (NA) Not applicable; (NC) Not checked		

Location and Position

- NA (1) Location description by government lot, recorded private claim, ¼ - ¼ section, section, township, range and county
- Y (2) Contiguous with existing village/city boundaries
- N (3) Creates an island area in Township (completely surrounded by city)
- N (4) Creates an island area in City (completely surrounded by town)

Petition and Map Information

- Y (1) Identify owner(s) of annexed land
- Y (2) Identify parcel ID numbers included in annexation.
- NA (3) Identify parcel ID numbers being split by annexation
- Y (4) North arrow
- Y (5) Graphic Scale
- Y (6) Streets and Highways shown and identified
- N (7) Legend
- Y (8) Total area/acreage of annexation

3. Other relevant information and comments:

Prepared by: RYAN BARRETT
Title: PROPERTY LISTER
Phone: 920-832-5666
Date: 2-3-2015

Please RETURN PROMPTLY to:
Municipal Boundary Review
101 E. Wilson Street, 9th Floor
Madison, WI 53702-0001
(608) 264-6102 (608) 267-6917 FAX
wimunicipalboundaryreview@wi.gov

Annexation Review Questionnaire

Wisconsin Department of Administration

WI Dept. of Administration
Municipal Boundary Review
101 E. Wilson Street, 9th Floor
Madison WI 53703
608-264-6102 Fax: 608-264-6104
wimunicipalboundaryreview@wi.gov
<http://doa.wi.gov/municipalboundaryreview/>

Petitioner: David Linskens

Petition Number: 13835

1. Territory to be annexed: From TOWN OF BUCHANAN To VILLAGE OF COMBINED LOCKS

2. Area (Acres): 2.71

3. Pick one: Property Tax Payments

OR Boundary Agreement

a. Annual town property tax on territory to be annexed:

\$ _____

a. Title of boundary agreement See attached document

b. Year adopted 2000

b. Total that will be paid to Town

(annual tax multiplied by 5 years): _____

c. Participating jurisdictions Buchanan Combined Lock

Darby Sanitary District

d. Statutory authority (pick one)

c. Paid by: Petitioner City Village

Other: _____

s.66.0307 s.66.0225 s.66.0301

4. Resident Population: | Electors: | Total: |

5. Approximate present land use of territory:

Residential: 100 % Recreational: _____ % Commercial: _____ % Industrial: _____ %

Undeveloped: _____ %

6. If territory is undeveloped, what is the anticipated use?

Residential: _____ % Recreational: _____ % Commercial: _____ % Industrial: _____ %

Other: _____ %

Comments: _____

7. Has a preliminary or final plat been submitted to the Plan Commission: Yes No

Plat Name: _____

8. What is the nature of land use adjacent to this territory in the city or village?

residential

In the town?: residential

9. What are the basic service needs that precipitated the request for annexation?

Sanitary sewer Water supply Storm sewers

Police/Fire protection EMS Zoning

Other _____

10. Is the city/village or town capable of providing needed utility services?

City/Village Yes No Town Yes No

If yes, approximate timetable for providing service: City/Village Town

Sanitary Sewers immediately
or, write in number of years. 1 year _____

Water Supply immediately
or, write in number of years. 1 year _____

Will provision of sanitary sewers and/or water supply to the territory proposed for annexation require capital expenditures (i.e. treatment plant expansion, new lift stations, interceptor sewers, wells, water storage facilities)?

Yes No

If yes, identify the nature of the anticipated improvements and their probable costs: _____

11. Planning:

- a. Do you have a comprehensive plan for the City/Village/Town? Yes No
Is this annexation consistent with your comprehensive plan? Yes No

Describe: _____

b. Annual appropriation for planning? \$ 5,000.00

c. How is the annexation territory now zoned? residential single family

d. How will the land be zoned and used if annexed? residential single family

12. Other relevant information and comments bearing upon the public interest in the annexation:

Prepared by: Town City Village

Name: Raquel Shampo-Giese

Email: gieser@combinedlocks.org

Phone: 920-788-7740

Date: 03/17/15

Please **RETURN PROMPTLY** to:

wimunicipalboundaryreview@wi.gov

Municipal Boundary Review

PO Box 1645, Madison WI 53701

Fax: (608) 264-6104



13835

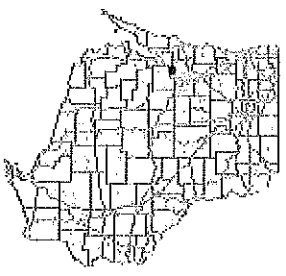

Legend

- Cities, Towns & Villages
- City
- Village
- Civil Town
- Rivers and Streams
- Open Water

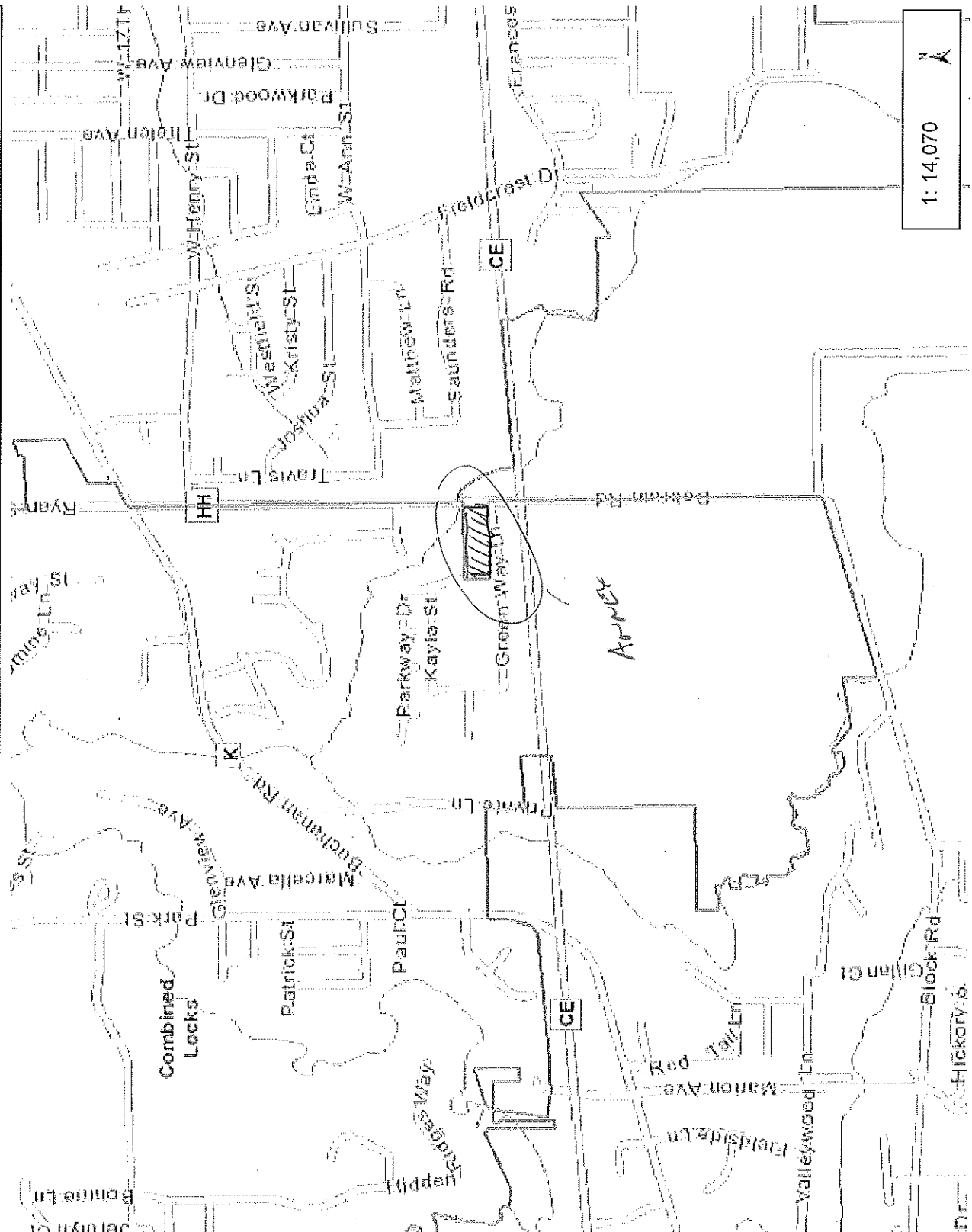

1: 14,070



Notes

DISCLAIMER: The information shown on these maps has been obtained from various sources, and are of varying age, reliability and resolution. These maps are not intended to be used for navigation, nor are these maps an authoritative source of information about legal land ownership or public access. No warranty, expressed or implied, is made regarding accuracy, applicability for a particular use, completeness, or legality of the information depicted on this map. For more information, see the DNR Legal Notices web page: <http://dnr.wis.gov/legal/>

0.4 Miles



0

0.22

0.4

NAD_1983_HARN_Wisconsin_TM
 © Latitude Geographics Group Ltd.



13835

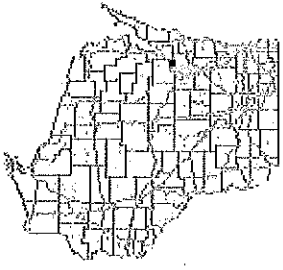

Legend

Cities, Towns & Villages



City



Village



Civil Town

2010 Air Photos (WFROC)



1: 3,518



DISCLAIMER: The information shown on these maps has been obtained from various sources, and are of varying age, reliability and resolution. These maps are not intended to be used for navigation, nor are these maps an authoritative source of information about legal land ownership or public access. No warranty, expressed or implied, is made regarding accuracy, applicability for a particular use, completeness, or legality of the information depicted on this map. For more information, see the DNR Legal Notices web page: <http://dnr.wi.gov/or/legal/>

NAD_1983_HARN_Wisconsin_TM
© Latitude Geographics Group Ltd.

Notes

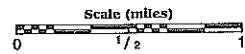
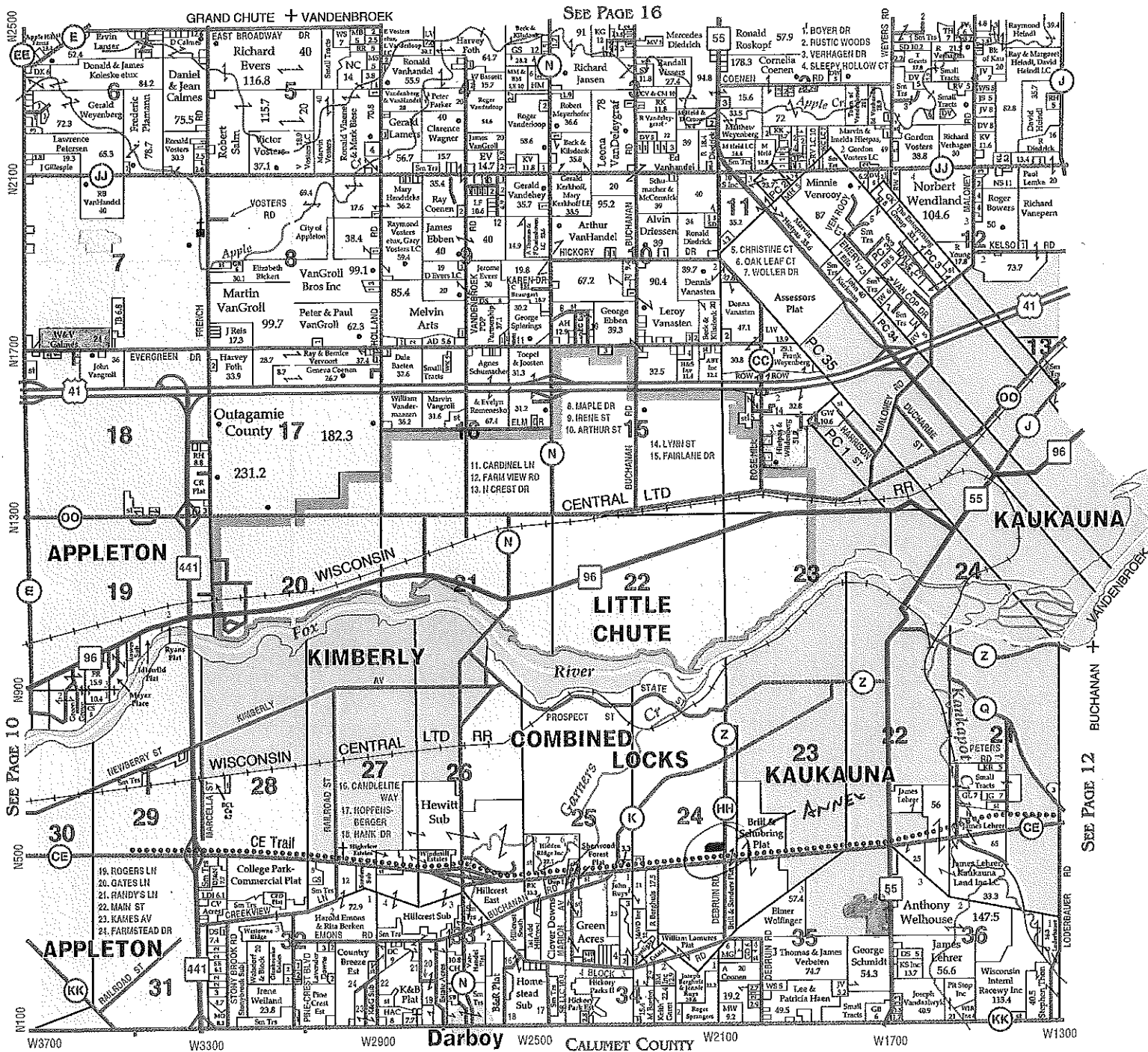
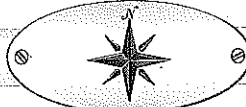

COONEN Grain Service, Inc.
A Family Business - Committed to Serving You!
 Manufacturers of Custom Proteins, Minerals & Feed Ration Balancing • Extrusion • Great Lakes Seeds
 Custom Combining • Drying & Storage • Pet & Lawn Supply
 • Experienced, Trained and Dedicated Staff •
 Corner of CE & DeBruin Roads
 N. 459 DeBruin Road • Kaukauna, WI 54130
 (920) 766-1472 or (800) 924-6649

CellphoneHELP™
 from CELLCO Publishing, Inc.
 Be prepared for ANY emergency situation, statewide! Get your TRAVEL SAFELY 911 Map & Emergency Cell Phone Directory today and have all the emergency phone numbers at your fingertips. It's color-coded for easy reference!
CALL (888) 791-9883

Village of
Combined
Locks

City of
Kaukauna

Town of
Buchanan

CE Trail

CE Trail

CE Trail

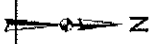

DISCLAIMER: This map is not guaranteed to be accurate, correct, current, or complete and constitutes neither a warranty nor the responsibility of the user.

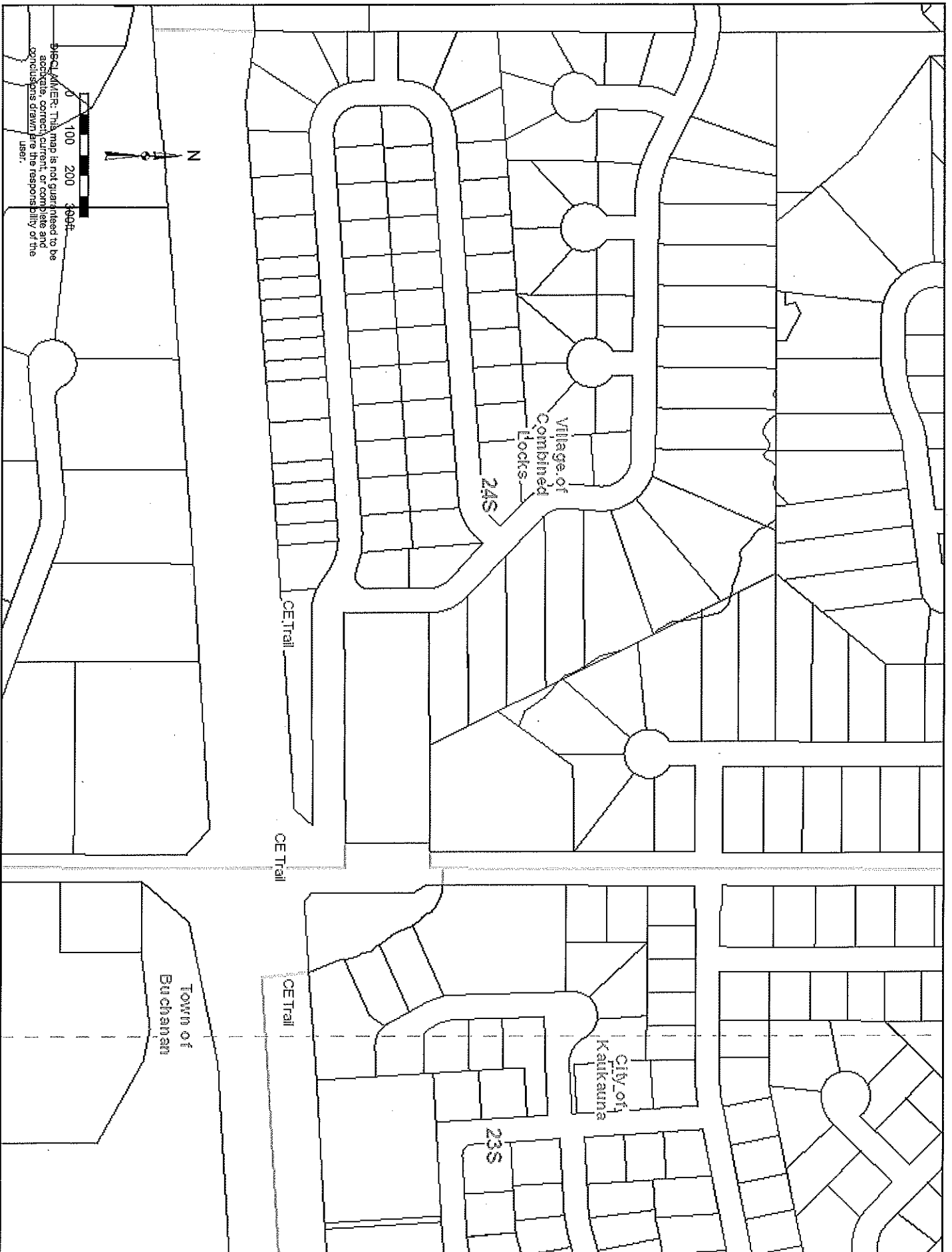

Village of
Combined
Locks

245S

City of
Kaukauna

235S

Town of
Buchanan

CE Trail

CE Trail

CE Trail



0 100 200 feet

DISCLAIMER: This map is not guaranteed to be accurate, correct, current, or complete and opinions drawn are the responsibility of the user.

Village of
Combined
Locks

24S

CE Trail

CE Trail

CE Trail

Town of
Buchanan

City of
Kaikauna

23S

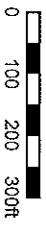

DISCLAIMER: This map is not guaranteed to be accurate, correct, current, or complete and conclusions drawn are the responsibility of the user.



**WISCONSIN DEPARTMENT OF
ADMINISTRATION**

SCOTT WALKER
GOVERNOR
SCOTT A. NEITZEL
SECRETARY

Municipal Boundary Review
PO Box 1645, Madison WI 53701
Voice (608) 264-6102 Fax (608) 264-6104
Email: wimunicipalboundaryreview@wi.gov
Web: <http://doa.wi.gov/municipalboundaryreview/>

March 18, 2015

PETITION FILE NO. 13835

RACQUEL SHAMPO-GIESE, CLERK
VILLAGE OF COMBINED LOCKS
405 WALLACE ST
COMBINED LOCKS, WI 54113-1129

JOEL GREGOZESKI, CLERK
TOWN OF BUCHANAN
N178 COUNTY RD N
APPLETON, WI 54915-9459

Subject: DAVID LINSKENS ANNEXATION

The proposed annexation submitted to our office on March 02, 2015, has been reviewed and found to be in the public interest. In determining whether an annexation is in the public interest, s. 66.0217 (6), Wis. Stats. requires the Department to examine "[t]he shape of the proposed annexation and the homogeneity of the territory with the annexing village or city and any other contiguous village or city...." so as unincorporated land transitions to city or village status, the resulting boundaries are rational and easy for jurisdictions and residents to follow. The subject petition is for territory that is reasonably shaped and contiguous to the **VILLAGE OF COMBINED LOCKS**.

Note: The existing municipal boundary must be clearly shown and identified on the scale map included with the ordinance that annexes this territory. (Ref: s. 66.0217 (1) (g), Wis. Stats.)

The Department reminds clerks of annexing municipalities of the requirements of s. 66.0217 (9)(a), Wis. Stats., which states:

"The clerk of a city or village which has annexed shall file immediately with the secretary of state a certified copy of the ordinance, certificate and plat, and shall send one copy to each company that provides any utility service in the area that is annexed. The clerk shall record the ordinance with the register of deeds and file a signed copy of the ordinance with the clerk of any affected school district..."

State and federal aids based on population and equalized value may be significantly affected through failure to file with the Secretary of State. Please file a copy of your annexing ordinance, including a statement certifying the population of the annexed territory. **Please also include the MBR number with your ordinance as this assists with record keeping. Your MBR number is: 13835**

The address of the Office of the Secretary of State is:

Annexations and Railroads
Division of Government Records
Office of the Secretary of State
PO Box 7848
Madison WI 53707-7848

Please call me at (608) 264-6102, should you have any questions concerning this annexation review.

Sincerely,

Erich Schmidtke, Municipal Boundary Review

cc: petitioner