

July 19, 2024

Bryce Hembrook, AICP
Planner - City of Marshfield Development Services
207 W. 6th Street
Marshfield, WI 54449

Dear Mr. Hembrook,

This letter is a request to petition the City of Marshfield for annexation of 1.96 acres, currently in the Town of McMillan.

The property's street address is:

111250 W. McMillan Street
Marshfield, WI 54449

The legal description is:

Sec. 32, T26N, R3E
SEC 32-26-03 PT OF SE ¼ SW ¼ -
CSM VOL 14 PG 284
(#3986) (DOC# 845381)

The parcel number is: 05626033230980; currently a residential property, with a population of two. We request direct annexation by unanimous approval.

Also submitted with this document:

- Certified Scale Map,
- Copy of WI Department of Administration request for annexation review,
- Application fee = \$2238.40 (447.68 Net Tax 2023 paid to Town of McMillan x 5).

We have submitted the WI Annexation review online and paid the filing and review fees online, as well.

We have mailed copies of the Wisconsin document and this petition to:

Town of McMillan
Donna Siltala – Treasurer
113904 Elm Tree Rd
Marshfield, WI 54449-5275.

This request is on behalf of my mother, Nancy L. Rakovec, and her signature is below.

Sincerely,



Wendy L. Eron

jweron@wctc.net

715-570-7076

3121 North Avenue

Wisconsin Rapids, WI 54495



Nancy L. Rakovec

Property Owner

715-387-2622

I, John M. Scheibe, Registered Land Surveyor, hereby certify that in full compliance with the provisions of Chapter 236.34 of the Wisconsin Statutes and the Town of McMillan Subdivision Control Ordinance and under the direction of John Rakovec, I have prepared this Certified Survey; that such Certified Survey correctly represents the exterior boundaries and that this land is located in the SE $\frac{1}{4}$ -SW $\frac{1}{4}$ of Section 32, Township 26 North, Range 3 East, Town of McMillan, Marathon County, Wisconsin, to-wit:

Commencing at the Southeast corner of the SW $\frac{1}{4}$ of said Section;

Thence S89°-59'-43" W, along the South line of said SW $\frac{1}{4}$, 386.49 feet to the Westerly right-of-way line of the abandoned Chicago & Northwestern Railroad;

Thence N24°-45'-20" E, along the aforementioned line, 36.34 feet to the North line of McMillan Street;

Thence S89°-59'-43" W, along the North line of said McMillan Street, 651.40 feet to the point of beginning;

Thence continuing S89°-59'-43" W, 286.51 feet to the West line of the SE $\frac{1}{4}$ -SW $\frac{1}{4}$ of said Section;

Thence N1°-21'-43" W, along the West line of said SE $\frac{1}{4}$ -SW $\frac{1}{4}$, 295.08 feet;

Thence N89°-59'-43" E, parallel with the North line of said McMillan Street, 293.50 feet;

Thence S0°-00'-17" E, perpendicular to the North line of said McMillan Street, 295.00 feet to the point of beginning.

MARCH 6, 1986
Date

John M. Scheibe
John M. Scheibe, R.L.S., S-918
Perry-Carrington Engineering Corporation
8598 Highway 10
Marshfield, WI 54449

Drafted by: Daniel C. Schuh

REGISTERS OFFICE
Marathon County, Wis. }
Received for Record this _____ A.D. 19____
day of _____
at _____ o'clock _____ M and recorded
in Vol. # 171 of G.S.M.
on page 284
Sharon de Seis
Register



86 MAR 7 AM 9 44

845381

Annexation Review Questionnaire

Wisconsin Department of Administration

WI Dept. of Administration
Municipal Boundary Review
PO Box 1645
Madison WI 53701
608-264-6102 Fax: 608-264-6104
wimunicipalboundaryreview@wi.gov
<http://doa.wi.gov/municipalboundaryreview>

Petitioner: **Rakovec**

Petition Number: **14686**

1. Territory to be annexed: From **TOWN OF MCMILLAN** To **CITY OF MARSHFIELD**

2. Area (Acres): 1.96

3. Pick one: Property Tax Payments

OR Boundary Agreement

a. Annual town property tax on territory to be annexed:

\$ 447.68

a. Title of boundary agreement _____

b. Year adopted _____

b. Total that will be paid to Town

(annual tax multiplied by 5 years): 2,238.40

c. Participating jurisdictions _____

d. Statutory authority (pick one)

c. Paid by: Petitioner City Village

s.66.0307 s.66.0225 s.66.0301

Other: _____

4. Resident Population: Electors: 1,376 Total: 2,081

5. Approximate **present land use** of territory:

Residential: _____% Recreational: _____% Commercial: _____% Industrial: _____%

Undeveloped: _____%

6. If territory is undeveloped, what is the **anticipated use**?

Residential: _____% Recreational: _____% Commercial: _____% Industrial: _____%

Other: _____%

Comments: _____

7. Has a preliminary or final plat been submitted to the Plan Commission: Yes No

Plat Name: _____

8. What is the **nature of land use adjacent** to this territory in the city or village?

residential, agricultural, agricultural forest

In the town?: Yes

9. What are the **basic service needs** that precipitated the request for annexation?

Sanitary sewer Water supply Storm sewers

Police/Fire protection EMS Zoning

Other _____

10. Is the city/village or town capable of providing needed utility services?

City/Village Yes No Town Yes No

If yes, approximate timetable for providing service: City/Village Town

<u>Sanitary Sewers</u> immediately	<input type="checkbox"/>	<input type="checkbox"/>
or, write in number of years.	_____	_____
<u>Water Supply</u> immediately	<input type="checkbox"/>	<input type="checkbox"/>
or, write in number of years.	_____	_____

Will provision of sanitary sewers and/or water supply to the territory proposed for annexation require capital expenditures (i.e. treatment plant expansion, new lift stations, interceptor sewers, wells, water storage facilities)?

Yes No

If yes, identify the nature of the anticipated improvements and their probable costs: _____

11. Planning & Zoning:

a. Do you have a comprehensive plan for the City/Village/Town? Yes No
Is this annexation consistent with your comprehensive plan? Yes No

b. How is the annexation territory now zoned? Residential _____

c. How will the land be zoned and used if annexed? _____

12. Elections: New ward or Existing ward? Will the annexation create a new ward or join an existing ward? For more information, please contact the Wisconsin Election Commission at (608) 266-8005, elections@wi.gov or see their annexation checklist here: <http://elections.wi.gov/forms/el-100>

13. Other relevant information and comments bearing upon the public interest in the annexation:

Prepared by: Town City Village

Name: JOHN COKL

Email: CLERK@TOWNOFMCMILLAN.GOV

Phone: 715-389-1338

Date: 7/30/24

Please **RETURN PROMPTLY** to:

wimunicipalboundaryreview@wi.gov

Municipal Boundary Review

PO Box 1645, Madison WI 53701

Fax: (608) 264-6104

(March 2018)



Surface Water Data Viewer Map

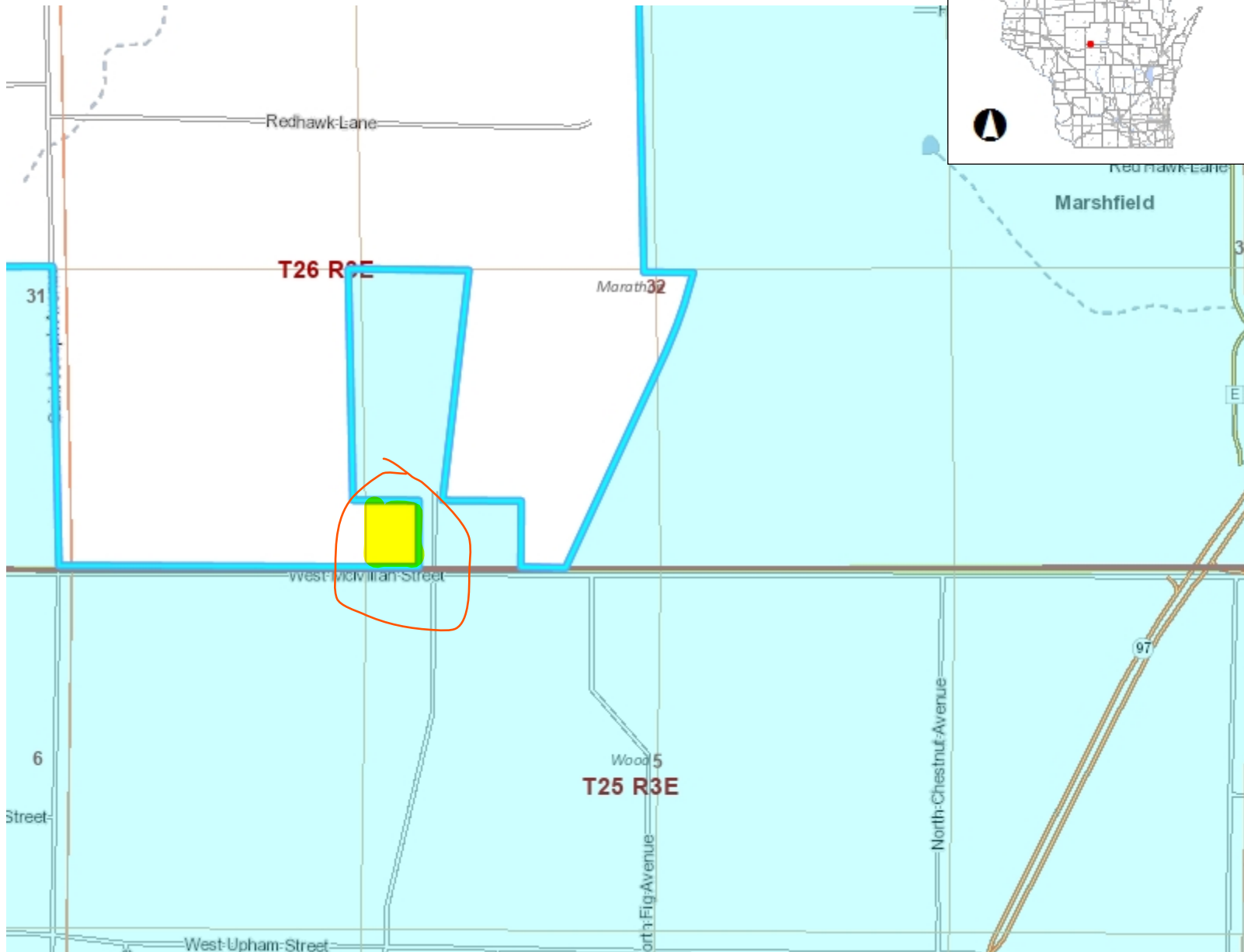

- Legend**
- Township
 - Section
 - Quarter-Quarter
 - County Boundary
 - Cities, Towns & Villages**
 - City
 - Village
 - Civil Town
 - Municipality
 - State Boundaries
 - County Boundaries
 - Major Roads**
 - Interstate Highway
 - State Highway
 - US Highway
 - County and Local Roads**
 - County HWY
 - Local Road
 - + Railroads
 - Tribal Lands
 - Rivers and Streams
 - Intermittent Streams
 - Lakes and Open water

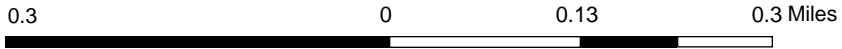

NAD_1983_HARN_Wisconsin_TM

1: 7,920

DISCLAIMER: The information shown on these maps has been obtained from various sources, and are of varying age, reliability and resolution. These maps are not intended to be used for navigation, nor are these maps an authoritative source of information about legal land ownership or public access. No warranty, expressed or implied, is made regarding accuracy, applicability for a particular use, completeness, or legality of the information depicted on this map. For more information, see the DNR Legal Notices web page: <http://dnr.wi.gov/legal/>

Notes

Township No 26 N, Range No 3 East 4th Mer.

Township Range & Crossed Mer.

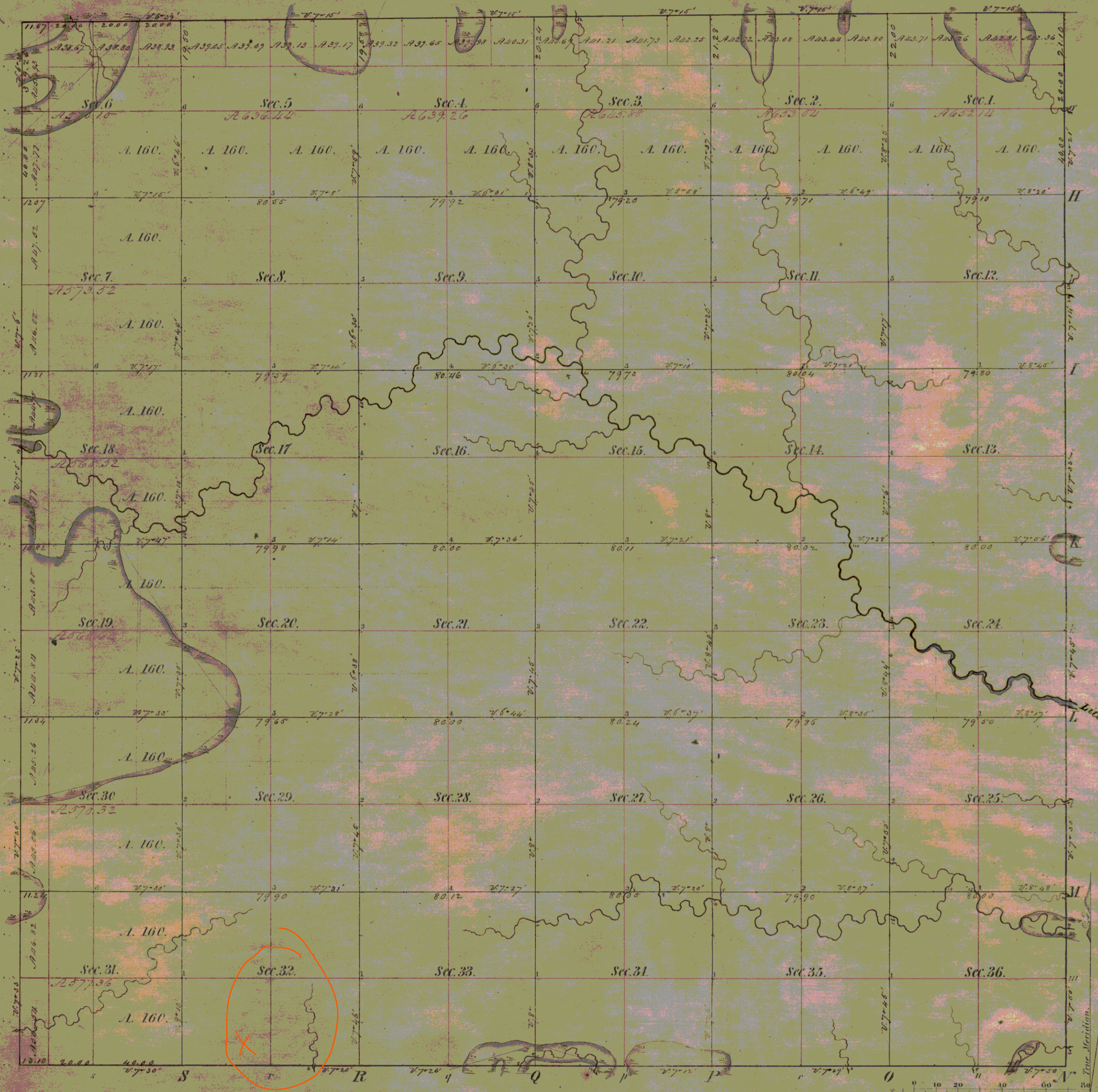

124.60

Meanders of								
Posts	Courses	Ch. Lk.	Posts	Courses	Ch. Lk.	Posts	Courses	Ch. Lk.

Total number of Acres *22655.33*

Surveys Designated	By Whom Surveyed	Date of Contract	Amount of Surveys	When Surveyed	When p ^d for and ch ^d in the Sur ['] Gen ['] acc [']
Township lines	<i>John D. Bryan</i>	<i>May 9th 1857</i>	<i>M. Ch^{'s} 1ks</i>	<i>Sept 4 & Oct 1857</i>	
Subdivisions	<i>Oscar J. Wright</i>	<i>Sept 14th 1853</i>	<i>59,36.81</i>	<i>Nov 1853</i>	

The above Map of Township No 26 North of Range No 3 East of the 4th Principal Meridian State of Wisconsin is strictly conformable to the field notes of the survey thereof on file in this Office, which have been examined and approved.

Surveyor General's Office.
Delugus H. Hays
 Sur. Genl.



TONY EVERS

GOVERNOR

KATHY BLUMENFELD

SECRETARY

Municipal Boundary Review

PO Box 1645, Madison WI 53701

Voice (608) 264-6102 Fax (608) 264-6104

Email: wimunicipalboundaryreview@wi.gov

Web: <http://doa.wi.gov/municipalboundaryreview>

August 07, 2024

PETITION FILE NO. 14686

JESSICA SCHIFERL, CLERK
CITY OF MARSHFIELD
207 W 6TH ST
MARSHFIELD, WI 54449-4138

JOHN COKL, CLERK
TOWN OF MCMILLAN
113904 ELM TREE ROAD
MARSHFIELD, WI 54449-5275

Subject: RAKOVEC ANNEXATION

The proposed annexation submitted to our office on July 19, 2024, has been reviewed and found to be in the public interest. In determining whether an annexation is in the public interest, s. 66.0217 (6), Wis. Stats. requires the Department to examine "[t]he shape of the proposed annexation and the homogeneity of the territory with the annexing village or city..." so as, to ensure the resulting boundaries are rational and compact. The statute also requires the Department to consider whether the annexing city or village can provide needed municipal services to the territory. The subject petition is for territory that is reasonably shaped and contiguous to the City of Marshfield, which is able to provide needed municipal services.

Note: The scale map of the territory to be annexed must clearly show and identify the existing City of Marshfield municipal boundary in relation to the territory.

The Department reminds clerks of annexing municipalities of the requirements of s. 66.0217 (9)(a), Wis. Stats., which states:

"The clerk of a city or village which has annexed shall file immediately with the secretary of administration a certified copy of the ordinance, certificate and plat, and shall send one copy to each company that provides any utility service in the area that is annexed. The clerk shall record the ordinance with the register of deeds and file a signed copy of the ordinance with the clerk of any affected school district..."

State and federal aids based on population and equalized value may be significantly affected through failure to file with the Department of Administration. Please file a copy of your annexing ordinance, including a statement certifying the population of the annexed territory. **Please include your MBR number 14686 with your ordinance.** Ordinance filing checklist available at <http://mds.wi.gov/>, click on "Help on How to Submit Municipal Records". Email scanned copy of required materials (color scan maps with color) to mds@wi.gov or mail to: Wisconsin Department of Administration, Municipal Boundary Review, PO Box 1645, Madison WI 53701-1645.

The petition file is available for viewing at: <http://mds.wi.gov/View/Petition?ID=2760>
Please call me at (608) 264-6102, should you have any questions concerning this annexation review.

Sincerely,

Erich Schmidtke, Municipal Boundary Review

cc: petitioner