

**PETITION FOR DIRECT ANNEXATION PURSUANT
TO WIS. STAT. §66.0217(2)**

The undersigned Richard M. Butler and Denise A. Butler, who are the owners in fee simple absolute of the following described property, now petition the City of Boscobel to detach the territory from the Town of Boscobel and annex the same into the City of Boscobel:

Part of the NW ¼ of the NE ¼ of Section 35, T8N, R3W of the 4th P.M., Grant County, Wisconsin, described as follows, to-wit: Commencing at the North Quarter corner of said Section 35; thence East 1336.50 feet; thence South 00° 43' West 836.00 feet; thence North 74° 30' West 213.40 feet; thence South 13° 47' West 33.00 feet to the point of beginning; thence South 13° 47' West 100.00 feet; thence North 74° 30' West 100.00 feet; thence North 13° 47' East 100.00 feet to the right-of-way of County Trunk Highway "M"; thence South 74° 30' East 100.00 feet along said right-of-way to the point of beginning.

The population of the territory is 2.

Your petitioners request that this property be made part of the R-1 Single Family Residential District under the City's Zoning Ordinance.

The reason for this requested annexation is that the septic system serving the residence on the property is failing and cannot be replaced; the Town has no sewer or water system; the City will be able to provide water and sewer services to the premises; the City's ordinance will maintain the property's residential status; and the City can also provide police services.

The territory is contiguous to the City and is situated in a residential neighborhood.

The premises are currently used for single family residential purposes.

Dated this 05 day of Sept., 2018.

Richard M. Butler
Richard M. Butler

Denise A. Butler
Denise A. Butler

Annexation of Territory from Town of Boscobel to City of Boscobel, Grant County, WI

Territory Annexed. The legal description of the property being annexed is as follows:

Part of the Northwest Quarter (NW $\frac{1}{4}$) of the Northeast Quarter (NE $\frac{1}{4}$) of Section 35, T8N, R3W of the 4th P.M., Town of Boscobel, Grant County, Wisconsin, described as follows, to-wit:

Commencing at the North Quarter corner of said Section 35; thence East 1336.50 feet; thence South 00° 43' West 836.00 feet; thence North 74° 30' West 213.40 feet; thence South 13° 47' West 33.00 feet to the point of beginning; thence South 13° 47' West 100.00 feet; thence North 74° 30' West 100.00 feet; thence North 13° 47' East 100.00 feet to the right-of-way of County Trunk Highway "M"; thence South 74° 30' East 100.00 feet along said right-of-way to the point of beginning.

Grant County Tax Parcel: 006-00337-0000.

Total Acres: approximately 0.23 acres

REAL PROPERTY LISTERS ANNEXATION REVIEW

1. Territory to be annexed: Part NW1/4 NE1/4 Sec 35...	From Town of: Boscobel	To City/Village of: Boscobel
---	---------------------------	---------------------------------

2. Checklist: (Y) Yes; (N) No; (NA) Not applicable; (NC) Not checked

Location and Position

Y (1) Location description by government lot, recorded private claim, ¼ - ¼ section, section, township, range and county

Y* (2) Contiguous with existing village/city boundaries

N** (3) Creates an island area in Township (completely surrounded by city)

N*** (4) Creates an island area in City (completely surrounded by town)

Petition and Map Information

Y (1) Identify owner(s) of annexed land

Y (2) Identify parcel ID numbers included in annexation.

N/A (3) Identify parcel ID numbers being split by annexation

Y (4) North arrow

Y (5) Graphic Scale

Y (6) Streets and Highways shown and identified

Y**** (7) Legend

Y (8) Total area/acreage of annexation

3. Other relevant information and comments: *Property across the County Road is under the City of Boscobel. **Parcels to the West, South, and East are under the Township. ***Parcels to West, South, and East are under the Township; but Parcels to the North of County Road are under the City. ****Only for City Boundary depiction.

Per Doc #799047 recorded in the Register of Deed’s Office on 12/18/2018, parcel #6-337 was already annexed to the City under parcel #206-337. Since this parcel was effective as of 1/1/2019 in our system, taxes have been paid to the City with each tax bill that has been generated. Since the Ordinance was recorded with the Register of Deed’s Office, and there were no issues with the legal description provided, the acreage listed, and the ownership names listed, the document was processed as recorded and as stated/requested in Section III of that Ordinance.

Prepared by: Tammy Hampton _____ Title: Deputy Clerk/Real Property Lister _____ Phone: 608-723-2666 _____ Date: 4/7/2025 _____	Please RETURN PROMPTLY to: Municipal Boundary Review PO Box 1645 Madison WI 53701 (608) 264-6102 FAX (608) 264-6104 wimunicipalboundaryreview@wi.gov
---	---

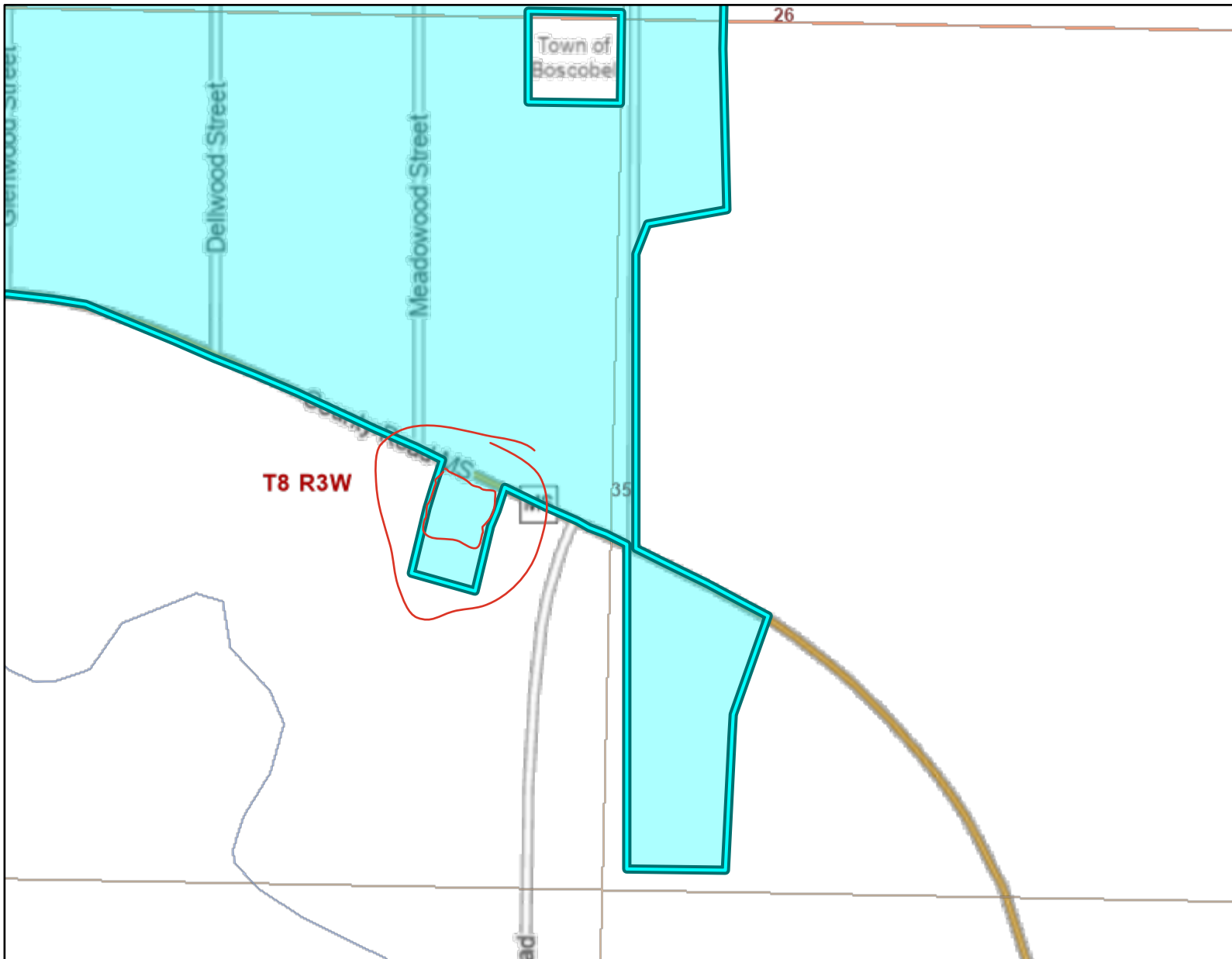

Legend: (some map layers may not be displayed)

- Rivers and Streams
- Intermittent Streams
- 24K Streams and Rivers
- Township
- Section
- Quarter-Quarter
- Cities, Towns & Villages**
- City
- Civil Town
- County Boundaries
- County and Local Roads**
- County HWY
- Local Road

Notes:

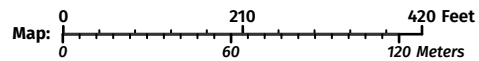

Service Layer Credits:
Cadastral: , Cities, Roads & Boundaries: , Surface Water (Cached): WiDNR, USGS, and other data

Map projection: NAD 1983 HARN Wisconsin TM

This map is a product generated by a DNR web mapping application.

This map is for informational purposes only and may not have been prepared for or be suitable for legal, engineering, or surveying purposes. The user is solely responsible for verifying the accuracy of information before using for any purpose. By using this product for any purpose user agrees to be bound by all disclaimers found here: <https://dnr.wisconsin.gov/legal>

Date Printed: 4/23/2025 7:45 AM



TONY EVERS

GOVERNOR

KATHY BLUMENFELD

SECRETARY

Municipal Boundary Review

PO Box 1645, Madison WI 53701

Voice (608) 264-6102 Fax (608) 264-6104

Email: wimunicipalboundaryreview@wi.gov

Web: <http://doa.wi.gov/municipalboundaryreview>

April 24, 2025

PETITION FILE NO. 14752

PATRICIA SMITH, CLERK
CITY OF BOSCOBEL
1006 WISCONSIN AVENUE
BOSCOBEL, WI 53805-1532

COURTNEY ROUNDS, CLERK
TOWN OF BOSCOBEL
5931 W BLUFF STREET
BOSCOBEL, WI 53805-1607

Subject: BUTLER ANNEXATION

The proposed annexation submitted to our office on April 03, 2025, has been reviewed and found to be in the public interest. In determining whether an annexation is in the public interest, s. 66.0217 (6), Wis. Stats. requires the Department to examine "[t]he shape of the proposed annexation and the homogeneity of the territory with the annexing village or city..." so as, to ensure the resulting boundaries are rational and compact. The statute also requires the Department to consider whether the annexing city or village can provide needed municipal services to the territory. The subject petition is for territory that is reasonably shaped and contiguous to the City of Boscobel, which is able to provide needed municipal services.

Note: The City should include the adjacent County Highway MS right-of-way for contiguity of the annexation territory with the City, as petitioner's scale map is ambiguous as to whether the roadway is included.

The Department reminds clerks of annexing municipalities of the requirements of s. 66.0217 (9)(a), Wis. Stats., which states:

"The clerk of a city or village which has annexed shall file immediately with the secretary of administration a certified copy of the ordinance, certificate and plat, and shall send one copy to each company that provides any utility service in the area that is annexed. The clerk shall record the ordinance with the register of deeds and file a signed copy of the ordinance with the clerk of any affected school district..."

State and federal aids based on population and equalized value may be significantly affected through failure to file with the Department of Administration. Please file a copy of your annexing ordinance, including a statement certifying the population of the annexed territory. **Please include your MBR number 14752 with your ordinance.** Ordinance filing checklist available at <http://mds.wi.gov/>, click on "Help on How to Submit Municipal Records". Email scanned copy of required materials (color scan maps with color) to mds@wi.gov or mail to: Wisconsin Department of Administration, Municipal Boundary Review, PO Box 1645, Madison WI 53701-1645.

The petition file is available for viewing at: <http://mds.wi.gov/View/Petition?ID=2826>

Please call me at (608) 264-6102, should you have any questions concerning this annexation review.

Sincerely,

A handwritten signature in black ink, appearing to read "Erich Schmidtke". The signature is fluid and cursive, with a prominent initial "E".

Erich Schmidtke, Municipal Boundary Review

cc: petitioner