

CITY OF RIVER FALLS

PIERCE & ST. CROIX COUNTIES

ANNEXATION ORDINANCE NO. 1999-13
& PLAT MAP

OFFICE OF THE SECRETARY OF STATE
State of Wisconsin

FILED OCTOBER 27, 1999

City of River Falls

C 121

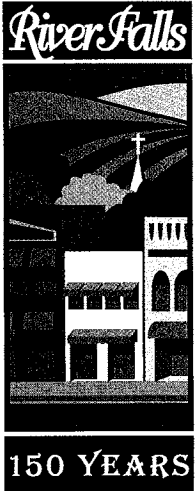

1848 - 1998

123 East Elm Street
River Falls, WI 54022
Phone: (715)425-0900
Fax: (715)425-0915

October 25, 1999

Secretary of State
P.O. Box 7848
Madison, WI 53707-7848

Dear Sir or Madam:

Enclosed you will find the certified copies of annexation ordinances and maps of annexed areas.

<u>Ordinance #</u>	<u>Property Owners</u>
1999-13	School District of River Falls
1999-14	Norman & Natalie Kusilek
1999-15	Nathan Rasmussen, et al
1999-16	Warren B. & Jeanette Leonard Family Trust
1999-17	Betty J. Finstad & Norbet J. Florian
1999-18	Richard & Judith Wallin
1999-19	Jonathan D. & Laurel T. Langford

Thank you.

Sincerely,

A handwritten signature in cursive script that reads "Lu Ann Hecht".

Lu Ann Hecht CMC
Deputy City Clerk

Enclosures

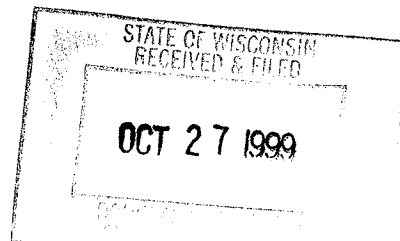

ORDINANCE NO. 1999-13

AN ORDINANCE ANNEXING TERRITORY
TO THE CITY OF RIVER FALLS

(School District of River Falls)

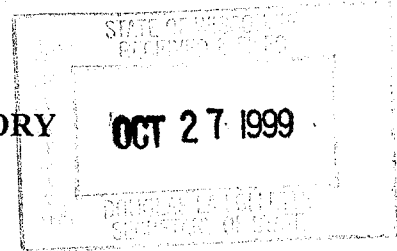

**THE COMMON COUNCIL OF THE CITY OF RIVER FALLS, WISCONSIN,
DOES HEREBY ORDAIN AS FOLLOWS:**

Section 1. A Territory Annexed. In accordance with Section 66.021 of the Wisconsin Statutes, the following described parcel lying adjacent to the existing corporate limits of the City of River Falls, is hereby annexed to the City of River Falls, Wisconsin, to wit:

A PARCEL OF LAND LOCATED IN THE SW 1/4 OF SECTION 7, T27N, R18W, TOWN OF RIVER FALLS, PIERCE COUNTY, WISCONSIN, DESCRIBED AS FOLLOWS: COMMENCING AT THE W 1/4 CORNER OF SAID SECTION 7; THENCE S0°30'44"W (ASSUMED BEARING) 1213.98' ALONG THE WEST LINE OF SAID SW 1/4 TO THE POINT OF BEGINNING; THENCE S89°37'54"E 431.21' (PREVIOUSLY RECORDED AS 430.00'); THENCE N0°30'44"E 1215.07' TO THE EAST-WEST 1/4 LINE OF SAID SECTION 7; THENCE S89°46'36"E ALONG SAID LINE 1560.39'; THENCE S00°30'44"W 532.15'; THENCE N87°52'46"W 220.64'; THENCE S0°30'44"W 180.49'; THENCE S87°52'46"E 220.64'; THENCE S0°30'44"W 686.74'; THENCE N89°04'02"W 408.82'; THENCE S4°14'55"W 1183.43'; THENCE N89°59'05"W 660.81'; THENCE N15°53'44"W 286.53'; THENCE N27°34'36"W 219.27'; THENCE N38°26'50"W 328.39'; THENCE N57°28'40"W 161.14'; THENCE N80°45'48"W 321.28'; THENCE N0°30'43"E 501.19' ALONG SAID WEST LINE OF THE SW 1/4 TO THE POINT OF BEGINNING.

CONTAINS 80.27 ACRES SUBJECT TO CEMETERY ROAD RIGHT-OF-WAY OVER THE NORTHERLY PORTION THEREOF.

SUBJECT TO EASEMENTS OF RECORD.

Section 2. Effective Annexation. From and after the effective date of this ordinance, a territory described in Section 1 above shall be part of the City of River Falls, Pierce County, Wisconsin, for any and all purposes provided by law. Said property being annexed from the Town of River Falls. Further, the annexed property shall be attached to Ward 8, District 2 of the City of River Falls.

Section 3. Costs to be Assessed to Annexation. From and after the effective date of annexation the benefiting property owners shall be assessed for improvements as outlined in the Annexation Agreement and per Section 8.09 (1-10), where improvements are not specifically installed by the developer.

CERTIFIED A TRUE AND CORRECT COPY OF
THE ORIGINAL THEREOF.

Laura Heck
CLERK, CITY OF RIVER FALLS
PIERCE & CROIX COUNTIES, WISCONSIN

DATED THIS 25 DAY OF 10 1999

Section 4. Zoning Classification. From and after the effective date of this ordinance, the territory described in Section 1 above shall be zoned (R1), Single Family (low density) Residence.

Section 5. Effective Date. This ordinance shall take effect from and after its passage publication as provided by law.

FOR THE CITY OF RIVER FALLS



Cecil D. Bjork, Mayor

ATTEST:

Julie Bergstrom, City Clerk

	<u>Aye</u>	<u>Nay</u>
Beebe	<u>x</u>	_____
Dravis	<u>x</u>	_____
Frey	<u>x</u>	_____
Graham	<u>x</u>	_____
Kittelson	<u>x</u>	_____
Mulhollam	<u>x</u>	_____
O'Connell	<u>x</u>	_____

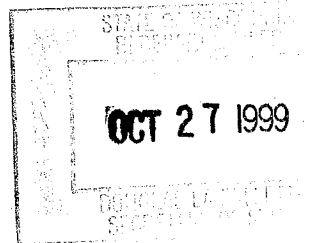
Adopted: August 24, 1999
Published: September 16, 1999



CERTIFIED A TRUE AND CORRECT COPY OF THE ORIGINAL THEREOF.

L. Ann Hecht, Deputy Clerk
CLERK, CITY OF RIVER FALLS
PIERCE & ST. CROIX COUNTIES, WISCONSIN

DATED THIS 25 DAY OF 10 1999

CITY OF RIVER FALLS

Scale: 1" = 2000'

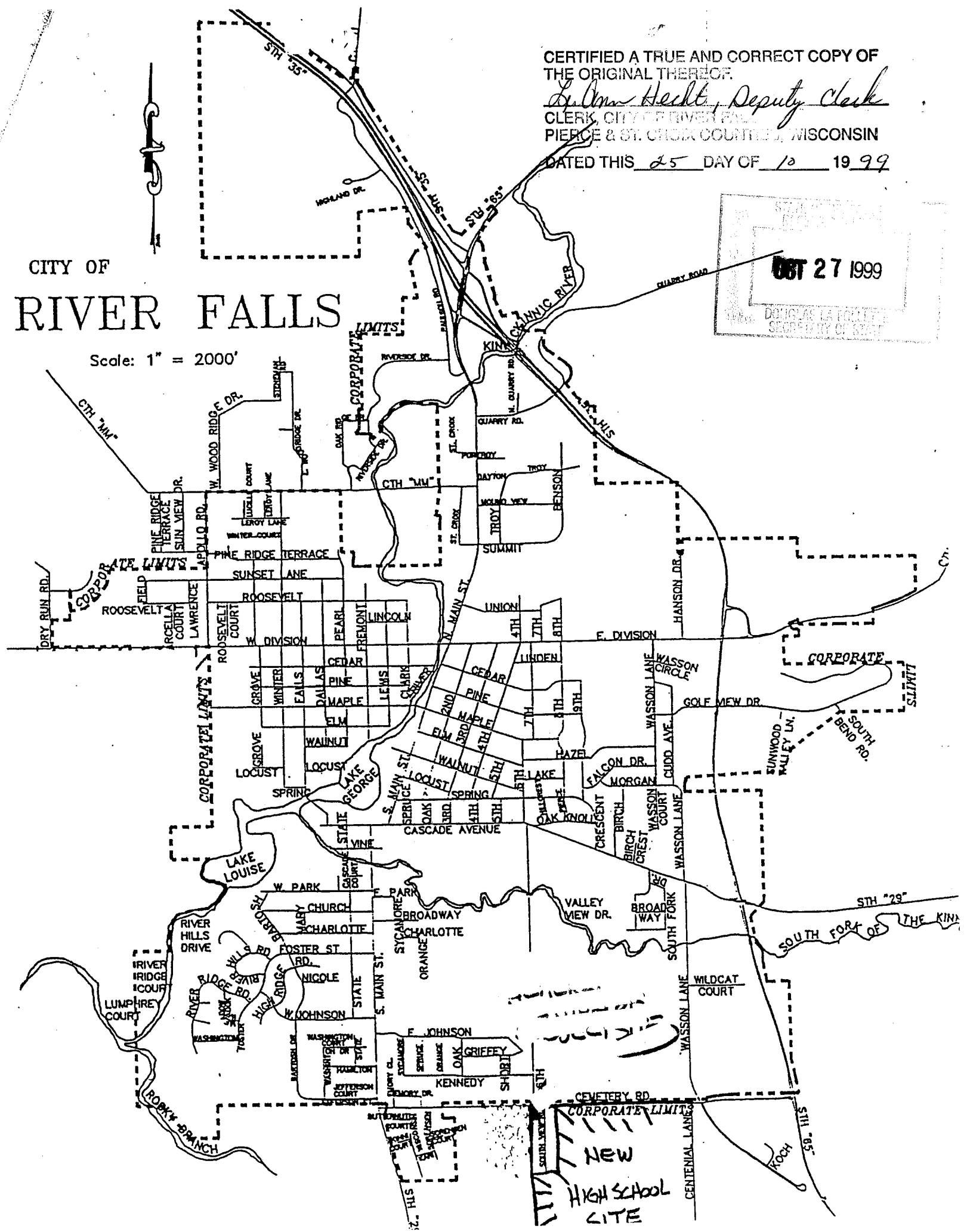
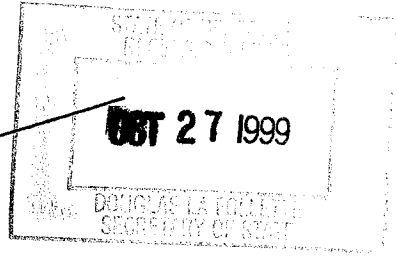

CERTIFICATION AS TO ANNEXATION OF TERRITORY
TO THE CITY OF RIVER FALLS, WISCONSIN

CITY OF RIVER FALLS

COUNTIES OF PIERCE & ST. CROIX

	EFFECTIVE DATE	ANNEXED TOWN	COUNTY OF ANNEXED TOWN	POPULATION INVOLVED
Published	<u>09/16/99</u>	<u>River Falls</u>	<u>Pierce</u>	<u>0</u>
Adopted	<u>08/24/99</u>			
	<u> </u>	<u> </u>	<u> </u>	<u> </u>
	<u> </u>	<u> </u>	<u> </u>	<u> </u>
	<u> </u>	<u> </u>	<u> </u>	<u> </u>

I, HEREBY CERTIFY THAT INFORMATION PROVIDED ON THIS FORM IS
CORRECT TO THE BEST OF MY KNOWLEDGE.

Signature *Lu Ann Hecht, Deputy*
City Clerk

Address of Clerk 123 E. Elm Street
River Falls, WI 54022
715-425-0900

