

CITY OF RHINELANDER

COUNTY OF ONEIDA

ANNEXATION ORDINANCE #30-00  
& PLAT MAP

---

**OFFICE OF THE SECRETARY OF STATE**  
**State of Wisconsin**

FILED SEPTEMBER 27, 2000

---

TELEPHONE 715 / 365-8607

FAX # 715 / 365-8630

E-MAIL clktreas@newnorth.net

C15

CITY OF RHINELANDER

CITY HALL

DEBORAH J. BREIVOGEL

CITY CLERK / TREASURER

135 SOUTH STEVENS STREET

P.O. BOX 658

RHINELANDER, WISCONSIN 54501

September 25, 2000

Doug La Follette  
Secretary of State  
Government Records  
P.O. Box 7848  
Madison, Wisconsin 53707

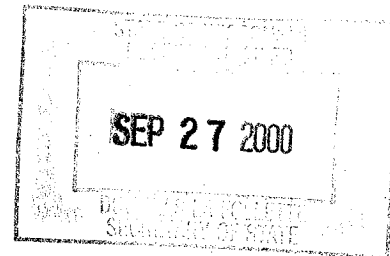

Dear Mr. La Follette:

In accordance with Section 66.021, Wisconsin Statutes, please find enclosed a certificate of annexation for Ordinances 30-00 of the City of Rhineland, Oneida County, Wisconsin, together with five each original executed annexation ordinances and maps showing the property annexed.

Very truly yours,

CITY OF RHINELANDER

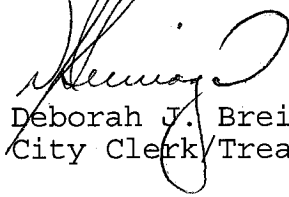
  
Deborah J. Breivogel  
City Clerk/Treasurer

/DJB

Enc.

CITY OF RHINELANDER

CITY HALL

DEBORAH J. BREIVOGEL

CITY CLERK / TREASURER

135 SOUTH STEVENS STREET

P.O. BOX 658

RHINELANDER, WISCONSIN 54501

**CERTIFICATE TO ANNEXATION**

I, DEBORAH J. BREIVOGEL, CITY CLERK IN AND FOR THE CITY OF RHINELANDER, ONEIDA COUNTY, WISCONSIN, do hereby certify that the attached described territory was detached from the Town of Crescent, Oneida County, Wisconsin, pursuant to Section 66.021, Wisconsin Statutes, as adopted by ordinance by the Rhinelander Common Council on August 14, 2000. I do hereby further certify that the area annexed contains zero (0) population and zero (0) alcoholic beverage licenses.

Dated this 25th day of September, 2000.

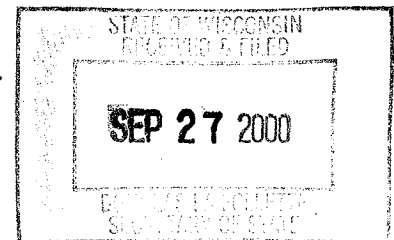

(SEAL)

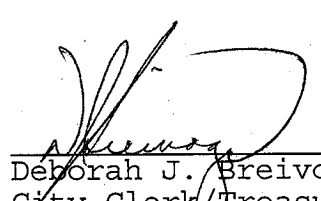
  
Deborah J. Breivogel  
City Clerk/Treasurer  
City of Rhinelander, Oneida Cty,  
Wisconsin

Org: Secretary of State  
Register of Deeds, Oneida County, WI

cc: WPSC, Real Estate Agent, Green Bay, WI/Local Office  
School District of Rhinelander, Secretary, Rhinelander, WI  
City Assessor/Town Assessor  
Wisconsin Dept of Revenue, Excise Tax Bureau, Madison, WI  
Rhinelander Police Dept/Oneida County Sheriff's Dept  
Rhinelander Fire Dept/County Fire Department  
Oneida County Land Information Office-Survey Files  
Rhinelander Transfer & Storage Inc.  
Rhinelander Public Works Dept  
James & Cynthia M. Kennedy

ORDINANCE NO. 30-00 RECOMMENDED BY PLANNING COMMISSION

AN ORDINANCE ANNEXING TERRITORY TO THE CITY OF RHINELANDER,  
WISCONSIN:

THE COMMON COUNCIL OF THE CITY OF RHINELANDER DO ORDAIN AS  
FOLLOWS:

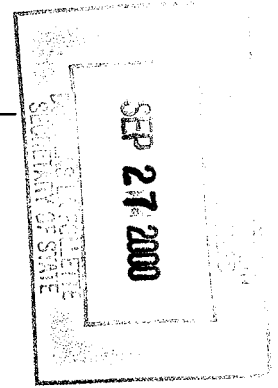

SECTION 1. Territory Annexed. In accordance with §66.021 of the Wisconsin Statutes of 1997-1998, and the petitions for direct annexation filed with the City Clerk on June 1, 2000, signed by the sole owner of the property within the area described below, located in the Town of Crescent, Oneida County, Wisconsin, is annexed to the City of Rhineland, Wisconsin.

Description

A parcel of land in the NW ¼ of the NW ¼, Section 12, T 36 N, R 8 E, Crescent Township, Oneida County, Wisconsin, being parcel "-B-" shown on Map No. 97-147 by Wilderness Surveying, Inc., dated January 15, 1998, more particularly described as follows:

Commencing at the NW corner of Section 12, marked by a P.K. nail in the pavement of North River Road; thence N 76°43'02" E for a distance of 32.90' to the NW corner of that parcel of land described in Vol. 798 of Records, Page 132, marked by an iron pipe at an intersection of the Easterly ROW line of North River Road with the Southerly ROW line of Airpark Road; thence along the North line of that parcel of land described in Vol. 798 of Records, Page 132 and also being along the Southerly ROW line of Airpark Road N 88°08'31" E for a distance of 559.60' to an iron pipe; thence S 00°45'35" E for a distance of 391.08' to the place of beginning marked by an iron pipe on the South line of that parcel of land as described in Vol. 798 of Records, Page 132; thence along the South line of that parcel of land as described in Vol. 798 of Records, Page 132 S 88°07'51" W for a distance of 559.62' to an iron pipe on the Easterly ROW line of North River Road; thence along the Easterly ROW line of North River Road S 00°14'28" E for a distance of 30.01 feet to an iron pipe; thence N 88°07'51" E for a distance of 559.89' to an iron pipe; thence N 00°45'35" W for a distance of 30.01' to the place of beginning. Together with and subject to covenants, easements, and restrictions of record.

A.K.A. 0.39 acre parcel adjacent to the Oneida Tool property.

SECTION 2. Effect of Annexation. For and after the date of this ordinance the territory described in Section 1 shall be a part of the City of Rhineland for any and all purposes provided by law and all persons coming or residing within such territory shall be subject to all ordinances, rules and regulations governing the City of Rhineland.

SECTION 3. Zoning Classification. Upon the recommendation of the Planning Commission, the territory annexed to the City of Rhineland by this ordinance is designated as I3, Air Industrial Park, subject to the zoning restrictions related to such zoning classifications in the City of Rhineland.

SECTION 4. Ward Designation. The territory described in Section 1 of this ordinance is hereby made a part of the 15<sup>th</sup> ward of the City of Rhineland, subject to ordinances, rules and regulations of the City governing wards.

SECTION 5. Severability. If any provision of this ordinance is invalid or unconstitutional, or the application of this ordinance to any person or circumstances is invalid or unconstitutional, such invalidity or unconstitutionality shall not affect the other provisions of applications of this ordinance which can be given effect without the invalid or unconstitutional provision of applications.

SECTION 6. Effective Date. This ordinance shall take effect upon passage and publication as provided by law.

### CERTIFICATE

STATE OF WISCONSIN     )  
  ) ss.  
COUNTY OF ONEIDA     )

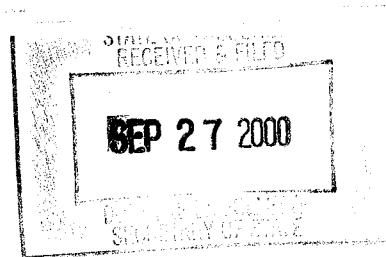

I, Deborah J. Breivogel, City Clerk of the City of Rhinelander, Wisconsin, do hereby certify that the foregoing ordinance was first read at a regular meeting of the Common Council of the City of Rhinelander, held at City Hall on July 12, 2000 at 7:00 p.m.; was adopted at a regular meeting of the Common Council of the City of Rhinelander held at City Hall on August 14, 2000 at 7:00 p.m. by a vote of 7 Ayes and 0 Nays, and published in the Rhinelander Daily News on the 3rd day of September, 2000.

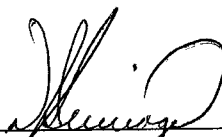
  
\_\_\_\_\_  
Deborah J. Breivogel, City Clerk  
City of Rhinelander  
Oneida County, Wisconsin

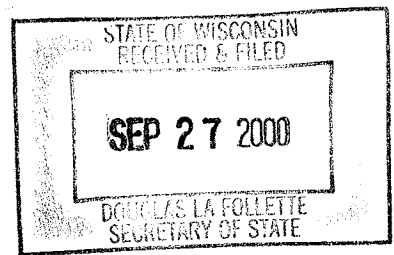
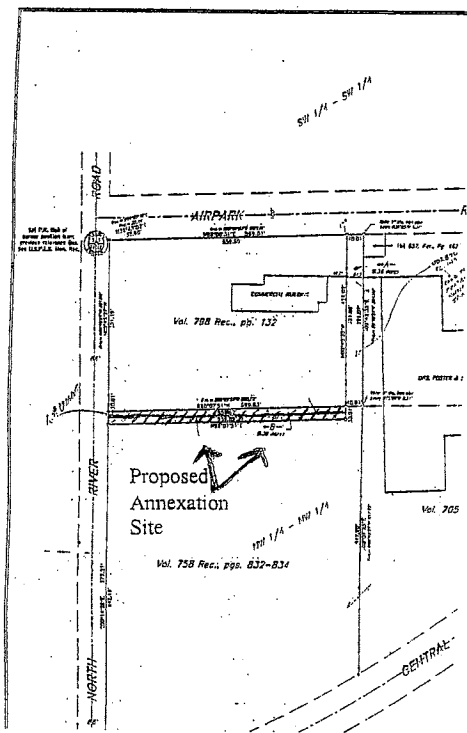

Curtis W. Wiese  
Secretary  
Rhineland Planning  
Commission

**PUBLISH LEGAL:**

June 16, and June 20, 2000

Please send publication statement to:

Mr. Richard Tessmann  
2389 Airpark Road  
Rhineland, WI 54501  
369-3232

cc: Planning Commission Board  
Mr. Richard Tessmann

30-00