

# The State of Wisconsin

**Office of the Secretary of State of Wisconsin**

**V-198**

**VILLAGE OF SOMERSET**

**COUNTY OF ST. CROIX**

**ANNEXATION AND PLAT**

**ORDINANCE A-480**

**FILED MAY 16, 2001**

V198  
**CERTIFICATE OF ANNEXATION**

Pamela Donohoe, Village Clerk  
Village of Somerset  
St. Croix County  
Wisconsin

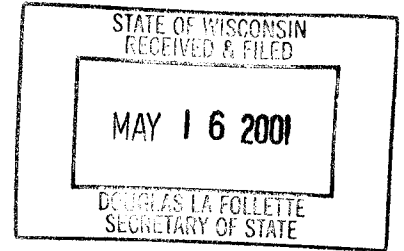

-to-

The Public,

I, Pamela Donohoe, Village Clerk of the Village of Somerset, do certify that the following described territory was detached from the Town of Somerset, St. Croix County, Wisconsin and was annexed to the Village of Somerset, pursuant to Section 66.021 (12) of the Wisconsin Statutes, by an ordinance adopted by the Village Board of the Village of Somerset at a regular meeting held on the 17<sup>th</sup> day of April 2001.

Parcel Description: The East Half of the Southeast Quarter and the Southeast Quarter of the Northeast Quarter all in Section 36, Township 31 North, Range 19 West, Acres: 118.40. Town of Somerset, St. Croix County, Wisconsin.  
Acres: 118.40

Population of total area: - 0 -

Dated this 25<sup>th</sup> day of April 2001.

PRINTED MAP - ATTACHED

  
Pamela Donohoe, Village Clerk  
Village of Somerset, Wisconsin

Subscribed and sworn to before me  
this 25 day of April, ~~2000~~ 2001

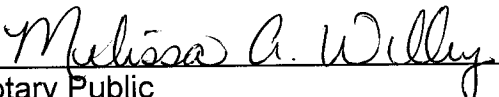
  
Notary Public  
St. Croix County, Wisconsin

My commission expires

2-20-2005

**MELISSA A. WILLEY**  
Notary Public-State of Wisconsin

## **ORDINANCE A-480**

### **AN ORDINANCE ANNEXING TERRITORY TO THE VILLAGE OF SOMERSET, WISCONSIN**

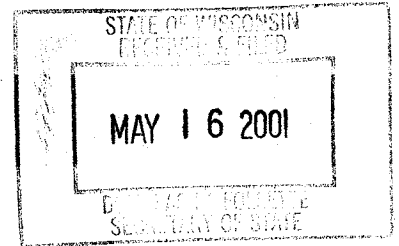

**THE COMMON COUNCIL OF THE VILLAGE OF SOMERSET, WISCONSIN  
DO ORDAIN AS FOLLOWS:**

**SECTION 1. TERRITORY ANNEXED.** In accordance with Section 66.021 of the Wisconsin Statutes and the petition for direct annexation filed with the Village Clerk on the 23<sup>rd</sup> day of February, 2001, signed by all of the owners and electors, the following described territory in the Town of Somerset, St. Croix County, Wisconsin, is annexed to the Village of Somerset, Wisconsin:

Parcel Description: The East Half of the Southeast Quarter and the Southeast Quarter of the Northeast Quarter all in Section 36, Township 31 North, Range 19 West, Acres: 118.40. Town of Somerset, St. Croix County, Wisconsin.

**SECTION 2. EFFECT OF ANNEXATION.** From and after the date of this ordinance the territory described in Section 1 shall be a part of the village of Somerset for any and all purposes provided by law and all persons coming or residing within such territory shall be subject to all ordinances, rules and regulations governing the Village of Somerset.

**SECTION 3. ZONING CLASSIFICATION.** The territory annexed hereby to the Village of Somerset is zoned Agricultural and subject to all provisions of the zoning ordinance of the village of Somerset.

**SECTION 4. SEVERABILITY.** If any provisions of this ordinance is invalid or unconstitutional, or if the application of this ordinance to any person or circumstances is invalid or unconstitutional, such invalidity or unconstitutionality shall not affect the other provisions or applications of this ordinance which can be given effect without the invalid or unconstitutional provisions or application.

**SECTION 5. EFFECTIVE DATE.** This ordinance shall take effect upon passage and publication as provided by law.

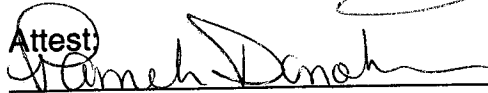

Michael Eckelberg, Village President

Attest: 

Pamela Donohoe, Village Clerk

Adopted: April 17, 2001  
Published: May 3, 2001  
Effective: May 4, 2001

I certify that this is a true and correct copy of Ordinance A480 adopted by the Village Board on April 17, 2001.



Pamela Donohoe, Village Clerk

4/24/01

Date

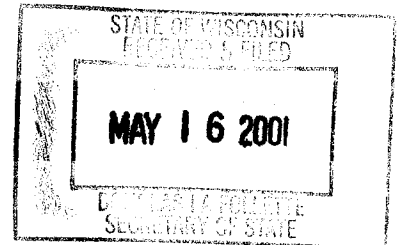

# PLAT OF SURVEY



## VICINITY MAP:

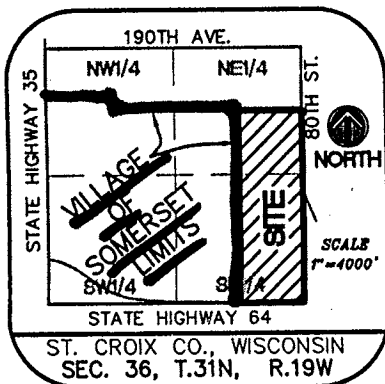

## LEGEND:

- ◆ DENOTES ALUMINUM MONUMENT FOUND
- DENOTES IRON PIPE FOUND
- DENOTES 1" X 24" IRON PIPE SET

## AREA

5,157,444 SQ.FT.  
= 118.40 ACRES

## SURVEY FOR:

HARRY BEHLING, INC.  
JERRY TRIDEN, INC.

INQUIRIES SHOULD BE  
DIRECTED TO HARRY  
BEHLING AT PHONE: (651)  
982-1726, FAX: (651)  
464-7808, ADDRESS:  
15252 W. FREEWAY DRIVE,  
FOREST LAKE, MN 55025.

## LEGAL DESCRIPTION:

The East Half of the  
Southeast Quarter and the  
Southeast Quarter of the  
Northeast Quarter all in  
Section 36, Township 31  
North, Range 19 West, St.  
Croix County, Wisconsin.

DRAWN BY: CJP		JOB NO: 520-01	DATE: 2/20/01
CHECK BY: TMH		DWG NO: 520-01	SHEET: 1 of 1
NO.	DATE	DESCRIPTION	BY



SCALE: 1 INCH = 400 FEET

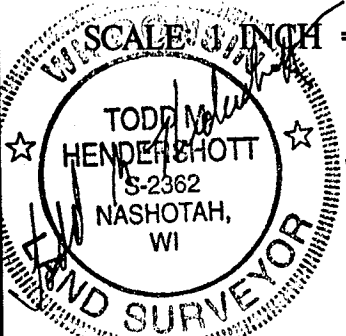

S CORNER OF SEC.  
36, T.31 N., R.18 W  
(ALUM. MON. FOUND)

1296.28'  
N87°24'06"W

STATE HIGHWAY 64

N87°24'06"W 1296.28'

## METRO LAND SURVEYING & ENGINEERING

412 COUNTY ROAD D  
LITTLE CANADA, MN 55117

PHONE: (651) 766-0112 FAX: (651) 766-0612

Job No. 520-OBS Scale: 1"=400' By: CJP

I hereby certify that this survey, plan or report was prepared  
by me or under my direct supervision and that I am a duly  
licensed land surveyor under the laws of the state of Wisconsin.

Dated this 21st day of FEBRUARY, 2001

By:

Todd P. Hendrich  
Surveyor, Wisconsin License No.

N87°43'38"W 2636.24

N CORNER OF SEC.  
36, T.31 N., R.18 W  
(PER WISC. DOT)

UNPLATTED LANDS

C.S.M. VOL.5, PG.1348

LOT 1

S87°37'16"E 1311.93'

N. LINE OF THE SE1/4  
OF THE NE1/4 OF SEC.  
36, T.31 N., R.18 W

N01°37'11"E  
1327.82'

NE CORNER OF SEC.  
36, T.31 N., R.18 W  
(ALUM. MON. FOUND)

VILLAGE  
LIMITS

S01°21'03"W 1325.47'

W. LINE OF THE SE1/4 OF THE  
NE1/4 OF SEC. 36, T.31 N., R.18 W

SE1/4 OF THE NE1/4  
SEC. 36, T.31N., R.18W.

S. LINE OF THE SE1/4 OF THE  
NE1/4 OF SEC. 36, T.31 N., R.18 W

W CORNER OF SEC.  
36, T.31 N., R.18 W  
(PER WISC. DOT)

N87°30'51"W  
3932.79'

N. LINE OF THE SE1/4 OF  
SEC. 36, T.31 N., R.18 W

N01°37'11"E 1327.82'

80TH STREET

E. LINE OF THE SE1/4 OF THE  
NE1/4 OF SEC. 36, T.31 N., R.18 W

SOMERSET INDUSTRIAL PARK

VILLAGE OF SOMERSET LIMITS

2629.08'

W. LINE OF THE E1/2 OF THE  
SE1/4 OF SEC. 36, T.31N., R.18W

E1/2 OF THE SE1/4  
SEC. 36, T.31N., R.18W.

VARIABLE ROW

E CORNER OF SEC.  
36, T.31 N., R.18 W  
(ALUM. MON. FOUND)

UNPLATTED LANDS

2631.44'

N01°29'46"E

E. LINE OF THE SE1/4 OF  
SEC. 36, T.31 N., R.18 W

SE CORNER OF SEC.  
36, T.31 N., R.18 W  
(ALUM. MON. FOUND)