

The State of Wisconsin

Office of the Secretary of State

VILLAGE 19

VILLAGE OF TURTLE LAKE

COUNTY OF POLK

ANNEXATION ORDINANCE NUMBER 13-5-8 AND RESOLUTION ORDINANCE NUMBER 2002-23

FILED DECEMBER 5, 2002

VILLAGE OF TURTLE LAKE

V-19

114 MARTIN AVENUE EAST • P.O. BOX 11 • TURTLE LAKE, WISCONSIN 54889
PHONE: (715) 986-2241 • FAX: (715) 986-4252

FRANCES DUNCANSON, Village Administrator

December 3, 2002

Office of the Secretary of State
Government Records Division
P.O. Box 7848
Madison, WI 53707-7848

To Whom It May Concern:

Pursuant to WI S/S 66.0223, this letter is to officially file with your office seven certified copies of necessary documents to complete annexation proceedings between the Village of Turtle Lake and the Town of Beaver in Polk County.

Please contact me with any questions.

Sincerely



Frances Duncanson
Village Administrator

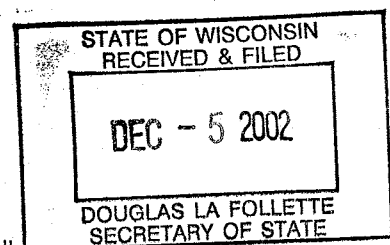



Village of Turtle Lake

Box 11
Turtle Lake, WI 54889
(715) 986-2241

CERTIFICATE:

I hereby certify that the attached are true and correct copies of an **ANNEXATION RESOLUTION, ANNEXATION ORDINANCE, AND MAP** which was accepted and adopted by the Village Board of the Village of Turtle Lake, Barron & Polk County Wisconsin, a Municipal Corporation at the Regular meeting of the Village Board on November 18TH, 2002. The originals are on file in the book containing the minutes of the meetings of the Village Board, said book is located in the Village Office at 114 Martin Avenue East in the Village of Turtle Lake, Barron & Polk County, Wisconsin.

The Administrator/Clerk also certifies that as estimated by the WI Department of Administration, the population of the Village of Turtle Lake, Polk County, Wisconsin is 77.

Dated this the 18th day of November, 2002 at Turtle Lake, Barron County, Wisconsin by:

Frances Duncanson, Village Administrator/Clerk

(Seal)

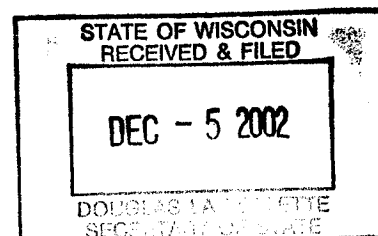

RESOLUTION 2002-23

ANNEXATION OF THE BOY SCOUT CAMP-NOVEMBER 18TH, 2002

WHEREAS, on October 21st, 2002 the Turtle Lake Village Board voted that pursuant to WI S/S 66.0223, the Village of Turtle Lake, Barron and Polk Counties, Wisconsin desires to annex in to the Village of Turtle Lake limits the below described contiguous Village owned property, known as the Boy Scout Camp:

Parcel BE 375B, Section 24, Town 34 North, Range 15 West, south 200 feet of the SE-SE described in Volume 251/347, approximately five acres in the Town of Beaver, Polk County, Wisconsin.

Parcel BE376A, Section 25, Town 34, Range 15, the north one-half of the NE-NE, approximately 20 acres in the Town of Beaver, Polk County, Wisconsin.

WHEREAS, the Turtle Lake Village Board has determined that annexation of the said lands is in the best interest of the citizens of the Village of Turtle Lake, now;

THEREFORE, BE IT RESOLVED that from and after the date of this resolution, the above described territory shall be a part of the Village of Turtle Lake, Polk County, Wisconsin for any and all purposes provided by law and all persons residing therein such territory shall be subject to all ordinances, rules, and regulations of the Village of Turtle Lake, Polk County, Wisconsin; and

BE IT FURTHER RESOLVED that pursuant to WI S/S 66.0223 the Turtle Lake Village Board directs the Village Administrator to file seven certified copies of Section 13-5-8 of the Village Code of Annexation Ordinances with the Secretary of State, together with seven certified copies of plats showing the boundaries of the said territory attached; and within ten days of filing the certified copies to the Secretary of State, a certified copy of the ordinance and plat shall be mailed or delivered to the Polk County Clerk; and

HEREBY this Resolution directs the Planning Commission of the Village of Turtle Lake to prepare an amendment to the zoning ordinance set forth the permanent classification and regulation for the zoning of the annexed territory and to submit its recommendations to the Village Board.

Dated this the 18th day of November, 2002 by:

Raymond J. Hall, Village President

Frances Duncanson, Village Administrator

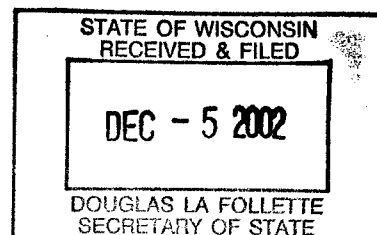

SECTION 13-5-8 ANNEXATION-NOVEMBER 18TH, 2002

(a) On October 21st, 2002 the Turtle Lake Village Board declared their intention to initiate proceedings to annex in to the Village of Turtle Lake corporate limits the below described contiguous Village owned property, locally known as the Boy Scout Camp:

Parcel BE 375B, Section 24, Town 34 North, Range 15 West, south 200 feet of the SE-SE described in Volume 251/347, approximately five acres in the Town of Beaver, Polk County, Wisconsin.

Parcel BE376A, Section 25, Town 34, Range 15, the north one-half of the NE-NE, approximately 20 acres in the Town of Beaver, Polk County, Wisconsin.

(b) Appropriate notice was made to the public and the Planning Commission met on November 14th, 2002 and recommended aforementioned annexation to the Village Board.

(c) The Turtle Lake Village Board has determined that annexation of the said lands is in the best interest of the citizens of the Village of Turtle Lake.

(d) The Village Board establishes a temporary zoning classification on said annexed lands as C-1 Conservancy until the comprehensive zoning ordinance can be amended.

(e) The real estate described above and attached hereto and hereby is annexed in to the Village of Turtle Lake, Polk County, Wisconsin, and detached from the Town of Beaver, Polk County, Wisconsin.

Given under my hand and dated this the 18th day of November, 2002 by:

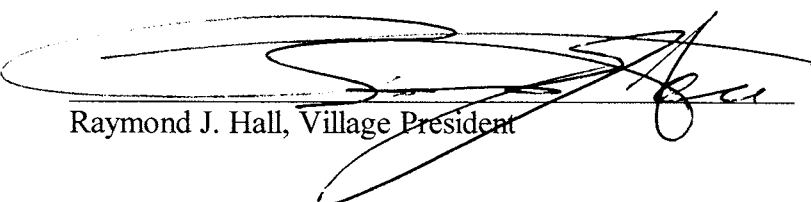
Raymond J. Hall, Village President

Frances Duncanson, Village Administrator

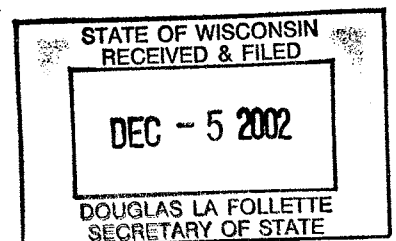

SEE PAGE 32

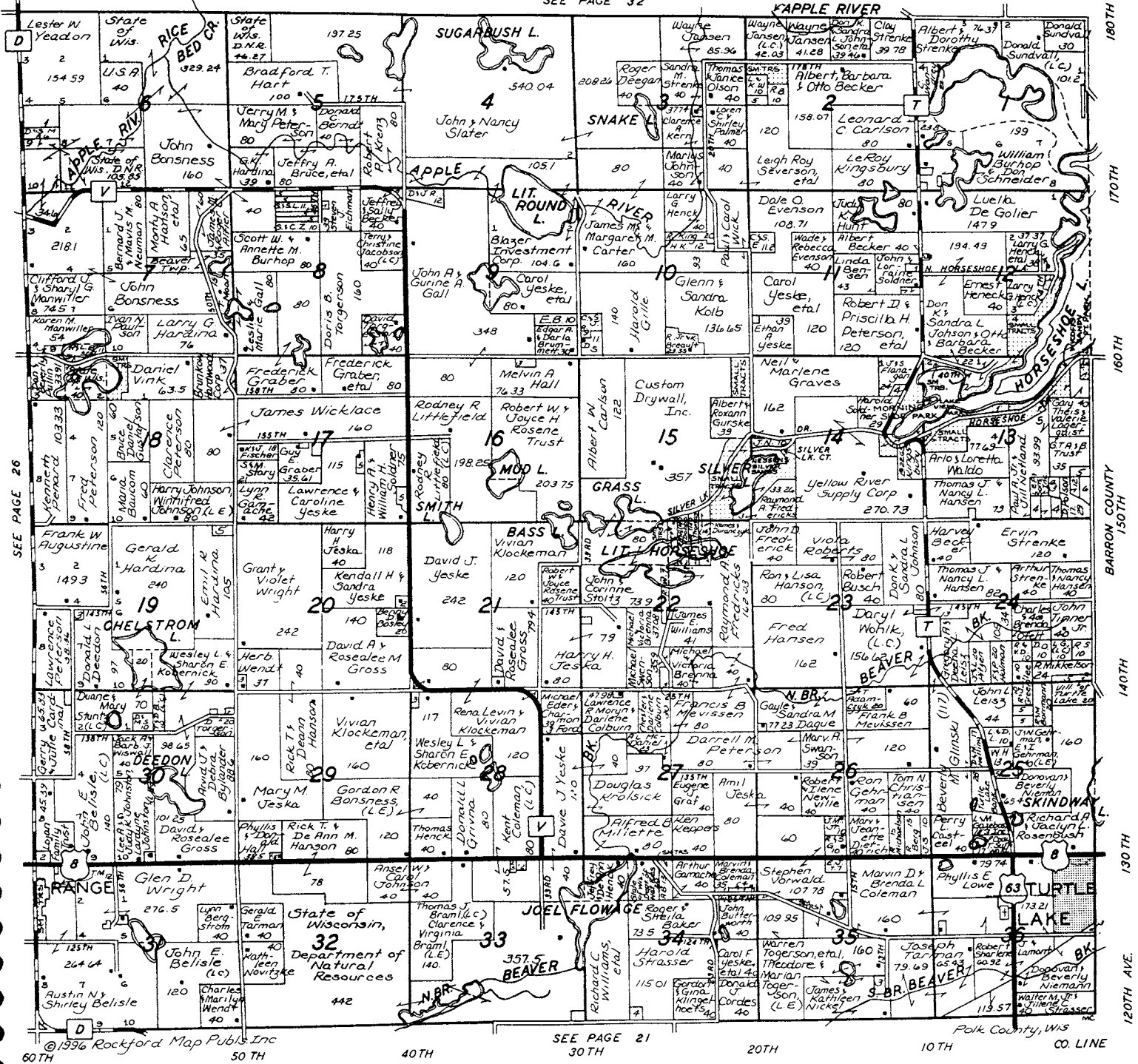

©1996 Rockford Map Publs Inc

SEE PAGE 21

Polk County, Wis

Lake Aire Agency
 COMPLETE INSURANCE SERVICE
JAMES KUNTZ, Owner
 Office:
 109 Martin Avenue, Box 365
 Turtle Lake, Wisconsin 54889
 (715) 986-4105
 Our Main Concern Is You!

Becker's Super Valu Store

 • Produce
 • Groceries
 • Meats
CALL: 986-2244
 608 Highway 8 - Turtle Lake

JOHNSON & JOHNSON LAND CO.
Real Estate
 Highway 8
 Turtle Lake, Wisconsin
 54889
(715) 986-4141

Dr. Dean M. Springer
 218 MAPLE STREET
 TURTLE LAKE, WISCONSIN
 54889
 Phone:
 (715) 986-4448

**STATE OF WISCONSIN
RECEIVED & FILED**

DEC - 5 2002

**DOUGLAS LA FOLLETTE
SECRETARY OF STATE**

T. 34 N.-R. 15 W.

SEE PAGE 32

KAPPLE RIVER

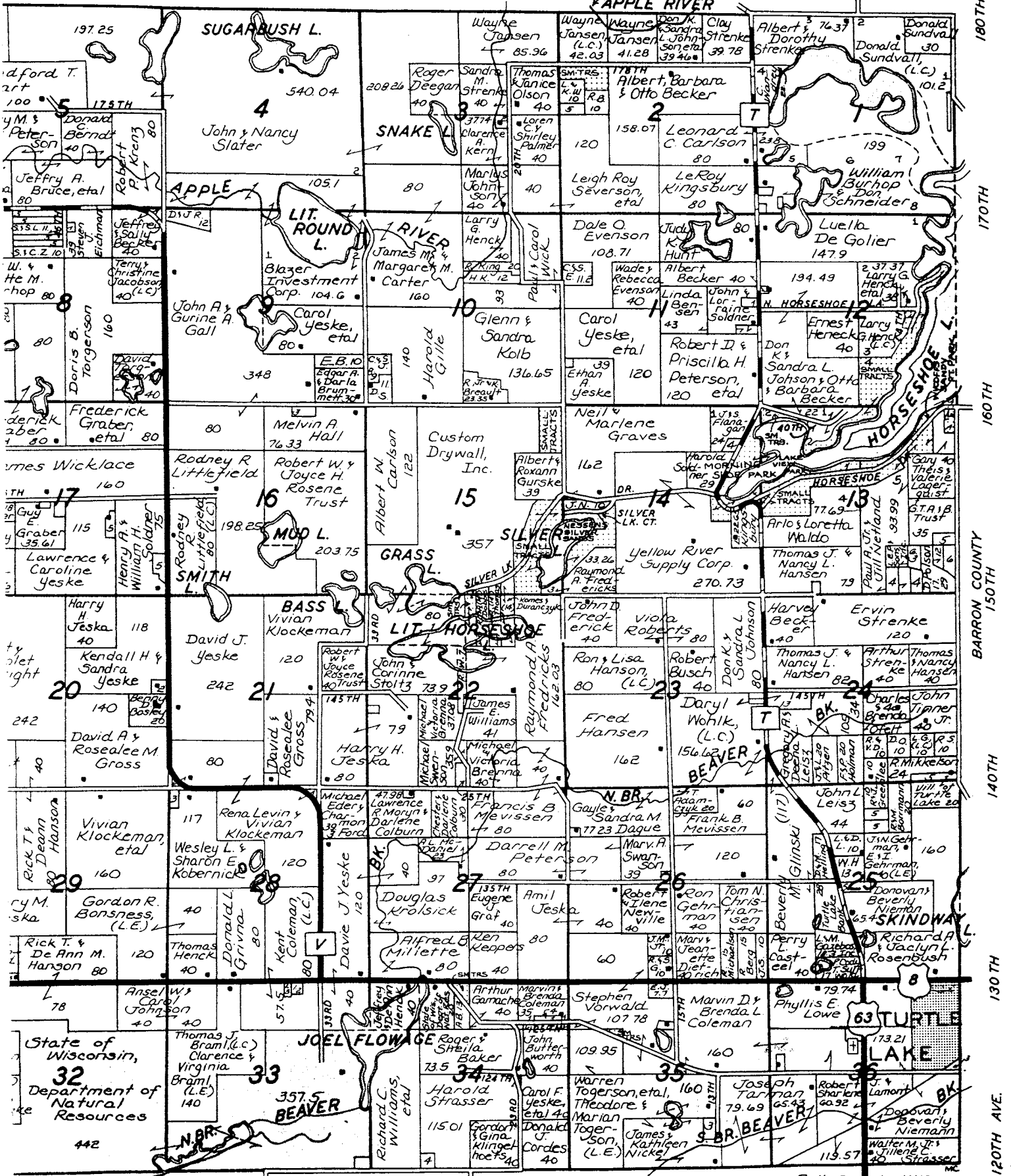

180TH
170TH
160TH
150TH
140TH
130TH
120TH AVE.

SEE PAGE 21

Polk County, Wis

40TH 30TH 20TH 10TH CO. LINE

STATE OF WISCONSIN
RECEIVED & FILED

DEC - 5 2002

DOUGLAS LA FOLLETTE
SECRETARY OF STATE

**STATE OF WISCONSIN
RECEIVED & FILED**

DEC - 5 2002

**DOUGLAS LA FOLLETTE
SECRETARY OF STATE**